

STATE OF ILLINOIS
DEPARTMENT OF TRANSPORTATION

ROUTE NO. FAP 716	SECTION #	COUNTY MACON	SHEETS 95	SHEET 42	SHEET NO. 8 28 SHEETS
FED. ROAD DIST. NO.		ILLINOIS		FED. AID PROJECT	
				CONTRACT NO. 74166 * (130BR-1B-1)	

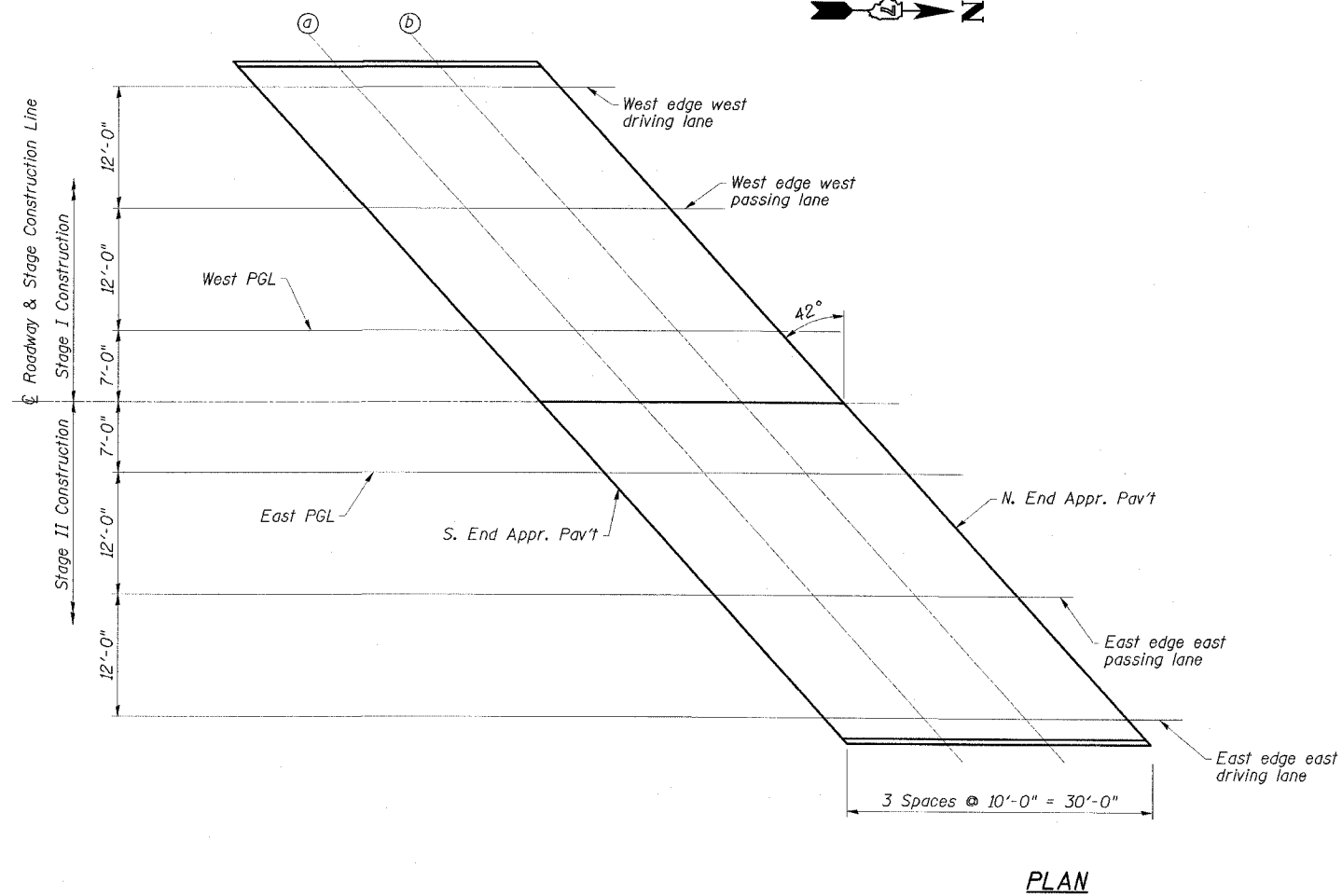

WEST EDGE WEST PASSING LANE

Location	Station	Offset (ft.)	Theoretical Grade Elevations
S. End Appr. Pav't.	136+34.87	-19.00	629.06
a	136+44.87	-19.00	629.14
b	136+54.87	-19.00	629.22
N. End Appr. Pav't.	136+64.87	-19.00	629.30

WEST PGL

Location	Station	Offset (ft.)	Theoretical Grade Elevations
S. End Appr. Pav't.	136+45.67	-7.00	629.34
a	136+55.67	-7.00	629.42
b	136+65.67	-7.00	629.50
N. End Appr. Pav't.	136+75.67	-7.00	629.58

ROADWAY & STAGE CONSTRUCTION LINE

Location	Station	Offset (ft.)	Theoretical Grade Elevations
S. End Appr. Pav't.	136+51.98	0.00	629.50
a	136+61.98	0.00	629.58
b	136+71.98	0.00	629.66
N. End Appr. Pav't.	136+81.98	0.00	629.74

EAST PGL

Location	Station	Offset (ft.)	Theoretical Grade Elevations
S. End Appr. Pav't.	136+58.28	7.00	629.44
a	136+68.28	7.00	629.52
b	136+78.28	7.00	629.60
N. End Appr. Pav't.	136+88.28	7.00	629.68

EAST EDGE EAST PASSING LANE

Location	Station	Offset (ft.)	Theoretical Grade Elevations
S. End Appr. Pav't.	136+69.08	19.00	629.34
a	136+79.08	19.00	629.42
b	136+89.08	19.00	629.50
N. End Appr. Pav't.	136+99.08	19.00	629.58

WEST EDGE WEST DRIVING LANE

Location	Station	Offset (ft.)	Theoretical Grade Elevations
S. End Appr. Pav't.	136+24.06	-31.00	628.73
a	136+34.06	-31.00	628.81
b	136+44.06	-31.00	628.89
N. End Appr. Pav't.	136+54.06	-31.00	628.97

EAST EDGE EAST DRIVING LANE

Location	Station	Offset (ft.)	Theoretical Grade Elevations
S. End Appr. Pav't.	136+79.89	31.00	629.17
a	136+89.89	31.00	629.25
b	136+99.89	31.00	629.33
N. End Appr. Pav't.	137+09.89	31.00	629.44

ESCA
CONSULTANTS, INC.

DESIGNED BY:	ELH	03/07
DRAWN BY:	HAS	03/07
CHECKED BY:	ELH	06/07
APPROVED BY:	RDP	06/07

TOP OF NORTH APPROACH
SLAB ELEVATIONS
IL ROUTE 48
OVER SPRING CREEK
FAP ROUTE 716-SECTION (130BR-1)B-1
MACON COUNTY
STATION 135+77.11
STRUCTURE NO. 058-0135