

SECTION	COUNTY	TOTAL SHEETS	SHEET NO.
00-00048-00-BT	COOK	39	14
STA. 9+95 TO STA. 31+58		ILLINOIS FED. AID PROJECT	
FED. ROAD DIST. NO. 1		CONTRACT NO. 83864	

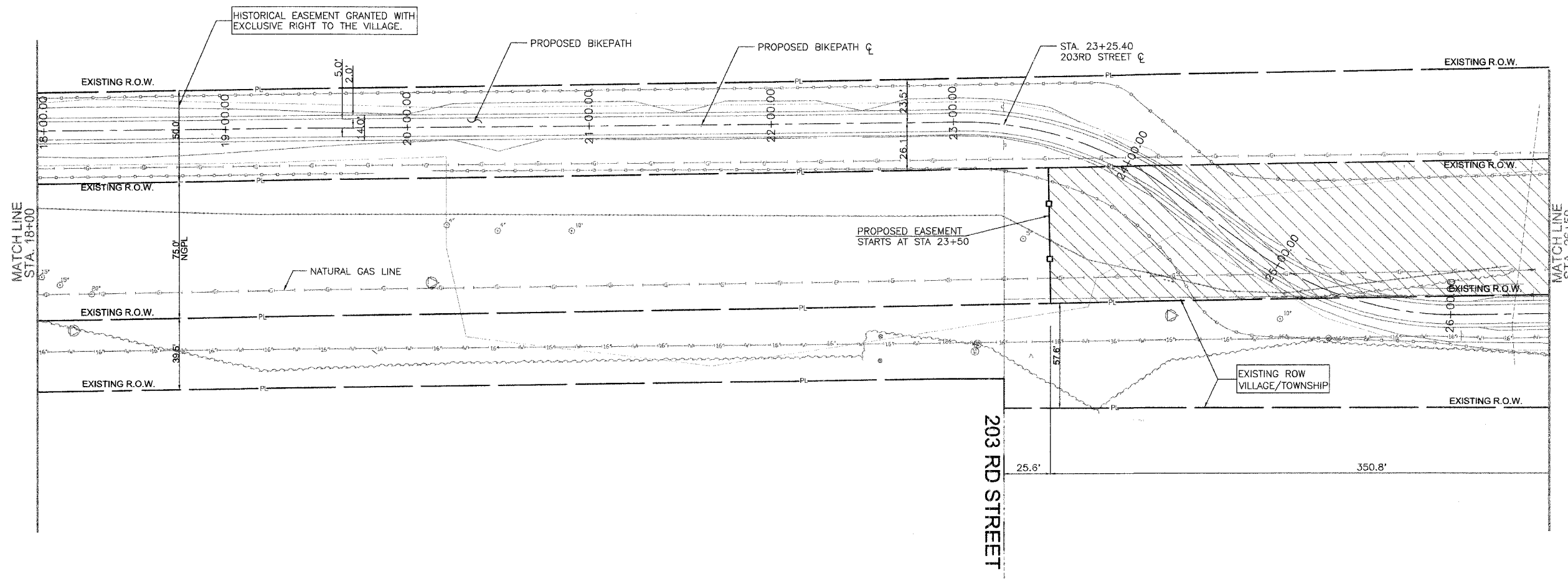

505 N. LASALLE SUITE 250  
CHICAGO, IL 60610  
(312)467-0123

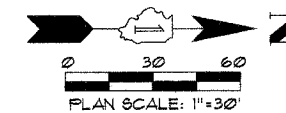

<b>EXISTING LEGEND</b>	<b>PROPOSED LEGEND</b>
⊙ TREES	● BOLLARDS
— WATER	▨ PROPOSED BRIDGE
— BEAN FIELD LINE	— TEMPORARY SILT FENCE
— GAS	● BORING LOCATION
— CORN FIELD LINE	— PROPOSED BIKE PATH
⊕ FIRE HYDRANT	— PROPOSED EASEMENT LIMITS
PL PROPERTY LINE	▨ PROPOSED PERMANENT EASEMENT
— EXISTING R.O.W.	
— FLOOD PLANE	

▨ TOTAL PROPOSED PERMANENT EASEMENT  
A = 0.60 AC  
A = 26,095 SQ FT

REVISIONS	
NAME	DATE

ILLINOIS DEPARTMENT OF TRANSPORTATION  
  
PRESERVATION BIKE PATH  
RIGHT OF WAY 18+00.00 - 26+50.00  
  
SCALE: 1"=30'  
DATE: MAY 04, 2007  
DRAWN BY: CC  
CHECKED BY: SC