

F.A.U. RTE.	SECTION	COUNTY	TOTAL SHEETS	SHEET NO.
3509	00-00173-00-FF	COOK	246	22
STA.		TO STA.		
FED. ROAD DIST. NO. 1		ILLINOIS FED. AID PROJECT		

EXISTING LEGEND

- (A) HOT-MIX ASPHALT BINDER AND SURFACE COURSES (3" AND VARIES)
- (B) PORTLAND CEMENT CONCRETE PAVEMENT (7" AND VARIES)
- (C) COMBINATION CONCRETE CURB & GUTTER, TYPE B-6.12B
- (D) GROUND SURFACE (ASSUME EXISTING TOPSOIL DEPTH 4")
- (E) PORTLAND CEMENT CONCRETE SIDEWALK (5")
- (F) AGGREGATE BASE COURSE (7" AND VARIES)
- (G) HOT-MIX ASPHALT BINDER AND SURFACE COURSES (4" AND VARIES)
- (H) PORTLAND CEMENT CONCRETE PAVEMENT (8" AND VARIES)
- (I) AGGREGATE BASE COURSE (8" AND VARIES)

NOTE: ASSUME EXISTING DRIVEWAY THICKNESS 8"

PROPOSED LEGEND

- (1) HOT-MIX ASPHALT SURFACE COURSE, MIX "D", N70 - 1 1/2"
- (2) PORTLAND CEMENT CONCRETE BASE COURSE 7 1/2"
- (3) PORTLAND CEMENT CONCRETE BASE COURSE 6"
- (4) HOT-MIX ASPHALT BINDER COURSE, IL-19.0, N70 - 2 1/2"
- (5) AGGREGATE SUBGRADE 12"
- (6) COMBINATION CONCRETE CURB & GUTTER, TYPE B-6.12
- (7) PORTLAND CEMENT CONCRETE SIDEWALK 5 INCH SUB-BASE GRANULAR MATERIAL, TYPE B, 4" (INCLUDED IN THE COST OF PCC SW 5 INCH)
- (8) TOPSOIL FURNISH AND PLACE, 4" SODDING, SALT TOLERANT NITROGEN FERTILIZER NUTRIENT POTASSIUM FERTILIZER NUTRIENT PHOSPHOROUS FERTILIZER NUTRIENT
- (9) BITUMINOUS MATERIALS (PRIME COAT)
- (10) LONGITUDINAL SAWED JOINT (NO. 6 X 30" EPOXY COATED TIE BARS @ 30" CTS) (STANDARD 420001) (INCLUDED IN THE COST OF PCC BASE COURSE)
- (11) LONGITUDINAL CONSTRUCTION JOINT TIE BAR FORMED IN PLACE (NO. 6 X 30" EPOXY COATED TIE BARS @ 24" CTS) (STANDARD 420001) (INCLUDED IN THE COST OF PCC BASE COURSE)
- (12) LONGITUDINAL CONSTRUCTION JOINT TIE BAR GROUTED IN PLACE (NO. 6 X 24" EPOXY COATED TIE BARS @ 24" CTS) (STANDARD 606001) (INCLUDED IN THE COST OF COMBINATION CURB & GUTTER)
- (13) PIPE UNDERDRAINS 4"
- (14) HOT-MIX ASPHALT SHOULDERS, 6"

PLOT DATE = 7/12/2007
 PLOT SCALE = 50.0000 / IN.
 USER NAME = bjhohman

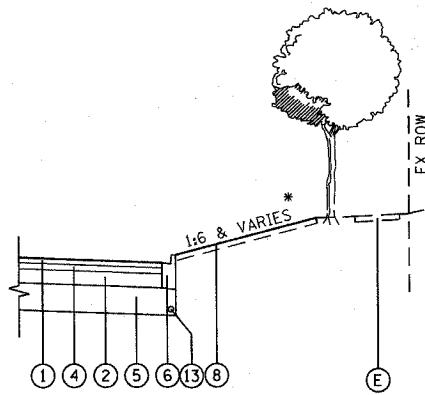

PROPOSED TREE TYPICAL SECTION
SHERIDAN ROAD
ISABELLA STREET

* SLOPE AWAY FROM ROAD
IN FILL SECTIONS
SLOPE TOWARD ROAD
IN CUT SECTIONS

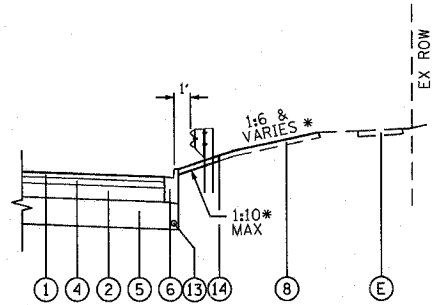

PROPOSED GUARDRAIL TYPICAL SECTION
SHERIDAN ROAD

* SLOPE AWAY FROM ROAD
IN FILL SECTIONS
SLOPE TOWARD ROAD
IN CUT SECTIONS

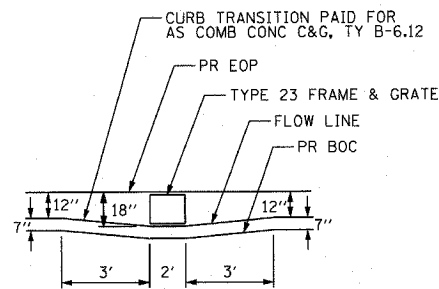

DRAINAGE STRUCTURES IN CURB & GUTTER TAPER DETAIL

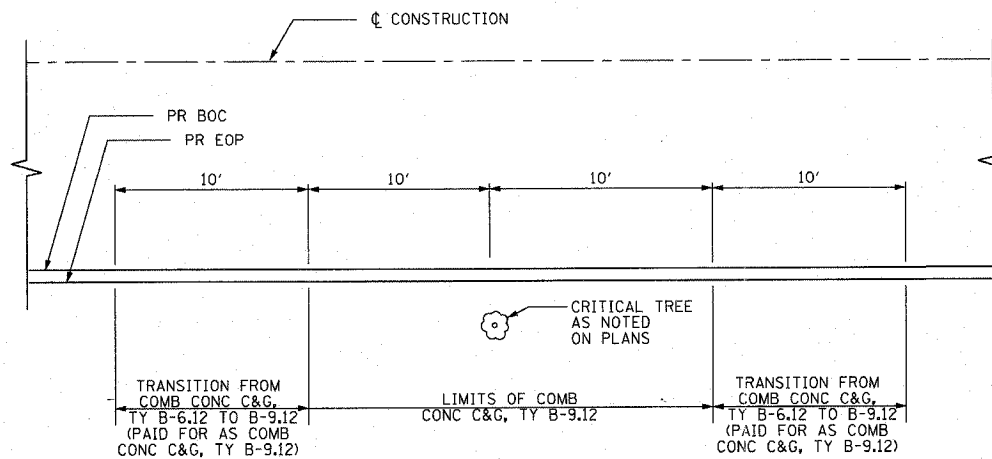

CRITICAL TREE CURB & GUTTER TRANSITION DETAIL

CRITICAL TREE CURB TRANSITION LOCATIONS

STATION	OFFSET	SIZE (IN)
1	1013+17.2	25.2' RT 16
2	1018+49.6	24.6' RT 22
3	1028+94.2	23.0' RT 14
4	1029+30.9	23.5' RT 14
5	1029+66.9	23.8' LT 14
6	1029+69.2	23.0' RT 18
7	1030+20.6	22.6' RT 32
8	1030+71.2	22.7' RT 36
9	1050+84.9	24.2' LT 36
10	3052+33.1	26.2' LT 30

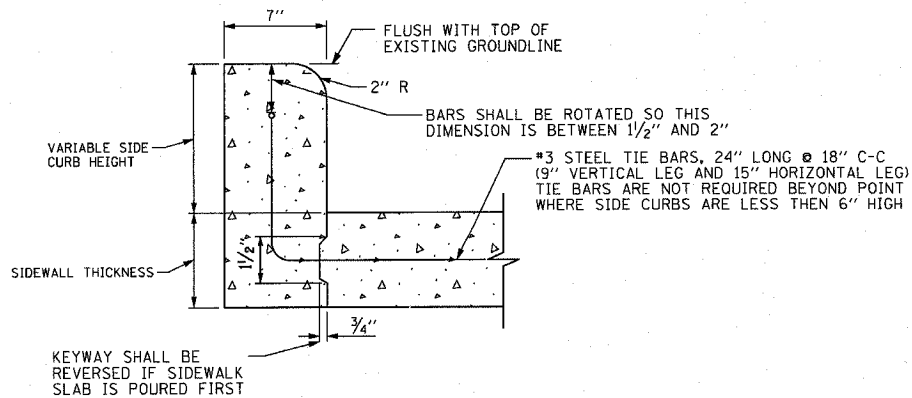

VARIABLE HEIGHT CURB

REVISIONS	
NAME	DATE

ILLINOIS DEPARTMENT OF TRANSPORTATION

TYPICAL SECTIONS
SHERIDAN ROAD
ISABELLA STREET

DATE 7/13/07
DRAWN BY LTD
CHECKED BY BJL

1051 PERIMETER DRIVE, SUITE 1025
 SCHALMERSBURG, ILLINOIS 60173
 (847) 505-9800

