

F.A.U. RTE.	SECTION	COUNTY	TOTAL SHEETS	SHEET NO.
3509	00-00173-00-FP	COOK	246	98
STA. 1048+00		TO STA. 1036+00		
FED. ROAD DIST. NO. 7 ILLINOIS FED. AID PROJECT				

MATCH LINE STATION 3054+00
LAKE AVENUE
SEE SHEET NO. 102

WASHINGTON AVENUE

MATCH LINE STATION 1048+00
SEE SHEET NO. 97

MATCH LINE STATION 1063+00
SEE SHEET NO. 99

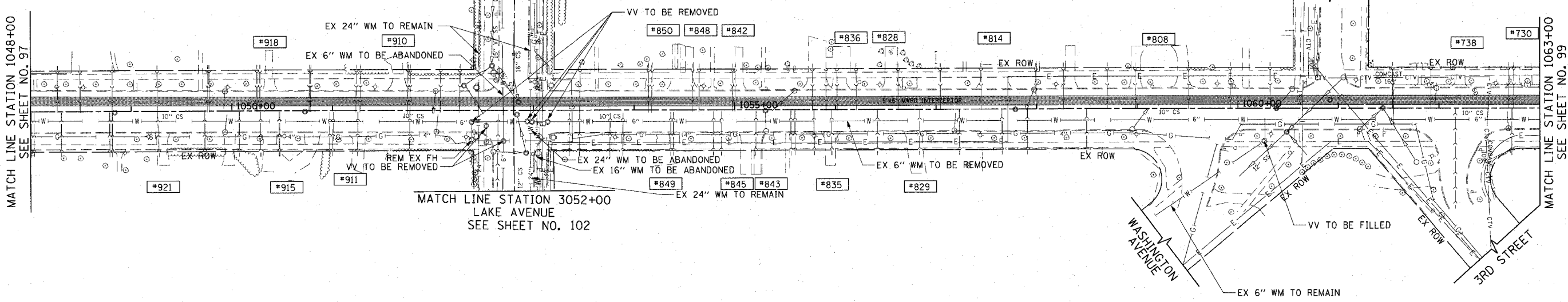

EXISTING

SEE SHEET NO. 94 FOR WATER MAIN NOTES.

MATCH LINE STATION 3054+00
LAKE AVENUE
SEE SHEET NO. 102

WASHINGTON AVENUE

MATCH LINE STATION 1048+00
SEE SHEET NO. 97

MATCH LINE STATION 1063+00
SEE SHEET NO. 99

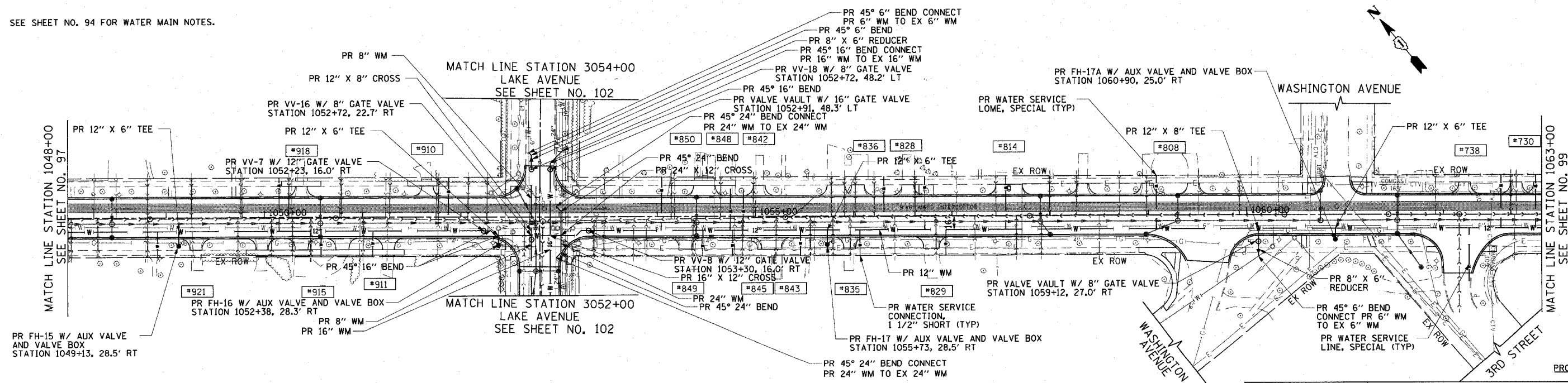

PROPOSED

REVISIONS	NAME	DATE

ILLINOIS DEPARTMENT OF TRANSPORTATION
WATER MAIN PLAN
SHERIDAN ROAD
STATION 1048+00 TO STATION 1063+00

DATE 7/13/07
DRAWN BY LTD
CHECKED BY BJL

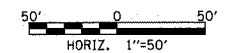

PLOT DATE = 7/12/2007
FILE NAME = g:\cadd\83964\road\water\main\1048-1063.dwg
SCALE = 1/8" = 1' / 1" = 10'
USER NAME = bjohnson

1051 PERIMETER DRIVE, SUITE 1025
SCHWANBERG, ILLINOIS 60173
(847) 965-9800

