

F.A. RTE.	SECTION	COUNTY	TOTAL SHEETS	SHEET NO.
3509	DO-00173-00-FP	COOK	246	144
STA.		TO STA.		
FED. ROAD DIST. NO.		ILLINOIS FED. AID PROJECT		

PLOT DATE = 7/12/2007
 FILE NAME = G:\CADD\83964\Road\Sheets\Westerfield.dwg
 PLOT SCALE = 20.0000' / 1" IN.
 USER NAME = bjoelinen



TRAFFIC SIGNAL LEGEND

PROPOSED	EXISTING

NOTE:
 1. ALL CONDUIT UNDER SIDEWALK TO BE INSTALLED (TRENCHED) PRIOR TO CONSTRUCTION OF NEW SIDEWALK

RESTORATION OF WORK AREA: RESTORATION OF THE TRAFFIC SIGNAL WORK AREA SHALL BE INCIDENTAL TO THE RELATED PAY ITEM SUCH AS FOUNDATION, CONDUIT, HANDHOLE, TRENCH AND BACKFILL, ETC., AND NO EXTRA COMPENSATION SHALL BE ALLOWED. ALL ROADWAY SURFACES SUCH AS SHOULDERS, MEDIANS, SIDEWALKS, PAVEMENT, ETC. SHALL BE REPLACED IN KIND. ALL DAMAGE TO MOWED LAWNS SHALL BE REPLACED WITH AN APPROVED SOD, AND ALL DAMAGE TO UNMOWED FIELDS SHALL BE SEEDED IN ACCORDANCE WITH STANDARD SPECIFICATIONS 252 AND 250 RESPECTIVELY.

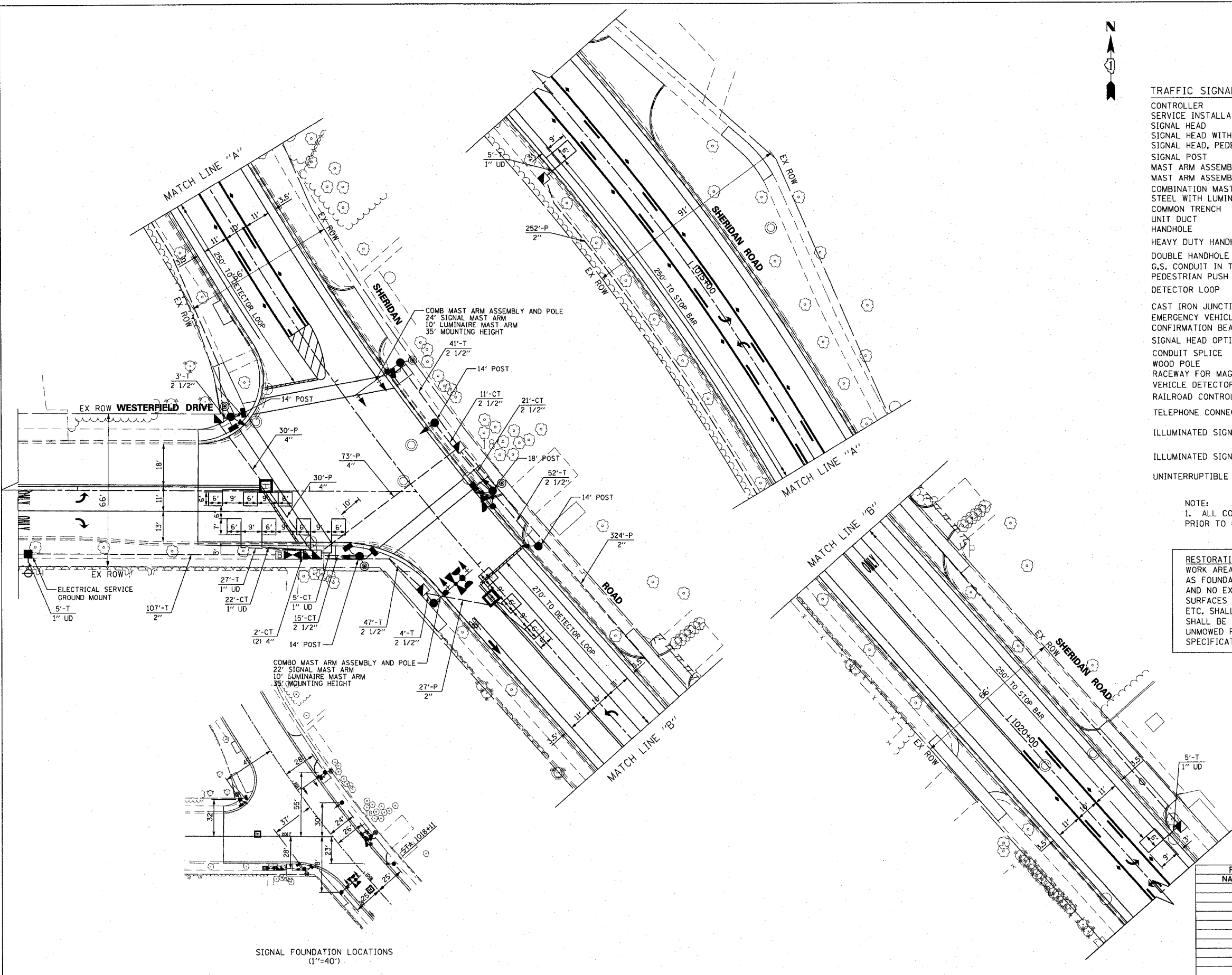

SIGNAL FOUNDATION LOCATIONS
 (1"=40')

REVISIONS	
NAME	DATE

ILLINOIS DEPARTMENT OF TRANSPORTATION

TRAFFIC SIGNAL INSTALLATION PLAN

SHERIDAN ROAD AND WESTERFIELD DRIVE

HORIZ. 1"=20'

DATE 7/12/2007

DRAWN BY SRS
 DESIGNED BY SRS
 CHECKED BY KMM