

STATE	SECTION	COUNTY	TOTAL SHEETS	SHEET NO.
IL	00-C0173-00-FF	COOK	246	171
STA. 4087+60 TO STA. 4113+13				
FED. ROAD DIST. NO. 7 ILLINOIS FED. AID PROJECT				

PLOT DATE = 7/6/2007
 FILE NAME = GR-480-0000-0000-SHEET-171-171.dwg
 PLOT SCALE = 50.0000 / IN.
 USER NAME = mjgonzalez

PROJECT LIMITS
 STATION 4088+74.25

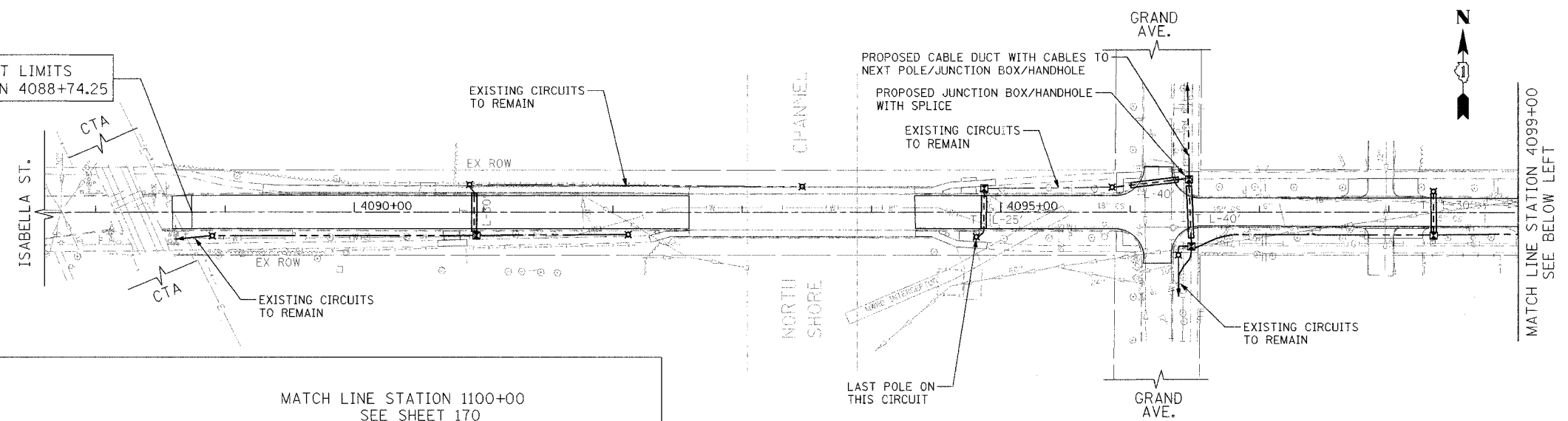

MATCH LINE STATION 1100+00
 SEE SHEET 170

LAST LIGHT POLE ON
 WILMETTE CIRCUIT
 LAST LIGHT POLE ON
 EVANSTON CIRCUIT

NOTES:
 1. FOR RELOCATED POLE OFFSET DISTANCE REQUIREMENTS,
 SEE NOTE 8 ON SHEET NO. 161

PROJECT LIMITS
 STA 4104+58.70

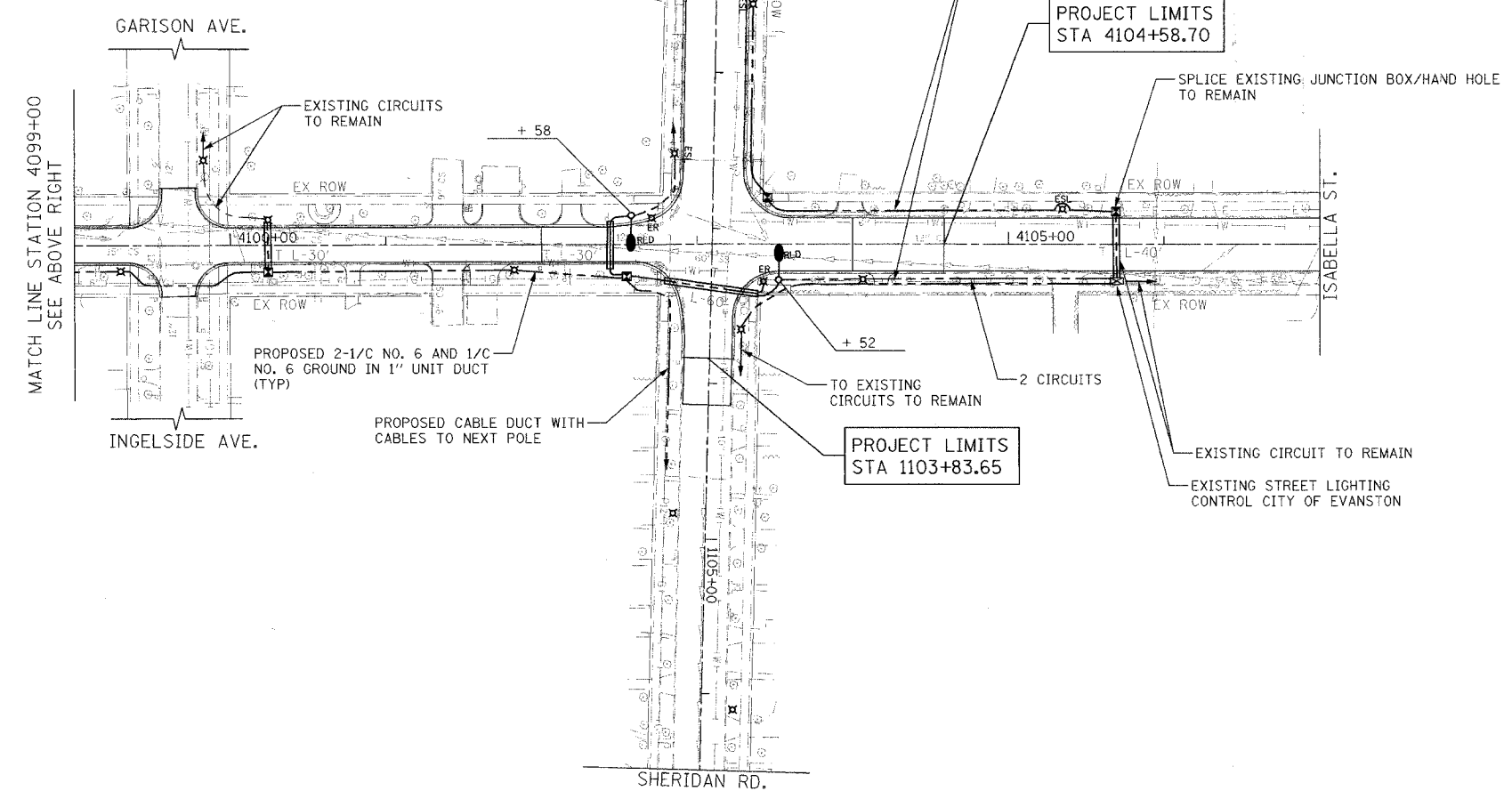

PROJECT LIMITS
 STA 1103+83.65

REVISIONS	NAME	DATE

ILLINOIS DEPARTMENT OF TRANSPORTATION
PROPOSED LIGHTING PLAN
 ISABELLA STREET
 STATION 4088+50 TO STATION 4113+13

DATE: 7/30/07
 DRAWN BY: AJP
 CHECKED BY: RJG

HORIZ. 1"=50'

1057 PERIMETER DRIVE, SUITE 1025
 SCHENAGO, ILLINOIS 60175
 (847) 688-8600

