

F.A.U. RTE.	SECTION	COUNTY	TOTAL SHEETS	SHEET NO.
3509 00-00173-00-FP		COOK	246	199
STA. 1026+50.00 TO STA. 1029+00.00				
FED. ROAD DIST. NO. 1 ILLINOIS FED. AID PROJECT				

DATE	
BY	
FINAL SURVEY	
FLUDED	
NOTE BOOK	
NO.	

DATE	
BY	
ORIGINAL SURVEY	
FLUDED	
NOTE BOOK	
NO.	

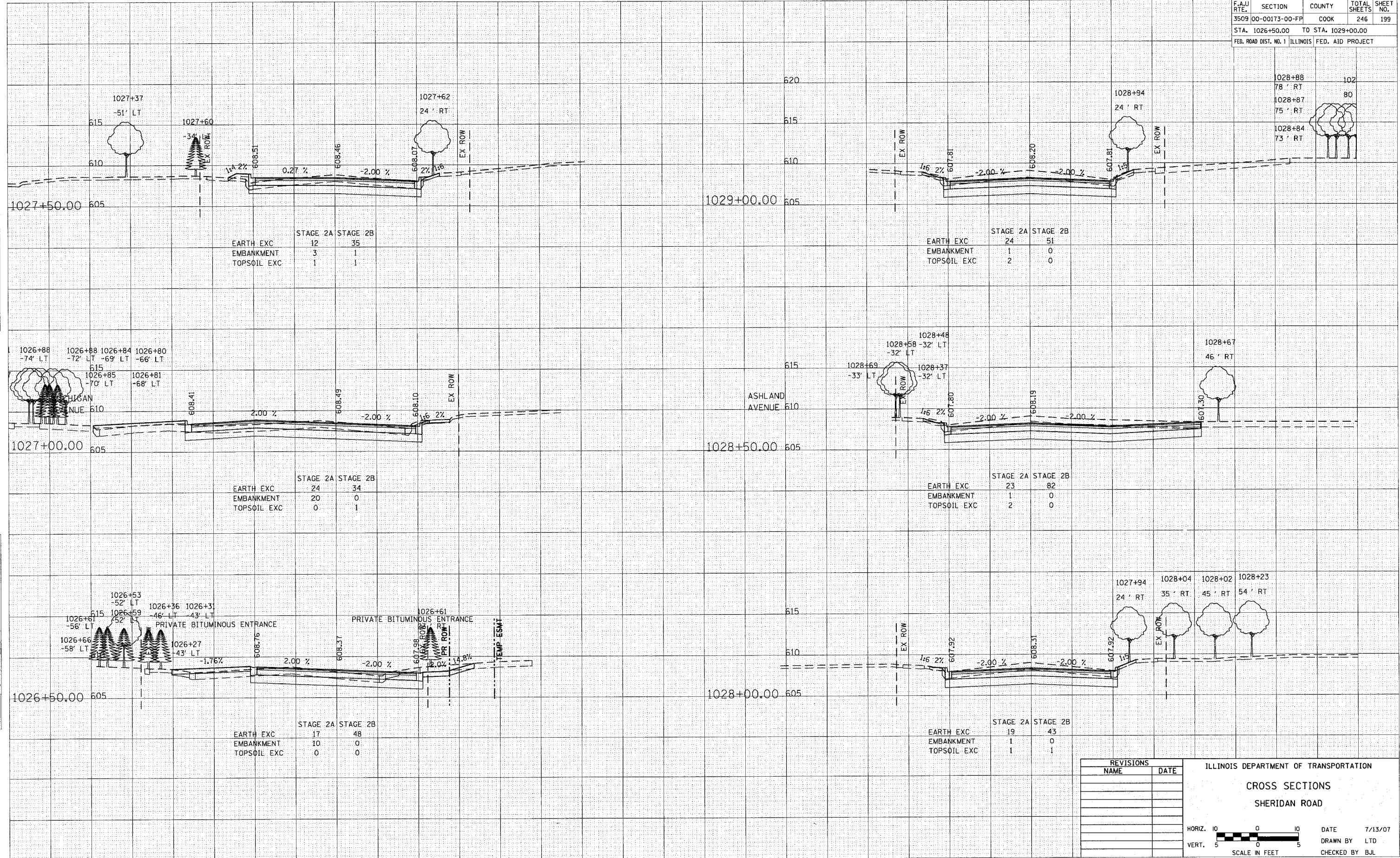

	STAGE 2A	STAGE 2B
EARTH EXC	12	35
EMBANKMENT	3	1
TOPSOIL EXC	1	1

	STAGE 2A	STAGE 2B
EARTH EXC	24	51
EMBANKMENT	1	0
TOPSOIL EXC	2	0

	STAGE 2A	STAGE 2B
EARTH EXC	24	34
EMBANKMENT	20	0
TOPSOIL EXC	0	1

	STAGE 2A	STAGE 2B
EARTH EXC	23	82
EMBANKMENT	1	0
TOPSOIL EXC	2	0

	STAGE 2A	STAGE 2B
EARTH EXC	17	48
EMBANKMENT	10	0
TOPSOIL EXC	0	0

	STAGE 2A	STAGE 2B
EARTH EXC	19	43
EMBANKMENT	1	0
TOPSOIL EXC	1	1

REVISIONS	
NAME	DATE

ILLINOIS DEPARTMENT OF TRANSPORTATION
CROSS SECTIONS
 SHERIDAN ROAD

HORIZ. 1" = 10'
 VERT. 1" = 5'

SCALE IN FEET

DATE 7/13/07
 DRAWN BY LTD
 CHECKED BY BJL