

FAS ROUTE NO.	SEC	COUNTY	TOTAL SHEETS	SHEET NO.
-	*	DEKALB	21	9

ILLINOIS PROJECT BRS-1122(107)
 * 04-00206-00-BR
 CONTRACT NO. 87316

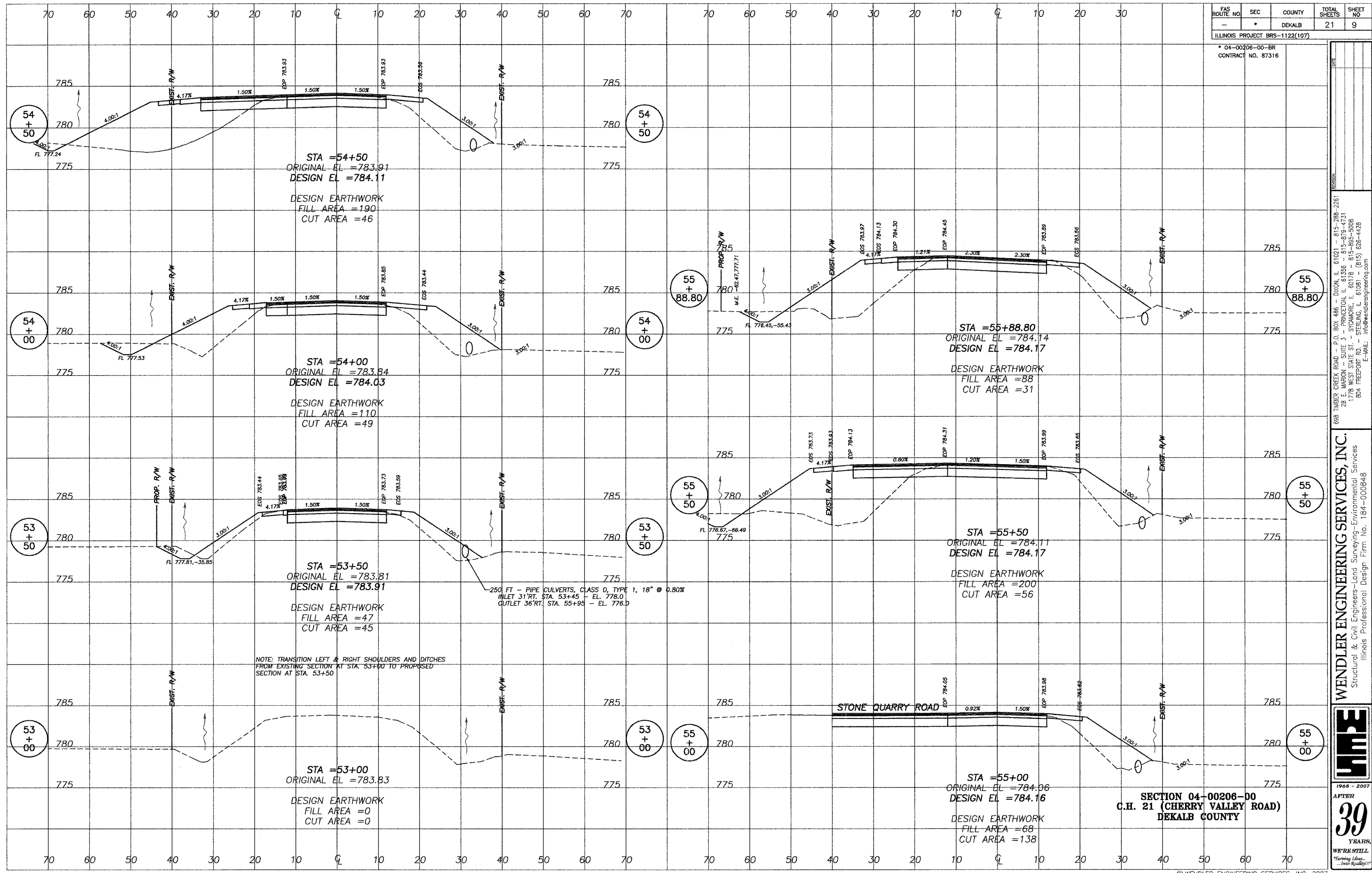

NOTE: TRANSITION LEFT & RIGHT SHOULDERS AND DITCHES FROM EXISTING SECTION AT STA. 53+00 TO PROPOSED SECTION AT STA. 53+50

250 FT - PIPE CULVERTS, CLASS D, TYPE 1, 18" @ 0.80%
 INLET 31' RT. STA. 53+45 - EL. 778.0
 OUTLET 36' RT. STA. 55+95 - EL. 776.0

SECTION 04-00206-00
 C.H. 21 (CHERRY VALLEY ROAD)
 DEKALB COUNTY

608 TIMBER CREEK ROAD - P.O. BOX 486 - DIXON, IL 61021 - 815-299-2261
 28 E. WAGON - SUITE 3 - PRINCETON, IL 61356 - 815-679-4731
 1778 WEST STATE ST. - SYCAMORE, IL 60178 - 815-885-5008
 804 FREEMONT RD. - STERLING, IL 61081 - (815) 626-4428
 E-MAIL: info@wendlerengineering.com

WENDLER ENGINEERING SERVICES, INC.
 Structural & Civil Engineers - Land Surveying - Environmental Services
 Illinois Professional Design Firm No. 184-000848



1968 - 2007
 AFTER
39
 YEARS.
 WE'RE STILL
 Turning Ideas...
 Into Reality!!!