

ROUTE NO.	SECTION	COUNTY	TOTAL SHEETS	SHEET NO.
TR 251	*	IROQUOIS	18	16
STA. 57+00.00 TO STA. 58+50.00				
FED. ROAD DIST. NO. 7	ILLINOIS	PROJECT BROS-075(130)	CONTRACT #873367	
* 98-26104-01-BR		* 98-26104-01-BR		

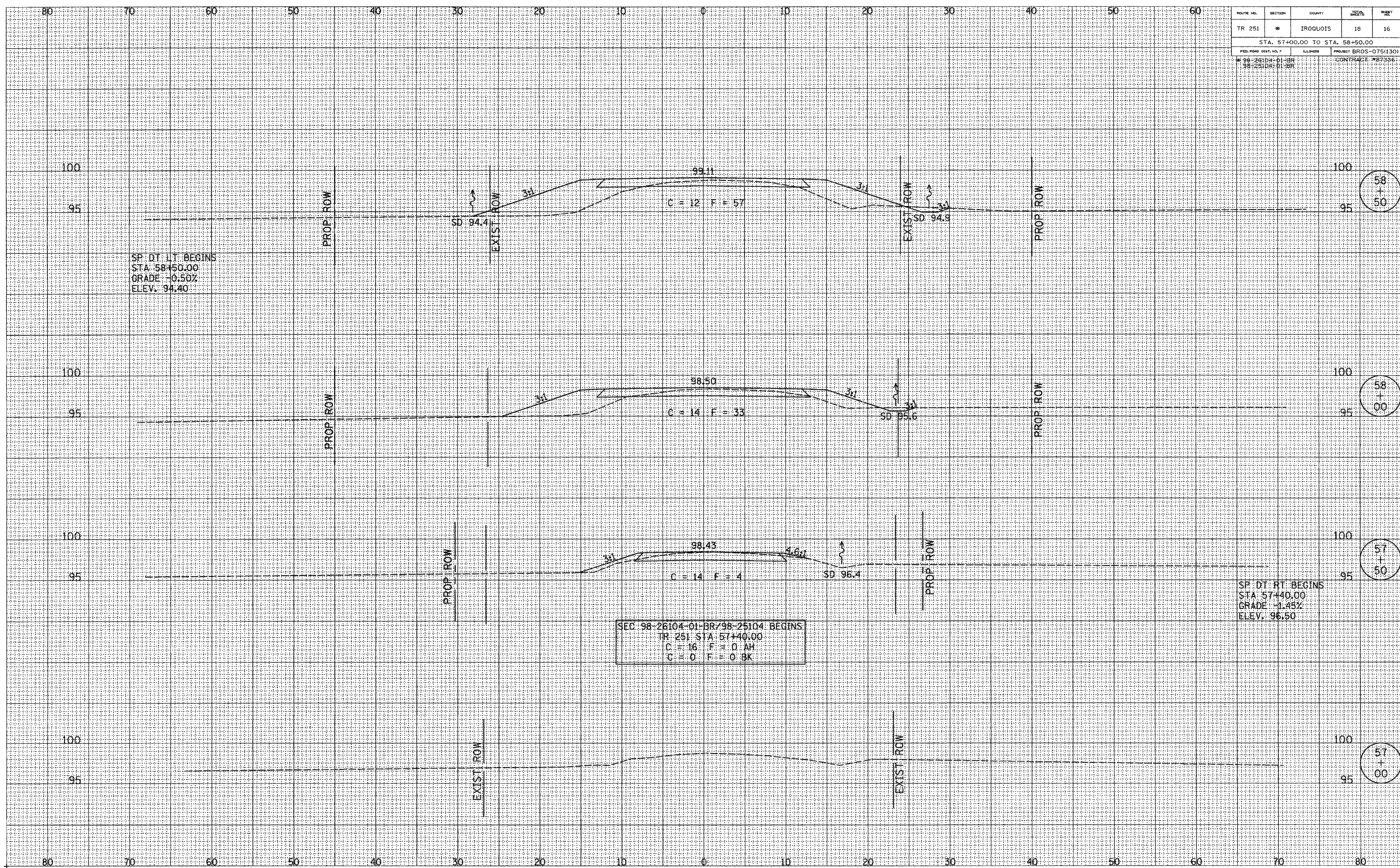

SP. DT. LT. BEGINS  
 STA. 58+50.00  
 GRADE -0.50%  
 ELEV. 94.40

SEC 98-26104-01-BR/98-25104 BEGINS  
 TR 251 STA. 57+40.00  
 C = 16 F = 0 AH  
 C = 0 F = 0 BK

SP. DT. RT. BEGINS  
 STA. 57+40.00  
 GRADE -1.45%  
 ELEV. 96.50

58  
+  
50

58  
+  
00

57  
+  
50

57  
+  
00

NOTE BOOK  
 TEMPLATE  
 AREAS  
 CHECKED

NOTE BOOK  
 TEMPLATE  
 AREAS  
 CHECKED