

F.A.U. RTE.	SECTION	COUNTY	TOTAL SHEETS	SHEET NO.
6711	00-00164-00-SP	TAZEWELL	80	42
STA. TO STA.		ILLINOIS FED. AID PROJECT		
FED. ROAD DIST. NO.				

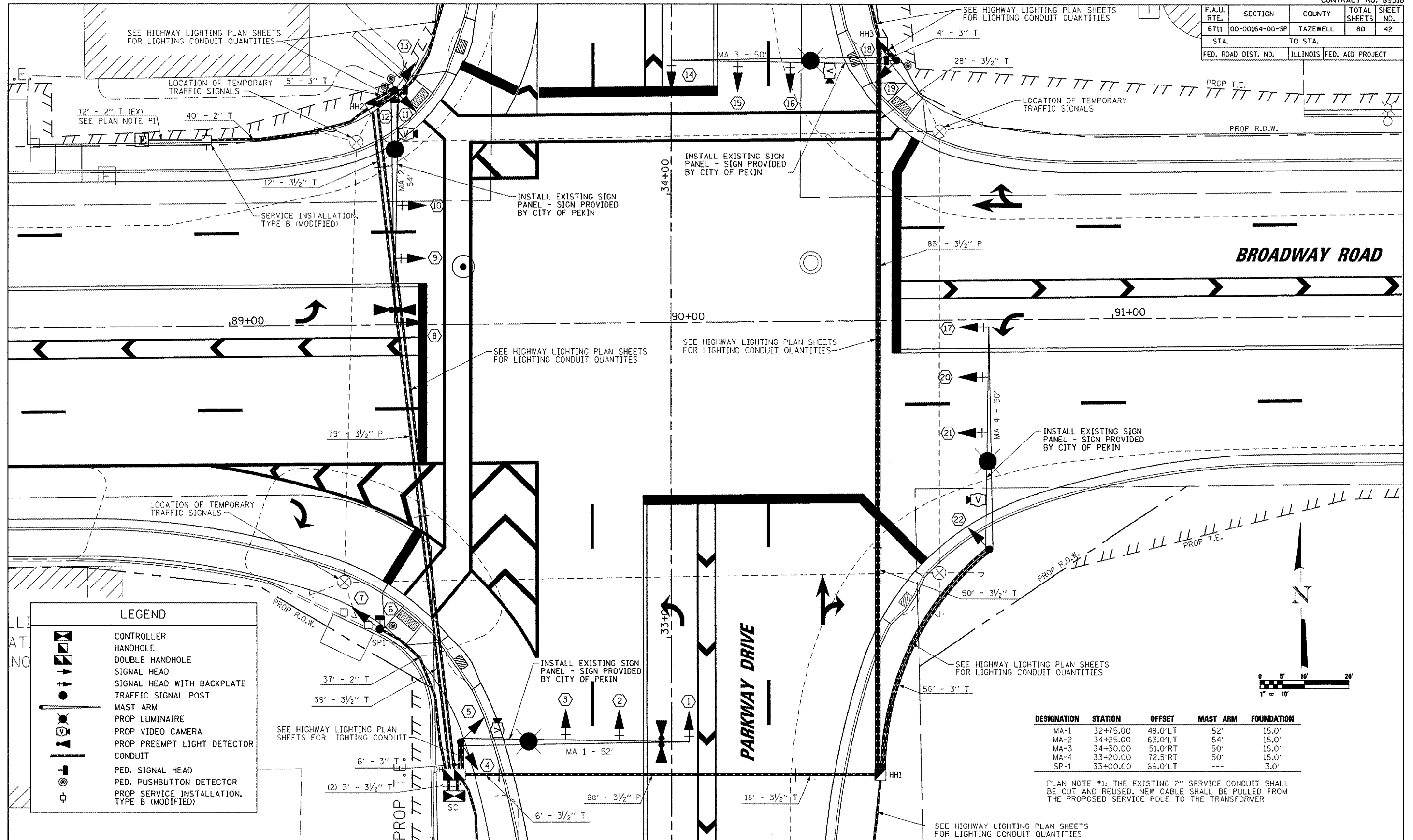

LEGEND

[Symbol]	CONTROLLER
[Symbol]	HANDHOLE
[Symbol]	DOUBLE HANDHOLE
[Symbol]	SIGNAL HEAD
[Symbol]	SIGNAL HEAD WITH BACKPLATE
[Symbol]	TRAFFIC SIGNAL POST
[Symbol]	MAST ARM
[Symbol]	PROP LUMINAIRE
[Symbol]	PROP VIDEO CAMERA
[Symbol]	PROP PREEMPT LIGHT DETECTOR
[Symbol]	CONDUIT
[Symbol]	PED. SIGNAL HEAD
[Symbol]	PED. PUSHBUTTON DETECTOR
[Symbol]	PROP SERVICE INSTALLATION, TYPE B (MODIFIED)

DESIGNATION	STATION	OFFSET	MAST ARM	FOUNDATION
MA-1	32+75.00	48.0'LT	52'	15.0'
MA-2	34+25.00	63.0'LT	54'	15.0'
MA-3	34+30.00	51.0'RT	50'	15.0'
MA-4	33+20.00	72.5'RT	50'	15.0'
SP-1	33+00.00	66.0'LT	---	3.0'

PLAN NOTE #1: THE EXISTING 2" SERVICE CONDUIT SHALL BE CUT AND REUSED, NEW CABLE SHALL BE PULLED FROM THE PROPOSED SERVICE POLE TO THE TRANSFORMER

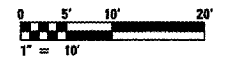

MAURER-STUTZ, INC. ENGINEERS