

F.A.U. RTE.	SECTION	COUNTY	TOTAL SHEETS	SHEET NO.
6711	00-00164-00-SP	TAZEWELL	80	44
STA. 26+80.00		TO STA. 31+00.00		
FED. ROAD DIST. NO.		ILLINOIS FED. AID PROJECT		

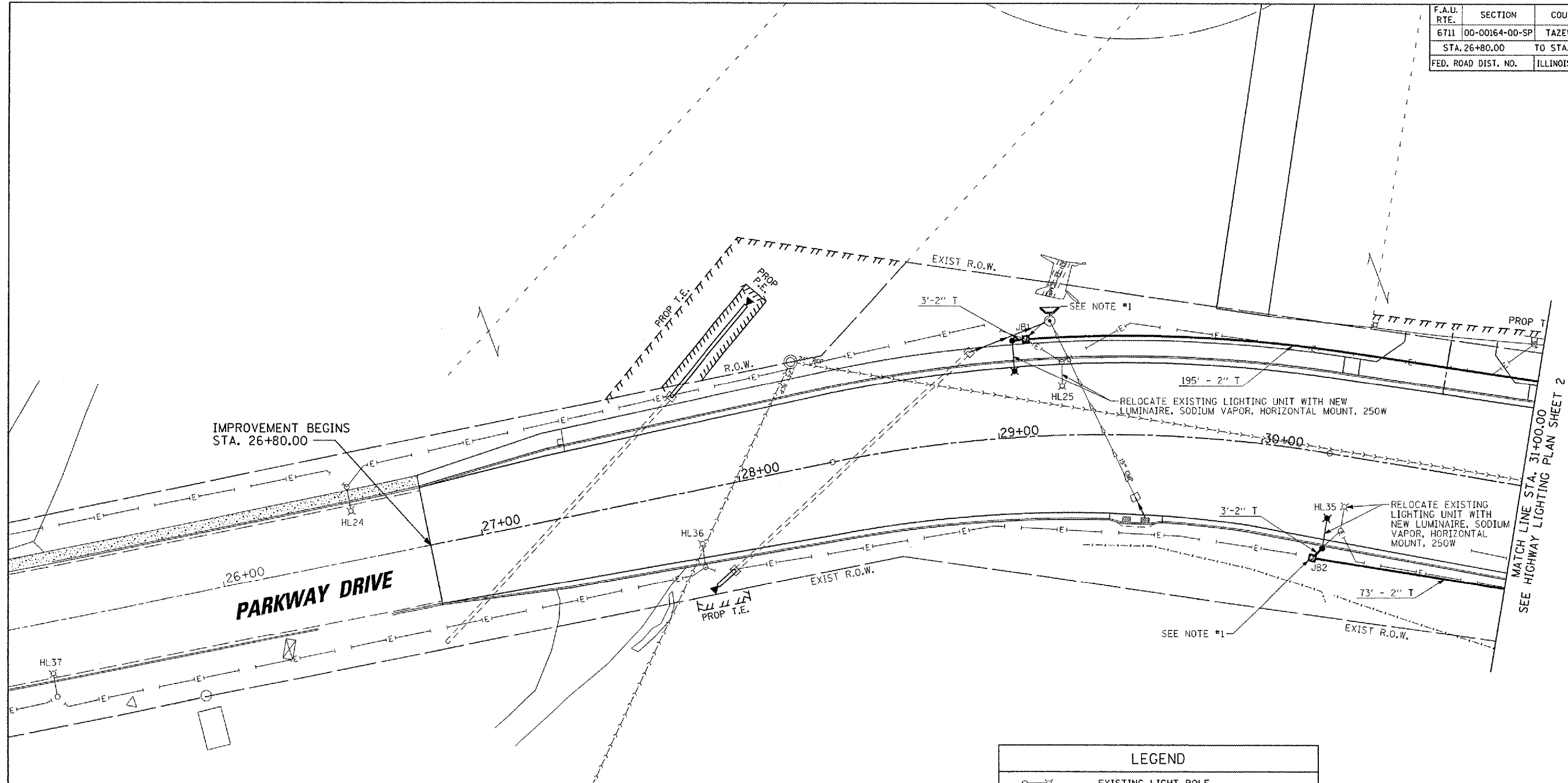

IMPROVEMENT BEGINS STA. 26+80.00

**PARKWAY DRIVE**

MATCH LINE STA. 31+00.00  
SEE HIGHWAY LIGHTING PLAN SHEET 2

LEGEND	
	EXISTING LIGHT POLE
	PROPOSED LIGHT POLE
	PROPOSED CONCRETE HANDHOLE (SPECIAL)
	PROPOSED CONDUIT

- PLAN NOTES:
- BUILD PROPOSED JUNCTION BOX (SPECIAL) OVER EXISTING CONDUIT. REMOVE CONDUIT WITHIN THE HANDHOLE, PULL EXISTING CABLE BACK, RE-USE AND REDIRECT TO RELOCATED POLE.
  - SEE SHEET 69 FOR LIGHT POLE RELOCATION DETAILS.

BILL OF MATERIALS		
ITEM	UNIT	QTY
JUNCTION BOX (SPECIAL)	EACH	2
RELOCATE EXISTING LIGHTING UNIT	EACH	2
CONDUIT IN TRENCH, 2" DIA, PVC	FOOT	274
TRENCH AND BACKFILL FOR ELECTRICAL WORK	FOOT	274
ELECTRICAL CABLE IN CONDUIT, 600 V (XLP-TYPE USE) 1/C NO. 6	FOOT	548
ELECTRIC CABLE IN CONDUIT, GROUND, NO. 6 1/C (GREEN)	FOOT	274

