

F.A.U. RTE.	SECTION #	COUNTY	TOTAL SHEETS	SHEET NO.
05-00444-00-BR		SANGAMON	33	7
STA.	TO STA.			
FED. ROAD DIST. NO.	ILLINOIS	FED. AID PROJECT		
			CITY OF SPRINGFIELD SHEET 1 OF 24 SHEETS	

Bench Mark "A":
Set chisled "A" on first pier North end of bridge East side.
Elev. 542.56

Existing Structure:
S.N. 084-3040 built in 1963 as FAS 1639, Sec. 101-2 212-1CS at Sta. 115+77.50 as a 4-span prestressed concrete box beam structure 145'-0" Bk. to Bk. w/pile bent piers and abutments.

Proposed Structure:
Existing bridge to be removed and replaced with a three span wide flange beam and concrete deck bridge on integral abutments and concrete encased pile bent piers.
Traffic to be maintained utilizing staged construction.
Staged Removal
No Salvage

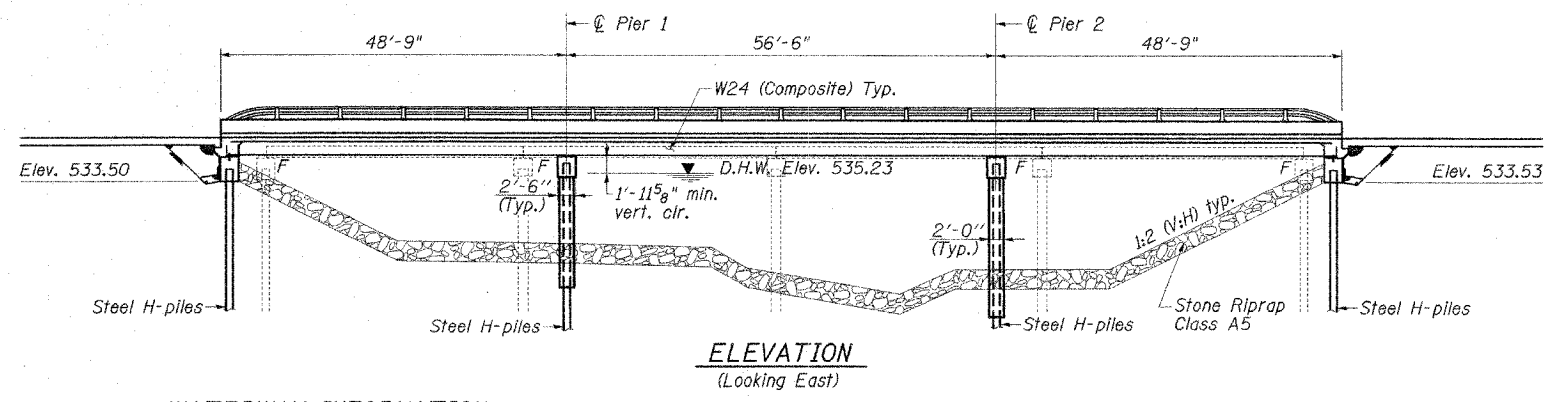
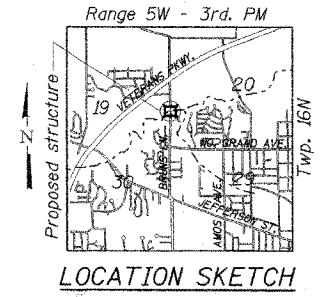

WATERWAY INFORMATION

Drainage Area = 107.65 sq. mi.		Exist. Low Grade Elev. 539.93 ft. @ Sta. 115+05.0							
		Prop. Low Grade Elev. 540.47 ft. @ Sta. 115+03.5							
Flood Yr.	Q C.F.S.	Opening Sq. Ft. Exist.	Prop.	Nat. H.W.E. Exist.	Prop.	Head - Ft. Exist.	Prop.	Headwater El. Exist.	Prop.
Design	30	5841.1	1213.0	1224.1	535.23	0.18	0.15	535.41	535.38
Base	100	7647.1	1358.7	1373.9	536.43	0.30	0.25	536.73	536.68
Overtopping									
Max. Calc.	500	9964.7	1554.2	1562.1	537.95	0.99	0.85	538.94	538.80

DESIGN SPECIFICATIONS

2004 AASHTO LRFD w/Interims thru 2006

DESIGN STRESSES

FIELD UNITS
f'c = 3,500 psi
fy = 60,000 psi (reinforcement)
fy = 50,000 psi (M270 Grade 50W)

SEISMIC DATA

Seismic Performance Zone (SPZ) = 1
Bedrock Acceleration Coefficient (A) = 0.04g
Site Coefficient (S) = 1.5

LOADING HL-93

Allow 50 psf for future wearing surface.

NAME PLATE
See Std. 515001

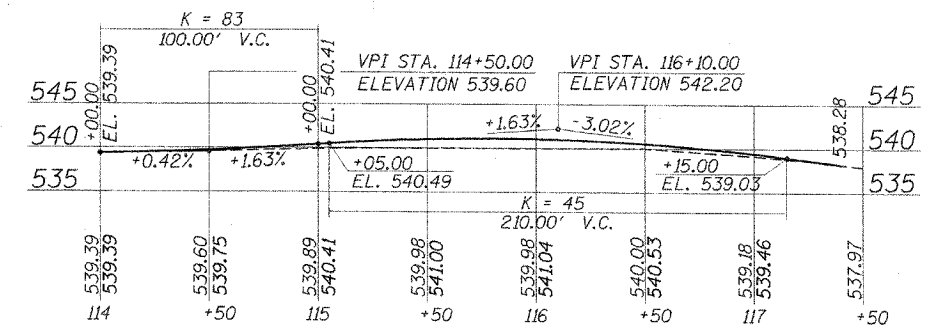
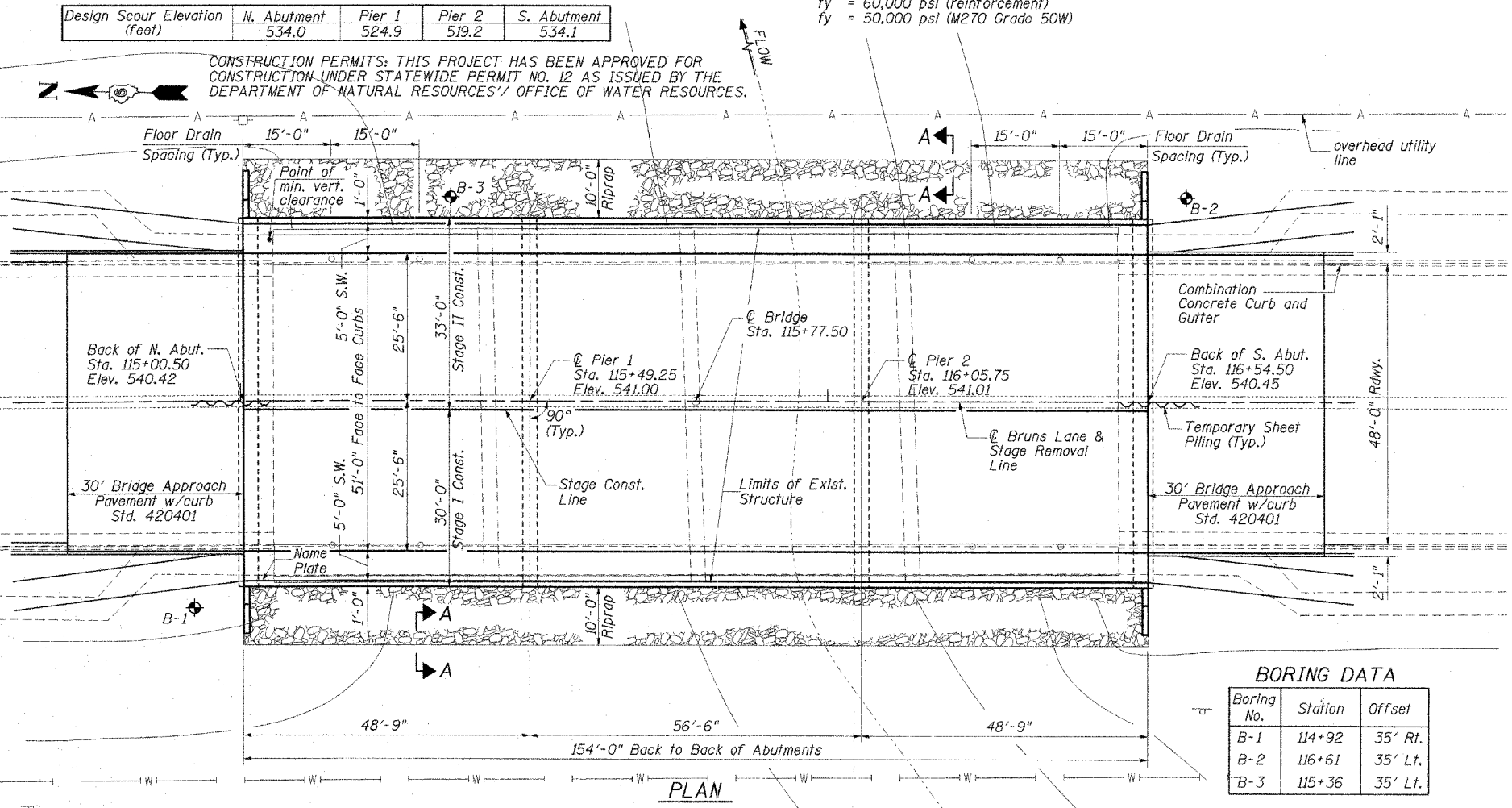

I certify that to the best of my knowledge, information and belief, that this bridge design is structurally adequate for the design loading shown on the plans. The design is an economical one for the style of structure and complies with requirements of the current "AASHTO LRFD Bridge Design Specifications."

Waleed Khalid, S.E.
Illinois Licensed Structural Engineer
License Number: 081-006374
Expiration Date: November 30, 2008



NOTES:

1. See Sheet 2 of 24 for Section A-A.

BORING DATA

Boring No.	Station	Offset
B-1	114+92	35' Rt.
B-2	116+61	35' Lt.
B-3	115+36	35' Lt.

REVISIONS	
NAME	DATE

CITY OF SPRINGFIELD, ILLINOIS
GENERAL PLAN & ELEVATION
FAU 8006-BRUNS LANE OVER SPRING CREEK
SECTION 05-00444-00-BR
SANGAMON COUNTY
STATION 115+77.50 S.N. 084-6017
SCALE: NONE DRAWN BY: GLD
DATE: 6/19/07 CHECKED BY: WK

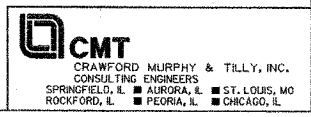

L:\SPR\Proj\0502503\Draw\Sheet\GENERAL PLAN & ELEV.dgn 6/22/07