

MUNICIPALITY	SECTION	COUNTY	TOTAL SHEETS	SHEET NO.
QUINCY	06-00300-00-LS	ADAMS	69	66

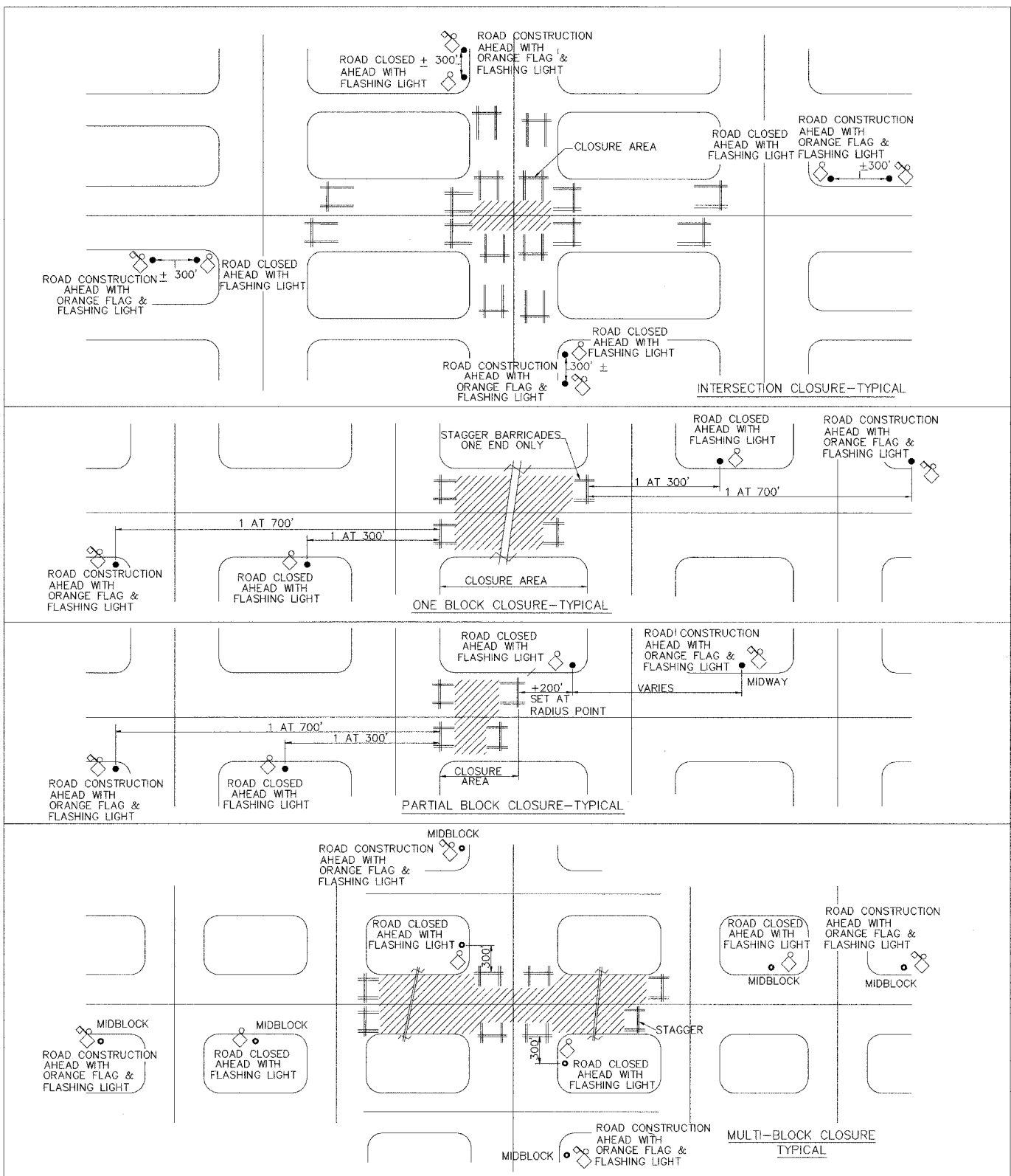

- NOTES**
1. TYPE A LOW INTENSITY FLASHING LIGHT ONE ABOVE EACH APPROACH BARRICADE.
 2. MOUNT R11-2 "ROAD CLOSED" ON ONE TYPE III BARRICADE EACH CLOSED APPROACH.
 3. MOUNT R11-4 "ROAD CLOSED TO THRU TRAFFIC" ON ONE TYPE III BARRICADE EACH STAGGERED APPROACH.
 4. REFER TO STANDARD 702001 FOR BARRICADE AND POSITIONING DETAILS.
 5. ALL WARNING SIGNS-BLACK LEGEND ON ORANGE REFLECTORIZED BACK GROUND - 48" x 48"
 6. TYPE III BARRICADE. EXACT NUMBER REQUIRED TO BE DETERMINED BY ENGINEER IN FIELD.
 7. POST MOUNT SIGNS IF CLOSURE EXCEEDS FOUR (4) DAYS.
 8. DIMENSIONS MAY BE VARIED DUE TO SIGHT CONDITIONS, TOPOGRAPHY, AND URBAN LANDSCAPE.
 9. ORANGE FLAG - MINIMUM 18"X18"
 10. FOR CLOSURES ON ONE WAY STREETS, PLACE FOUR WARNING SIGNS AT GIVEN DISTANCES ON APPROACH SIDE ONLY.
 11. ENGINEER TO DETERMINE WHICH APPROACH TO STAGGER BARRICADES.
- TRAFFIC CONTROL AND PROTECTION (SPECIAL)**
- JUNE 99

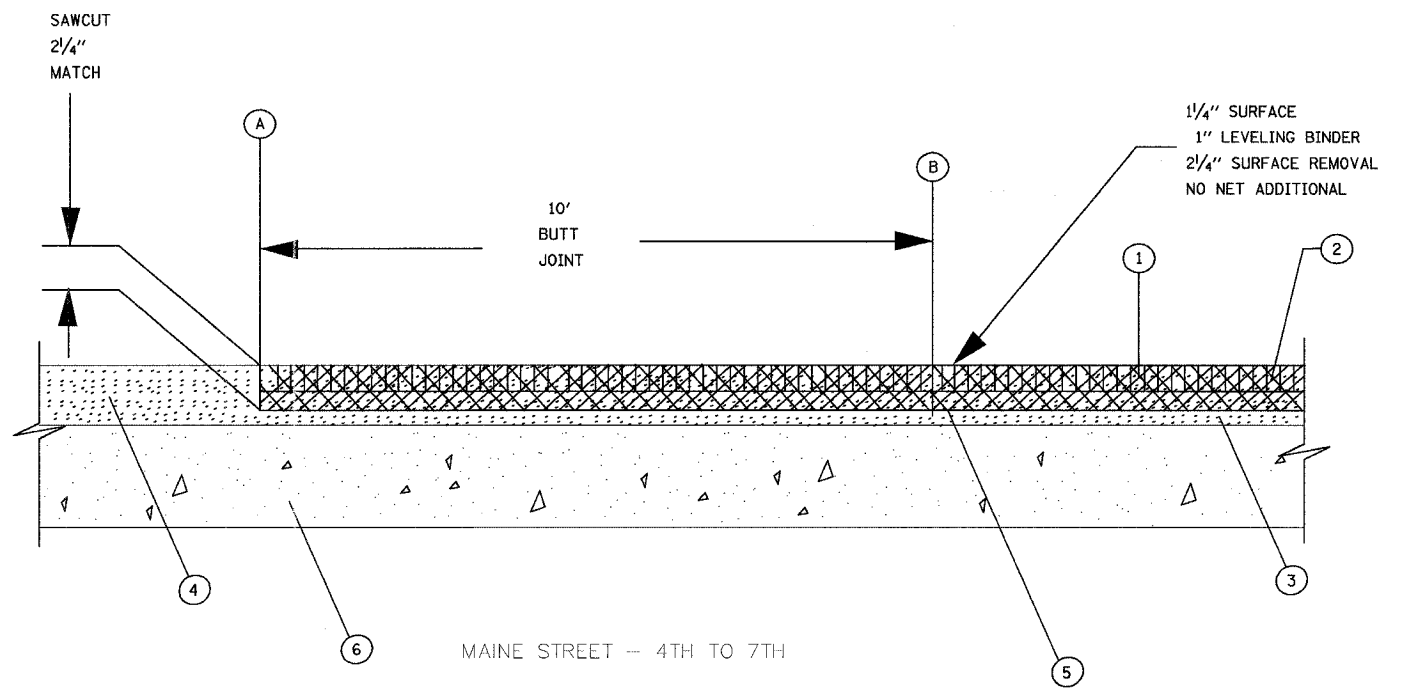

1. PROPOSED BITUMINOUS SURFACE COURSE
2. PROPOSED BITUMINOUS LEVELING BINDER
3. PROPOSED BITUMINOUS SURFACE REMOVAL (VARIABLE DEPTH)
4. EXISTING BITUMINOUS CONCRETE OVERLAY
5. PROPOSED BITUMINOUS SURFACE REMOVAL - BUTT JOINT
6. EXISTING CONCRETE PAVEMENT

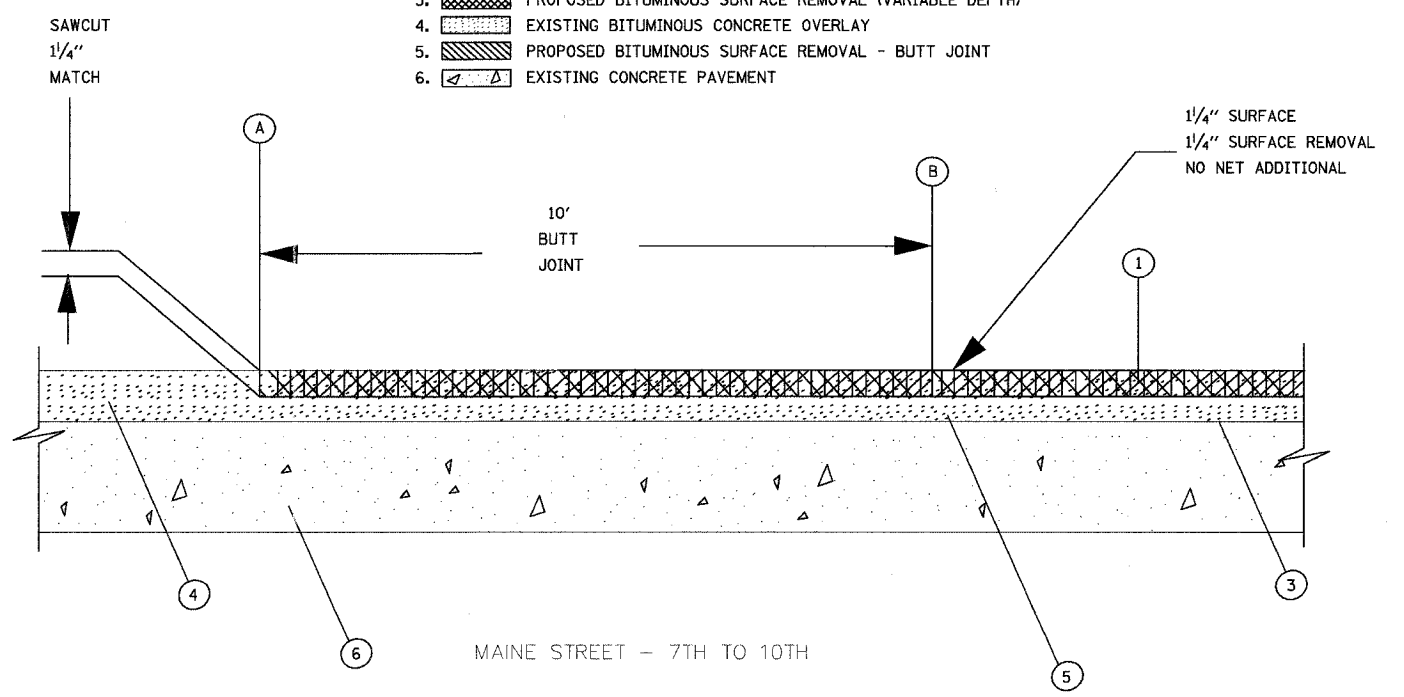

HOT-MIX ASPHALT SURFACE REMOVAL - BUTT JOINT - GENERAL DETAIL