

ROUTE NO.	SECTION	COUNTY	SHEET	TOTAL
	#	CRAWFORD	9	3
FED. ROAD DIST. NO. 7		ILLINOIS	FED. AID PROJECT	

* 05-07129-00-8R

-D.M.-
-Existing Structure-
-Salvage-

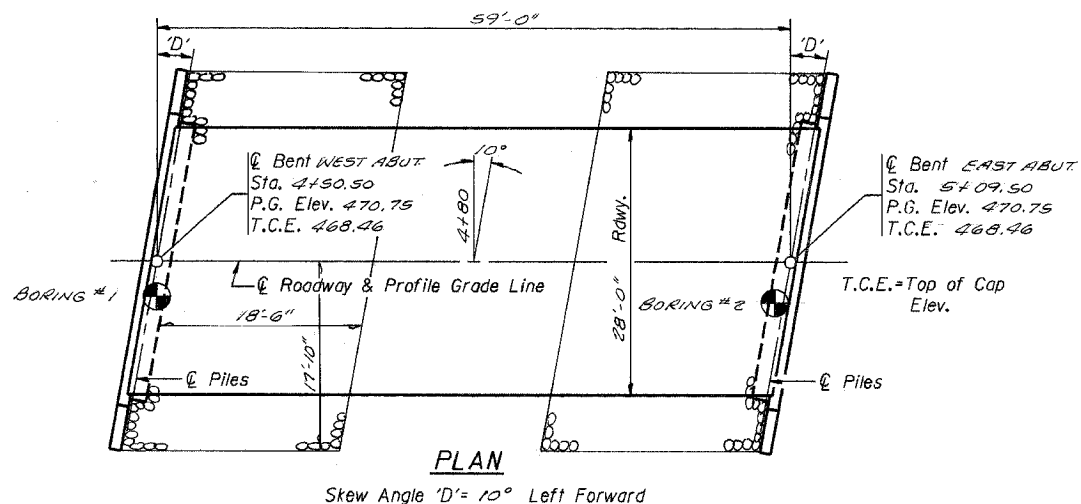
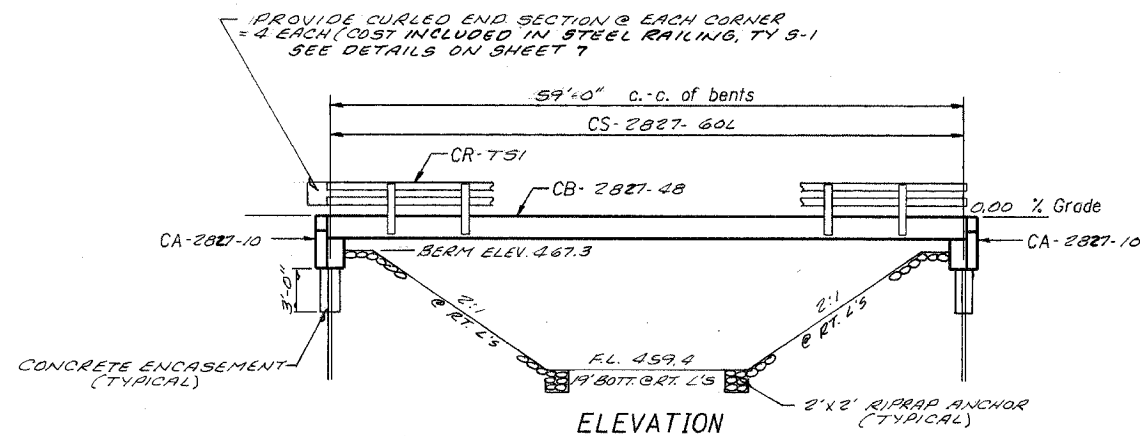

STONE DUMPED RIPRAP CL. A4
12" MINIMUM THICKNESS = 90 TON

GENERAL NOTES

1. The Contractor shall drive 1 test piles, as specified, in a permanent location as directed by the Engineer before ordering the remaining piles.
2. See Special Provisions for boring logs.
3. A Corrosion inhibitor, as covered in the Special Provisions, shall be used in the concrete for precast prestressed concrete deck beams.

TOTAL BILL OF MATERIAL

Item	Unit	Super	Sub.		Total
			Piers	Abuts.	
Removal of Existing Structures	Each				1
Bituminous Concrete Surface Course, Superpave	Ton				
Waterproofing Membrane System	Sq. Yd.				
Concrete Structures	Cu. Yd.			20.8	20.8
Precast Prestressed Concrete Deck Beams (27" Depth)	Sq. Ft.	1680			1680
Steel Bridge Rail, Type SM	Foot				
Steel Railing, Type S-1	Foot	120			120
Reinforcement Bars	Pound			2580	2580
Furnishing STEEL PILES HP 10 X 42	Foot			378	378
Driving PILES	Foot			378	378
Test Piles STEEL HP 10 X 42	Each			1	1
Name Plates	Each			1	1
Concrete Encasement	Cu. Yd.			2.6	2.6
Portland Cement Mortar Fairing Course	Foot				
STONE DUMPED RIPRAP CL. A4	TON			90	90

DESIGN SPECIFICATIONS
2002 AASHTO Standard Specifications - 17th ed.

LOADING HS20-44
Allow 25#/sq. ft. for future wearing surface.

SEISMIC DATA
Seismic Performance Category (SPC) =
Bedrock Acceleration Coefficient (A) =
Site Coefficient (S) =

PILE DATA (2- ABUTS.)
Type STEEL HP 10 X 42
NOMINAL REQUIRED BEARING = 335 KIPS
Estimated Length 42 Feet
Number Required 10 (Includes 1 Test Pile located in Bent #1) W. ABUT.
ALLOWABLE RESISTANCE AVAILABLE = 112 KIPS

STATION 4+80
LITTLE CREEK
SEC. 05-07129-00-8R BUILT 20
PROJECT NO. BR05-033(A?)
CRAWFORD COUNTY
LOADING HS20
STR. NO. 017-3752

LETTERING FOR NAME PLATE
Locate Name Plate at S.W. Corner of Bridge (See Std. CN)

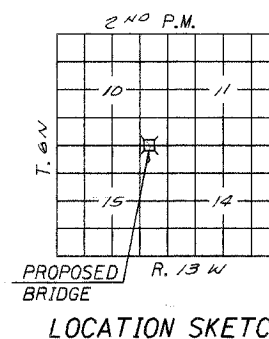

WATERWAY INFORMATION

Drainage Area = 7.14 SQ. MI. Low Grade Elev. = 470.75 @ Sta. 4+80

Flood	Freq. Yr.	Q		Nat. H.W.E.	Head - Ft.		Headwater El.	
		Exist.	Prop.		Exist.	Prop.	Exist.	Prop.
Design	15	1134	BR 108 APP 7	467.3	0.6	0.3	467.9	467.6
Base	100	1787	BR 198 APP 113	467.9	0.6	0.7	468.5	468.6
Overtopping								
Max. Calc.	500	2310		468.3		1.2		469.5

INDEX OF SHEETS

1. General Plan & Elevation
2. Standard CS - 2827 - 60L
3. Standard CB - 2827 - 48
4. Standard CA - 2827 - 10
5. Standard CR - 751
6. Standard CN
7. Standard CX - 1
8. Standard
9. Standard

GENERAL PLAN & ELEVATION
T.R. ROUTE 199
OVER LITTLE CREEK
SECTION 05-07129-00-8R
CRAWFORD COUNTY
STATION 4+80