

F.A. RTE.	SECTION	COUNTY	TOTAL SHEETS	SHEET NO.
57/64	(41-3)HBK	JEFFERSON	518	110
STA.	TO STA.			
FED. ROAD DIST. NO.	ILLINOIS FED. AID PROJECT			

DATE	BY
DATE	BY
DATE	BY

DATE	BY
DATE	BY
DATE	BY

PLOT DATE = 8/21/2007 6:01:3 AM
 FILE NAME = I:\98963\98963\DOT\84963\98963\84963.PCS2
 USER NAME = hts

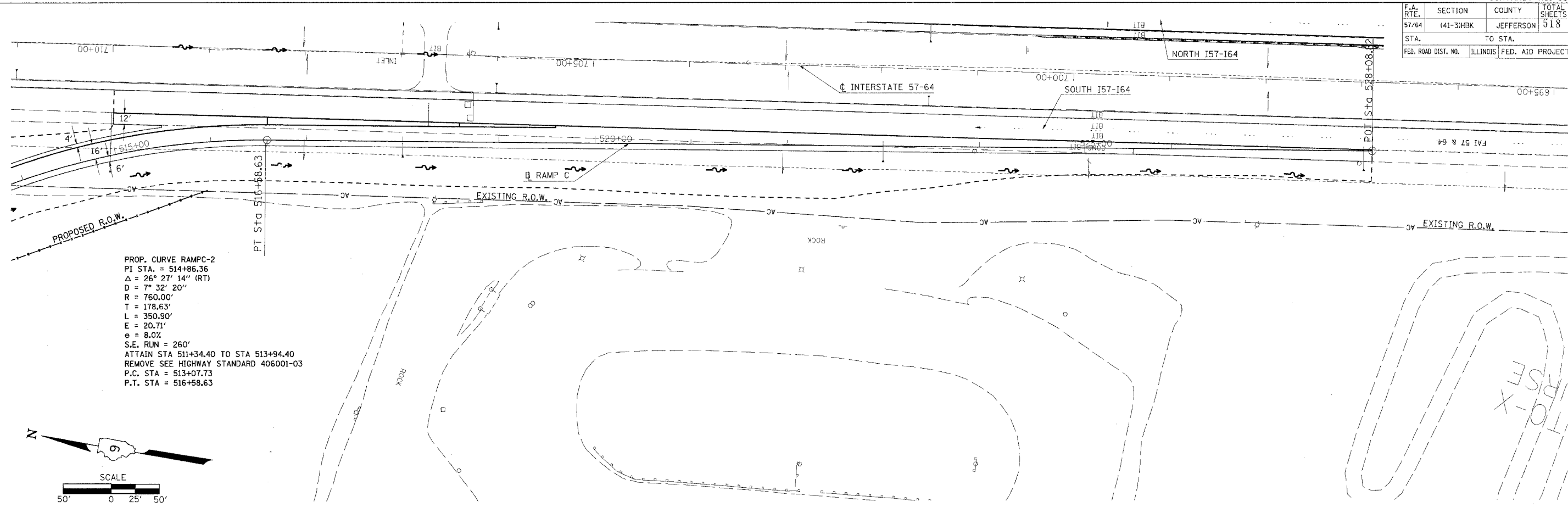

PROP. CURVE RAMP-2
 PI STA. = 514+86.36
 $\Delta = 26^\circ 27' 14''$ (RT)
 $D = 7^\circ 32' 20''$
 $R = 760.00'$
 $T = 178.63'$
 $L = 350.90'$
 $E = 20.71'$
 $\theta = 8.0\%$
 $S.E. RUN = 260'$
 ATTAIN STA 511+34.40 TO STA 513+94.40
 REMOVE SEE HIGHWAY STANDARD 406001-03
 P.C. STA = 513+07.73
 P.T. STA = 516+58.63

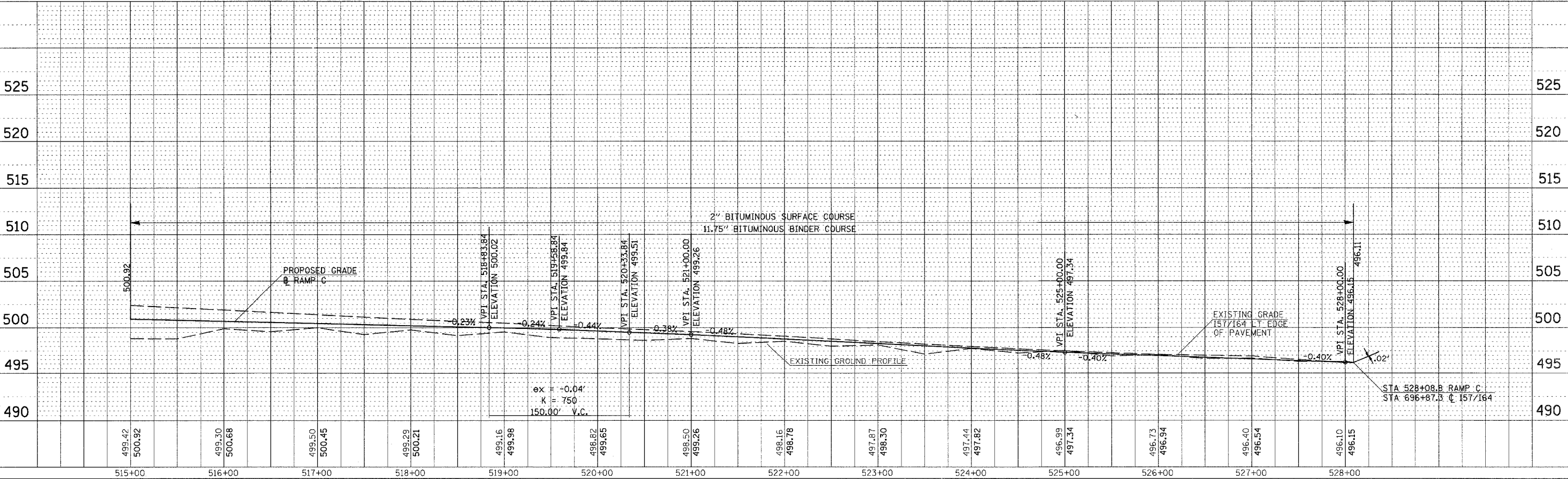
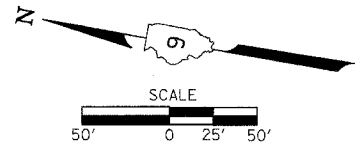

PLAN PROFILE RAMP C