

F.A.I. RTE.	SECTION	COUNTY	TOTAL SHEETS	SHEET NO.
57/64	(41-3)HBK	JEFFERSON	518	134
STA. 10+00.00		TO STA. 11+56.23		
FED. ROAD DIST. NO.	ILLINOIS FED. AID PROJECT			CONTRACT NO. 98963

COORDINATE TABLE

☉ PROPOSED OUTLET DITCH

PNT	CURVE NAME	STATION	NORTHING	EASTING
POT		10+00.00	594607.015	809586.576
PI		11+56.23	594760.374	809556.745
POT		12+57.15	594860.222	809571.425

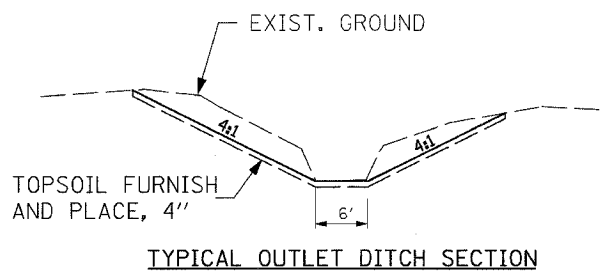
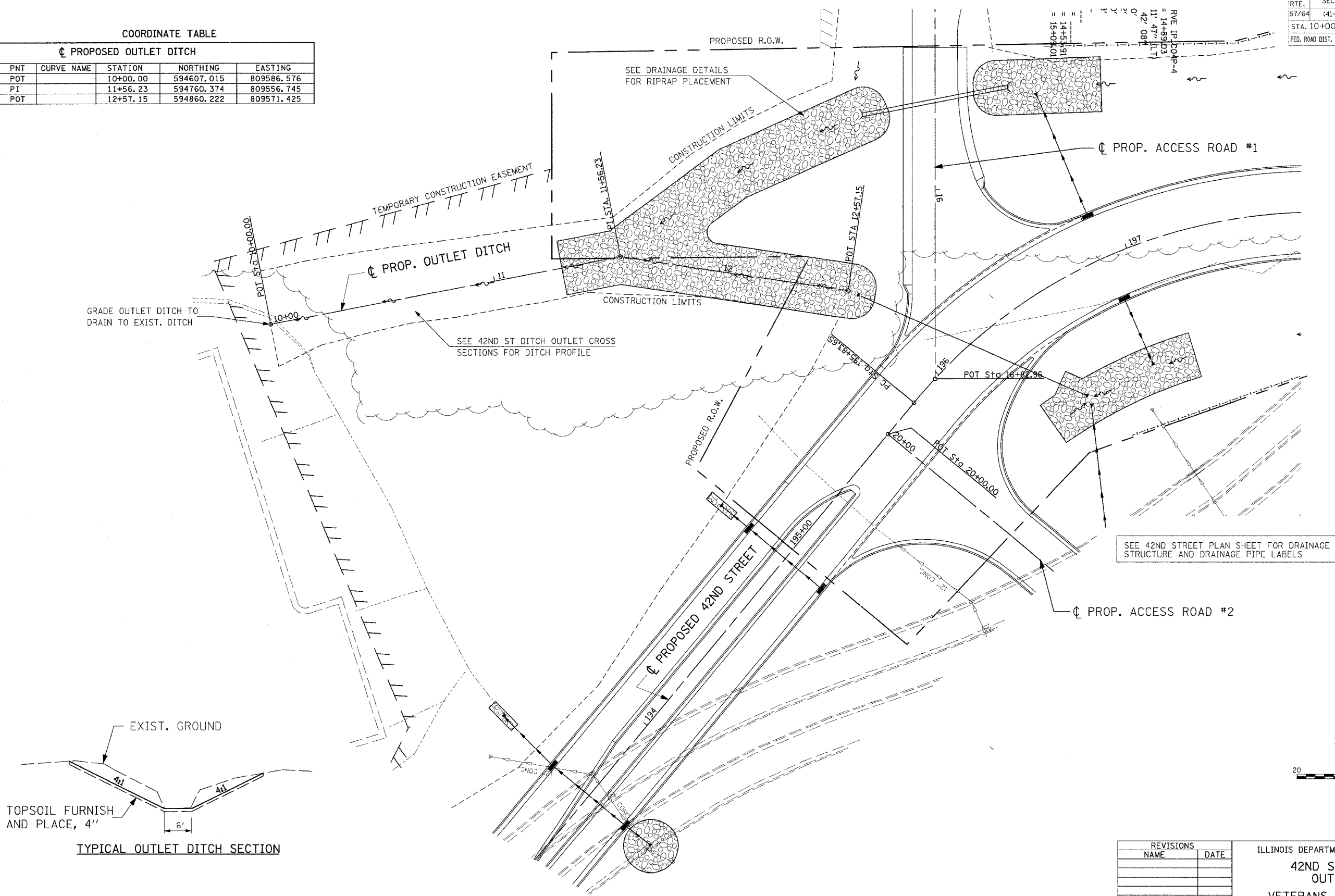

REVISIONS	
NAME	DATE

ILLINOIS DEPARTMENT OF TRANSPORTATION
**42ND STREET DITCH
 OUTLET PLAN**
 VETERANS MEMORIAL DRIVE
 INTERCHANGE
 SECTION (41-3)HBK

SCALE: DATE 3-22-07

DRAWN BY RLT
 CHECKED BY MTM

Copyright, Hanson Professional Services Inc. 2007
HANSON
 Hanson Professional Services Inc.

03/21/2007, 08:32 AM
 I:\98\jobs\98s20\9a\Road\Sheet\c701.dwg
 LAYOUT: RLT 02/26/04
 DRAWN: JED 04/12/04
 REVIEWED: MTM 03/22/07