

F.A.I. RTE.	SECTION	COUNTY	TOTAL SHEETS	SHEET NO.
57/64	(41-3)HBK	JEFFERSON	518	136
STA.	TO STA.			
FED. ROAD DIST. NO.	ILLINOIS	FED. AID PROJECT		
CONTRACT NO. 98963				

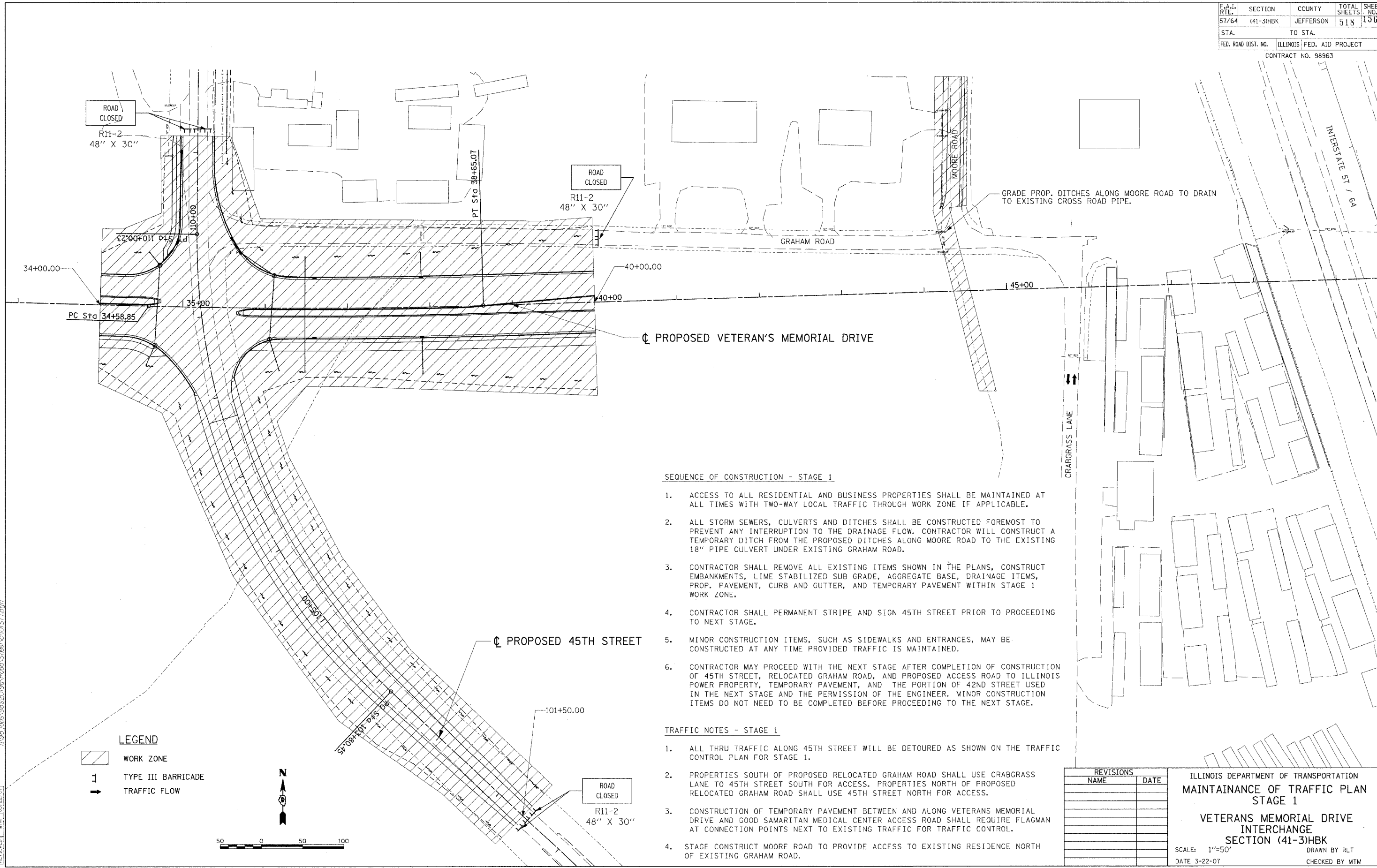

© Copyright Hanson Professional Services Inc. 2007  
**HANSON**  
 Hanson Professional Services Inc.

03/22/2007 03:42 PM  
 A:\98 Jobs\98s\0190\Road\Sheet\AC-101ST1.dgn

LAYOUT	RLT	02/26/04
DRAWN	JED	04/12/04
REVIEWED	MTM	03/22/07

**LEGEND**

	WORK ZONE
	TYPE III BARRICADE
	TRAFFIC FLOW

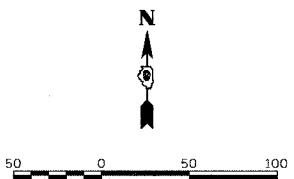

**SEQUENCE OF CONSTRUCTION - STAGE 1**

- ACCESS TO ALL RESIDENTIAL AND BUSINESS PROPERTIES SHALL BE MAINTAINED AT ALL TIMES WITH TWO-WAY LOCAL TRAFFIC THROUGH WORK ZONE IF APPLICABLE.
- ALL STORM SEWERS, CULVERTS AND DITCHES SHALL BE CONSTRUCTED FOREMOST TO PREVENT ANY INTERRUPTION TO THE DRAINAGE FLOW. CONTRACTOR WILL CONSTRUCT A TEMPORARY DITCH FROM THE PROPOSED DITCHES ALONG MOORE ROAD TO THE EXISTING 18" PIPE CULVERT UNDER EXISTING GRAHAM ROAD.
- CONTRACTOR SHALL REMOVE ALL EXISTING ITEMS SHOWN IN THE PLANS, CONSTRUCT EMBANKMENTS, LIME STABILIZED SUB GRADE, AGGREGATE BASE, DRAINAGE ITEMS, PROP. PAVEMENT, CURB AND GUTTER, AND TEMPORARY PAVEMENT WITHIN STAGE 1 WORK ZONE.
- CONTRACTOR SHALL PERMANENT STRIPE AND SIGN 45TH STREET PRIOR TO PROCEEDING TO NEXT STAGE.
- MINOR CONSTRUCTION ITEMS, SUCH AS SIDEWALKS AND ENTRANCES, MAY BE CONSTRUCTED AT ANY TIME PROVIDED TRAFFIC IS MAINTAINED.
- CONTRACTOR MAY PROCEED WITH THE NEXT STAGE AFTER COMPLETION OF CONSTRUCTION OF 45TH STREET, RELOCATED GRAHAM ROAD, AND PROPOSED ACCESS ROAD TO ILLINOIS POWER PROPERTY, TEMPORARY PAVEMENT, AND THE PORTION OF 42ND STREET USED IN THE NEXT STAGE AND THE PERMISSION OF THE ENGINEER. MINOR CONSTRUCTION ITEMS DO NOT NEED TO BE COMPLETED BEFORE PROCEEDING TO THE NEXT STAGE.

**TRAFFIC NOTES - STAGE 1**

- ALL THRU TRAFFIC ALONG 45TH STREET WILL BE DETOURED AS SHOWN ON THE TRAFFIC CONTROL PLAN FOR STAGE 1.
- PROPERTIES SOUTH OF PROPOSED RELOCATED GRAHAM ROAD SHALL USE CRABGRASS LANE TO 45TH STREET SOUTH FOR ACCESS. PROPERTIES NORTH OF PROPOSED RELOCATED GRAHAM ROAD SHALL USE 45TH STREET NORTH FOR ACCESS.
- CONSTRUCTION OF TEMPORARY PAVEMENT BETWEEN AND ALONG VETERANS MEMORIAL DRIVE AND GOOD SAMARITAN MEDICAL CENTER ACCESS ROAD SHALL REQUIRE FLAGMAN AT CONNECTION POINTS NEXT TO EXISTING TRAFFIC FOR TRAFFIC CONTROL.
- STAGE CONSTRUCT MOORE ROAD TO PROVIDE ACCESS TO EXISTING RESIDENCE NORTH OF EXISTING GRAHAM ROAD.

REVISIONS	
NAME	DATE

ILLINOIS DEPARTMENT OF TRANSPORTATION  
**MAINTAINANCE OF TRAFFIC PLAN**  
**STAGE 1**  
**VETERANS MEMORIAL DRIVE**  
**INTERCHANGE**  
**SECTION (41-3)HBK**  
 SCALE: 1"=50'  
 DATE 3-22-07  
 DRAWN BY RLT  
 CHECKED BY MTM