

LAYOUT	RLT	02/26/04
DRAWN	JED	04/12/04
REVIEWED	MTM	01/22/07

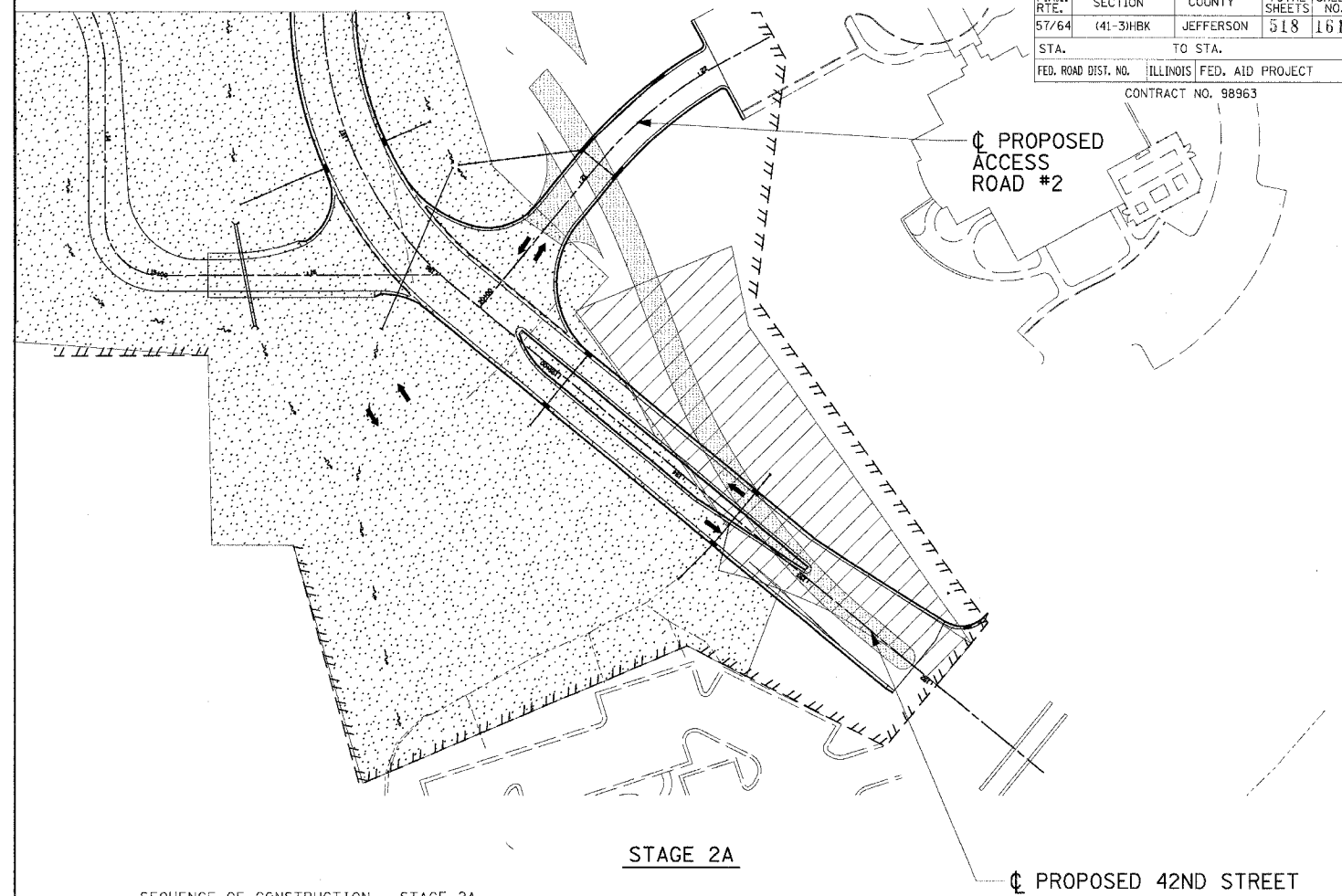
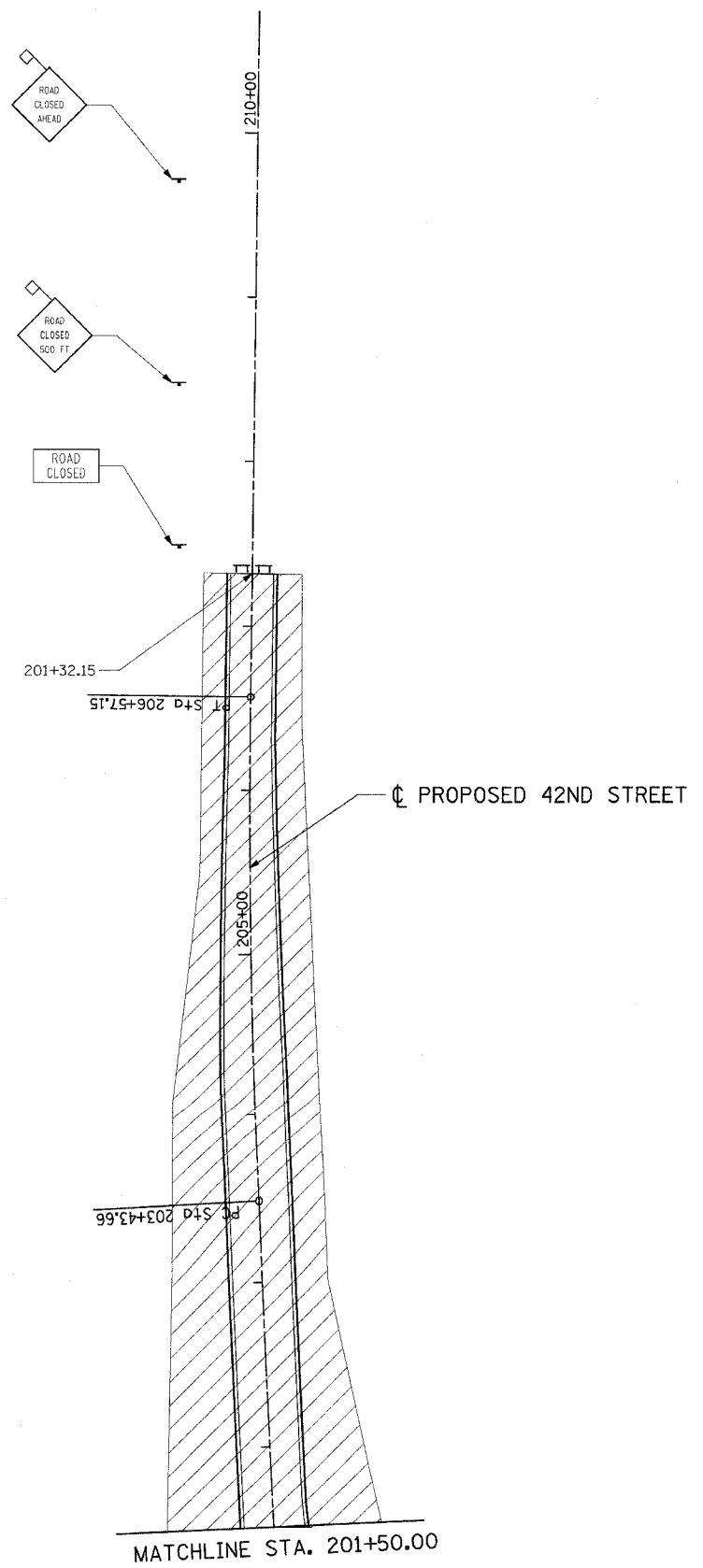

F.A.I. RTE.	SECTION	COUNTY	TOTAL SHEETS	SHEET NO.
57/64	(41-3)HBK	JEFFERSON	518	161
STA.		TO STA.		
FED. ROAD DIST. NO.		ILLINOIS	FED. AID PROJECT	
CONTRACT NO. 98963				

SEQUENCE OF CONSTRUCTION - STAGE 2A

1. ACCESS TO ALL RESIDENTIAL AND BUSINESS PROPERTIES SHALL BE MAINTAINED AT ALL TIMES WITH TWO-WAY LOCAL TRAFFIC THROUGH WORK ZONE IF APPLICABLE
2. COMPLETE CONSTRUCTION OF 42ND STREET NORTH BOUND LANE TO GOOD SAMARITAN MEDICAL CENTER.
3. REMOVE THE REMAINDER OF THE EXISTING ENTRANCE ROAD TO GOOD SAMARITAN MEDICAL CENTER.
4. CONSTRUCT EMBANKMENT, SUB GRADE, AGGREGATE BASE, DRAINAGE ITEMS FOR ACCESS RD. #2

TRAFFIC NOTES - STAGE 2A

1. 42ND STREET INTERSECTION WILL BE COMPLETED AND READY TO OPEN PRIOR TO CLOSING OF THE EXISTING GOOD SAMARITAN ENTRANCE. VETERANS MEMORIAL DRIVE WEST OF 42ND STREET WILL REMAIN CLOSED THRU THE REMAINDER OF CONSTRUCTION.
2. TRAFFIC TO AND FROM GOOD SAMARITAN MEDICAL CENTER AND ILLINOIS POWER SHALL USE COMPLETED 42ND STREET.
3. TRAFFIC FOR THE COMPLETION OF THE REMAINING NORTH BOUND LANE OF 42ND STREET, SOUTH OF VETERANS MEMORIAL DRIVE, SHALL USE THE SOUTH BOUND LANE WITH FLAGMAN UNDER DAY TIME OPERATIONS. THE NORTH BOUND LANE WILL BE OPEN TEMPORARILY FOR NIGHT AND WEEKEND OPERATIONS.

LEGEND

- WORK ZONE
- TYPE III BARRICADE
- TRAFFIC FLOW
- COMPLETED WORK
- TEMPORARY PAVEMENT

REVISIONS	
NAME	DATE

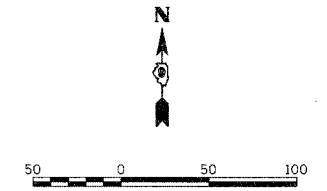

ILLINOIS DEPARTMENT OF TRANSPORTATION
 MAINTENANCE OF TRAFFIC PLAN
 STAGE 2 & STAGE 2A
 VETERANS MEMORIAL DRIVE
 INTERCHANGE
 SECTION (41-3)HBK
 SCALE: 1"=50'
 DATE 3-22-07
 DRAWN BY RLT
 CHECKED BY MTM