

F.A.I. RTE.	SECTION	COUNTY	TOTAL SHEETS	SHEET NO.
57/64	41-3/HBK	JEFFERSON	518	172
STA.		TO STA.		
FED. ROAD DIST. NO.		ILLINOIS	FED. AID PROJECT	

LEGEND

- DRUM WITH STEADY BURNING LIGHT
- VERTICAL PANEL

R2-1-4860
G20-I102(O)-48

SPEED LIMIT 55

WORK ZONE

W1-4R(O)-48

W1-4L(O)-48

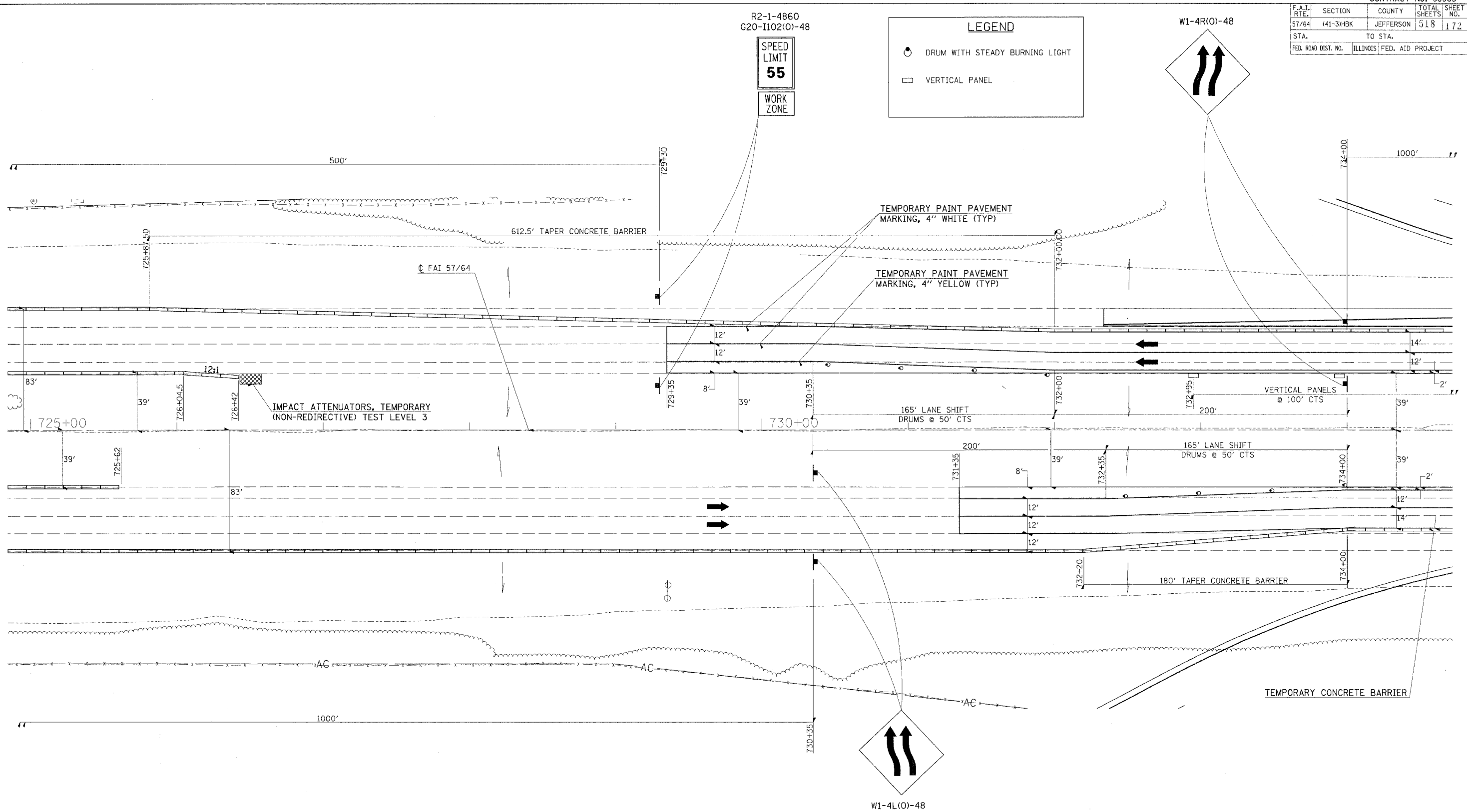

REVISIONS

NAME	DATE

ILLINOIS DEPARTMENT OF TRANSPORTATION

FAI-57/64

STAGE 3

STA. 725+00 TO STA. 734+00

SHEET 7 OF 13

SCALE: 1"=30'

DATE _____ DRAWN BY _____

DATE _____ CHECKED BY _____

03/22/2007, 02:26 PM
 I:\98\plus\98a250\9811001\RAMPS\revised.dwg
 03/22/07 / JN
 RL

