

F.A.I. RTE.	SECTION	COUNTY	TOTAL SHEETS	SHEET NO.
57/64	41-3HBK	JEFFERSON	518	365

STA.	TO STA.
310+50.00	312+00.00

FED. ROAD DIST. NO. ILLINOIS FED. AID PROJECT

DATE	
BY	
SURVEYED	
PLOTTED	
NOTE BOOK	
AREAS CHECKED	

DATE	
BY	
SURVEYED	
PLOTTED	
NOTE BOOK	
AREAS CHECKED	

PLT DATE = 08/29/2007 11:45 AM  
FILE NAME = D:\08\2007\41-3HBK\41-365.CAD  
PLT SCALE = 10.0000 / IN.  
USER NAME = Kay

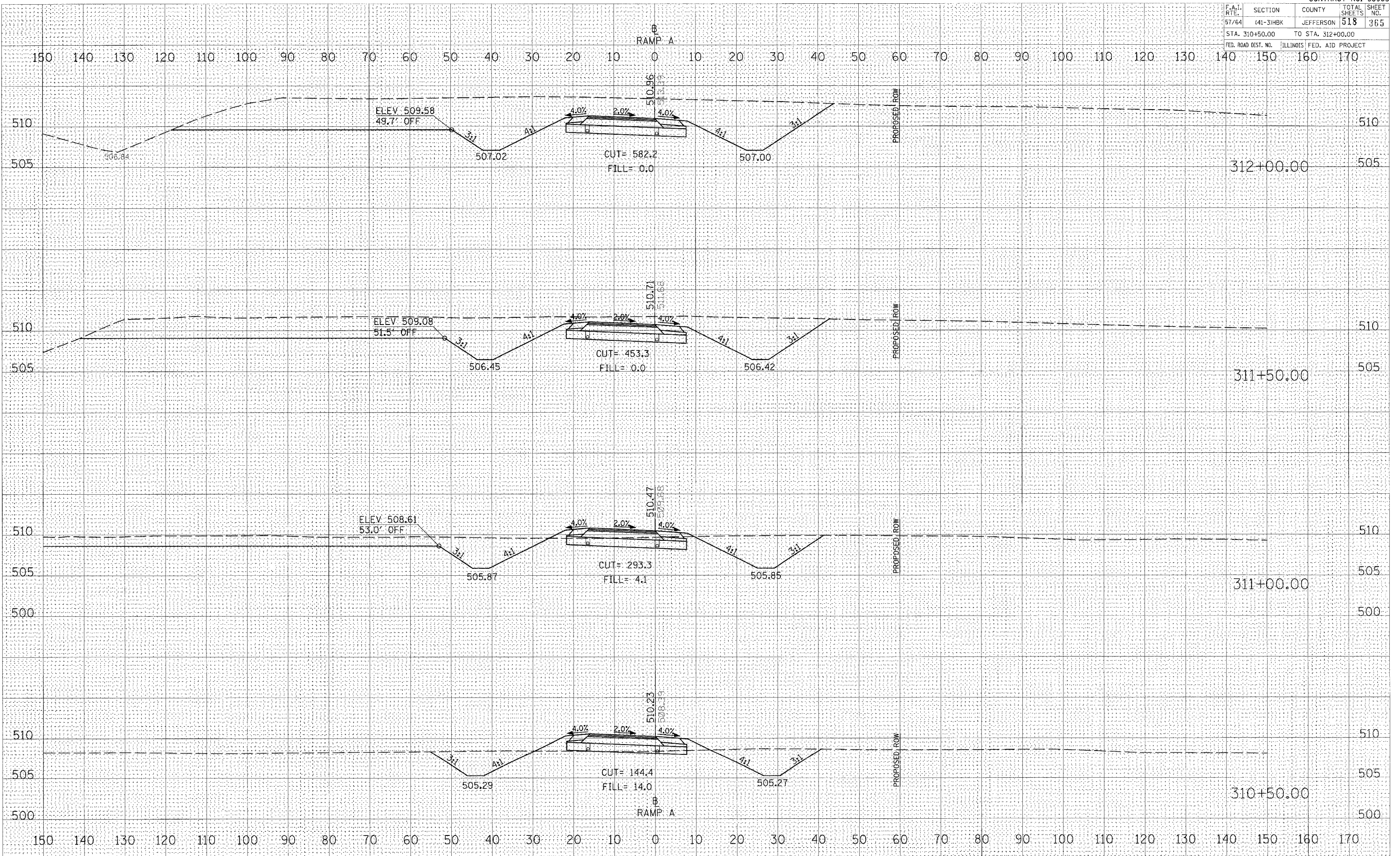

CROSS SECTIONS - PROPOSED RAMP A