

* THE AREAS FOR TREE REMOVAL ARE PRIMARILY ALONG THE LEFT BANK FROM THE TOE OF THE WETLAND BERM TO THE TREE LINE SHOWN ALONG THE CHANNEL, AND ON THE LEFT BANK IN VICINITY OF THE BYPASS CHANNEL. SEE SCHEDULE OF QUANTITIES FOR STATIONING.

* CONTRACTOR TO PROVIDE TEMPORARY 10' X 5' BOX CULVERT SECTIONS (OR EQUIVALENT CONVEYANCE) BENEATH PHASE 1 HAUL ROAD. COST INCLUDED WITH CHANNEL EXCAVATION.

SUGGESTED CONSTRUCTION SEQUENCING

PHASE 1 (COMPLETED BY OTHERS)

1. CLEAR CONSTRUCTION ACCESS FOR LOWER HALF OF THE PROJECT CHANNEL AND ANY TREES IN PARK ALONG UPPER HALF OF THE PROJECT CHANNEL REACH.
2. BUILD CONSTRUCTION ACCESS ROAD TO ELEV. 584.5.
3. EXCAVATE AND STABILIZE WETLAND BYPASS CHANNEL FROM MAIN CHANNEL TO PROPOSED OUTLET LOCATION.
4. INSTALL OUTLET STRUCTURE AND PIPE.

PHASE 2

1. EXCAVATE DIVERSION TRENCHES, WHERE SHOWN, TO ROUTE WATER THROUGH PARK POND & INSTALL CULVERT.
2. INSTALL COFFERDAMS AT STA. 7+40+ AND 12+00+.
3. EXCAVATE CHANNEL BETWEEN RIFFLES #2 AND #3, AND INSTALL SIDESLOPE PROTECTION.
4. BUILD RIFFLES #2 AND #3 AND EXCAVATE A SIDECANNEL AT STA. 8+66.24 CONNECTING BLACKBERRY CREEK WITH PHASE 1 WETLAND BYPASS CHANNEL.
5. RELOCATE COFFERDAM AT RIFFLE #2 TO FINISHED CHANNEL SURFACE.
6. REMOVE COFFERDAM UPSTREAM OF RIFFLE #3 ALLOWING WATER TO FLOW INTO WETLAND BYPASS CHANNEL.
7. BACKFILL AND RE-SEED DIVERSION TRENCH # 1. PLUG OUTLET PIPE IF NEEDED.
8. EXCAVATE CHANNEL BETWEEN RIFFLE #2 AND DAM, AND INSTALL SIDESLOPE PROTECTION.
9. BUILD RIFFLE #1.
10. COMPLETE DAM REMOVAL PER PLANS.
11. REMOVE COFFERDAM DOWNSTREAM OF RIFFLE #2. CONSTRUCT BYPASS CHANNEL WEIR
12. BACKFILL AND RE-SEED DIVERSION TRENCH #2. REMOVE PLUG FROM OUTLET PIPE.
13. BUILD UP WETLAND BERM TO AN ELEVATION OF 587.0
14. REMOVE OR BACKFILL OUTLET STRUCTURE AND PIPE. REMOVE LID SPACERS AND SECURE LID.

SPoil LOCATION FOR SALVAGED BLOCKS FROM THE DAM

REMOVE STONES FROM EXISTING DAM TO MATCH PROPOSED CHANNEL PRISM SEE SHEET 9

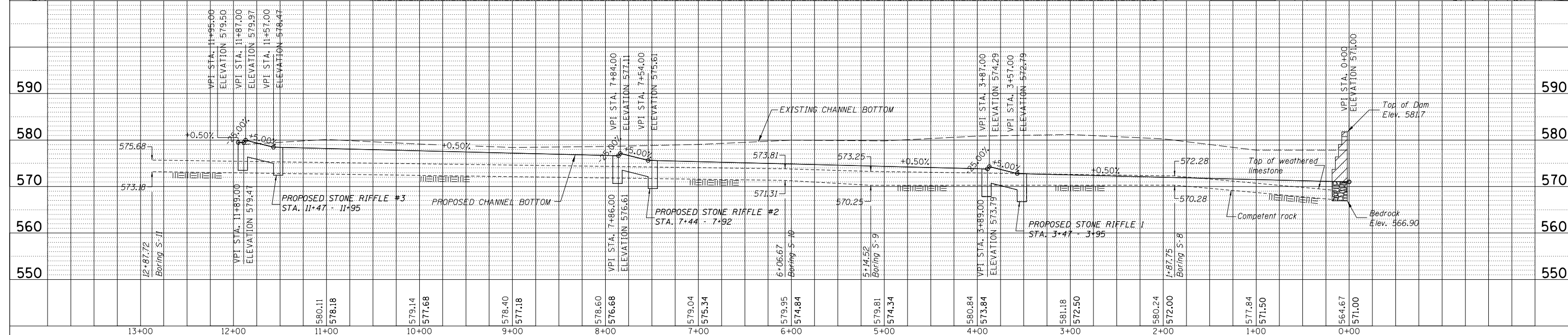

DESIGNED BY: WTC
DRAWN BY: JUF
CHECKED BY: TMM
CHECKED BY: TMM

O:\OwrProj\m\Projects\Blackberry Creek\Plan Sheets\Plan and Profile.dgn 10:21:31 AM 8/24/2012