

NOTES

Blackberry Creek Dam shall remain in place as a BMP measure until the channel stabilization work is complete.
Due to the historical significance of the dam, Archaeologist Floyd Mansberger will need to be contacted prior to dam removal work. See Utility Reference Table on sheet 2. 72 hour notice shall be provided.

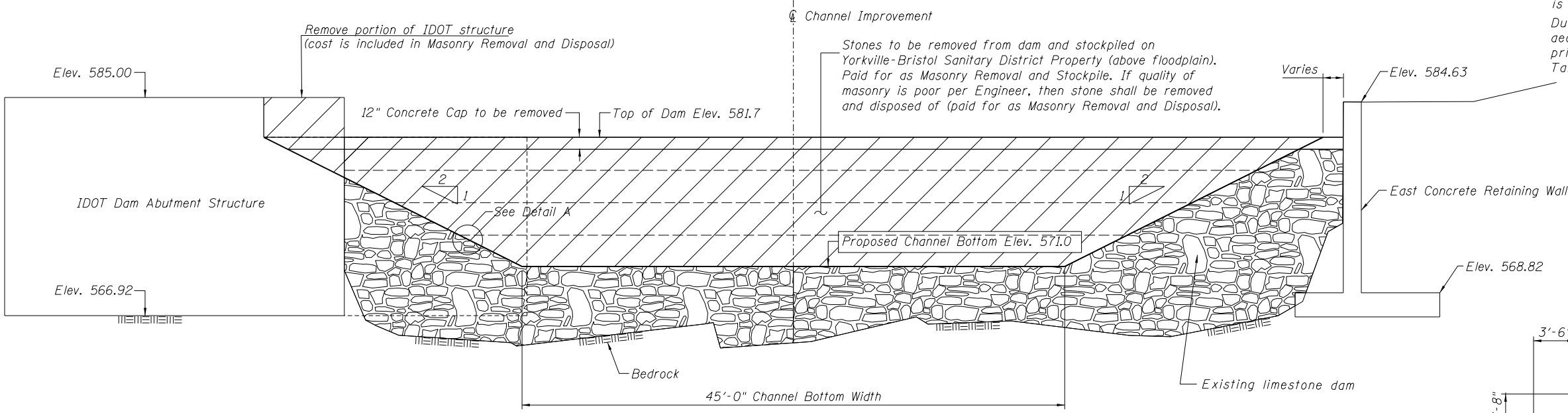

SECTION A-A

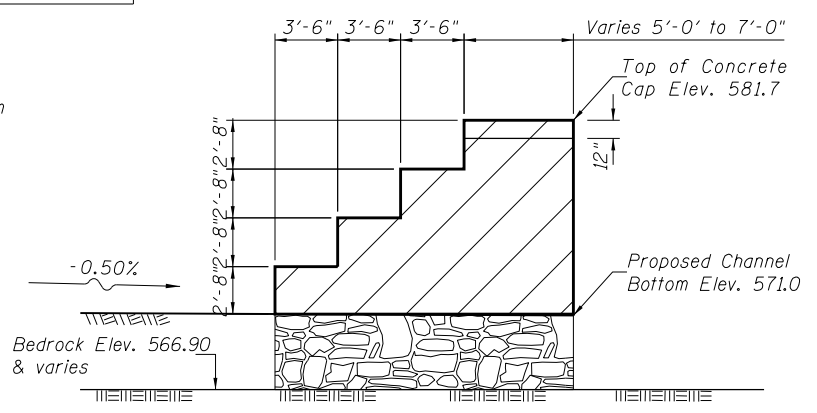

SECTION B-B

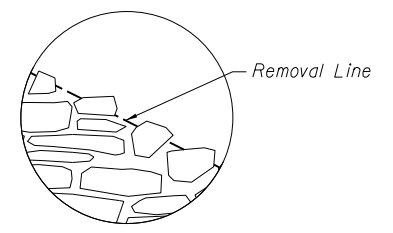

Remove stones along proposed removal line, keeping blocks intact as much as possible. Finished edge will be somewhat jagged.

DETAIL A

BILL OF MATERIAL

Masonry Removal and Stockpile	Cu Yd	273
Masonry Removal and Disposal	Cu Yd	273

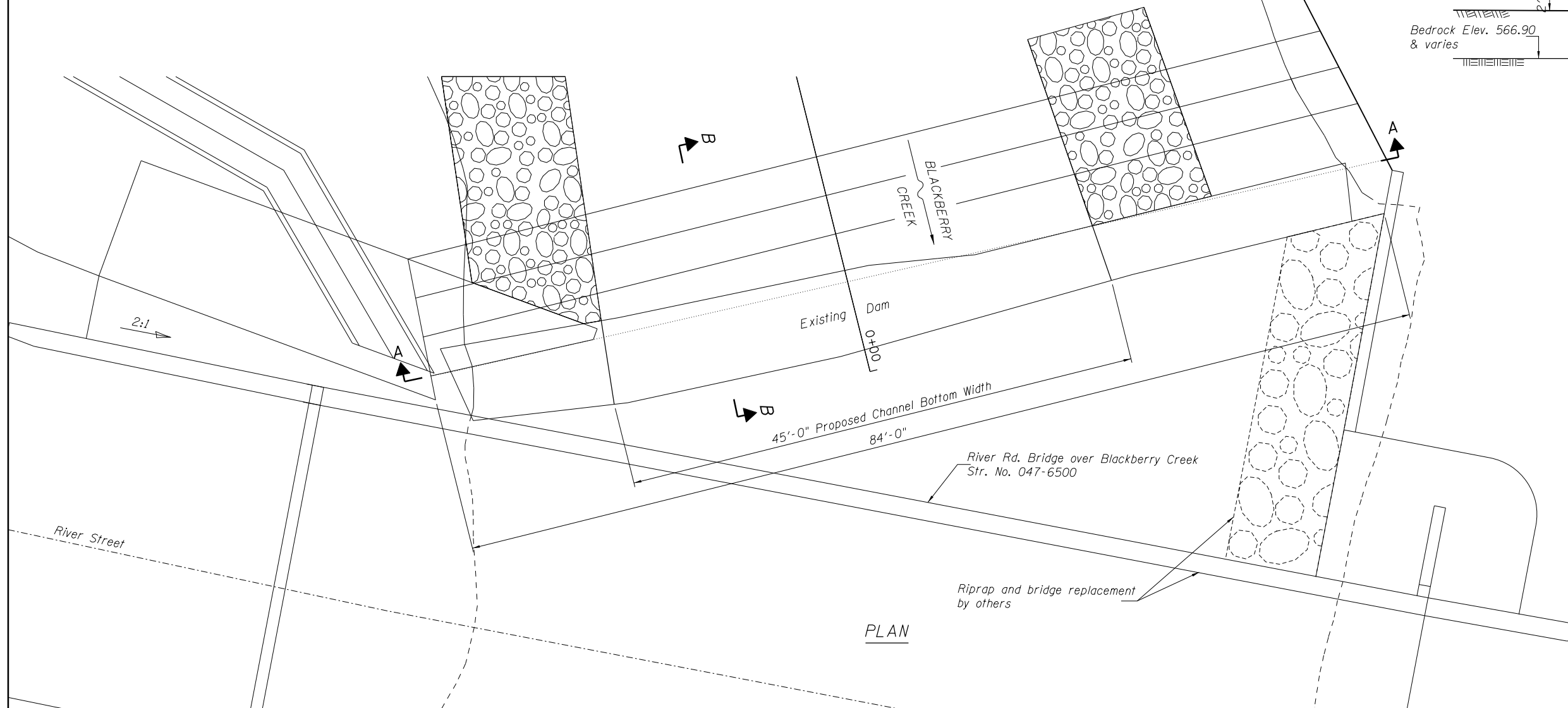

PLAN

O:\OwrProj\mpl\Projects\Blackberry Creek\Plan Sheets\Dam Modifications.dgn
 8/24/2012 10:34:58 AM
 Designed By JUF checked By TMM
 Drawn By JUF checked By TMM