

DATE	
BY	
REVISION	
NO. 1	
NO. 2	
NO. 3	
NO. 4	
NO. 5	
NO. 6	
NO. 7	
NO. 8	
NO. 9	
NO. 10	
NO. 11	
NO. 12	
NO. 13	
NO. 14	
NO. 15	
NO. 16	
NO. 17	
NO. 18	
NO. 19	
NO. 20	

DATE	
BY	
REVISION	
NO. 1	
NO. 2	
NO. 3	
NO. 4	
NO. 5	
NO. 6	
NO. 7	
NO. 8	
NO. 9	
NO. 10	
NO. 11	
NO. 12	
NO. 13	
NO. 14	
NO. 15	
NO. 16	
NO. 17	
NO. 18	
NO. 19	
NO. 20	

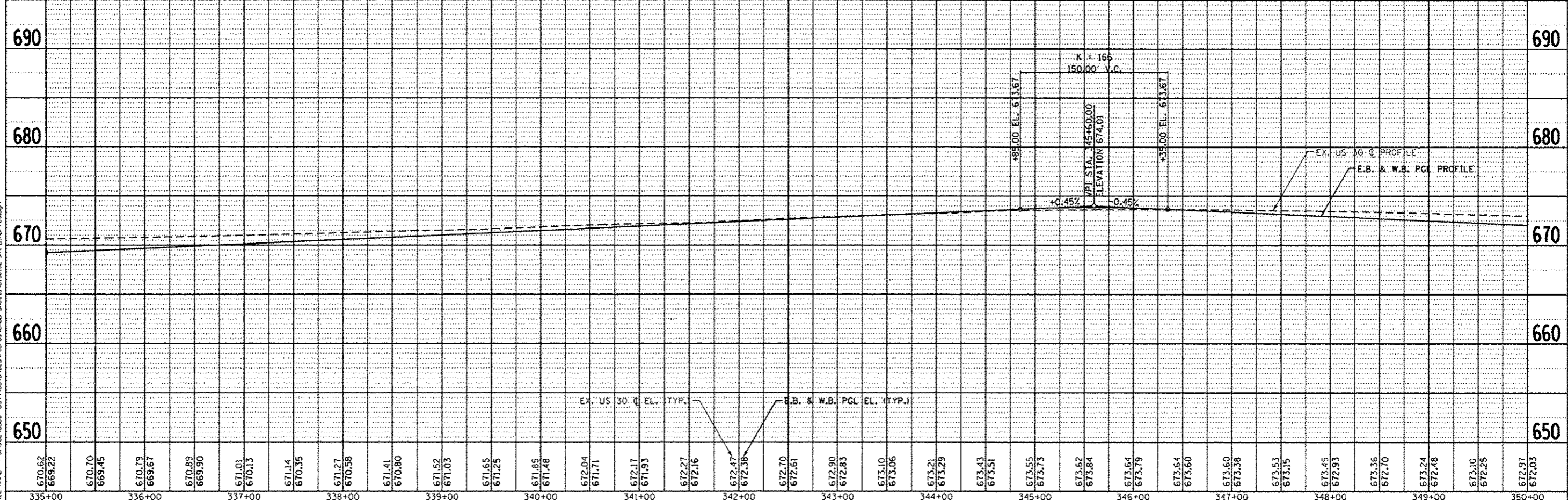
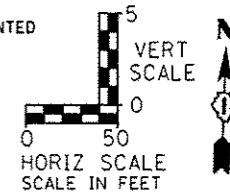
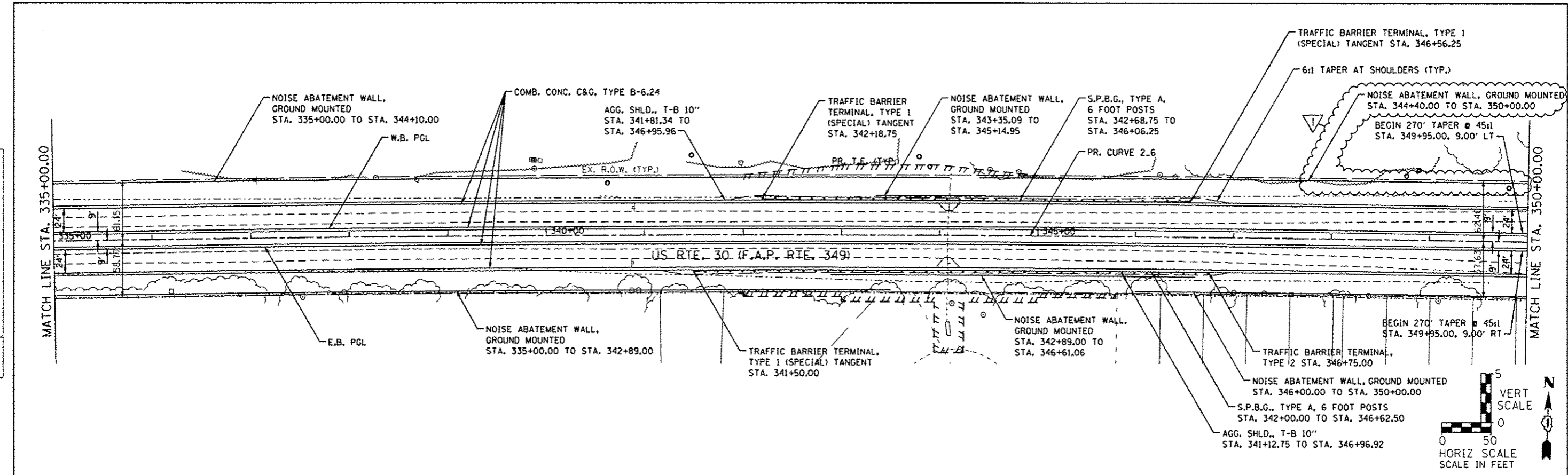

1170 SOUTH HOUBOLT ROAD JOLIET, ILLINOIS 60431 (815) 744-4200	USER NAME = dennis	DESIGNED - MAG	REVISED - 9-6-12	STATE OF ILLINOIS DEPARTMENT OF TRANSPORTATION	PLAN AND PROFILE		SECTION 11 WRS-3	COUNTY KENDALL	TOTAL SHEETS 527 OF 79	CONTRACT NO. 60132
	PLOT SCALE = 1/8" = 100.0000' / 1"	CHECKED - S.JN	REVISED -		SCALE: AS SHOWN	SHEET NO. OF SHEETS				
PLOT DATE = 9/7/2012		DRAWN - B.J.F.	REVISED -	SHEET NO. OF SHEETS STA. 335+00 TO STA. 350+00		ILLINOIS FED. AID PROJECT				