

GENERAL NOTES

4" ϕ drainage holes shall be field drilled through the wall panels as required to facilitate surface drainage with a maximum of one hole per panel. Location to be determined in the field by the Engineer. Cost included with Noise Abatement Wall, Ground Mounted.

The Noise Abatement Walls shall have an absorptive panel system on the roadway side and either absorptive or reflective on the residential side, unless noted otherwise. See Special Provision for additional details.

All reinforcement including the welded wire fabric shall be Epoxy Coated. Welded wire fabric shall be according to AASHTO M 55.

The Contractor shall verify and consider the location of existing and proposed drainage structures, overhead and underground utilities prior to wall construction. Any damage to utilities to be repaired at the Contractor's expense.

Type, size and spacing of posts, noise wall panels, drilled shaft size and embedment length, reinforcement details, lifting bars and wall limits including top and bottom of wall shall be determined by Contractor. Cost included with Noise Abatement Wall, Ground Mounted.

TOTAL BILL OF MATERIAL

ITEM	UNIT	TOTAL
Noise Abatement Wall, Ground Mounted	Sq. Ft.	171,237

CURVE DATA

(US Route 30)

(Proposed Curve 2_1)	(Proposed Curve 2_6)
$\Delta = 38^{\circ}25'19''$ (LT)	$\Delta = 3^{\circ}30'11''$ (RT)
$D = 1^{\circ}57'19''$	$D = 0^{\circ}08'00''$
$T = 1,021.02'$	$T = 1,314.10'$
$L = 1,964.94'$	$L = 2,627.38'$
$E = 172.79'$	$E = 20.09'$
$R = 2,930.17'$	$R = 42,972.95'$
P.C. = Sta. 297+95.49	P.C. = Sta. 324+00.62
P.T. = Sta. 317+60.43	P.T. = Sta. 350+28.00
P.I. = Sta. 308+16.51	P.I. = Sta. 337+14.72

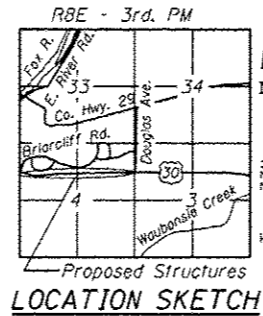

LOADING

Wind on Ground Mounted Noise Wall = 25 psf

DESIGN SPECIFICATIONS

2002 AASHTO Standard Specifications for Highway Bridges
1989 Guide Specifications for Structural Design of Sound Barriers with Interims

DESIGN STRESSES

FIELD UNITS

$f'_c = 3,500$ psi
 $f_y = 60,000$ psi (Reinforcement)
 $f_y = 36,000$ psi (Struct. Steel, M270 Grade 50)

PRECAST UNITS

$f'_c = 4,500$ psi
 $f_y = 60,000$ psi (Reinforcement)
 $f_y = 65,000$ psi (Welded Wire Fabric)

INDEX OF SHEETS

- S1. General Plan
- S2. Details
- S3. North Noise Abatement Wall 1
- S4. South Noise Abatement Wall 1
- S5. North and South Noise Abatement Walls 2 & 3
- S6-S19. Boring Logs

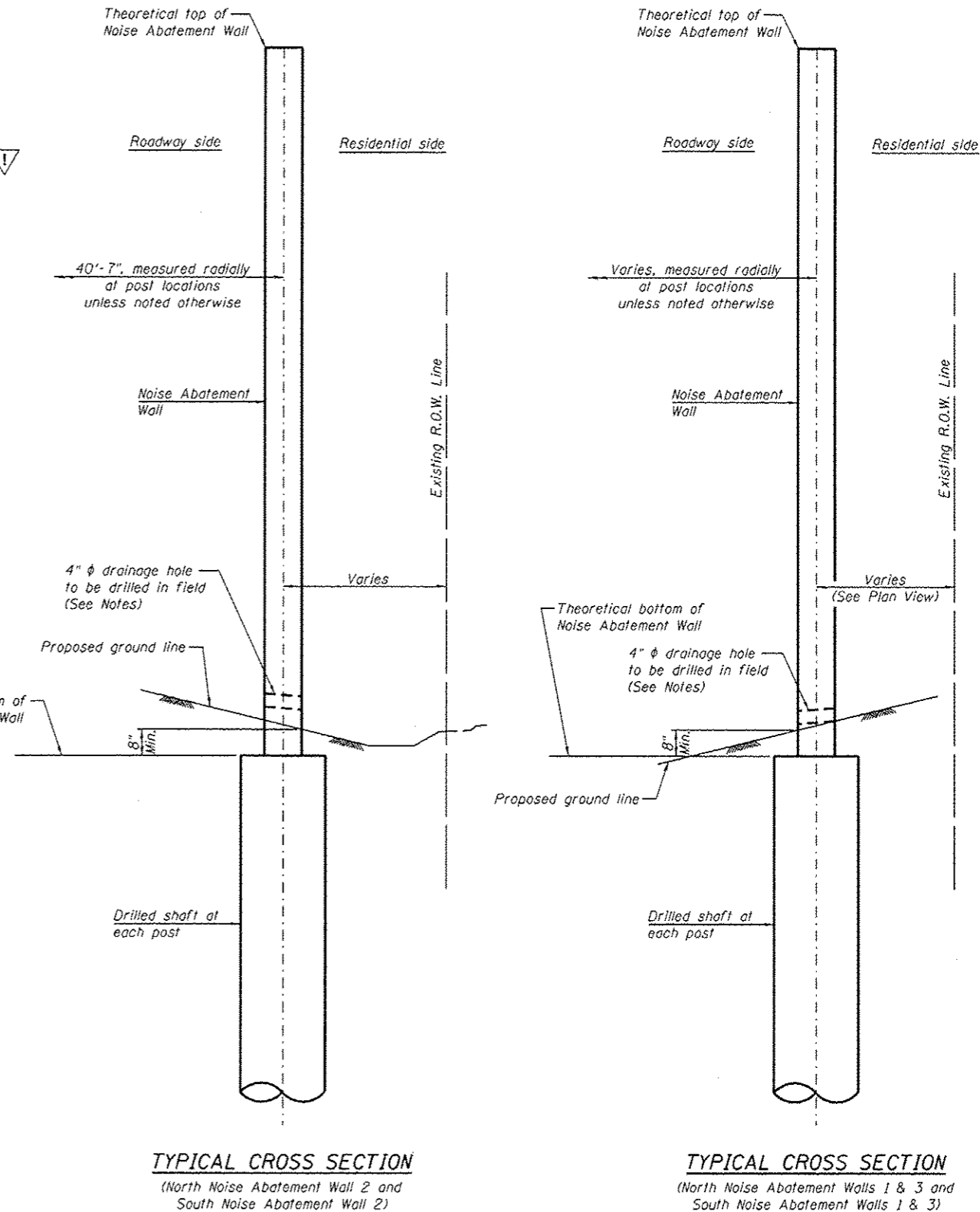

USER NAME :	DESIGNED - ADB	REVISED - 9-6-12
FILE NAME :	CHECKED - MTH	REVISED -
PLOT SCALE :	DRAWN - AJF	REVISED -
PLOT DATE :	CHECKED - MTH	REVISED -

STATE OF ILLINOIS
DEPARTMENT OF TRANSPORTATION

DETAILS
NOISE ABATEMENT WALLS
SHEET NO. 52 OF 519 SHEETS

F.A.P. RTE.	SECTION	COUNTY	TOTAL SHEETS	SHEET NO.
349	11 WRS-3	KENDALL	527	322
CONTRACT NO. 60132				
ILLINOIS FED. AID PROJECT				