

- NOTES:
- REFER TO INTERSECTION DETAIL SHEETS FOR LOCATION OF PAVEMENT JOINTS FOR STAGING.
 - USE THE FOLLOWING PAY ITEMS WHERE APPLICABLE IN ORDER TO STAGE CONSTRUCT THE INTERSECTION:
 - HOT MIX ASPHALT SURFACE REMOVAL-BUTT JOINT
 - INCIDENTAL HOT-MIX ASPHALT SURFACING
 - HOT-MIX ASPHALT SURFACE REMOVAL, VARIABLE DEPTH

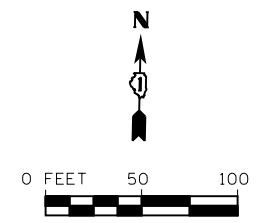
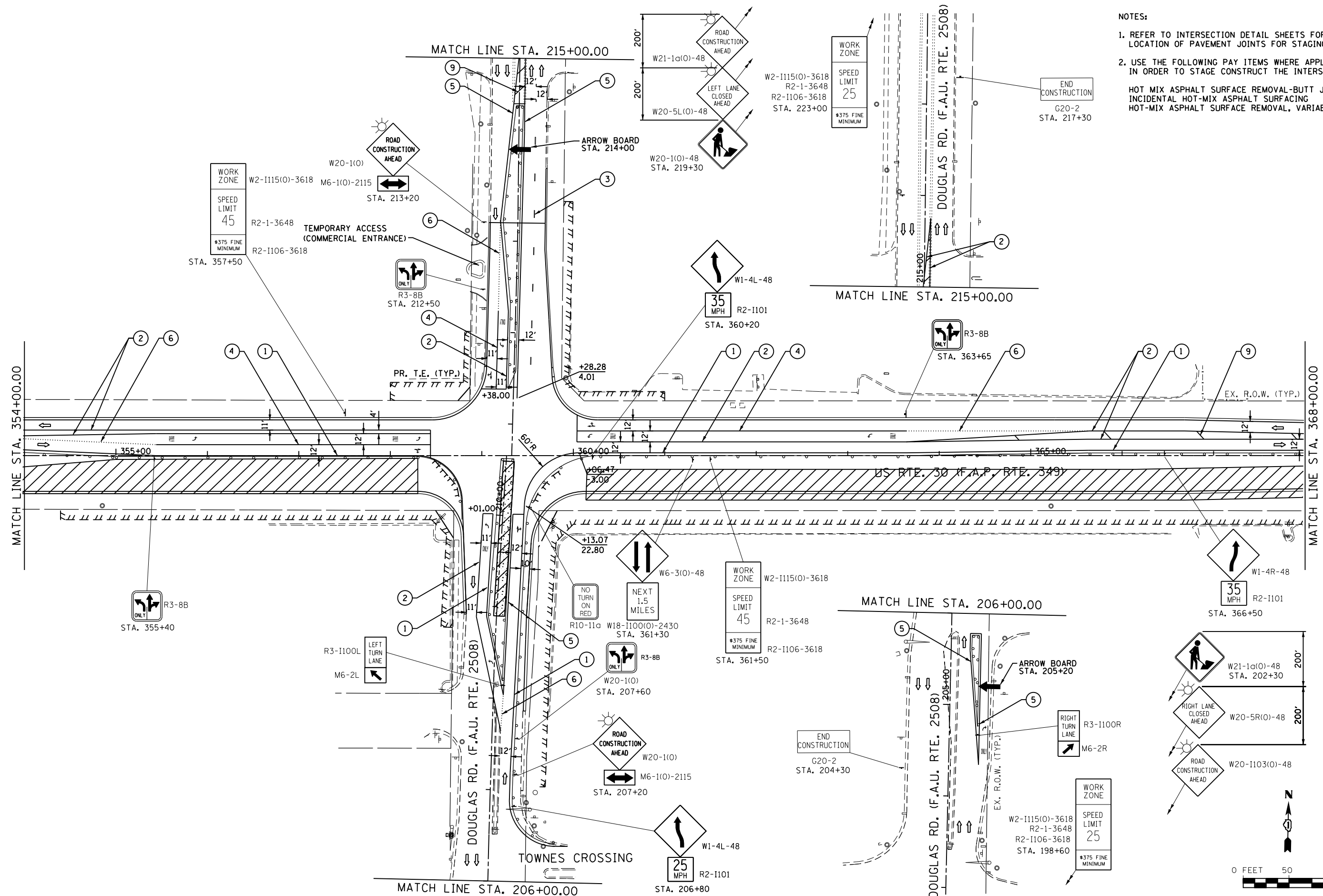

FILE NAME = S:\JUL16300-6399\6346\023\Micro\CAD Sheets\0160132-sht-staging\1b.dgn

STRAND
ENGINEERS
1170 SOUTH HOUBOLT ROAD
JOLIET, ILLINOIS 60431
(815) 744-4200

USER NAME = amanda_j
DESIGNED -
DRAWN -
PLOT SCALE = 100.0000' / 1" =
CHECKED -
DATE -
PLOT DATE = 8/1/2012

DESIGNED -
DRAWN -
CHECKED -
DATE -
REVISED -
REVISED -
REVISED -
REVISED -

**STATE OF ILLINOIS
DEPARTMENT OF TRANSPORTATION**

**MAINTENANCE OF TRAFFIC
STAGE 2b**

SCALE: AS SHOWN SHEET NO. OF SHEETS STA. 354+00.00 TO STA. 368+00.00

| | | | | |
|---|----------|---------|--------------|-----------|
| F.A.P. RTE. | SECTION | COUNTY | TOTAL SHEETS | SHEET NO. |
| 349 | 11 WRS-3 | KENDALL | 527 | 122 |
| CONTRACT NO. 60132 | | | | |
| FED. ROAD DIST. NO. 1 ILLINOIS FED. AID PROJECT | | | | |