

PLAN	SURVEYED	DATE
	PLOTTED	BY
	GRADES CHECKED	
	ALIGNMENT CHECKED	
	STRUCTURE NOTED	
	FILE NAME	

PROFILE	SURVEYED	DATE
	PLOTTED	BY
	GRADES CHECKED	
	ALIGNMENT CHECKED	
	STRUCTURE NOTED	
	FILE NAME	

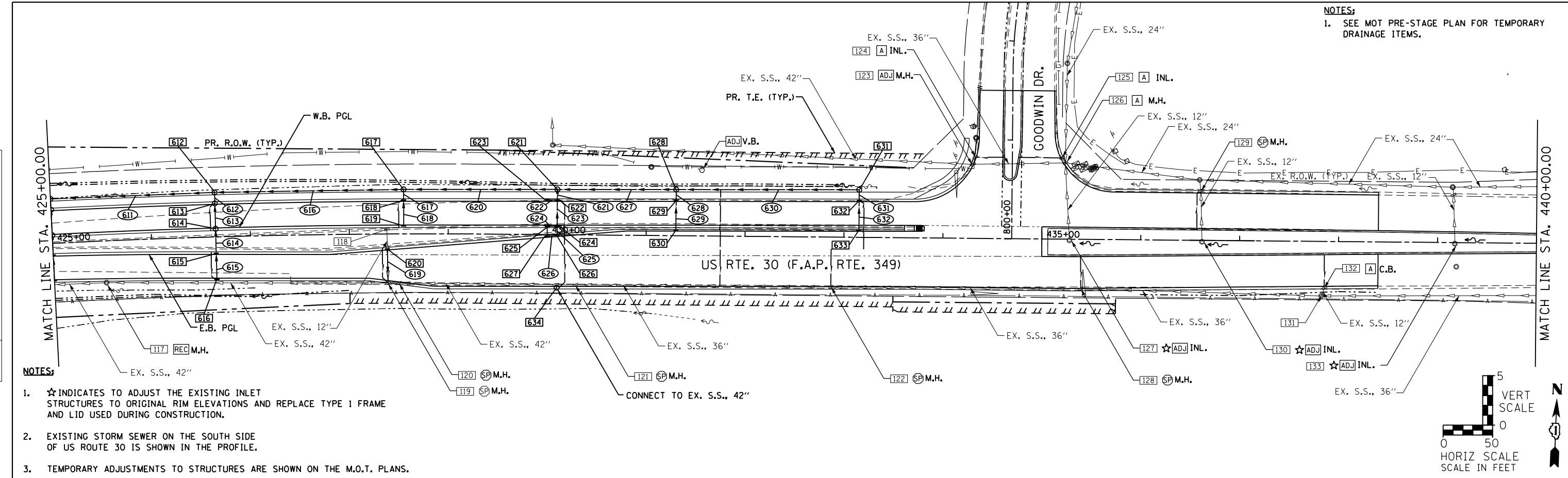

NOTES:  
1. SEE MOT PRE-STAGE PLAN FOR TEMPORARY DRAINAGE ITEMS.

- NOTES:
- ★ INDICATES TO ADJUST THE EXISTING INLET STRUCTURES TO ORIGINAL RIM ELEVATIONS AND REPLACE TYPE 1 FRAME AND LID USED DURING CONSTRUCTION.
  - EXISTING STORM SEWER ON THE SOUTH SIDE OF US ROUTE 30 IS SHOWN IN THE PROFILE.
  - TEMPORARY ADJUSTMENTS TO STRUCTURES ARE SHOWN ON THE M.O.T. PLANS.

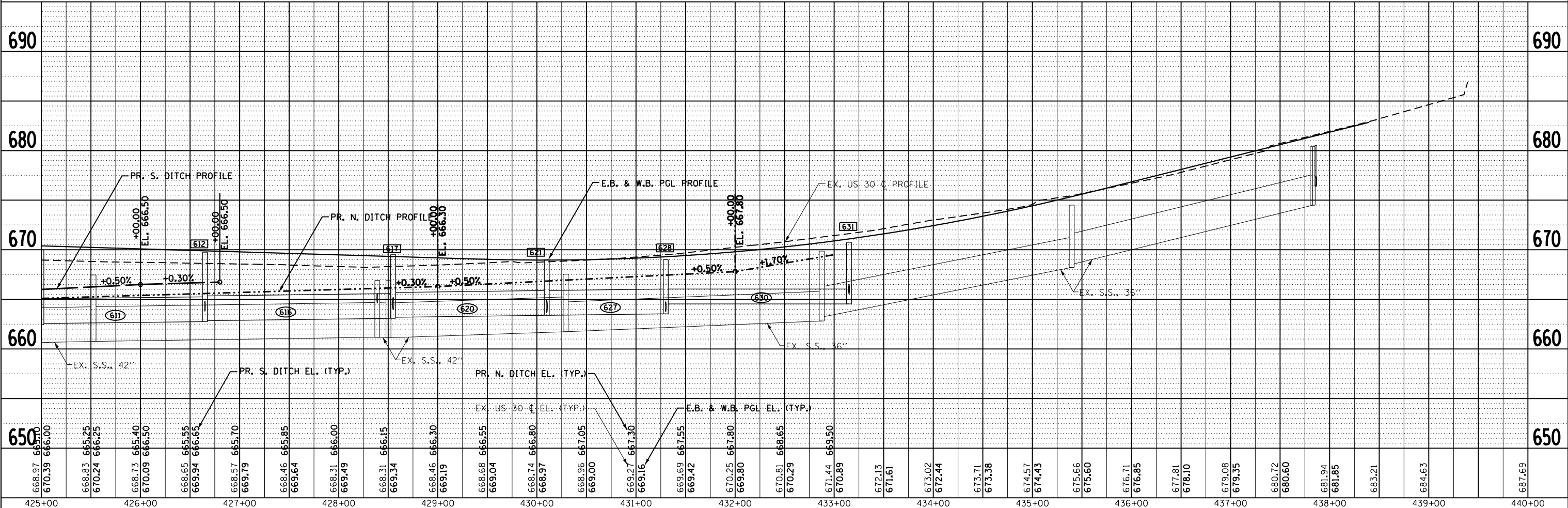
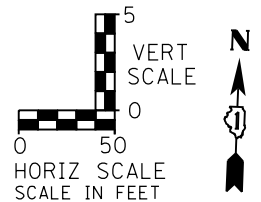

STRAND ENGINEERS  
1170 SOUTH HOUBOLT ROAD  
JOLIET, ILLINOIS 60431  
(815) 744-4200

USER NAME = amandaj	DESIGNED - RES/NJO	REVISED -
	CHECKED - MKS	REVISED -
PLOT SCALE = 100.0000' / 1"	DRAWN - AJJ	REVISED -
PLOT DATE = 5/11/2012	CHECKED - SJN	REVISED -

STATE OF ILLINOIS  
DEPARTMENT OF TRANSPORTATION

US ROUTE 30 - DRAINAGE AND UTILITY PLAN AND PROFILE  
SCALE: AS SHOWN SHEET NO. OF SHEETS STA. 425+00 TO STA. 440+00

F.A.P. RTE. 349	SECTION 11 WRS-3	COUNTY KENDALL	TOTAL SHEETS 527	SHEET NO. 173
CONTRACT NO. 60132				
FED. ROAD DIST. NO. 1 ILLINOIS FED. AID PROJECT				