

PLAN	SURVEYED	BY	DATE
	NOTED		
	CHECKED		
	AT		
	FILE NAME		
	NO.		

PROFILE	SURVEYED	BY	DATE
	GRADES		
	CHECKED		
	STRUCTURE		
	NOT AT THIS OFFICE		
	NO.		

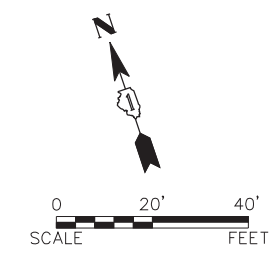
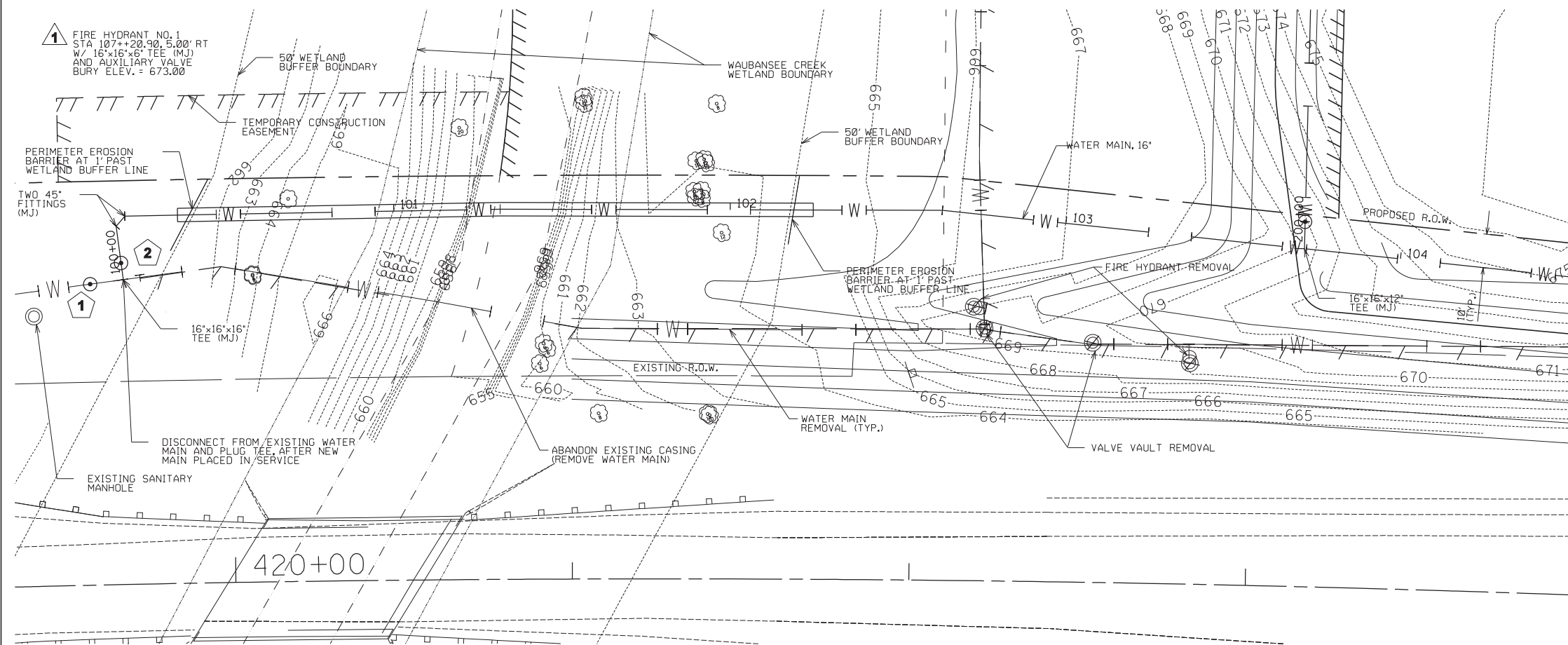

- 1** VALVE VAULT NO. 1
STA 100+00, 10.00' LT
(ROADWAY STA 419+58.62)
16" GATE VALVE
IN 60" VAULT
RIM = 664.60
- 2** VALVE VAULT NO. 2
STA 100+05
(ROADWAY STA 419+67.70)
16" GATE VALVE
IN 60" VAULT
RIM = 665.6

- CONSTRUCTION SEQUENCE**
1. TEMPORARY SHUT DOWN OF EXISTING 16" WATER MAIN SECTION. USE EMERGENCY SHUT DOWN PROCEDURES.
 2. CUT EXISTING MAIN AND INSTALL VV #1, WATER MAIN TO 16"x16"x16" TEE, AND VV #2. RECONNECT TO EXISTING WATER MAIN.
 3. WITH VV #2 REMAINING CLOSED OPEN EXISTING WATER MAIN AT VV #1.
 4. CONSTRUCT NEW WATER MAIN, PRESSURE TEST, AND DISINFECT NEW WATER MAIN.
 5. AFTER VILLAGE OBTAINS OPERATING PERMIT, DISCONNECT FROM EXISTING WATER MAIN AT THE 16"x16"x16" TEE, CAPPING TEE WITH MJ FITTING AND THRUST BLOCKING.
 6. CONNECT TO EXISTING WATER MAIN AT VV #3 USING 45" FITTING (MJ) AND THRUST BLOCKING.
 7. REMOVE EXISTING WATER MAIN.

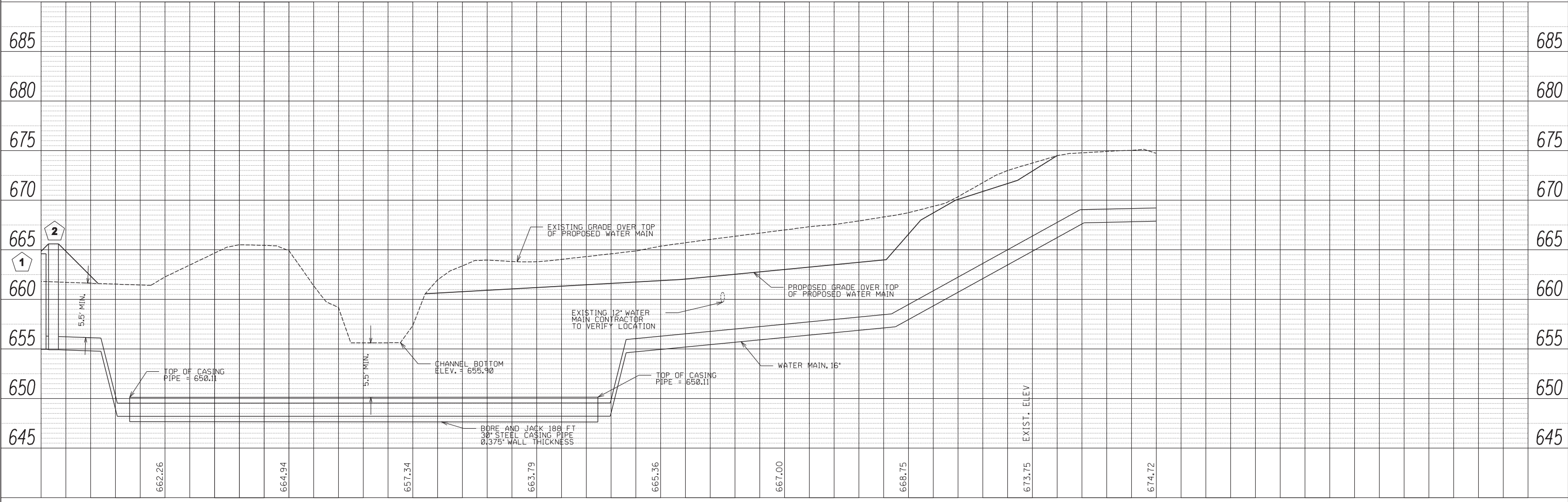

FILE NAME = H:\SDSKP\Proj\M01120\dgn\Dgn_Final Eng\M01120-PP.dgn	USER NAME = kpung	DESIGNED - TNP	REVISED -	STATE OF ILLINOIS DEPARTMENT OF TRANSPORTATION	PROPOSED WATER MAIN PLAN AND PROFILE	F.A.P. RTE. = 349	SECTION = 11 WRS-3	COUNTY = KENDALL	TOTAL SHEETS = 527	SHEET NO. = 180	
PLOT SCALE = 20.0000' / IN.	CHECKED - TAW	REVISOR -	SCALE: 1" = 20'			SHEET NO. 1 OF 3 SHEETS	STA. 100+00 TO STA. 104+50	CONTRACT NO. 60132		FED. ROAD DIST. NO. 1	ILLINOIS FED. AID PROJECT
PLOT DATE = 4/26/2012	DATE = 4/26/12	REVISOR -									