

\\D:\01\Projects\264\Dgn\CADD_Sheets\160132-SHT-TS-33.dgn

CONSTRUCTION NOTES:

① THE CONTRACTOR SHALL LOCATE AND INTERCEPT THE COUPLING OF THE EXISTING 2" INTERCONNECT CONDUIT AND SPLICE NEW 2" GALVANIZED STEEL CONDUIT FOR THE INTERCONNECT BETWEEN US ROUTE 30/DOUGLAS RD. AND TOWNES CROSSING/DOUGLAS RD.

EXISTING INTERCONNECT TO FERNWOOD DR.

CONSTRUCTION NOTE ①

NOTE:
THE TRAFFIC SIGNAL CONTROLLER EQUIPMENT FOR THIS PROJECT SHALL BE "EAGLE" TO MATCH THE EXISTING ADJACENT SYSTEM.

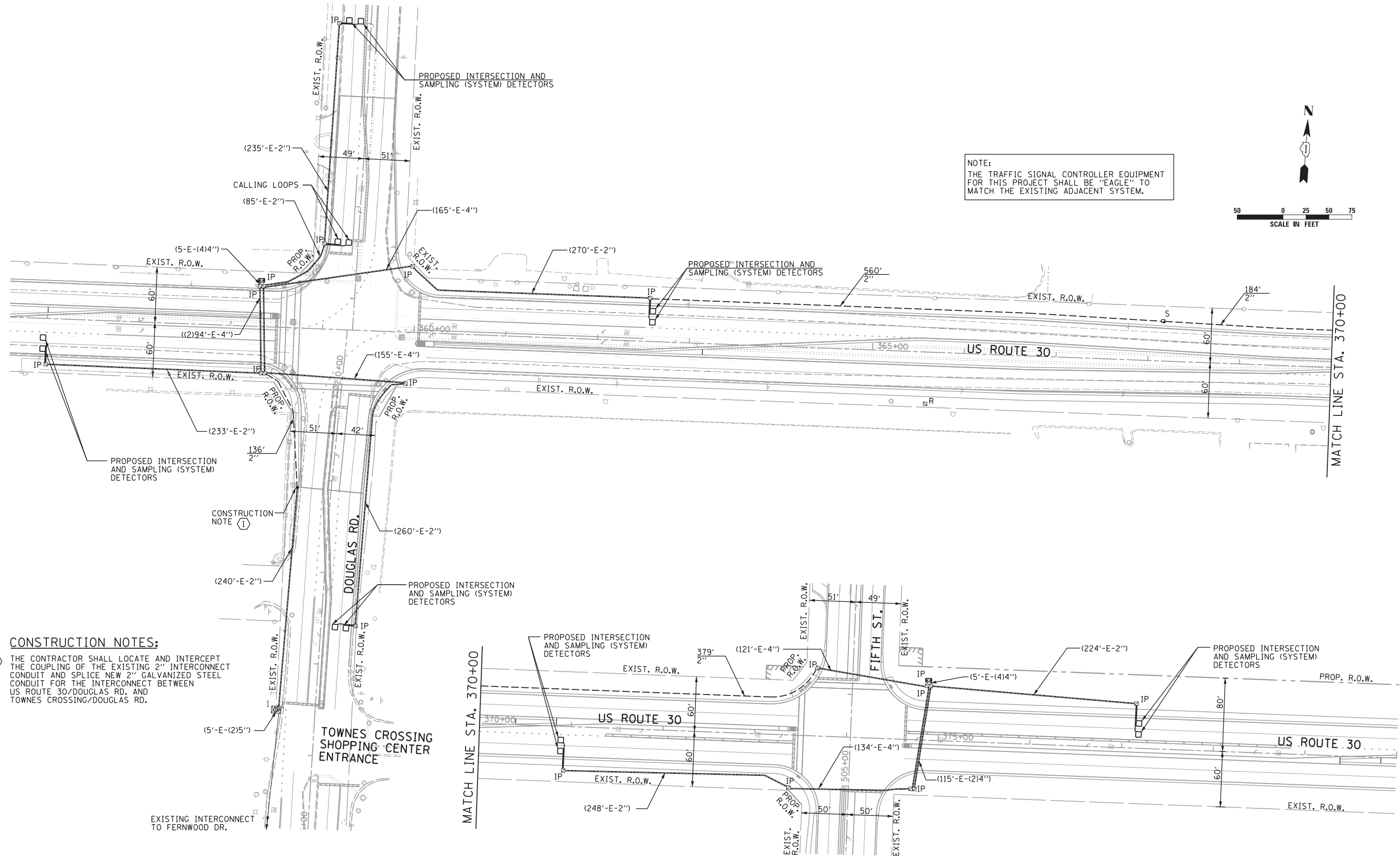
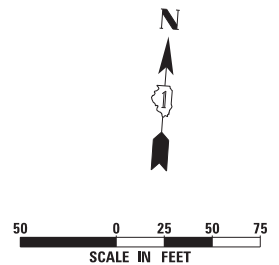

SINGH
CONSULTING ENGINEERS
www.singhinc.com

USER NAME = vpelegrinos
DESIGNED - VO
DRAWN - YJ
PLOT SCALE = 50.000' / in.
CHECKED - KGP
PLOT DATE = 4/25/2012

REVISIED -
REVISIED -
REVISIED -
REVISIED -

DATE -

**STATE OF ILLINOIS
DEPARTMENT OF TRANSPORTATION**

**SYSTEM INTERCONNECT PLAN,
US ROUTE 30 (DOUGLAS RD. TO FIFTH ST.)**

SCALE: 1"=50' SHEET NO. OF SHEETS STA. TO STA.

F.A.P. RTE.	SECTION	COUNTY	TOTAL SHEETS	SHEET NO.
349	11 WRS-3	KENDALL	527	277
CONTRACT NO. 60132				
FED. ROAD DIST. NO. 1 ILLINOIS FED. AID PROJECT				