

INDEX OF SHEETS

HIGHWAY STANDARDS

HIGHWAY STANDARDS

SHEET NO.	DESCRIPTION
1	COVER SHEET
2	INDEX OF SHEETS AND HIGHWAY STANDARDS
3	GENERAL NOTES, COMMITMENTS, & HMA MIXTURE REQUIREMENTS
4-22	SUMMARY OF QUANTITIES
23-37	TYPICAL SECTIONS
38-62	SCHEDULES OF QUANTITIES
63-65	ALIGNMENT, TIES, AND BENCHMARKS
66-72	REMOVAL PLAN
73-79	ROADWAY PLAN
80-87	PROFILES
88	SUGGESTED STAGING AND TRAFFIC CONTROL - GENERAL NOTES
89	SUGGESTED STAGING AND TRAFFIC CONTROL - STAGE 1 - TYPICAL SECTIONS
90-94	SUGGESTED STAGING AND TRAFFIC CONTROL - STAGE 1 - PLAN
95-98	SUGGESTED STAGING AND TRAFFIC CONTROL - STAGE 1 - DETAILS
99	SUGGESTED STAGING AND TRAFFIC CONTROL - STAGE 2 - TYPICAL SECTIONS
100-103	SUGGESTED STAGING AND TRAFFIC CONTROL - STAGE 2 - PLAN
104	SUGGESTED STAGING AND TRAFFIC CONTROL - STAGE 2A & 2B - TYPICAL SECTIONS
105-106	SUGGESTED STAGING AND TRAFFIC CONTROL - STAGE 2A - PLAN
107-108	SUGGESTED STAGING AND TRAFFIC CONTROL - STAGE 2B - PLAN
109	SUGGESTED STAGING AND TRAFFIC CONTROL - STAGE 2C - PLAN
110	SUGGESTED STAGING AND TRAFFIC CONTROL - STAGE 3 - TYPICAL SECTIONS
111-114	SUGGESTED STAGING AND TRAFFIC CONTROL - STAGE 3 - PLAN
115-120	EROSION AND SEDIMENT CONTROL PLAN
121-125	EROSION AND SEDIMENT CONTROL DETAILS
126-131	LANDSCAPING PLAN
132-137	DRAINAGE PLAN
138-142	DRAINAGE SCHEDULES
143-144	UNDERDRAIN SCHEDULES
145-148	DRAINAGE DETAILS
149-150	GRADING PLAN
151-152	GRADING CROSS SECTIONS
153-157	PLAT OF HIGHWAYS
158-164	PAVEMENT MARKING PLAN
165-194	TRAFFIC SIGNAL PLAN
195-221	LIGHTING PLAN
222-337	US 30 BRIDGE DRAWINGS
338-348	US 30 RETAINING WALL DRAWINGS
349-364	DETAILS
365-370	SUPERELEVATION PLAN
371-378	SIGNING PLAN
379-385	SIGN DETAILS
386-426	US 30 CROSS SECTIONS
427-465	IL 31 CROSS SECTIONS
466-481	RAMP A CROSS SECTIONS
482-495	RAMP B CROSS SECTIONS
496-501	RAMP C CROSS SECTIONS
502-507	RAMP D CROSS SECTIONS

STD. NO.	TITLE
000001-06	STANDARD SYMBOLS, ABBREVIATIONS AND PATTERNS
001001	AREAS OF REINFORCEMENT BARS
001006	DECIMAL OF AN INCH AND OF A FOOT
280001 - 06	TEMPORARY EROSION CONTROL SYSTEMS
406001 - 05	ENTRANCE RAMP TERMINAL (FLEXIBLE RAMP PAVEMENT ADJACENT TO FLEXIBLE MAINLINE PAVEMENT)
406101 - 04	EXIT RAMP TERMINAL (FLEXIBLE RAMP PAVEMENT ADJACENT TO FLEXIBLE MAINLINE PAVEMENT)
420401-08	BRIDGE APPROACH PAVEMENT CONNECTOR
424001 - 06	PERPENDICULAR CURB RAMPS FOR SIDEWALKS
442101 - 07	CLASS B PATCHES
442201 - 03	CLASS C AND D PATCHES
482001 - 02	HMA SHOULDER ADJACENT TO FLEXIBLE PAVEMENT
483001 - 04	PC SHOULDER
515001 - 03	NAME PLATE FOR BRIDGES
542301 - 03	PRECAST REINFORCED CONCRETE FLARED END SECTION
542311 - 03	GRATING FOR CONCRETE FLARED END SECTION (FOR 24" (600 mm) THRU 54" (1350 mm) PIPE)
542536 - 03	INLET BOX TYPE 36 (900) A
601101 - 01	CONCRETE HEADWALL FOR PIPE DRAIN
602001 - 02	CATCH BASIN TYPE A
602011 - 02	CATCH BASIN TYPE C
602106 - 01	DRAINAGE STRUCTURES TYPES 4, 5 & 6
602401 - 03	MANHOLE TYPE A
602601 - 02	PRECAST REINFORCED CONCRETE FLAT SLAB TOP
602701 - 02	MANHOLE STEPS
604001 - 03	FRAME AND LID TYPE 1
604036 - 02	GRATE TYPE 8
604046 - 02	FRAME AND GRATE TYPE 10
604056 - 03	FRAME AND GRATE TYPE 11V
604071 - 04	FRAMES AND GRATE, TYPE 20
604081 - 04	FRAMES AND GRATES, TYPE 22
604091 - 02	FRAME AND GRATE, TYPE 24
606001 - 04	CONCRETE CURB TYPE B AND COMBINATION CONCRETE CURB AND GUTTER
606201 - 02	TYPE B GUTTER (INLET, OUTLET & ENTRANCE)
606301 - 04	PC CONCRETE ISLANDS AND MEDIANS
606306 - 03	CORRUGATED PC CONCRETE MEDIANS
630001 - 10	STEEL PLATE BEAM GUARDRAIL
630301 - 05	SHOULDER WIDENING FOR TYPE 1 (SPECIAL) GUARDRAIL TERMINALS
631011 - 08	TRAFFIC BARRIER TERMINAL, TYPE 2
631031 - 10	TRAFFIC BARRIER TERMINAL, TYPE 6
635006 - 03	REFLECTOR AND TERMINAL MARKER PLACEMENT
635011 - 02	REFLECTOR MARKER AND MOUNTING DETAILS
637006 - 02	CONCRETE BARRIER, DOUBLE FACE, 42 IN. HEIGHT
701006 - 03	OFF-RD OPERATIONS, 2L, 2W 15' (4.5 m) TO 24" (600 mm) FROM PAVEMENT EDGE
701101 - 02	OFF-RD OPERATIONS, MULTILANE 15' (4.5 m) TO 24" (600 mm) FROM PAVEMENT EDGE
701306 - 03	LANE CLOSURE, 2L, 2W, SLOW MOVING OPERATIONS DAY ONLY FOR SPEEDS ≥ 45 MPH
701326 - 04	LANE CLOSURE, 2L, 2W, PAVEMENT WIDENING, FOR SPEEDS ≥ 45 MPH
701422 - 04	LANE CLOSURE, MULTILANE, FOR SPEEDS ≥ 45 MPH TO 55 MPH
701431 - 07	LANE CLOSURE, MULTILANE, UNDIVIDED WITH CROSSOVER, FOR SPEEDS ≥ 45 MPH TO 55 MPH
701601 - 07	URBAN LANE CLOSURE, MULTILANE, 1W OR 2W WITH NONTRAVERSABLE MEDIAN
701701 - 08	URBAN LANE CLOSURE, MULTILANE INTERSECTION
701901 - 02	TRAFFIC CONTROL DEVICES
704001 - 07	TEMPORARY CONCRETE BARRIER
720001 - 01	SIGN PANEL MOUNTING DETAILS
720006 - 03	SIGN PANEL ERECTION DETAILS

STD. NO.	TITLE
728001 - 01	TELESCOPING STEEL SIGN SUPPORT
731001 - 01	BASE FOR TELESCOPING STEEL SIGN SUPPORT
780001 - 03	TYPICAL PAVEMENT MARKINGS
781001 - 03	TYPICAL APPLICATIONS RAISED REFLECTIVE PAVEMENT MARKERS
814001 - 02	HANDHOLES
814006 - 02	DOUBLE HANDHOLES
857001 - 01	STANDARD PHASE DESIGNATION DIAGRAMS AND PHASE SEQUENCES
857006 - 01	SUPERVISED RAILROAD INTERCONNECT CIRCUIT
862001 - 01	UNINTERRUPTABLE POWER SUPPLY (UPS)
873001 - 02	TRAFFIC SIGNAL GROUNDING & BONDING
877001 - 05	STEEL MAST ARM ASSEMBLY AND POLE 16' THROUGH 55'
877006 - 04	STEEL MAST ARM ASSEMBLY AND POLE WITH DUAL MAST ARMS
878001 - 04	CONCRETE FOUNDATION DETAILS
880001 - 01	SPAN WIRE MOUNTED SIGNALS AND FLASHING BEACON INSTALLATION
880006 - 01	TRAFFIC SIGNAL MOUNTING DETAILS
886001 - 01	DETECTOR LOOP INSTALLATIONS

AGGREGATE SUBGRADE IMPROVEMENT (ASI) HAS BEEN PROVIDED FOR SOILS WHICH TEND TO BE UNSTABLE WHEN WET. THE ACTUAL NEED FOR REMOVAL AND REPLACEMENT WITH ASI WILL BE DETERMINED IN THE FIELD AT THE TIME OF CONSTRUCTION BY THE ENGINEER (BY USE OF A CONE PENETROMETER IN CONJUNCTION WITH THE IDOT STABILITY MANUAL). IF UNSUITABLE SOILS ARE ENCOUNTERED, THE SOILS SHALL BE REMOVED AND REPLACED WITH ASI. IF UNSUITABLE SOIL IS NOT ENCOUNTERED, THEN THE QUANTITY WILL BE DEDUCTED AND NO ADDITIONAL COMPENSATION WILL BE DUE THE CONTRACTOR. THE APPROXIMATE LIMITS AND DEPTHS OF REMOVAL AND ASI REPLACEMENT ARE:

A) US 30  
 1) 12" STA 1250+50 TO 1257+50 (FULL WIDTH)  
 2) 12" STA 1257+50 TO 1260+50 (RIGHT SIDE)  
 B) IL 31  
 1) 6" STA 129+50 TO 132+00 (WIDENING AREA)  
 C) RAMP A  
 1) 24" STA 301+00 TO 309+00 (FULL WIDTH)  
 D) RAMP B  
 1) 24" STA 407+75 TO 413+00 (FULL WIDTH)  
 E) RAMP C  
 1) 24" STA 501+00 TO 504+00 (FULL WIDTH)  
 F) RAMP D  
 1) 66" STA 605+00 TO 608+50 (FULL WIDTH)

GEOTECHNICAL FABRIC FOR GROUND STABILIZATION SHALL BE PROVIDED AND PLACED BELOW THE AGGREGATE SUBGRADE IMPROVEMENT.

Rev. 9-13-12

P:\CBS\2010\20103063\3\ad\_sfile.dgn\CO\016033-stn-generalNotes-01.dgn  
 6/15/2012 3:09:39 PM

<table border="1"> <tr><td>USER NAME</td><td>* 1654</td></tr> <tr><td>DESIGNED</td><td>- JWB</td></tr> <tr><td>DRAWN</td><td>- JWB</td></tr> <tr><td>CHECKED</td><td>- RS</td></tr> <tr><td>DATE</td><td>- 06/15/2012</td></tr> </table>	USER NAME	* 1654	DESIGNED	- JWB	DRAWN	- JWB	CHECKED	- RS	DATE	- 06/15/2012	<table border="1"> <tr><td>REVISED</td><td>-</td></tr> <tr><td>REVISED</td><td>-</td></tr> <tr><td>REVISED</td><td>-</td></tr> <tr><td>REVISED</td><td>-</td></tr> </table>	REVISED	-	REVISED	-	REVISED	-	REVISED	-	<p align="center"><b>STATE OF ILLINOIS</b> <b>DEPARTMENT OF TRANSPORTATION</b></p>	<p align="center"><b>U.S. ROUTE 30 AT IL ROUTE 31</b> <b>INDEX OF SHEETS AND HIGHWAY STANDARDS</b></p>	<table border="1"> <tr><td>F.A.P. RTE.</td><td>SECTION</td><td>COUNTY</td><td>TOTAL SHEETS</td><td>SHEET NO.</td></tr> <tr><td>349</td><td>(10 &amp; 11) VBI R-3</td><td>*</td><td>507</td><td>2</td></tr> <tr><td colspan="3">* KANE AND KENDALL</td><td colspan="2">CONTRACT NO. 60133</td></tr> <tr><td colspan="5">ILLINOIS FED. AID PROJECT</td></tr> </table>	F.A.P. RTE.	SECTION	COUNTY	TOTAL SHEETS	SHEET NO.	349	(10 & 11) VBI R-3	*	507	2	* KANE AND KENDALL			CONTRACT NO. 60133		ILLINOIS FED. AID PROJECT				
USER NAME	* 1654																																									
DESIGNED	- JWB																																									
DRAWN	- JWB																																									
CHECKED	- RS																																									
DATE	- 06/15/2012																																									
REVISED	-																																									
REVISED	-																																									
REVISED	-																																									
REVISED	-																																									
F.A.P. RTE.	SECTION	COUNTY	TOTAL SHEETS	SHEET NO.																																						
349	(10 & 11) VBI R-3	*	507	2																																						
* KANE AND KENDALL			CONTRACT NO. 60133																																							
ILLINOIS FED. AID PROJECT																																										
<table border="1"> <tr><td>PLOT SCALE</td><td>* 100.0000' / IN.</td></tr> <tr><td>PLOT DATE</td><td>* 6/15/2012</td></tr> </table>		PLOT SCALE	* 100.0000' / IN.	PLOT DATE	* 6/15/2012	<table border="1"> <tr><td>SCALE:</td><td>N.T.S.</td></tr> <tr><td>SHEET NO.:</td><td>--</td></tr> </table>	SCALE:	N.T.S.	SHEET NO.:	--																																
PLOT SCALE	* 100.0000' / IN.																																									
PLOT DATE	* 6/15/2012																																									
SCALE:	N.T.S.																																									
SHEET NO.:	--																																									

GENERAL NOTES

- BEFORE STARTING ANY EXCAVATION, THE CONTRACTOR SHALL CALL "J.U.L.I.E." AT 800-892-0123 FOR FIELD LOCATIONS OF BURIED ELECTRIC, TELEPHONE AND GAS FACILITIES. (48 HOUR NOTIFICATION IS REQUIRED).
- THE CONTRACTOR SHALL COORDINATE CONSTRUCTION ACTIVITIES WITH UTILITY COMPANIES.
- THE CONTRACTOR WILL NOT BE ALLOWED TO SET UP A YARD OR FIELD OFFICE ON STATE PROPERTY WITHOUT WRITTEN PERMISSION FROM THE DEPARTMENT.
- WHEN ARTIFICIAL LIGHTING IS USED IN NIGHT OPERATIONS THE CONTRACTOR SHALL EXERCISE THE UTMOST PRECAUTIONS IN PREVENTING ADVERSE VISIBILITY TO THE MOTORING PUBLIC AND ADJOINING RESIDENTIAL AREAS.
- WHEN MILLED PAVEMENT IS OPEN TO TRAFFIC THE MAXIMUM GRADE DIFFERENTIAL BETWEEN PASSES OF THE MILLING MACHINE SHALL NOT EXCEED 40 MM (1 1/2 INCHES) WHERE THE SPEED LIMIT IS 80 KM/H (45 MPH) OR LESS AND 25 MM (1 INCH) WHERE THE SPEED LIMIT IS GREATER THAN 80 KM/H (45 MPH). WITH WRITTEN APPROVAL FROM THE ENGINEER, A MAXIMUM GRADE DIFFERENTIAL OF 75 MM (3 INCHES) MAY BE ALLOWED IF THE EDGE OF THE MILLING IS SLOPED A MINIMUM 1:3 (V:H).
- BUTT JOINTS WILL BE INSTALLED AT THE ENDS OF ALL RESURFACING (WHERE RESURFACING MEETS EXISTING PAVEMENT), IN ACCORDANCE WITH THE "BUTT JOINT AND HMA TAPER DETAILS" SHEET INCLUDED IN THE PLANS, UNLESS OTHERWISE SPECIFIED.
- THE CONTRACTOR SHALL CONTACT THE TRAFFIC CONTROL SUPERVISOR AT (847) 705-4470 A MINIMUM 72 HOURS IN ADVANCE OF BEGINNING WORK.
- THE RESIDENT ENGINEER SHALL CONTACT DON CHIARUGI, AREA TRAFFIC FIELD ENGINEER AT (847) 741-9857 AT LEAST (2) WEEKS PRIOR TO PLACEMENT OF PERMANENT PAVEMENT MARKINGS.
- REFER TO DISTRICT ONE TYPICAL PAVEMENT MARKINGS (TC 13) AND RAISED REFLECTIVE PAVEMENT MARKERS (TC11) FOR ADDITIONAL DETAILS NOT SHOWN ON THESE PLANS.
- MATCH EXISTING PAVEMENT MARKINGS AT PROJECT LIMITS.
- POLYUREA PAVEMENT MARKINGS SHALL BE USED ON CONCRETE SURFACES AND THERMOPLASTIC PAVEMENT MARKINGS SHALL BE USED ON HMA SURFACES.
- TWO WEEKS PRIOR TO PLACEMENT OF PERMANENT PAVEMENT MARKINGS THE ENGINEER SHALL CONTACT DON CHIARUGI, AREA TRAFFIC FIELD ENGINEER, AT (847) 741-9857.
- EXCEPT AS NOTED ON THE PLANS, PAVEMENT GRADES SHOWN ARE AT THE TOP OF PAVEMENT SURFACES.
- FOR STABILIZATION, ALL TYPE III BARRICADES SHALL REQUIRE A MINIMUM OF FOUR SAND BAGS PER BARRICADE.
- PERMANENT SEEDING SHALL NOT BE PLACED AT ANY TIME WHEN THE GROUND IS FROZEN, WET, OR IN AN UNTILLABLE CONDITION.
- EROSION CONTROL MEASURES SHALL BE MAINTAINED AND REMAIN IN PLACE UNTIL CONSTRUCTION IS COMPLETE AND WORK AREAS ARE STABILIZED.
- ONLY THOSE TREES DESIGNATED BY THE ENGINEER OR LISTED IN THE TREE REMOVAL SCHEDULE SHALL BE REMOVED. THE CONTRACTOR SHALL PROTECT ALL REMAINING TREES FROM DAMAGE
- ALL ELEVATIONS REFERRING TO U.S.G.S. MEAN SEA LEVEL DATUM.
- ABANDONED UNDERGROUND UTILITIES THAT CONFLICT WITH CONSTRUCTION SHALL BE DISPOSED OF OUTSIDE OF THE LIMITS OF THE RIGHT OF WAY ACCORDING TO ARTICLE 202.03 OF THE STANDARD SPECIFICATIONS AND AS DIRECTED BY THE ENGINEER. THIS WORK WILL NOT BE PAID FOR SEPARATELY, BUT SHALL BE INCLUDED IN THE COST OF EARTH EXCAVATION.
- THE WORK REQUIRED TO CONNECT PROPOSED STORM SEWER TO AN EXISTING DRAINAGE STRUCTURE OR PIPE WILL NOT BE PAID FOR SEPARATELY, BUT INCLUDED IN THE COST OF THE PROPOSED DRAINAGE ITEMS.
- THE QUANTITY FOR PAVEMENT REMOVAL INCLUDES PAVEMENT REMOVAL AND PAVED SHOULDER REMOVAL AS THEY APPEAR ON THE REMOVAL PLANS.

GENERAL NOTES

- THE WORK REQUIRED TO CONNECT EXISTING STORM SEWERS TO PROPOSED DRAINAGE STRUCTURES WILL NOT BE PAID FOR SEPARATELY, BUT INCLUDED IN THE COST OF THE PROPOSED DRAINAGE ITEMS.
- THE CONTRACTOR'S ATTENTION IS DIRECTED TO THE PRESENCE OF DEPARTMENT OWNED UNDERGROUND ELECTRICAL CABLE WITHIN THE LIMITS OF THE PROPOSED IMPROVEMENT. THE CONTRACTOR SHALL REQUEST THE ILLINOIS DEPARTMENT OF TRANSPORTATION IN SCHAUMBURG A MINIMUM OF 72 HOURS NOTICE. THE DEPARTMENT IS NOT A MEMBER OF THE JOINT UTILITY LOCATING INFORMATION FOR EXCAVATORS (JULIE) SYSTEM.
- ALL DAMAGE TO DEPARTMENT OWNED UNDERGROUND FACILITIES, CAUSED BY THE CONTRACTOR SHALL BE REPAIRED TO THE SATISFACTION OF THE DEPARTMENT AT THE CONTRACTOR'S EXPENSE. THIS SHALL INCLUDE ALL TEMPORARY REPAIRS REQUIRED TO KEEP THE FACILITY OPERATIONAL WHILE MATERIAL IS BEING OBTAINED TO MAKE PERMANENT REPAIRS. SPLICING OF ELECTRIC CABLE SHALL NOT BE ALLOWED. ELECTRIC CABLE SHALL BE REPLACED FROM POLE TO POLE OR CONTROLLER.
- UNDERCUTTING SHALL BE PERFORMED UNDER PAVEMENT WIDENING, HMA SHOULDER, AGGREGATE SHOULDER, AND PAVED ENTRANCE/MAIL BOX TURNOUT AREAS WHEN REQUIRED BY SOIL CONDITIONS. POROUS GRANULAR EMBANKMENT, SUBGRADE SHALL BE USED TO FILL UNDERCUT CAVITIES. UNDERCUTTING DEPTH SHALL RANGE BETWEEN 6" AND 12" BEYOND THE BOTTOM OF THE STANDARD SECTIONS FOUND IN THE TYPICAL SECTIONS.
- THE CONTRACTOR SHALL BE REQUIRED TO PROVIDE ACCESS TO ABUTTING PROPERTY AT ALL TIMES DURING THE CONSTRUCTION OF THIS PROJECT.
- A 404 PERMIT APPLICATION HAS BEEN SUBMITTED BY THE DEPARTMENT FOR THE WORK SHOWN IN THE PLANS. THE PERMIT ISSUED TO THE DEPARTMENT DOES NOT COVER THE IN STREAM WORK BY THE CONTRACTOR. THEREFORE AFTER AWARD, THE CONTRACTOR WILL NEED TO SUBMIT THE WORK PLAN TO THE CORPS. THE CORPS WILL NOT BE PROVIDING AN APPROVAL UNLESS STATED OTHERWISE IN THE PERMIT AND IN STREAM WORK CAN COMMENCE AT THE CONTRACTOR'S DISCRETION. GUIDELINES ON ACCEPTABLE IN STREAM WORK TECHNIQUES CAN BE FOUND ON THE CORPS WEBSITE: <http://www.lrc.usace.army.mil/>
- FOR WORK OUTSIDE THE LIMITS OF THE BRIDGE APPROACH PAVEMENT, ALL REFERENCES IN THE HIGHWAY STANDARDS AND STANDARD SPECIFICATIONS FOR REINFORCEMENT, DOWEL BARS AND TIE BARS IN PAVEMENT, SHOULDERS, CURB, GUTTER, COMBINATION CURB & GUTTER AND MEDIAN, AND CHAIR SUPPORTS FOR CRC PAVEMENT, SHALL BE EPOXY COATED, UNLESS NOTED ON THE PLANS.
- FOR STORM SEWERS CONSTRUCTED UNDER ROADWAY, BACKFILLING METHODS TWO AND THREE AUTHORIZED UNDER THE PROVISIONS OF ARTICLE 550.07 OF THE STANDARD SPECIFICATIONS WILL NOT BE ALLOWED.
- THE CONTRACTOR'S ATTENTION IS CALLED TO THE FACT THAT THE PRESERVATION OF EXISTING TREES IS OF UTMOST IMPORTANCE TO THE VILLAGE OF MONTGOMERY. ALL TREE PROTECTION, TREE REMOVAL, PRUNING AND ROOT PRUNING SHALL BE COMPLETED BEFORE CONSTRUCTION OPERATIONS COMMENCE IN ANY AREA. AT NO TIME SHALL THE CONTRACTOR PRUNE OR REMOVE ANY TREES UNLESS SPECIFICALLY DIRECTED BY THE ENGINEER.
- TEMPORARY FENCE SHOULD BE ERECTED ALONG THE DRIPLINE OF THE TREES, SHRUBS, AND LANDSCAPED BEDS WITHIN THE LIMITS OF CONSTRUCTION DESIGNATED TO REMAIN TO ESTABLISH A "TREE PROTECTION ZONE" AND AROUND EXISTING WETLANDS TO ESTABLISH A "WETLAND PROTECTION ZONE" BEFORE ANY WORK BEGINS OR ANY MATERIAL IS DELIVERED TO THE JOBSITE. NO WORK IS TO BE PERFORMED (OTHER THAN ROOT PRUNING), MATERIALS STORED OR VEHICLES DRIVEN OR PARKED WITHIN THE "TREE PROTECTION ZONE" AND "WETLAND PROTECTION ZONE". REMOVE PROTECTIVE TEMPORARY FENCE ONLY AFTER ALL CONSTRUCTION WORK HAS BEEN COMPLETED.
- THE CONTRACTOR SHALL ATTACH AN ALUMINUM SIGN WITH THE FOLLOWING TEXT: "PROTECTED WETLAND - NO INTRUSION". THE SIGN(S) SHALL BE ATTACHED TO THE STAKES BY A METHOD APPROVED BY THE ENGINEER. THE SIGN(S) WILL BE PROVIDED BY THE DEPARTMENT AND SHALL BE PICKED UP BY THE CONTRACTOR FROM THE DISTRICT ONE ROADSIDE DEVELOPMENT ARCHITECT IN SCHAUMBURG, ILLINOIS, SCHEDULING THE PICKUP OF THE SIGNS CAN BE ARRANGED BY CONTACTING THE DISTRICT ONE ROADSIDE DEVELOPMENT UNIT AT (847)705-4171. WHEN WORK HAS BEEN COMPLETED, THE SIGN SHALL BE RETURNED TO THE DISTRICT ONE ROADSIDE DEVELOPMENT UNIT. THE COST OF PICKING UP, ATTACHING THE SIGNS TO THE TEMPORARY FENCE STAKES AND RETURNING THE SIGNS WILL NOT BE PAID FOR SEPARATELY, BUT SHALL BE INCLUDED IN THE CONTRACT UNIT PRICE FOR TEMPORARY FENCE.

COMMITMENTS

- NO COMMITMENTS HAVE BEEN MADE FOR THIS PROJECT.

THE CONTRACTOR SHALL MILL BEFORE PATCHING

HOT-MIX ASPHALT MIXTURE REQUIREMENTS	
MIXTURE TYPE	AIR VOIDS @ 100c
PAVEMENT WIDENING AND RESURFACING (US 30)	
POLYMERIZED HOT-MIX ASPHALT SURFACE COURSE, MIX "F", N90 (IL 9.5 mm); 2"	4.0% @ 90 Gyr.
LEVELING BINDER (MACHINE METHOD), N70; 3/4" AND VARIES	4.0% @ 70 Gyr.
HMA BASE COURSE, 10" OR HMA BASE COURSE WIDENING, 10" (HMA BINDER IL-19mm)	4.0% @ 70 Gyr.
PAVEMENT WIDENING AND RESURFACING (IL 31)	
HOT-MIX ASPHALT SURFACE COURSE, MIX "D", N70 (IL 9.5 mm); 2"	4.0% @ 70 Gyr.
LEVELING BINDER (MACHINE METHOD), N70; 1" AND VARIES	4.0% @ 70 Gyr.
HMA BASE COURSE, 10" OR HMA BASE COURSE WIDENING, 10" (HMA BINDER IL-19mm)	4.0% @ 70 Gyr.
PAVEMENT RESURFACING (IL 31)	
HOT-MIX ASPHALT SURFACE COURSE, MIX "D", N70 (IL 9.5 mm); 2"	4.0% @ 70 Gyr.
LEVELING BINDER (MACHINE METHOD), N70; 1" AND VARIES	4.0% @ 70 Gyr.
FULL DEPTH PAVEMENT (US 30)	
POLYMERIZED HOT-MIX ASPHALT SURFACE COURSE, MIX "F", N90 (IL 9.5 mm); 2"	4.0% @ 90 Gyr.
POLYMERIZED HOT-MIX ASPHALT BINDER COURSE, IL-19.0, N90; TOP 2-1/4"	4.0% @ 90 Gyr.
HOT-MIX ASPHALT BINDER COURSE, IL-19.0, N90; 8-1/2" (IN 2 LIFTS)	4.0% @ 90 Gyr.
PAVEMENT RECONSTRUCTION (IL 31)	
HOT-MIX ASPHALT SURFACE COURSE, MIX "D", N70 (IL 9.5 mm); 2"	4.0% @ 70 Gyr.
HMA BASE COURSE, 10" (HMA BINDER IL-19mm)	4.0% @ 70 Gyr.
FULL DEPTH PAVEMENT (RAMPS)	
HOT-MIX ASPHALT SURFACE COURSE, MIX "D", N70 (IL 9.5 mm); 2"	4.0% @ 70 Gyr.
HOT-MIX ASPHALT BINDER COURSE, IL-19.0, N70; 10-1/2" (IN 3 LIFTS)	4.0% @ 70 Gyr.
DRIVEWAYS	
HOT-MIX ASPHALT SURFACE COURSE, MIX "D", N50 (IL 9.5 mm); 2"	4.0% @ N50 Gyr.
HMA BASE COURSE (HMA BINDER IL-19 mm); CE - 8" (IN 2 LIFTS)	4.0% @ N50 Gyr.
PATCHING	
CLASS "D" PATCHES (HMA BINDER IL 19mm)	4.0% @ 70 Gyr.
HOT-MIX ASPHALT SHOULDERS, 12-3/4" (US 30 & IL 31)	
HOT-MIX ASPHALT SURFACE COURSE, MIX "D", N70 (IL 9.5 mm); 2"	4.0% @ 70 Gyr.
HOT-MIX ASPHALT BINDER COURSE, IL-19.0, N70; 10-3/4" (IN 3 LIFTS)	4.0% @ 70 Gyr.
HOT-MIX ASPHALT SHOULDERS, 12-1/2" (RAMPS)	
HOT-MIX ASPHALT SURFACE COURSE, MIX "D", N70 (IL 9.5 mm); 2"	4.0% @ 70 Gyr.
HOT-MIX ASPHALT BINDER COURSE, IL-19.0, N70; 10-1/2" (IN 3 LIFTS)	4.0% @ 70 Gyr.
TEMPORARY PAVEMENT*	
HOT-MIX ASPHALT SURFACE COURSE, MIX "D", N50 (IL 9.5 mm); 2"	4.0% @ 50 Gyr.
TEMPORARY PAVEMENT (HMA BINDER, IL-19mm), 8" (IN 2 LIFTS)	4.0% @ 50 Gyr.

THE UNIT WEIGHT USED TO CALCULATE ALL HMA SURFACE MIXTURES IS 112 LBS/SQ YD/IN. THE "AC TYPE" FOR POLYMERIZED HMA MIXES SHALL BE "SBS/SBR PG 76-22" AND FOR NON-POLYMERIZED HMA THE "AC TYPE" SHALL BE "PG 64-22" UNLESS MODIFIED BY DISTRICT ONE SPECIAL PROVISIONS. FOR "PERCENT OF RAP" SEE SPECIAL PROVISIONS.

\*PCC TEMPORARY PAVEMENT SHALL CONSIST OF CLASS PV CONCRETE MEETING THE REQUIREMENTS OF ARTICLE 1020 OF THE STANDARD SPECIFICATIONS. PCC THICKNESS SHALL BE 8".

\*TEMPORARY PAVEMENT USING EITHER HMA OR PCC OPTION SHALL BE PLACED ON A 4" AGGREGATE BASE COURSE. THE COST OF THE AGGREGATE BASE COURSE SHALL BE INCLUDED IN THE COST OF EITHER TEMPORARY HMA OR PCC PAVEMENT.

P:\Jobs\2010-2010-2003-CAD\Site.dgn, VCC\01013-shr-Gener alnotes-02.dgn  
 9/13/2012 10:12:28 AM

USER NAME * 1654	DESIGNED - JWB	REVISED - CRAEF 09-11-12
DRAWN - JWB	REVISIONS -	
PLOT SCALE * 100.0000 / IN.	CHECKED - RS	REVISIONS -
PLOT DATE * 9/13/2012	DATE - 06/15/2012	REVISIONS -

STATE OF ILLINOIS  
DEPARTMENT OF TRANSPORTATION

U.S. ROUTE 30 AT IL ROUTE 31  
GENERAL NOTES, COMMITMENTS, & HMA MIXTURE REQUIREMENTS

SCALE: N.T.S. SHEET NO. --

F.A.P. RTE.	SECTION	COUNTY	TOTAL SHEETS	SHEET NO.
349	(10 & 11) VBI R-3	*	507	3
* KANE AND KENDALL			CONTRACT NO. 60133	
ILLINOIS FED. AID PROJECT				

CODE NO.	DESCRIPTION	UNIT	URBAN TOTAL QUANTITY	ROADWAY 0003		BRIDGE 0013	TRAFFIC SIGNALS 0021				LIGHTING 0021		RETAINING WALL 0040		
				KANE COUNTY	KENDALL COUNTY		IL 31 AT EB US 30 RAMPS		VILLAGE OF MONTGOMERY	KANE COUNTY	KANE COUNTY	IL 31 INTERCONNECT		KANE COUNTY	KENDALL COUNTY
							80% FED 20% STATE	80% FED 20% STATE							
				80% FED 20% STATE	80% FED 20% STATE		80% FED 20% STATE	80% FED 20% STATE	100% VILLAGE	80% FED 20% STATE	80% FED 20% STATE	80% FED 20% STATE		80% FED 20% STATE	80% FED 20% STATE
28000315	AGGREGATE DITCH CHECKS	TON	1,240	1,240											
28000400	PERIMETER EROSION BARRIER	FOOT	12,365	12,365											
<b>28000500</b>	<b>INLET AND PIPE PROTECTION</b>	<b>EACH</b>	<b>8</b>	<b>8</b>											
28000510	INLET FILTERS	EACH	73	73											
28100105	STONE RIPRAP, CLASS A3	SO YD	780	780											
28100107	STONE RIPRAP, CLASS A4	SO YD	913	155		758									
28100109	STONE RIPRAP, CLASS A5	SO YD	1,280	1,280											
28200200	FILTER FABRIC	SO YD	4982	4224		758									
<b>30300001</b>	<b>AGGREGATE SUBGRADE IMPROVEMENT</b>	<b>CU YD</b>	<b>30,778</b>	<b>30,778</b>											
30300112	AGGREGATE SUBGRADE IMPROVEMENT, 12"	SO YD	56,045	54,038	2,007										
35501316	HOT-MIX ASPHALT BASE COURSE, 8"	SO YD	221	221											
35501324	HOT-MIX ASPHALT BASE COURSE, 10"	SO YD	2766	2766											
<b>35501327</b>	<b>HOT-MIX ASPHALT BASE COURSE 10 3/4"</b>	<b>SO YD</b>	<b>10,310</b>	<b>10,310</b>											
35600716	HOT-MIX ASPHALT BASE COURSE WIDENING, 10"	SO YD	597	233	364										
40600200	BITUMINOUS MATERIALS (PRIME COAT)	TON	50	41	9										
40600300	AGGREGATE (PRIME COAT)	TON	298	217	81										
40600400	MIXTURE FOR CRACKS, JOINTS, AND FLANGEWAYS	TON	57	27	30										
40600635	LEVELING BINDER (MACHINE METHOD), N70	TON	2193	1,065	1128										
40600895	CONSTRUCTING TEST STRIP	EACH	3	3											
40600982	HOT-MIX ASPHALT SURFACE REMOVAL - BUTT JOINT	SO YD	4,701	2,999	1,702										
40603335	HOT-MIX ASPHALT SURFACE COURSE, MIX "D", N50	TON	25	25											

Rev. 9-13-12

Rev.

5/23/2012 3:59:08 PM

USER NAME * 1654	DESIGNED - JWB	REVISED -
DRAWN - JWB	REVISED -	
PLOT SCALE * 100.0000 / IN.	CHECKED - RS	REVISED -
PLOT DATE * 5/23/2012	DATE - 05/23/2012	REVISED -

STATE OF ILLINOIS  
DEPARTMENT OF TRANSPORTATION

U.S. ROUTE 30 AT IL ROUTE 31  
SUMMARY OF QUANTITIES

SHEET NO. 500-2 OF 19

F.A.P. RTE.	SECTION	COUNTY	TOTAL SHEETS	SHEET NO.
349	(10 & 11 VB) R-3		507	5
* KANE AND KENDALL			CONTRACT NO. 60133	
[ILLINOIS] FED. AID PROJECT				

CODE NO.	DESCRIPTION	UNIT	URBAN TOTAL QUANTITY	ROADWAY 0003		BRIDGE 0013	TRAFFIC SIGNALS 0021				LIGHTING 0021		RETAINING WALL 0040	
				KANE COUNTY	KENDALL COUNTY		IL 31 AT EB US 30 RAMP		IL 31 AT WB US 30 RAMP	US 30 AT RAMP	IL 31 INTERCONNECT	KANE COUNTY		KENDALL COUNTY
							KANE COUNTY	VILLAGE OF MONTGOMERY						
				80% FED 20% STATE	80% FED 20% STATE		80% FED 20% STATE	80% FED 20% STATE	100% VILLAGE	80% FED 20% STATE	80% FED 20% STATE	80% FED 20% STATE		80% FED 20% STATE
40603340	HOT-MIX ASPHALT SURFACE COURSE, MIX "D", N70	TON	5087	2031	2256									
40603595	POLYMERIZED HOT-MIX ASPHALT SURFACE COURSE, MIX "F", N90	TON	605	605										
40701931	HOT-MIX ASPHALT PAVEMENT (FULL DEPTH), 12 1/2"	SQ YD	10,452	10,452										
40701936	HOT-MIX ASPHALT PAVEMENT (FULL DEPTH), 12 3/4"	SQ YD	14,988	14,988										
42000501	PORTLAND CEMENT CONCRETE PAVEMENT 10" (JOINTED)	SQ YD	494	391	103									
42001420	BRIDGE APPROACH PAVEMENT CONNECTOR (PCC)	SQ YD	197	197										
42001430	BRIDGE APPROACH PAVEMENT CONNECTOR (FLEXIBLE)	SQ YD	52	52										
44000100	PAVEMENT REMOVAL	SQ YD	37,626	36,247	1379									
44000200	DRIVEWAY PAVEMENT REMOVAL	SQ YD	1425	1425										
44000500	COMBINATION CURB AND GUTTER REMOVAL	FOOT	6,393	6,393										
44003100	MEDIAN REMOVAL	SQ FT	39,952	33,477	6,475									
44200974	CLASS B PATCHES, TYPE III, 10 INCH	SQ YD	51	34	17									
44201299	DOWEL BARS 1 1/2"	EACH	60	40	20									
44201803	CLASS D PATCHES, TYPE II, 13 INCH	SQ YD	3,931	1,887	2,044									
44201807	CLASS D PATCHES, TYPE III, 13 INCH	SQ YD	387	185	202									
44201809	CLASS D PATCHES, TYPE IV, 13 INCH	SQ YD	673	395	278									
44213200	SAW CUTS	FOOT	144	96	48									
44213208	TIE BARS 1 1/4"	EACH	60	40	20									
44300200	STRIP REFLECTIVE CRACK CONTROL TREATMENT	FOOT	23,923	12,605	11,318									
48101600	AGGREGATE SHOULDERS, TYPE B, 8"	SQ YD	3558	2768	790									

FILES 5/23/2012 3:59:19 PM

USER NAME * 165*	DESIGNED - JWB	REVISED -
PLOT SCALE * 1/80.0000 "/ IN.	DRAWN - JWB	REVISED -
PLOT DATE * 5/23/2012	CHECKED - RS	REVISED -
	DATE - 05/23/2012	REVISED -

STATE OF ILLINOIS  
DEPARTMENT OF TRANSPORTATION

U.S. ROUTE 30 AT IL ROUTE 31  
SUMMARY OF QUANTITIES

SHEET NO. 500-3 OF 19

F.A.P. RTE.	SECTION	COUNTY	TOTAL SHEETS	SHEET NO.
349	(10 & 11 VB) R-3		507	6
* KANE AND KENDALL			CONTRACT NO. 60133	
ILLINOIS FED. AID PROJECT				

Rev. 9-13-12

Rev.

CODE NO.	DESCRIPTION	UNIT	TOTAL QUANTITY	URBAN		BRIDGE 0013	TRAFFIC SIGNALS 0021				LIGHTING 0021		RETAINING WALL 0040	
				ROADWAY 0003			IL 31 AT EB US 30 RAMPS		IL 31 AT WB US 30 RAMPS	US 30 AT RAMPS	IL 31 INTERCONNECT	KANE COUNTY		KENDALL COUNTY
				KANE COUNTY	KENDALL COUNTY		KANE COUNTY	KANE COUNTY	VILLAGE OF MONTGOMERY	KANE COUNTY	KANE COUNTY			
				80% FED 20% STATE	80% FED 20% STATE		80% FED 20% STATE	80% FED 20% STATE	100% VILLAGE	80% FED 20% STATE	80% FED 20% STATE	80% FED 20% STATE		80% FED 20% STATE
59000200	EPOXY CRACK INJECTION	FOOT	228			228								
59100100	GEOCOMPOSITE WALL DRAIN	50 YD	372			178							194	
59300100	<b>CONTROLLED LOW-STRENGTH MATERIAL</b>	<b>CU YD</b>	<b>123</b>	<b>123</b>										
60100060	CONCRETE HEADWALLS FOR PIPE DRAINS	EACH	25	25										
60107600	PIPE UNDERDRAINS 4"	FOOT	1,867	1,733	134									
60108100	PIPE UNDERDRAINS 4" (SPECIAL)	FOOT	612	606	6									
60200805	CATCH BASINS, TYPE A, 4" DIAMETER, TYPE 8 GRATE	EACH	4	4										
60201005	CATCH BASINS, TYPE A, 4" DIAMETER, TYPE 10 FRAME AND GRATE	EACH	2	2										
60201110	CATCH BASINS, TYPE A, 4" DIAMETER, TYPE 11V FRAME AND GRATE	EACH	4	4										
60201340	CATCH BASINS, TYPE A, 4" DIAMETER, TYPE 24 FRAME AND GRATE	EACH	29	26	3									
60208240	CATCH BASINS, TYPE C, TYPE 24 FRAME AND GRATE	EACH	45	44	1									
60218300	MANHOLES, TYPE A, 4" DIAMETER, TYPE 1 FRAME, OPEN LID	EACH	1	1										
60218400	MANHOLES, TYPE A, 4" DIAMETER, TYPE 1 FRAME, CLOSED LID	EACH	17	17										
60221100	MANHOLES, TYPE A, 5" DIAMETER, TYPE 1 FRAME, CLOSED LID	EACH	3	3										
60223700	MANHOLES, TYPE A, 6" DIAMETER, TYPE 1 FRAME, OPEN LID	EACH	1	1										
60224005	MANHOLES, TYPE A, 6" DIAMETER, TYPE 8 GRATE	EACH	1	1										
60270050	DRAINAGE STRUCTURES, TYPE 4 WITH TWO TYPE 20 FRAME AND GRATES	EACH	3	3										
60270055	DRAINAGE STRUCTURES, TYPE 5 WITH TWO TYPE 22 FRAME AND GRATES	EACH	1	1										
60300305	FRAMES AND LIDS TO BE ADJUSTED	EACH	3	3										

3:59:24 PM 5/23/2012

USER NAME * J654	DESIGNED - JWB	REVISED -
DRAWN - JWB	REVISED -	
PLLOT SCALE * 100.0000' / IN.	CHECKED - RS	REVISED -
PLLOT DATE * 5/23/2012	DATE - 05/23/2012	REVISED -

**STATE OF ILLINOIS  
DEPARTMENT OF TRANSPORTATION**

**U.S. ROUTE 30 AT IL ROUTE 31  
SUMMARY OF QUANTITIES**

SHEET NO. 500-6 OF 19

Rev. 9-13-12

Rev.

F.A.P. RTE.	SECTION	COUNTY	TOTAL SHEETS	SHEET NO.
349	(10 & 11 VB) R-3		507	11
* KANE AND KENDALL		CONTRACT NO. 60133		
ILLINOIS FED. AID PROJECT				

CODE NO.	DESCRIPTION	UNIT	TOTAL QUANTITY	URBAN		BRIDGE 0013	TRAFFIC SIGNALS 0021				LIGHTING 0021		RETAINING WALL 0040		
				ROADWAY 0003			IL 31 AT EB US 30 RAMP		IL 31 AT WB US 30 RAMP	US 30 AT RAMP	IL 31 INTERCONNECT	KANE COUNTY		KENDALL COUNTY	KANE COUNTY
				KANE COUNTY	KENDALL COUNTY		KANE COUNTY	VILLAGE OF MONTGOMERY	KANE COUNTY	KANE COUNTY	KANE COUNTY				
80% FED 20% STATE	80% FED 20% STATE	80% FED 20% STATE	80% FED 20% STATE	100% VILLAGE	80% FED 20% STATE	80% FED 20% STATE	80% FED 20% STATE	80% FED 20% STATE	80% FED 20% STATE	80% FED 20% STATE					
64300240	IMPACT ATTENUATORS (FULLY REDIRECTIVE, NARROW), TEST LEVEL 2	EACH	1	1											
64300260	IMPACT ATTENUATORS (FULLY REDIRECTIVE, NARROW), TEST LEVEL 3	EACH	2	2											
67100100	MOBILIZATION	L SUM	1	1											
70103815	TRAFFIC CONTROL SURVEILLANCE	CAL DAY	45	45											
70106800	CHANGEABLE MESSAGE SIGN	CAL MO	18	18											
70300100	SHORT-TERM PAVEMENT MARKING	FOOT	11,024	9,138	1,886										
70300210	TEMPORARY PAVEMENT MARKING - LETTERS AND SYMBOLS	SO FT	1,298	570	728										
70300220	TEMPORARY PAVEMENT MARKING - LINE, 4"	FOOT	89,513	77,043	12,470										
70300240	TEMPORARY PAVEMENT MARKING - LINE 6"	FOOT	5,753	3,807	1,946										
70300250	TEMPORARY PAVEMENT MARKING - LINE 8"	FOOT	2,068	956	1,112										
70300260	TEMPORARY PAVEMENT MARKING - LINE 12"	FOOT	1,624	1,120	504										
70300280	TEMPORARY PAVEMENT MARKING - LINE, 24"	FOOT	766	378	388										
70301000	WORK ZONE PAVEMENT MARKING REMOVAL	SO FT	26,780	18,279	8,501										
70400100	TEMPORARY CONCRETE BARRIER	FOOT	3,386	3,386											
70400200	RELOCATE TEMPORARY CONCRETE BARRIER	FOOT	2,744	2,744											
* 72000100	SIGN PANEL - TYPE 1	SO FT	339	257	82										
* 72000200	SIGN PANEL - TYPE 2	SO FT	376	340	23			13							
* 72400100	REMOVE SIGN PANEL ASSEMBLY - TYPE A	EACH	62	51	11										

\* Specialty Items

Rev. 9-13-12

Rev.

USER NAME • 1654	DESIGNED - JWB	REVISED -
DRAWN - JWB	REVISOR -	
PLOT SCALE • 100.0000' / 1"	CHECKED - RS	REVISOR -
PLOT DATE • 5/23/2012	DATE - 05/23/2012	REVISOR -

STATE OF ILLINOIS  
DEPARTMENT OF TRANSPORTATION

U.S. ROUTE 30 AT IL ROUTE 31  
SUMMARY OF QUANTITIES

F.A.P. RTE.	SECTION	COUNTY	TOTAL SHEETS	SHEET NO.
349	(10 & 11) VBI R-3		507	13
* KANE AND KENDALL		CONTRACT NO. 60133		
ILLINOIS FED. AID PROJECT				

SHEET NO. 500-10 OF 19

FILED 2/23/2012 3:59:26 PM

**EXISTING CONDITIONS**

- (A) HOT-MIX ASPHALT SURFACE COURSE 2 1/2"-3"
- (B) PORTLAND CEMENT CONCRETE PAVEMENT, 10"
- (C) PORTLAND CEMENT CONCRETE BASE COURSE, 9"-10"
- (D) HOT-MIX ASPHALT BASE COURSE, 11 1/4"
- (E) HOT-MIX ASPHALT SHOULDER, 8"
- (F) AGGREGATE SHOULDER, 6"-8"
- (G) COMBINATION CONCRETE CURB & GUTTER, TYPE B-6.12 OR B-6.24
- (H) MEDIAN SURFACE, 12"
- (I) EXISTING GROUND
- (J) GRANULAR SUBBASE, THICKNESS VARIES

**PROPOSED IMPROVEMENTS**

- (1) POLYMERIZED HOT-MIX ASPHALT SURFACE COURSE, MIX "F", N90: 2"
- (2) HOT-MIX ASPHALT SURFACE COURSE, MIX "D", N70: 2"
- (3) LEVELING BINDER (MACHINE METHOD), N70: 3/4" & VAR. ON US 30, 1" ON IL 31 & VAR.
- (4) (US 30) HOT-MIX ASPHALT PAVEMENT (FULL DEPTH), 12 3/4" CONSISTING OF:  
POLYMERIZED HOT-MIX ASPHALT SURFACE COURSE, MIX "F", N90: 2"  
POLYMERIZED HOT-MIX ASPHALT BINDER COURSE, IL-19.0, N90: 2 1/4"  
HOT-MIX ASPHALT BINDER COURSE, IL-19.0, N90: 8 1/2"
- (5) PAVEMENT RECONSTRUCTION (IL 31) CONSISTING OF:  
HOT-MIX ASPHALT SURFACE COURSE, MIX "D", N70: 2"  
HOT-MIX ASPHALT BASE COURSE: 10 3/4"
- (6) (RAMPS) HOT-MIX ASPHALT PAVEMENT (FULL DEPTH), 12 1/2" CONSISTING OF:  
HOT-MIX ASPHALT SURFACE COURSE, MIX "D", N70: 2"  
HOT-MIX ASPHALT BINDER COURSE, IL-19.0, N70: 10 1/2"
- (7) (US 30 & IL 31) HOT-MIX ASPHALT SHOULDERS, 12 3/4" CONSISTING OF:  
HOT-MIX ASPHALT SURFACE COURSE, MIX "D", N70: 2"  
HOT-MIX ASPHALT BINDER COURSE, IL-19.0, N70: 10 3/4"
- (8) (RAMPS) HOT-MIX ASPHALT SHOULDERS, 12 1/2" CONSISTING OF:  
HOT-MIX ASPHALT SURFACE COURSE, MIX "D", N70: 2"  
HOT-MIX ASPHALT BINDER COURSE, IL-19.0, N70: 10 1/2"
- (9) COMBINATION CONCRETE CURB & GUTTER, TYPE B-6.24
- (10) AGGREGATE SUBGRADE IMPROVEMENT, 12"
- (11) AGGREGATE SHOULDER, TYPE B, 8"
- (12) AGGREGATE WEDGE SHOULDER, TYPE B
- (13) STRIP REFLECTIVE CRACK CONTROL TREATMENT
- (14) CONCRETE MEDIAN SURFACE, 4"
- (15) PORTLAND CEMENT CONCRETE PAVEMENT, 10" (JOINTED)
- (16) PORTLAND CEMENT CONCRETE SHOULDERS, 10"
- (17) TOPSOIL, FURNISH & PLACE, 4", FERTILIZER NUTRIENTS AND SEEDING OR SODDING. SEE LANDSCAPING PLANS FOR LOCATIONS AND SEEDING TYPE.
- (18) TOPSOIL, FURNISH & PLACE, 30", FERTILIZER NUTRIENTS, SEEDING CLASS 2A AND EROSION CONTROL BLANKET
- (19) EPOXY COATED, DEFORMED, NO. 6 TIE BARS, 24" LONG @ 24" C-C  
COST INCIDENTAL TO PCC PAVT, CONC C & G AND CONC MEDIAN TY SB-6
- (20) EPOXY COATED, DEFORMED, NO. 6 TIE BARS, 30" LONG @ 24" C-C  
COST INCIDENTAL TO PCC SHOULDERS, 10"
- (21) EPOXY COATED, DEFORMED, NO. 6 TIE BARS, 24" LONG @ 24" C-C  
COST INCIDENTAL TO CONCRETE BARRIER BASE
- (22) HOT-MIX ASPHALT BASE COURSE, 10"
- (23) HOT-MIX ASPHALT BASE COURSE WIDENING, 10"

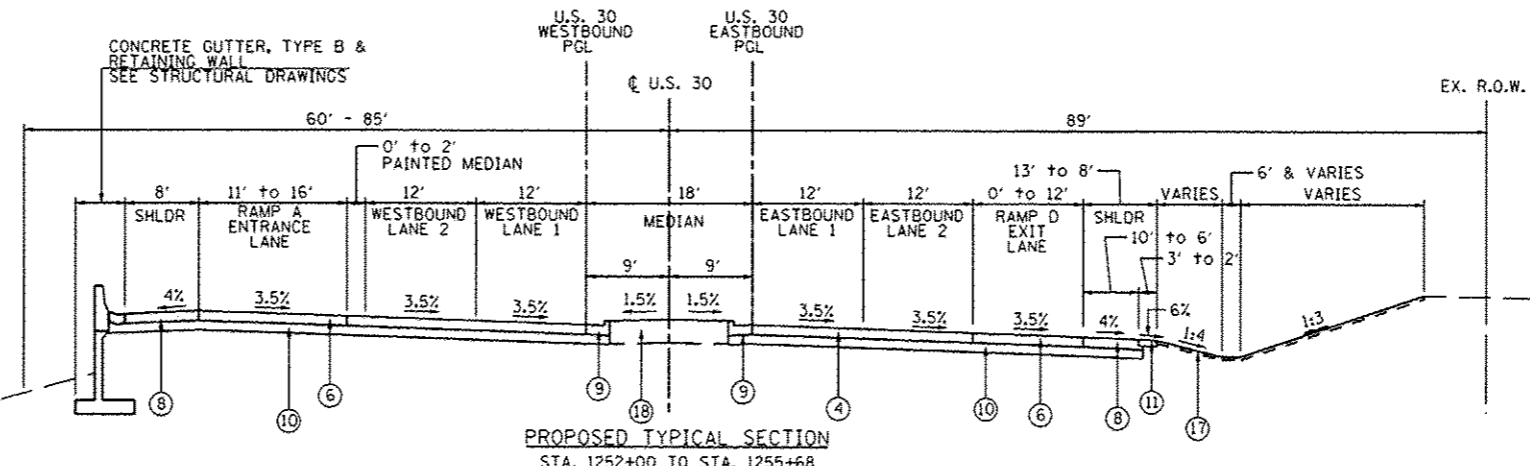
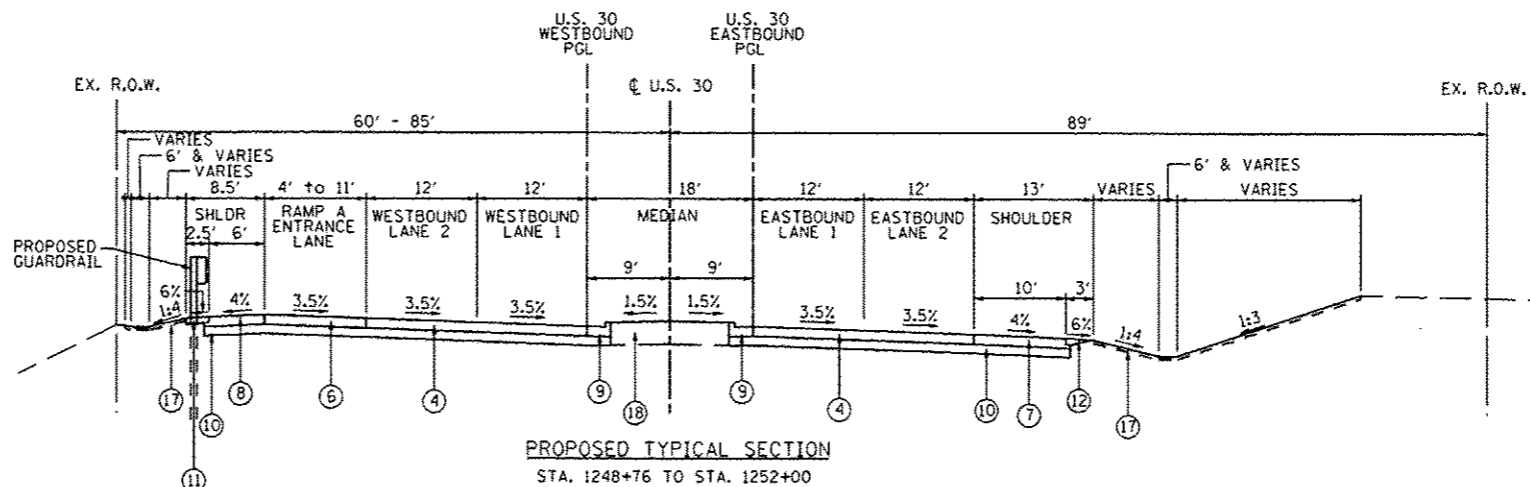
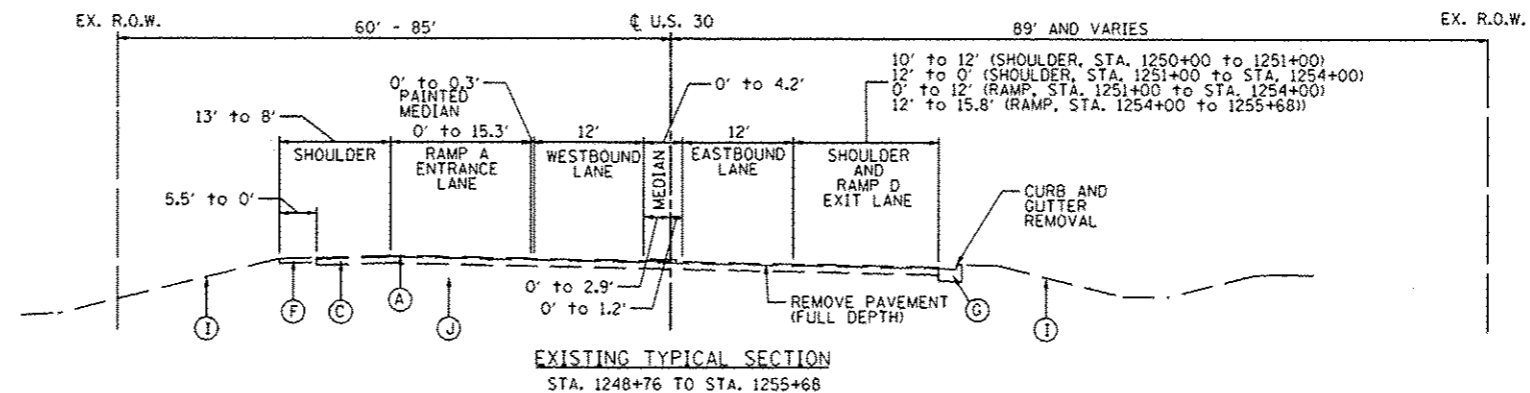

**NOTES:**

- IN AREAS WHERE EXISTING DRIVEWAY AND ROADWAY PAVEMENTS ARE BEING REMOVED AND NOT REPLACED THE AREA SHALL BE EXCAVATED TO A MINIMUM DEPTH OF 30 INCHES BELOW EXISTING PAVEMENT ELEVATION TO REMOVE GRAVEL SUBGRADE BENEATH THE PAVEMENTS. THE ADDITIONAL EXCAVATION WILL BE PAID FOR AS EARTH EXCAVATION.

P:\1248+76\20032021\_CAD\_Site.dgn VCC\DIS0133-shr-typlcd-03.dgn  
 9/13/2012 1:42:05 PM

USER NAME	1854	DESIGNED	JWB	REVISED	GRAEF 9-11-12
DRAWN	JWB	CHECKED	RS	DATE	06/15/2012
DATE	06/15/2012	REVISIONS			

**STATE OF ILLINOIS  
DEPARTMENT OF TRANSPORTATION**

**U.S. ROUTE 30 AT IL ROUTE 31  
TYPICAL SECTIONS - U.S. ROUTE 30**

SCALE: N.T.S. SHEET NO. -- STA. ---- TO STA. ----

F.A.P. RTE.	SECTION	COUNTY	TOTAL SHEETS	SHEET NO.
349	(10 & 11 YB) R-3		607	25
KANE AND KENDALL			CONTRACT NO. 60133	
ILLINOIS FED. AID PROJECT				

**EXISTING CONDITIONS**

- (A) HOT-MIX ASPHALT SURFACE COURSE 2 1/2"-3"
- (B) PORTLAND CEMENT CONCRETE PAVEMENT, 10"
- (C) PORTLAND CEMENT CONCRETE BASE COURSE, 9"-10"
- (D) HOT-MIX ASPHALT BASE COURSE, 11 1/4"
- (E) HOT-MIX ASPHALT SHOULDER, 8"
- (F) AGGREGATE SHOULDER, 6"-8"
- (G) COMBINATION CONCRETE CURB & GUTTER, TYPE B-6.12 OR B-6.24
- (H) MEDIAN SURFACE, 12"
- (I) EXISTING GROUND
- (J) GRANULAR SUBBASE, THICKNESS VARIES

**PROPOSED IMPROVEMENTS**

- (1) POLYMERIZED HOT-MIX ASPHALT SURFACE COURSE, MIX "F", N90: 2"
- (2) HOT-MIX ASPHALT SURFACE COURSE, MIX "D", N70: 2"
- (3) LEVELING BINDER (MACHINE METHOD), N70: 3/4" & VAR. ON US 30, 1" ON IL 31 & VAR.
- (4) (US 30) HOT-MIX ASPHALT PAVEMENT (FULL DEPTH), 12 3/4" CONSISTING OF:  
POLYMERIZED HOT-MIX ASPHALT SURFACE COURSE, MIX "F", N90: 2"  
POLYMERIZED HOT-MIX ASPHALT BINDER COURSE, IL-19.0, N90: 2 1/4"  
HOT-MIX ASPHALT BINDER COURSE, IL-19.0, N90: 8 1/2"
- (5) PAVEMENT RECONSTRUCTION (IL 31) CONSISTING OF:  
HOT-MIX ASPHALT SURFACE COURSE, MIX "D", N70: 2"  
HOT-MIX ASPHALT BASE COURSE: 10 3/4"
- (6) (RAMPS) HOT-MIX ASPHALT PAVEMENT (FULL DEPTH), 12 1/2" CONSISTING OF:  
HOT-MIX ASPHALT SURFACE COURSE, MIX "D", N70: 2"  
HOT-MIX ASPHALT BINDER COURSE, IL-19.0, N70: 10 1/2"
- (7) (US 30 & IL 31) HOT-MIX ASPHALT SHOULDERS, 12 3/4" CONSISTING OF:  
HOT-MIX ASPHALT SURFACE COURSE, MIX "D", N70: 2"  
HOT-MIX ASPHALT BINDER COURSE, IL-19.0, N70: 10 3/4"
- (8) (RAMPS) HOT-MIX ASPHALT SHOULDERS, 12 1/2" CONSISTING OF:  
HOT-MIX ASPHALT SURFACE COURSE, MIX "D", N70: 2"  
HOT-MIX ASPHALT BINDER COURSE, IL-19.0, N70: 10 1/2"
- (9) COMBINATION CONCRETE CURB & GUTTER, TYPE B-6.24
- (10) AGGREGATE SUBGRADE IMPROVEMENT, 12"
- (11) AGGREGATE SHOULDER, TYPE B, 8"
- (12) AGGREGATE WEDGE SHOULDER, TYPE B
- (13) STRIP REFLECTIVE CRACK CONTROL TREATMENT
- (14) CONCRETE MEDIAN SURFACE, 4"
- (15) PORTLAND CEMENT CONCRETE PAVEMENT, 10" (JOINTED)
- (16) PORTLAND CEMENT CONCRETE SHOULDERS, 10"
- (17) TOPSOIL, FURNISH & PLACE, 4", FERTILIZER NUTRIENTS AND SEEDING OR SODDING. SEE LANDSCAPING PLANS FOR LOCATIONS AND SEEDING TYPE.
- (18) TOPSOIL, FURNISH & PLACE, 30", FERTILIZER NUTRIENTS, SEEDING CLASS 2A AND EROSION CONTROL BLANKET
- (19) EPOXY COATED, DEFORMED, NO. 6 TIE BARS, 24" LONG @ 24" C-C  
COST INCIDENTAL TO PCC PAVT, CONC C & G AND CONC MEDIAN TY SB-6
- (20) EPOXY COATED, DEFORMED, NO. 6 TIE BARS, 30" LONG @ 24" C-C  
COST INCIDENTAL TO PCC SHOULDERS, 10"
- (21) EPOXY COATED, DEFORMED, NO. 6 TIE BARS, 24" LONG @ 24" C-C  
COST INCIDENTAL TO CONCRETE BARRIER BASE
- (22) HOT-MIX ASPHALT BASE COURSE, 10"
- (23) HOT-MIX ASPHALT BASE COURSE WIDENING, 10"

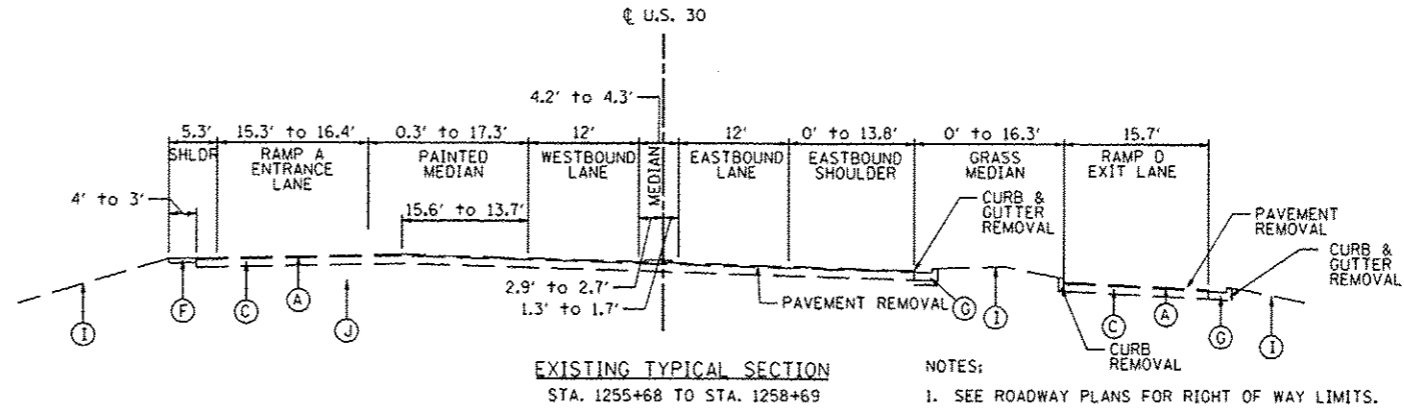

NOTES:  
1. SEE ROADWAY PLANS FOR RIGHT OF WAY LIMITS.

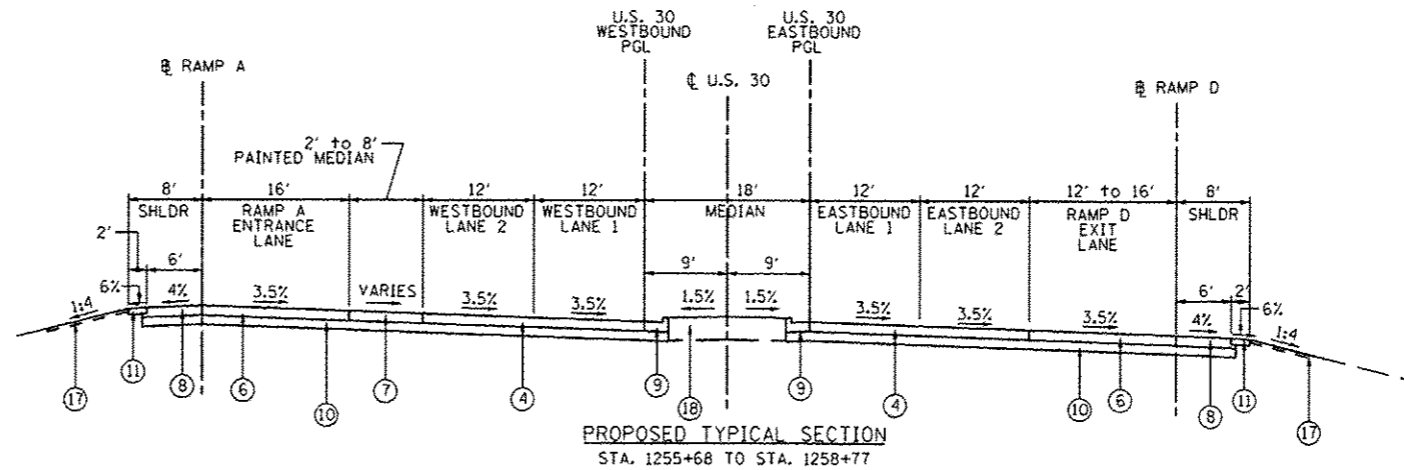

NOTES:  
1. IN AREAS WHERE EXISTING DRIVEWAY AND ROADWAY PAVEMENTS ARE BEING REMOVED AND NOT REPLACED THE AREA SHALL BE EXCAVATED TO A MINIMUM DEPTH OF 30 INCHES BELOW EXISTING PAVEMENT ELEVATION TO REMOVE GRAVEL SUBGRADE BENEATH THE PAVEMENTS. THE ADDITIONAL EXCAVATION WILL BE PAID FOR AS EARTH EXCAVATION.

P:\Jobs\2010\2010303\ACAD\Site\ dgn\CC\B60133-ent-typical-04.dgn 9/13/2012 4:42:31 PM

USER NAME * 1654	DESIGNED - JWB	REVISED - GRAEF 9-11-12
PLOT SCALE * 20,0000' / IN.	DRAWN - JWB	REVISED -
PLOT DATE * 9/13/2012	CHECKED - RS	REVISED -
	DATE - 06/15/2012	REVISED -

**STATE OF ILLINOIS  
DEPARTMENT OF TRANSPORTATION**

**U.S. ROUTE 30 AT IL. ROUTE 31  
TYPICAL SECTIONS - U.S. ROUTE 30**

SCALE: N.T.S. SHEET NO. -- STA. ---- TO STA. ----

F.A.P. RTE.	SECTION	COUNTY	TOTAL SHEETS	SHEET NO.
349	(10 & 11 VBI R-3	*	507	28
* KANE AND KENDALL		CONTRACT NO. 60133		
ILLINOIS FED. AID PROJECT				



EXISTING CONDITIONS

- (A) HOT-MIX ASPHALT SURFACE COURSE 2 1/2"-3"
- (B) PORTLAND CEMENT CONCRETE PAVEMENT, 10"
- (C) PORTLAND CEMENT CONCRETE BASE COURSE, 9"-10"
- (D) HOT-MIX ASPHALT BASE COURSE, 11 1/4"
- (E) HOT-MIX ASPHALT SHOULDER, 8"
- (F) AGGREGATE SHOULDER, 6"-8"
- (G) COMBINATION CONCRETE CURB & GUTTER, TYPE B-6.12 OR B-6.24
- (H) MEDIAN SURFACE, 12"
- (I) EXISTING GROUND
- (J) GRANULAR SUBBASE, THICKNESS VARIES

PROPOSED IMPROVEMENTS

- (1) POLYMERIZED HOT-MIX ASPHALT SURFACE COURSE, MIX "F", N90: 2"
- (2) HOT-MIX ASPHALT SURFACE COURSE, MIX "D", N70: 2"
- (3) LEVELING BINDER (MACHINE METHOD), N70: 3/4" & VAR. ON US 30, 1" ON IL 31 & VAR.
- (4) (US 30) HOT-MIX ASPHALT PAVEMENT (FULL DEPTH), 12 3/4" CONSISTING OF:  
POLYMERIZED HOT-MIX ASPHALT SURFACE COURSE, MIX "F", N90: 2"  
POLYMERIZED HOT-MIX ASPHALT BINDER COURSE, IL-19.0, N90: 2 1/4"  
HOT-MIX ASPHALT BINDER COURSE, IL-19.0, N90: 8 1/2"
- (5) PAVEMENT RECONSTRUCTION (IL 31) CONSISTING OF:  
HOT-MIX ASPHALT SURFACE COURSE, MIX "D", N70: 2"  
HOT-MIX ASPHALT BASE COURSE: 10 3/4"
- (6) (RAMPS) HOT-MIX ASPHALT PAVEMENT (FULL DEPTH), 12 1/2" CONSISTING OF:  
HOT-MIX ASPHALT SURFACE COURSE, MIX "D", N70: 2"  
HOT-MIX ASPHALT BINDER COURSE, IL-19.0, N70: 10 1/2"
- (7) (US 30 & IL 31) HOT-MIX ASPHALT SHOULDERS, 12 3/4" CONSISTING OF:  
HOT-MIX ASPHALT SURFACE COURSE, MIX "D", N70: 2"  
HOT-MIX ASPHALT BINDER COURSE, IL-19.0, N70: 10 3/4"
- (8) (RAMPS) HOT-MIX ASPHALT SHOULDERS, 12 1/2" CONSISTING OF:  
HOT-MIX ASPHALT SURFACE COURSE, MIX "D", N70: 2"  
HOT-MIX ASPHALT BINDER COURSE, IL-19.0, N70: 10 1/2"
- (9) COMBINATION CONCRETE CURB & GUTTER, TYPE B-6.24
- (10) AGGREGATE SUBGRADE IMPROVEMENT, 12"
- (11) AGGREGATE SHOULDER, TYPE B, 8"
- (12) AGGREGATE WEDGE SHOULDER, TYPE B
- (13) STRIP REFLECTIVE CRACK CONTROL TREATMENT
- (14) CONCRETE MEDIAN SURFACE, 4"
- (15) PORTLAND CEMENT CONCRETE PAVEMENT, 10" (JOINTED)
- (16) PORTLAND CEMENT CONCRETE SHOULDERS, 10"
- (17) TOPSOIL, FURNISH & PLACE, 4", FERTILIZER NUTRIENTS AND SEEDING OR SODDING. SEE LANDSCAPING PLANS FOR LOCATIONS AND SEEDING TYPE.
- (18) TOPSOIL, FURNISH & PLACE, 30", FERTILIZER NUTRIENTS, SEEDING CLASS 2A AND EROSION CONTROL BLANKET
- (19) EPOXY COATED, DEFORMED, NO. 6 TIE BARS, 24" LONG @ 24" C-C  
COST INCIDENTAL TO PCC PAVT, CONC C & G AND CONC MEDIAN TY SB-6
- (20) EPOXY COATED, DEFORMED, NO. 6 TIE BARS, 30" LONG @ 24" C-C  
COST INCIDENTAL TO PCC SHOULDERS, 10"
- (21) EPOXY COATED, DEFORMED, NO. 6 TIE BARS, 24" LONG @ 24" C-C  
COST INCIDENTAL TO CONCRETE BARRIER BASE
- (22) HOT-MIX ASPHALT BASE COURSE, 10"
- (23) HOT-MIX ASPHALT BASE COURSE WIDENING, 10"

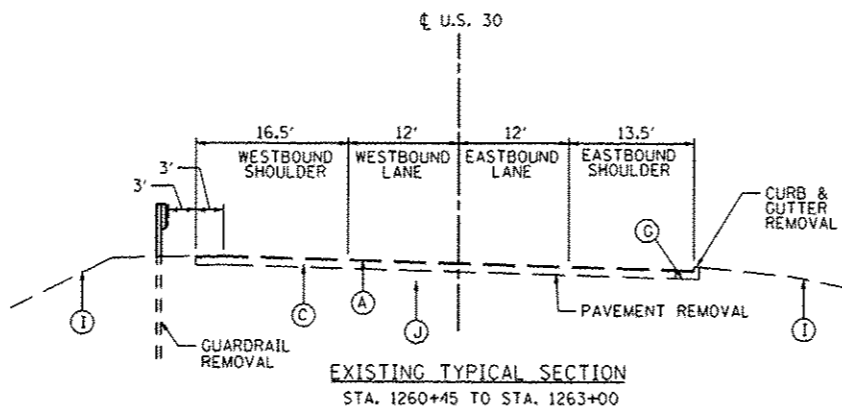

NOTES:

- 1. WESTBOUND GUARDRAIL BEGINS AT STA. 1261+10.
- 2. SEE ROADWAY PLANS FOR RIGHT OF WAY LIMITS.

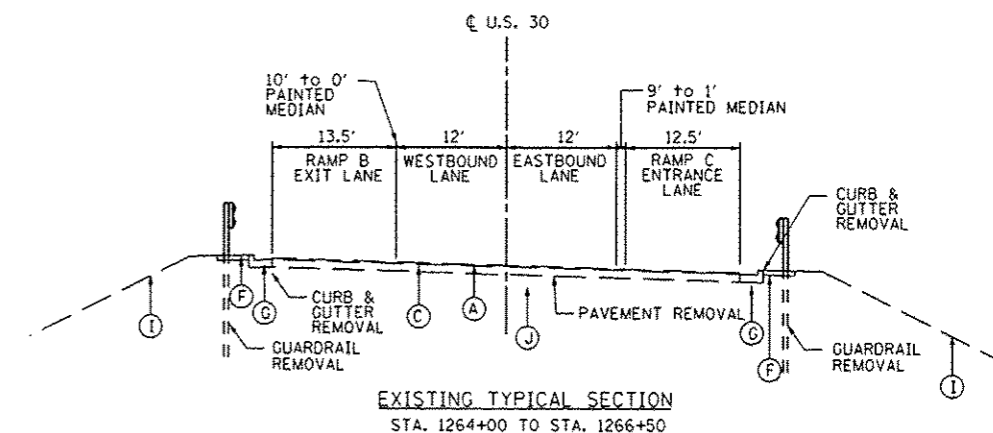

NOTES:

- 1. SEE ROADWAY PLANS FOR RIGHT OF WAY LIMITS.

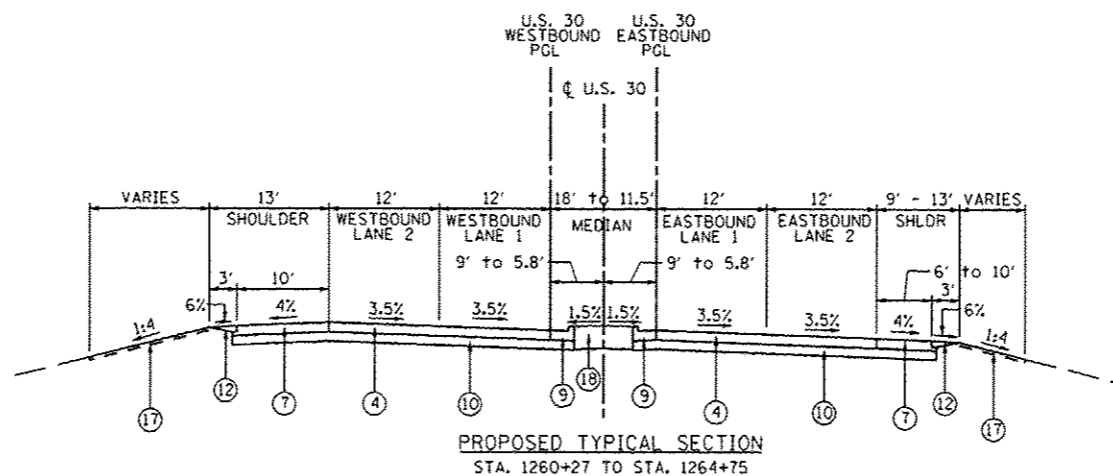

NOTES:

- 1. SEE ROADWAY PLANS FOR RIGHT OF WAY LIMITS.

NOTES:

- 1. IN AREAS WHERE EXISTING DRIVEWAY AND ROADWAY PAVEMENTS ARE BEING REMOVED AND NOT REPLACED, THE AREA SHALL BE EXCAVATED TO A MINIMUM DEPTH OF 30 INCHES BELOW EXISTING PAVEMENT ELEVATION TO REMOVE GRAVEL SUBGRADE BENEATH THE PAVEMENTS. THE ADDITIONAL EXCAVATION WILL BE PAID FOR AS EARTH EXCAVATION.

P:\Jobs\210\_2000303\CAD\Site\dwg\00\016013-sh1-typical-05.dwg 5/17/2012 14:59 PM

USER NAME	1654	DESIGNED	JWB	REVISED	GRAEF 9-11-12
DRAWN	JWB	CHECKED	RS	DATE	06/15/2012
PLT SCALE	20.0000' / 1" IN.	DATE	06/15/2012	REVISED	
PLT DATE	9/13/2012	DATE	06/15/2012	REVISED	

STATE OF ILLINOIS  
DEPARTMENT OF TRANSPORTATION

U.S. ROUTE 30 AT IL ROUTE 31 TYPICAL SECTIONS - U.S. ROUTE 30		F.A.P. RTE.	SECTION	COUNTY	TOTAL SHEETS	SHEET NO.
SCALE: N.T.S.		349	(10 & 11 VBI) R-3	*	507	27
SHEET NO. --		KANE AND KENDALL		CONTRACT NO. 60133		
STA. ---- TO STA. ----		ILLINOIS FED. AID PROJECT				

**EXISTING CONDITIONS**

- (A) HOT-MIX ASPHALT SURFACE COURSE 2 1/2"-3"
- (B) PORTLAND CEMENT CONCRETE PAVEMENT, 10"
- (C) PORTLAND CEMENT CONCRETE BASE COURSE, 9"-10"
- (D) HOT-MIX ASPHALT BASE COURSE, 11 1/4"
- (E) HOT-MIX ASPHALT SHOULDER, 8"
- (F) AGGREGATE SHOULDER, 6"-8"
- (G) COMBINATION CONCRETE CURB & GUTTER, TYPE B-6.12 OR B-6.24
- (H) MEDIAN SURFACE, 12"
- (I) EXISTING GROUND
- (J) GRANULAR SUBBASE, THICKNESS VARIES

**PROPOSED IMPROVEMENTS**

- (1) POLYMERIZED HOT-MIX ASPHALT SURFACE COURSE, MIX "F", N90: 2"
- (2) HOT-MIX ASPHALT SURFACE COURSE, MIX "D", N70: 2"
- (3) LEVELING BINDER (MACHINE METHOD), N70: 3/4" & VAR. ON US 30, 1" ON IL 31 & VAR.
- (4) (US 30) HOT-MIX ASPHALT PAVEMENT (FULL DEPTH), 12 3/4" CONSISTING OF:  
POLYMERIZED HOT-MIX ASPHALT SURFACE COURSE, MIX "F", N90: 2"  
POLYMERIZED HOT-MIX ASPHALT BINDER COURSE, IL-19.0, N90: 2 1/4"  
HOT-MIX ASPHALT BINDER COURSE, IL-19.0, N90: 8 1/2"
- (5) PAVEMENT RECONSTRUCTION (IL 31) CONSISTING OF:  
HOT-MIX ASPHALT SURFACE COURSE, MIX "D", N70: 2"  
HOT-MIX ASPHALT BASE COURSE: 10 3/4"
- (6) (RAMPS) HOT-MIX ASPHALT PAVEMENT (FULL DEPTH), 12 1/2" CONSISTING OF:  
HOT-MIX ASPHALT SURFACE COURSE, MIX "D", N70: 2"  
HOT-MIX ASPHALT BINDER COURSE, IL-19.0, N70: 10 1/2"
- (7) (US 30 & IL 31) HOT-MIX ASPHALT SHOULDERS, 12 3/4" CONSISTING OF:  
HOT-MIX ASPHALT SURFACE COURSE, MIX "D", N70: 2"  
HOT-MIX ASPHALT BINDER COURSE, IL-19.0, N70: 10 3/4"
- (8) (RAMPS) HOT-MIX ASPHALT SHOULDERS, 12 1/2" CONSISTING OF:  
HOT-MIX ASPHALT SURFACE COURSE, MIX "D", N70: 2"  
HOT-MIX ASPHALT BINDER COURSE, IL-19.0, N70: 10 1/2"
- (9) COMBINATION CONCRETE CURB & GUTTER, TYPE B-6.24
- (10) AGGREGATE SUBGRADE IMPROVEMENT, 12"
- (11) AGGREGATE SHOULDER, TYPE B, 8"
- (12) AGGREGATE WEDGE SHOULDER, TYPE B
- (13) STRIP REFLECTIVE CRACK CONTROL TREATMENT
- (14) CONCRETE MEDIAN SURFACE, 4"
- (15) PORTLAND CEMENT CONCRETE PAVEMENT, 10" (JOINTED)
- (16) PORTLAND CEMENT CONCRETE SHOULDERS, 10"
- (17) TOPSOIL, FURNISH & PLACE, 4", FERTILIZER NUTRIENTS AND SEEDING OR SODDING. SEE LANDSCAPING PLANS FOR LOCATIONS AND SEEDING TYPE.
- (18) TOPSOIL, FURNISH & PLACE, 30", FERTILIZER NUTRIENTS, SEEDING CLASS 2A AND EROSION CONTROL BLANKET

(19) EPOXY COATED, DEFORMED, NO. 6 TIE BARS, 24" LONG @ 24" C-C  
COST INCIDENTAL TO PCC PAVT, CONC C & G AND CONC MEDIAN TY SB-6

(20) EPOXY COATED, DEFORMED, NO. 6 TIE BARS, 30" LONG @ 24" C-C  
COST INCIDENTAL TO PCC SHOULDERS, 10"

(21) EPOXY COATED, DEFORMED, NO. 6 TIE BARS, 24" LONG @ 24" C-C  
COST INCIDENTAL TO CONCRETE BARRIER BASE

(22) HOT-MIX ASPHALT BASE COURSE, 10"

(23) HOT-MIX ASPHALT BASE COURSE WIDENING, 10"

**NOTES:**

1. IN AREAS WHERE EXISTING DRIVEWAY AND ROADWAY PAVEMENTS ARE BEING REMOVED AND NOT REPLACED, THE AREA SHALL BE EXCAVATED TO A MINIMUM DEPTH OF 30 INCHES BELOW EXISTING PAVEMENT ELEVATION TO REMOVE GRAVEL SUBGRADE BENEATH THE PAVEMENTS. THE ADDITIONAL EXCAVATION WILL BE PAID FOR AS EARTH EXCAVATION.

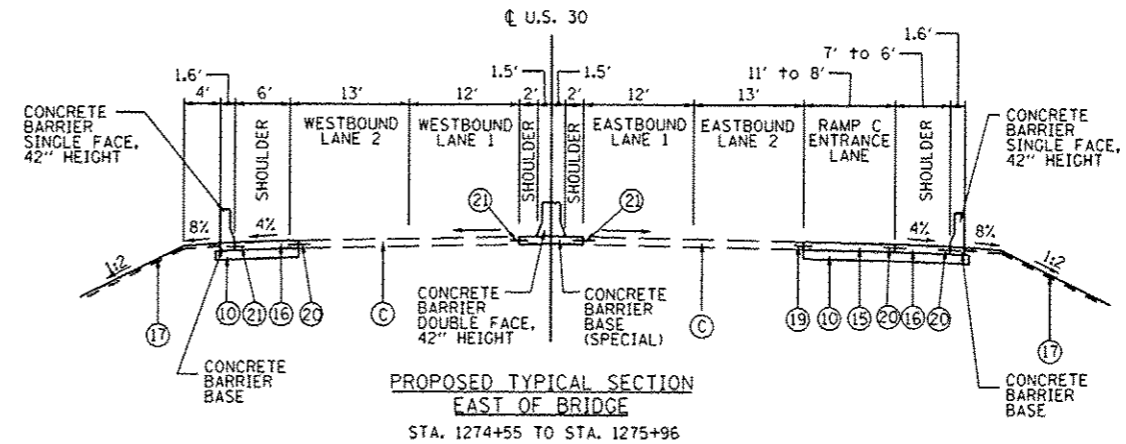
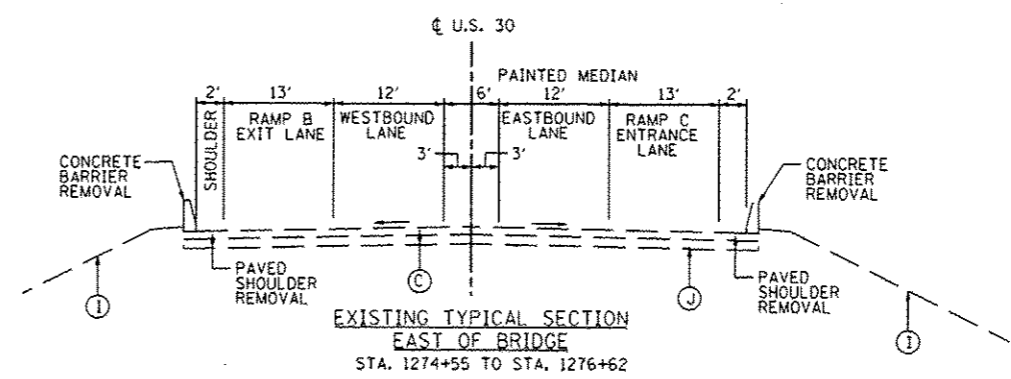
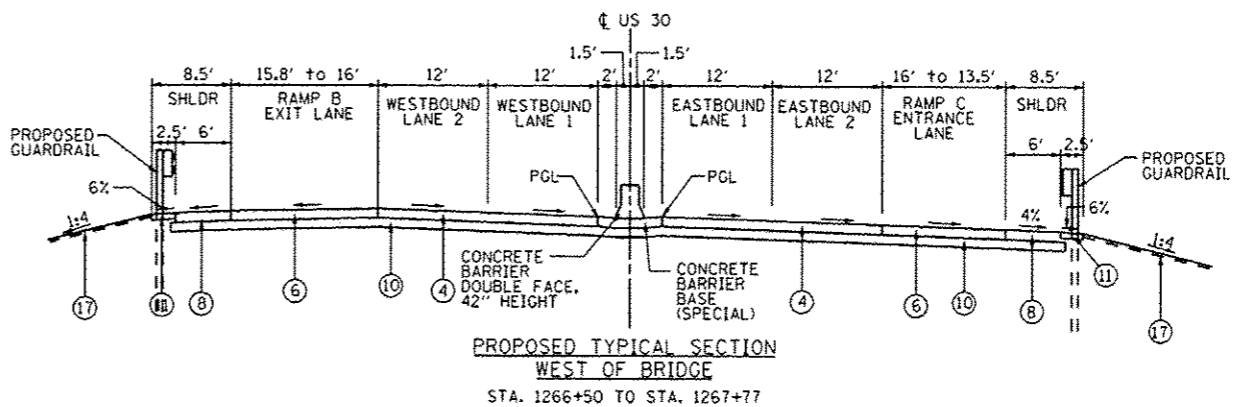
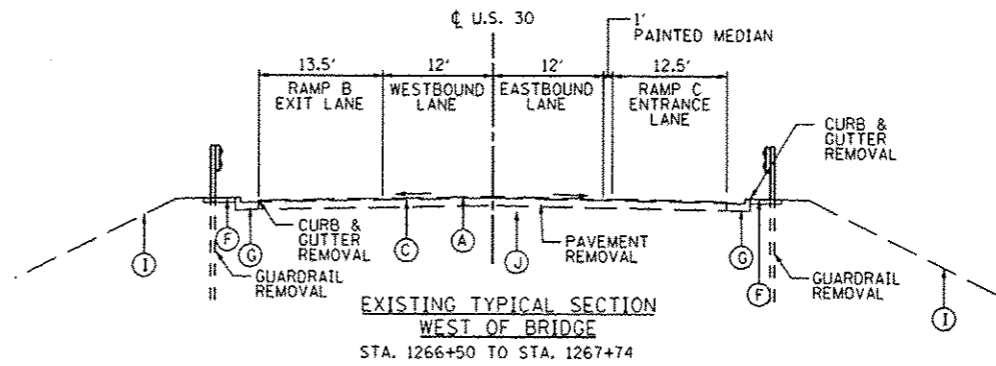

P:\Jobs\2010-2000\2013\CAD\_Site\Drawings\001\01013-shr-fypical-06-br1r1dgs.dgn  
 9/13/2012 10:52:27 AM

USER NAME * 1054	DESIGNED - JWB	REVISED - GRAEF 9-11-12
PLOT SCALE = 20.0000' / IN.	DRAWN - JWB	REVISED -
PLOT DATE = 9/13/2012	CHECKED - RS	REVISED -
	DATE - 06/15/2012	REVISED -

**STATE OF ILLINOIS  
DEPARTMENT OF TRANSPORTATION**

**U.S. ROUTE 30 AT IL ROUTE 31  
TYPICAL SECTIONS - U.S. ROUTE 30**  
SCALE: N.T.S. SHEET NO. -- STA. ---- TO STA. ----

F.A.P. RTE. 349	SECTION (10 & 11 VBI R-3)	COUNTY *	TOTAL SHEETS 507	SHEET NO. 28
* KANE AND KENDALL			CONTRACT NO. 60133	
ILLINOIS FED. AID PROJECT				

**EXISTING CONDITIONS**

- (A) HOT-MIX ASPHALT SURFACE COURSE 2 1/2"-3"
- (B) PORTLAND CEMENT CONCRETE PAVEMENT, 10"
- (C) PORTLAND CEMENT CONCRETE BASE COURSE, 9"- 10"
- (D) HOT-MIX ASPHALT BASE COURSE, 11 1/4"
- (E) HOT-MIX ASPHALT SHOULDER, 8"
- (F) AGGREGATE SHOULDER, 6"-8"
- (G) COMBINATION CONCRETE CURB & GUTTER, TYPE B-6.12 OR B-6.24
- (H) MEDIAN SURFACE, 12"
- (I) EXISTING GROUND
- (J) GRANULAR SUBBASE, THICKNESS VARIES

**PROPOSED IMPROVEMENTS**

- (1) POLYMERIZED HOT-MIX ASPHALT SURFACE COURSE, MIX "F", N90: 2"
- (2) HOT-MIX ASPHALT SURFACE COURSE, MIX "D", N70: 2"
- (3) LEVELING BINDER (MACHINE METHOD), N70: 3/4" & VAR. ON US 30, 1" ON IL 31 & VAR.
- (4) (US 30) HOT-MIX ASPHALT PAVEMENT (FULL DEPTH), 12 3/4" CONSISTING OF:  
POLYMERIZED HOT-MIX ASPHALT SURFACE COURSE, MIX "F", N90: 2"  
POLYMERIZED HOT-MIX ASPHALT BINDER COURSE, IL-19.0, N90: 2 1/4"  
HOT-MIX ASPHALT BINDER COURSE, IL-19.0, N90: 8 1/2"
- (5) PAVEMENT RECONSTRUCTION (IL 31) CONSISTING OF:  
HOT-MIX ASPHALT SURFACE COURSE, MIX "D", N70: 2"  
HOT-MIX ASPHALT BASE COURSE: 10 3/4"
- (6) (RAMPS) HOT-MIX ASPHALT PAVEMENT (FULL DEPTH), 12 1/2" CONSISTING OF:  
HOT-MIX ASPHALT SURFACE COURSE, MIX "D", N70: 2"  
HOT-MIX ASPHALT BINDER COURSE, IL-19.0, N70: 10 1/2"
- (7) (US 30 & IL 31) HOT-MIX ASPHALT SHOULDERS, 12 3/4" CONSISTING OF:  
HOT-MIX ASPHALT SURFACE COURSE, MIX "D", N70: 2"  
HOT-MIX ASPHALT BINDER COURSE, IL-19.0, N70: 10 3/4"
- (8) (RAMPS) HOT-MIX ASPHALT SHOULDERS, 12 1/2" CONSISTING OF:  
HOT-MIX ASPHALT SURFACE COURSE, MIX "D", N70: 2"  
HOT-MIX ASPHALT BINDER COURSE, IL-19.0, N70: 10 1/2"
- (9) COMBINATION CONCRETE CURB & GUTTER, TYPE B-6.24
- (10) AGGREGATE SUBGRADE IMPROVEMENT, 12"
- (11) AGGREGATE SHOULDER, TYPE B, 8"
- (12) AGGREGATE WEDGE SHOULDER, TYPE B
- (13) STRIP REFLECTIVE CRACK CONTROL TREATMENT
- (14) CONCRETE MEDIAN SURFACE, 4"
- (15) PORTLAND CEMENT CONCRETE PAVEMENT, 10" (JOINTED)
- (16) PORTLAND CEMENT CONCRETE SHOULDERS, 10"
- (17) TOPSOIL, FURNISH & PLACE, 4", FERTILIZER NUTRIENTS AND SEEDING OR SODDING. SEE LANDSCAPING PLANS FOR LOCATIONS AND SEEDING TYPE.
- (18) TOPSOIL, FURNISH & PLACE, 30", FERTILIZER NUTRIENTS, SEEDING CLASS 2A AND EROSION CONTROL BLANKET
- (19) EPOXY COATED, DEFORMED, NO. 6 TIE BARS, 24" LONG @ 24" C-C  
COST INCIDENTAL TO PCC PAV'T, CONC C & G AND CONC MEDIAN TY SB-6
- (20) EPOXY COATED, DEFORMED, NO. 6 TIE BARS, 30" LONG @ 24" C-C  
COST INCIDENTAL TO PCC SHOULDERS, 10"
- (21) EPOXY COATED, DEFORMED, NO. 6 TIE BARS, 24" LONG @ 24" C-C  
COST INCIDENTAL TO CONCRETE BARRIER BASE
- (22) HOT-MIX ASPHALT BASE COURSE, 10"
- (23) HOT-MIX ASPHALT BASE COURSE WIDENING, 10"

**NOTES:**

1. IN AREAS WHERE EXISTING DRIVEWAY AND ROADWAY PAVEMENTS ARE BEING REMOVED AND NOT REPLACED, THE AREA SHALL BE EXCAVATED TO A MINIMUM DEPTH OF 30 INCHES BELOW EXISTING PAVEMENT ELEVATION TO REMOVE GRAVEL SUBGRADE BENEATH THE PAVEMENTS. THE ADDITIONAL EXCAVATION WILL BE PAID FOR AS EARTH EXCAVATION.

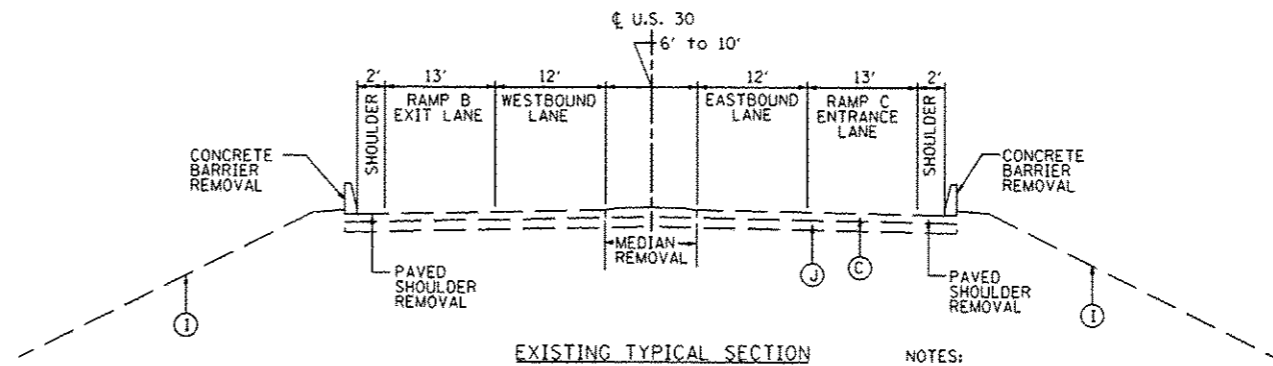

**EXISTING TYPICAL SECTION**  
STA. 1276+62 TO STA. 1277+60

NOTES:  
1. SEE ROADWAY PLANS FOR RIGHT OF WAY LIMITS.

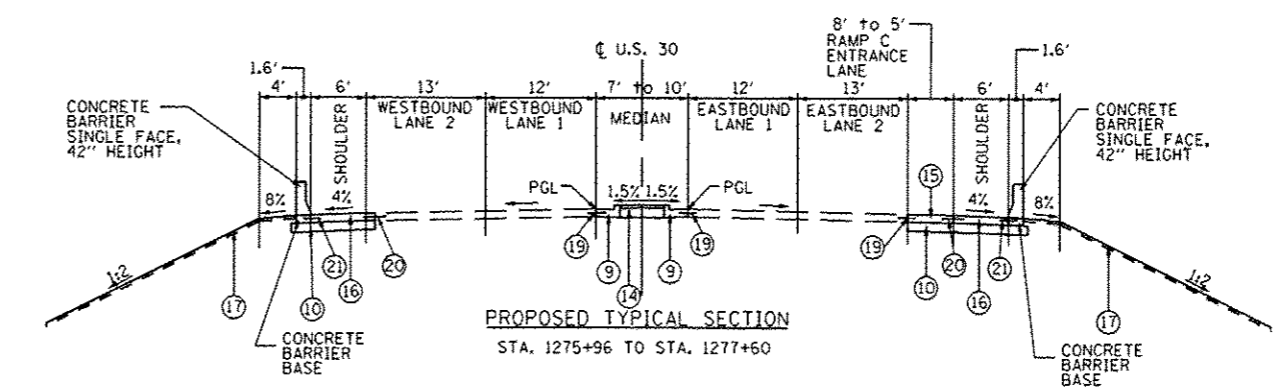

**PROPOSED TYPICAL SECTION**  
STA. 1275+96 TO STA. 1277+60

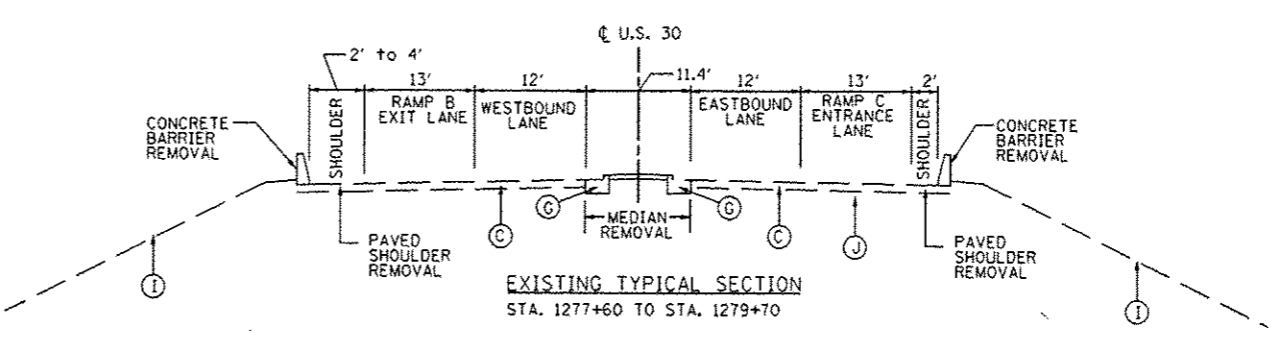

**EXISTING TYPICAL SECTION**  
STA. 1277+60 TO STA. 1279+70

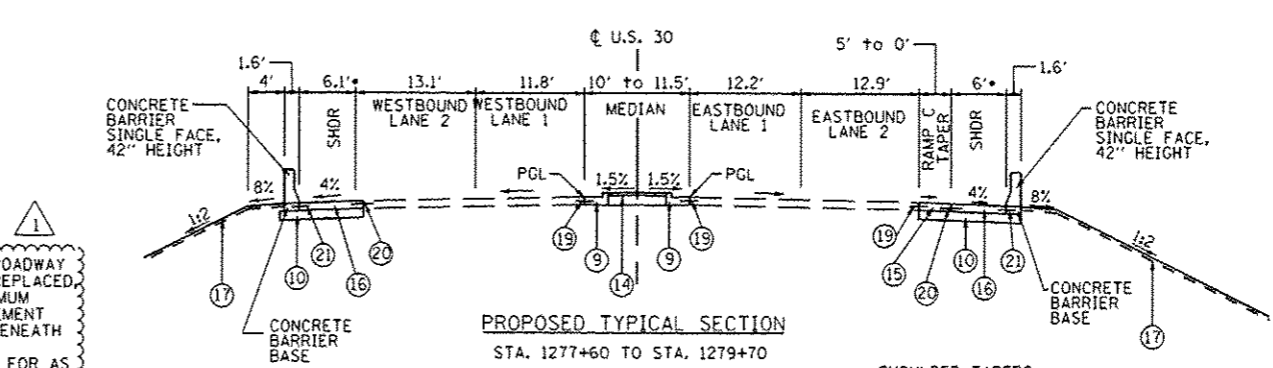

**PROPOSED TYPICAL SECTION**  
STA. 1277+60 TO STA. 1279+70

\*SHOULDER TAPERS VARIES 6' TO 4' STA. 1279+49 TO 1279+70, LT VARIES 6' TO 2' STA. 1278+97 TO 1279+70, RT

P:\Jobs\2010-2010\303\CAD\Site\dwg\061013-shr-f-typlcr-07.dgn 14:40:31 PM 9/13/2012

USER NAME = 1654	DESIGNED - JWB	REVISED - GRAEF 9-11-12
	DRAWN - JWB	REVISED -
PLOT SCALE = 20.0000' / IN.	CHECKED - RS	REVISED -
PLOT DATE = 9/13/2012	DATE - 06/15/2012	REVISED -

**STATE OF ILLINOIS**  
**DEPARTMENT OF TRANSPORTATION**

**U.S. ROUTE 30 AT IL ROUTE 31**  
**TYPICAL SECTIONS - U.S. ROUTE 30**

F.A.P. RTE.	SECTION	COUNTY	TOTAL SHEETS	SHEET NO.
349	(10 & 11 VB) R-3	*	507	29
* KANE AND KENDALL			CONTRACT NO. 60133	
ILLINOIS FED. AID PROJECT				

SCALE: N.T.S. SHEET NO. -- STA. ---- TO STA. ----

**EXISTING CONDITIONS**

- (A) HOT-MIX ASPHALT SURFACE COURSE 2 1/2"-3"
- (B) PORTLAND CEMENT CONCRETE PAVEMENT, 10"
- (C) PORTLAND CEMENT CONCRETE BASE COURSE, 9"-10"
- (D) HOT-MIX ASPHALT BASE COURSE, 11 1/4"
- (E) HOT-MIX ASPHALT SHOULDER, 8"
- (F) AGGREGATE SHOULDER, 6"-8"
- (G) COMBINATION CONCRETE CURB & GUTTER, TYPE B-6.12 OR B-6.24
- (H) MEDIAN SURFACE, 12"
- (I) EXISTING GROUND
- (J) GRANULAR SUBBASE, THICKNESS VARIES

**PROPOSED IMPROVEMENTS**

- (1) POLYMERIZED HOT-MIX ASPHALT SURFACE COURSE, MIX "F", N90: 2"
- (2) HOT-MIX ASPHALT SURFACE COURSE, MIX "D", N70: 2"
- (3) LEVELING BINDER (MACHINE METHOD), N70: 3/4" & VAR. ON US 30, 1" ON IL 31 & VAR.
- (4) (US 30) HOT-MIX ASPHALT PAVEMENT (FULL DEPTH), 12 3/4" CONSISTING OF:  
POLYMERIZED HOT-MIX ASPHALT SURFACE COURSE, MIX "F", N90: 2"  
POLYMERIZED HOT-MIX ASPHALT BINDER COURSE, IL-19.0, N90: 2 1/4"  
HOT-MIX ASPHALT BINDER COURSE, IL-19.0, N90: 8 1/2"
- (5) PAVEMENT RECONSTRUCTION (IL 31) CONSISTING OF:  
HOT-MIX ASPHALT SURFACE COURSE, MIX "D", N70: 2"  
HOT-MIX ASPHALT BASE COURSE: 10 3/4"
- (6) (RAMPS) HOT-MIX ASPHALT PAVEMENT (FULL DEPTH), 12 1/2" CONSISTING OF:  
HOT-MIX ASPHALT SURFACE COURSE, MIX "D", N70: 2"  
HOT-MIX ASPHALT BINDER COURSE, IL-19.0, N70: 10 1/2"
- (7) (US 30 & IL 31) HOT-MIX ASPHALT SHOULDERS, 12 3/4" CONSISTING OF:  
HOT-MIX ASPHALT SURFACE COURSE, MIX "D", N70: 2"  
HOT-MIX ASPHALT BINDER COURSE, IL-19.0, N70: 10 3/4"
- (8) (RAMPS) HOT-MIX ASPHALT SHOULDERS, 12 1/2" CONSISTING OF:  
HOT-MIX ASPHALT SURFACE COURSE, MIX "D", N70: 2"  
HOT-MIX ASPHALT BINDER COURSE, IL-19.0, N70: 10 1/2"
- (9) COMBINATION CONCRETE CURB & GUTTER, TYPE B-6.24
- (10) AGGREGATE SUBGRADE IMPROVEMENT, 12"
- (11) AGGREGATE SHOULDER, TYPE B, 8"
- (12) AGGREGATE WEDGE SHOULDER, TYPE B
- (13) STRIP REFLECTIVE CRACK CONTROL TREATMENT
- (14) CONCRETE MEDIAN SURFACE, 4"
- (15) PORTLAND CEMENT CONCRETE PAVEMENT, 10" (JOINTED)
- (16) PORTLAND CEMENT CONCRETE SHOULDERS, 10"
- (17) TOPSOIL, FURNISH & PLACE, 4", FERTILIZER NUTRIENTS AND SEEDING OR SODDING. SEE LANDSCAPING PLANS FOR LOCATIONS AND SEEDING TYPE.
- (18) TOPSOIL, FURNISH & PLACE, 30", FERTILIZER NUTRIENTS, SEEDING CLASS 2A AND EROSION CONTROL BLANKET

- (19) EPOXY COATED, DEFORMED, NO. 6 TIE BARS, 24" LONG @ 24" C-C  
COST INCIDENTAL TO PCC PAV'T. CONC C & G AND CONC MEDIAN TY SB-6
- (20) EPOXY COATED, DEFORMED, NO. 6 TIE BARS, 30" LONG @ 24" C-C  
COST INCIDENTAL TO PCC SHOULDERS, 10"
- (21) EPOXY COATED, DEFORMED, NO. 6 TIE BARS, 24" LONG @ 24" C-C  
COST INCIDENTAL TO CONCRETE BARRIER BASE

- (22) HOT-MIX ASPHALT BASE COURSE, 10"
- (23) HOT-MIX ASPHALT BASE COURSE WIDENING, 10"

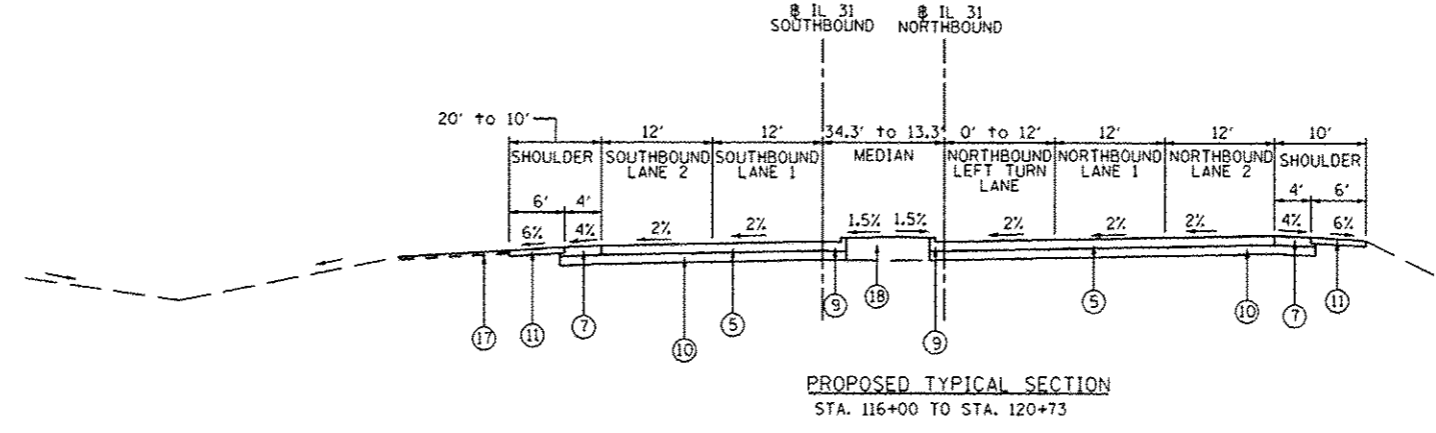
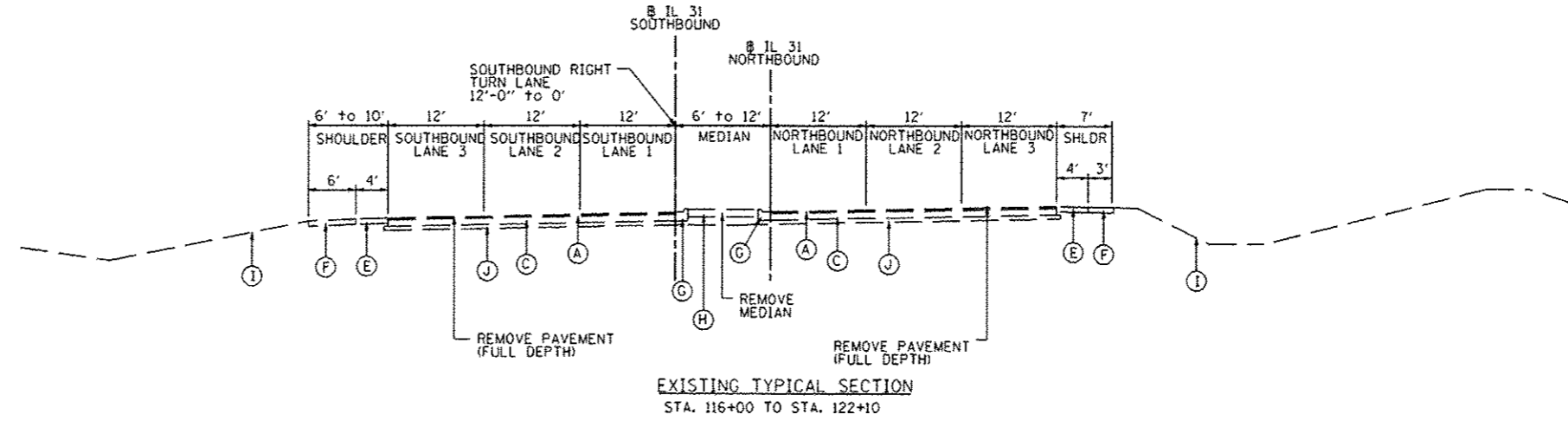

P:\VBS2\2012\03\031\CLD\Site.dgn\001\050133-stt-typical-1.dgn  
 9/12/2012 03:39:10 AM

USER NAME * 1654	DESIGNED - JWb	REVISED - GRAEF 9-11-12
PLOT SCALE * 20,0000 ' / IN.	DRAWN - JWb	REVISED -
PLOT DATE * 9/12/2012	CHECKED - RS	REVISED -
	DATE - 06/15/2012	REVISED -

**STATE OF ILLINOIS  
DEPARTMENT OF TRANSPORTATION**

**U.S. ROUTE 30 AT IL ROUTE 31  
TYPICAL SECTIONS - IL ROUTE 31**

SCALE: N.T.S. SHEET NO. -- STA. ---- TO STA. ----

F.A.P. RTE.	SECTION	COUNTY	TOTAL SHEETS	SHEET NO.
349	(10 & 11) VB1 R-3		507	33
* KANE AND KENDALL			CONTRACT NO. 60133	
ILLINOIS FED. AID PROJECT				

**EXISTING CONDITIONS**

- (A) HOT-MIX ASPHALT SURFACE COURSE 2 1/2"-3"
- (B) PORTLAND CEMENT CONCRETE PAVEMENT, 10"
- (C) PORTLAND CEMENT CONCRETE BASE COURSE, 9"-10"
- (D) HOT-MIX ASPHALT BASE COURSE, 11 1/4"
- (E) HOT-MIX ASPHALT SHOULDER, 8"
- (F) AGGREGATE SHOULDER, 6"-8"
- (G) COMBINATION CONCRETE CURB & GUTTER, TYPE B-6.12 OR B-6.24
- (H) MEDIAN SURFACE, 12"
- (I) EXISTING GROUND
- (J) GRANULAR SUBBASE, THICKNESS VARIES

**PROPOSED IMPROVEMENTS**

- (1) POLYMERIZED HOT-MIX ASPHALT SURFACE COURSE, MIX "F", N90: 2"
- (2) HOT-MIX ASPHALT SURFACE COURSE, MIX "D", N70: 2"
- (3) LEVELING BINDER (MACHINE METHOD), N70: 3/4" & VAR. ON US 30, 1" ON IL 31 & VAR.
- (4) (US 30) HOT-MIX ASPHALT PAVEMENT (FULL DEPTH), 12 3/4" CONSISTING OF:  
POLYMERIZED HOT-MIX ASPHALT SURFACE COURSE, MIX "F", N90: 2"  
POLYMERIZED HOT-MIX ASPHALT BINDER COURSE, IL-19.0, N90: 2 1/4"  
HOT-MIX ASPHALT BINDER COURSE, IL-19.0, N90: 8 1/2"
- (5) PAVEMENT RECONSTRUCTION (IL 31) CONSISTING OF:  
HOT-MIX ASPHALT SURFACE COURSE, MIX "D", N70: 2"  
HOT-MIX ASPHALT BASE COURSE: 10 3/4"
- (6) (RAMPS) HOT-MIX ASPHALT PAVEMENT (FULL DEPTH), 12 1/2" CONSISTING OF:  
HOT-MIX ASPHALT SURFACE COURSE, MIX "D", N70: 2"  
HOT-MIX ASPHALT BINDER COURSE, IL-19.0, N70: 10 1/2"
- (7) (US 30 & IL 31) HOT-MIX ASPHALT SHOULDERS, 12 3/4" CONSISTING OF:  
HOT-MIX ASPHALT SURFACE COURSE, MIX "D", N70: 2"  
HOT-MIX ASPHALT BINDER COURSE, IL-19.0, N70: 10 3/4"
- (8) (RAMPS) HOT-MIX ASPHALT SHOULDERS, 12 1/2" CONSISTING OF:  
HOT-MIX ASPHALT SURFACE COURSE, MIX "D", N70: 2"  
HOT-MIX ASPHALT BINDER COURSE, IL-19.0, N70: 10 1/2"
- (9) COMBINATION CONCRETE CURB & GUTTER, TYPE B-6.24
- (10) AGGREGATE SUBGRADE IMPROVEMENT, 12"
- (11) AGGREGATE SHOULDER, TYPE B, 8"
- (12) AGGREGATE WEDGE SHOULDER, TYPE B
- (13) STRIP REFLECTIVE CRACK CONTROL TREATMENT
- (14) CONCRETE MEDIAN SURFACE, 4"
- (15) PORTLAND CEMENT CONCRETE PAVEMENT, 10" (JOINTED)
- (16) PORTLAND CEMENT CONCRETE SHOULDERS, 10"
- (17) TOPSOIL, FURNISH & PLACE, 4", FERTILIZER NUTRIENTS AND SEEDING OR SODDING. SEE LANDSCAPING PLANS FOR LOCATIONS AND SEEDING TYPE.
- (18) TOPSOIL, FURNISH & PLACE, 30", FERTILIZER NUTRIENTS, SEEDING CLASS 2A AND EROSION CONTROL BLANKET
- (19) EPOXY COATED, DEFORMED, NO. 6 TIE BARS, 24" LONG @ 24" C-C  
COST INCIDENTAL TO PCC PAVT, CONC C & G AND CONC MEDIAN TY SB-6
- (20) EPOXY COATED, DEFORMED, NO. 6 TIE BARS, 30" LONG @ 24" C-C  
COST INCIDENTAL TO PCC SHOULDERS, 10"
- (21) EPOXY COATED, DEFORMED, NO. 6 TIE BARS, 24" LONG @ 24" C-C  
COST INCIDENTAL TO CONCRETE BARRIER BASE
- (22) HOT-MIX ASPHALT BASE COURSE, 10"
- (23) HOT-MIX ASPHALT BASE COURSE WIDENING, 10"

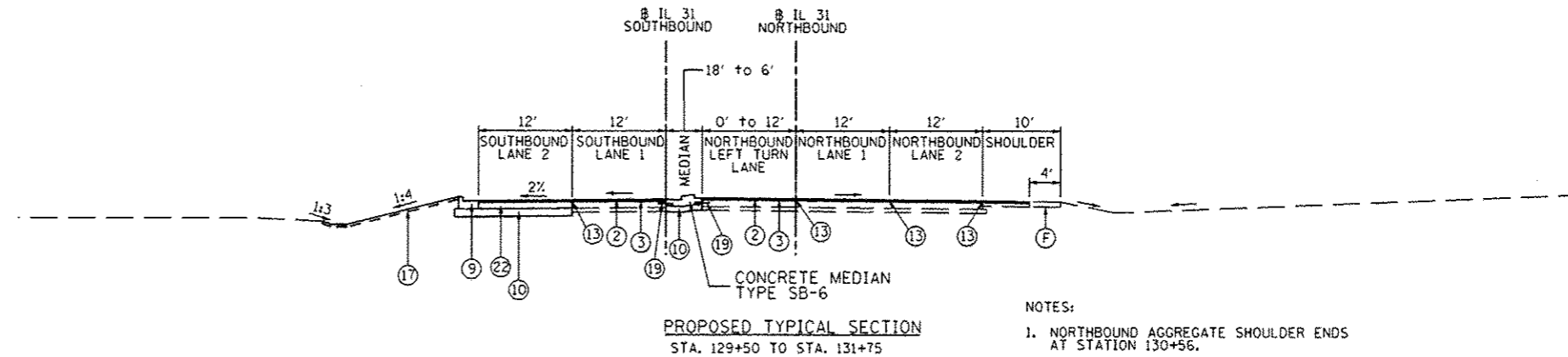
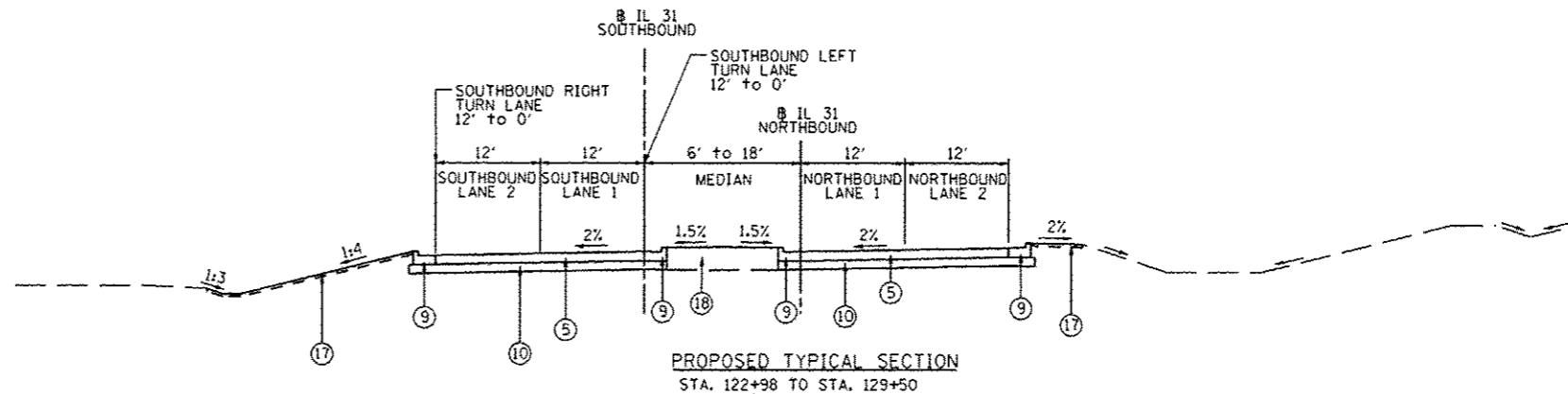
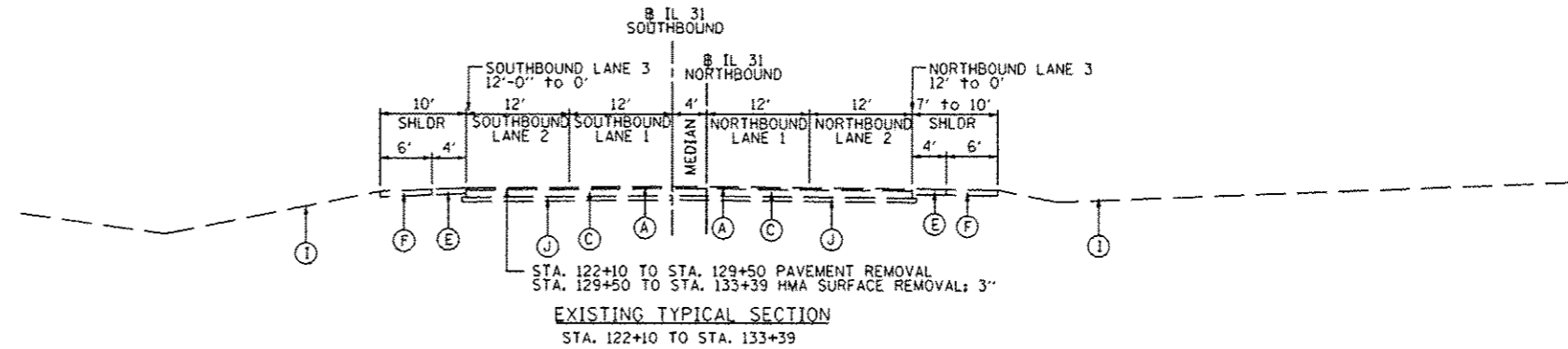

NOTES:  
1. NORTHBOUND AGGREGATE SHOULDER ENDS AT STATION 130+56.

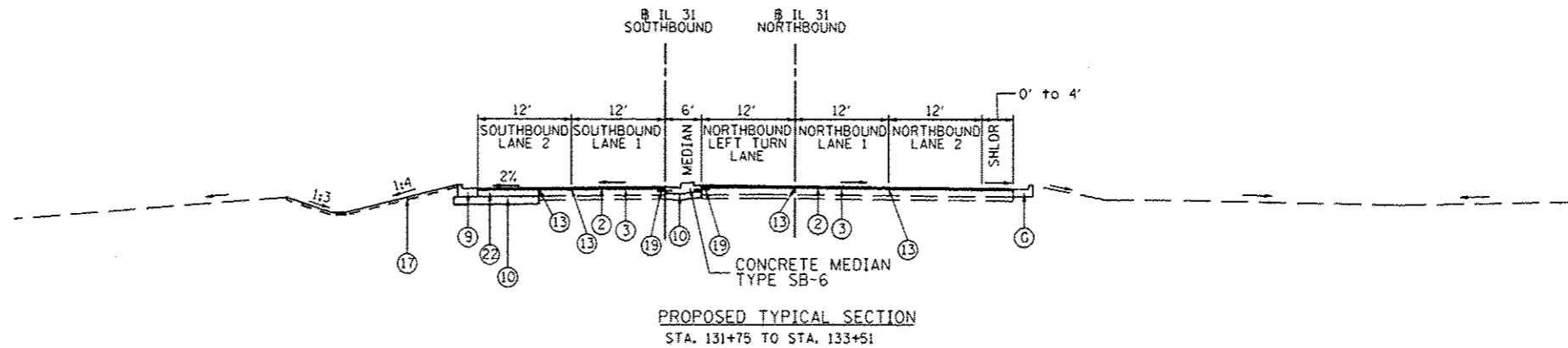

P:\jobs\2010\20102013\10-10-13\Site.dgn\001013-shr-typical-r2.dgn  
 01/27/2012 12:54:38 PM

USER NAME	1654	DESIGNED	JWB	REVISED	GRAEF 09-11-12
DRAWN	JWB	CHECKED	RS	DATE	06/15/2012
PLOT SCALE	20,0000' / IN.	REVISIONS			
PLOT DATE	9/12/2012				

**STATE OF ILLINOIS  
DEPARTMENT OF TRANSPORTATION**

**U.S. ROUTE 30 AT IL ROUTE 31  
TYPICAL SECTIONS - IL ROUTE 31**

SCALE: N.T.S. SHEET NO. --- STA. ---- TO STA. ----

F.A.P. RTE.	SECTION	COUNTY	TOTAL SHEETS	SHEET NO.
349	(10 & 11) VBI R-3		607	34
KANE AND KENDALL			CONTRACT NO. 60133	
ILLINOIS FED. AID PROJECT				

FROM	TO	20200100									20400800								
		EARTH EXCAVATION			EXCAVATION AVAILABLE TO BE USED IN EMBANKMENT			EMBANKMENT			EARTHWORK BALANCE: WASTE (+) OR SHORTAGE (-)			FURNISHED EXCAVATION			WASTE HAUL OFF		
		CU YD			CU YD			CU YD			CU YD			CU YD			CU YD		
STATION	STATION	STAGE 1	STAGE 2	Prestage	STAGE 1	STAGE 2	Prestage	STAGE 1	STAGE 2	Prestage	STAGE 1	STAGE 2	Prestage	STAGE 1	STAGE 2	Prestage	STAGE 1	STAGE 2	Prestage
Infields																			
N. E. Infield			34846		0	29619	0		14273		0	15346	0	0	0	0	0	15346	0
S. E. Infield		26517			22539	0	0	9465			13074	0	0	0	0	0	13074	0	0
Two S. W. Infields		5740			4879	0	0	2934			1945	0	0	0	0	0	1945	0	0
N. W. Infield			14453		0	12285	0		12830	1796	0	-545	-1796	0	545	1796	0	0	0
Ramp A																			
301+50	302+00		219		0	186	0		333		0	-147	0	0	147	0	0	0	0
302+00	302+50		177		0	150	0		406		0	-256	0	0	256	0	0	0	0
302+50	303+00		91		0	77	0		589		0	-512	0	0	512	0	0	0	0
303+00	303+50		50		0	43	0		697		0	-655	0	0	655	0	0	0	0
303+50	304+00		73		0	62	0		691		0	-629	0	0	629	0	0	0	0
304+00	304+50		51		0	43	0		741		0	-698	0	0	698	0	0	0	0
304+50	305+00		33		0	28	0		736		0	-708	0	0	708	0	0	0	0
305+00	305+50		73		0	62	0		640		0	-578	0	0	578	0	0	0	0
305+50	306+00																		
306+00	306+50		130		0	111	0		1113		0	-1003	0	0	1003	0	0	0	0
306+50	307+00		19		0	16	0		643		0	-627	0	0	627	0	0	0	0
307+00	307+50		45		0	38	0		910		0	-872	0	0	872	0	0	0	0
307+50	308+00		96		0	82	0		1258		0	-1176	0	0	1176	0	0	0	0
308+00	308+50		233		0	198	0		1241		0	-1043	0	0	1043	0	0	0	0
308+50	309+00		422		0	359	0		796		0	-437	0	0	437	0	0	0	0
309+00	309+50		452		0	384	0		418		0	-34	0	0	34	0	0	0	0
309+50	310+00		466		0	396	0		191		0	205	0	0	0	0	0	205	0
310+00	310+50		568		0	483	0		77		0	406	0	0	0	0	0	406	0
310+50	311+00		640		0	544	0		58		0	486	0	0	0	0	0	486	0
311+00	311+50		687		0	584	0		33		0	551	0	0	0	0	0	551	0
311+50	312+00		658		0	559	0		23		0	536	0	0	0	0	0	536	0
312+00	312+50		509		0	433	0		43		0	390	0	0	0	0	0	390	0
312+50	313+00		345		0	293	0		77		0	216	0	0	0	0	0	216	0
313+00	313+50		210		0	179	0		102		0	77	0	0	0	0	0	77	0
313+50	314+00		122		0	104	0		92		0	12	0	0	0	0	0	12	0
314+00	314+50		86		0	73	0		73		0	0	0	0	0	0	0	0	0
314+50	315+00		36		0	31	0		33		0	-2	0	0	2	0	0	0	0
Ramp B																			
403+00	403+50		60		0	51	0		1900		0	-1849	0	0	1849	0	0	0	0
403+50	404+00				0	0	0		2312		0	-2312	0	0	2312	0	0	0	0
404+00	404+50				0	0	0		2280		0	-2280	0	0	2280	0	0	0	0

P:\Jobs\2012\03\031\04\01\Site\ent-schedule-for-thwork.dgn  
 9/13/2012 3:29:56 PM



USER NAME - 1654	DESIGNED - JWB	REVISED - GRAEF 09/11/2012/1
	DRAWN - JWB	REVISED -
PLOT SCALE - 100.0000' / IN.	CHECKED - RS	REVISED -
PLOT DATE - 9/13/2012	DATE - 06/15/2012	REVISED -

**STATE OF ILLINOIS**  
**DEPARTMENT OF TRANSPORTATION**

<b>U.S. ROUTE 30 AT IL ROUTE 31</b> <b>EARTHWORK SCHEDULES</b>	
SCALE: N.T.S.	SHEET NO. 1 OF 5

F.A.P. RTE.	SECTION	COUNTY	TOTAL SHEETS	SHEET NO.
349	(10 & 11 VBI) R-3	-	507	42
- KANE AND KENDALL			CONTRACT NO. 60133	
ILLINOIS FED. AID PROJECT				

FROM	TO	20200100						20400800												
		EARTH EXCAVATION			EXCAVATION AVAILABLE TO BE USED IN EMBANKMENT			EMBANKMENT			EARTHWORK BALANCE: WASTE (+) OR SHORTAGE (-)			FURNISHED EXCAVATION			WASTE HAUL OFF			
		CU YD			CU YD			CU YD			CU YD			CU YD						
STATION	STATION	STAGE 1	STAGE 2	Prestage	STAGE 1	STAGE 2	Prestage	STAGE 1	STAGE 2	Prestage	STAGE 1	STAGE 2	Prestage	STAGE 1	STAGE 2	Prestage	STAGE 1	STAGE 2	Prestage	
404+50	405+00				0	0	0		2043		0	-2043	0	0	2043	0	0	0	0	0
405+00	405+50				0	0	0		1580		0	-1580	0	0	1580	0	0	0	0	0
405+50	406+00				0	0	0		701		0	-701	0	0	701	0	0	0	0	0
406+00	406+50				0	0	0		457		0	-457	0	0	457	0	0	0	0	0
406+50	407+00				0	0	0		730		0	-730	0	0	730	0	0	0	0	0
407+00	407+50		0		0	0	0		719		0	-719	0	0	719	0	0	0	0	0
407+50	408+00																			
408+00	408+50		0		0	0	0		1505		0	-1505	0	0	1505	0	0	0	0	0
408+50	409+00				0	0	0		787		0	-787	0	0	787	0	0	0	0	0
409+00	409+50				0	0	0		765		0	-765	0	0	765	0	0	0	0	0
409+50	410+00				0	0	0		702		0	-702	0	0	702	0	0	0	0	0
410+00	410+50				0	0	0		796		0	-796	0	0	796	0	0	0	0	0
410+50	411+00				0	0	0		759		0	-759	0	0	759	0	0	0	0	0
411+00	411+50				0	0	0		593		0	-593	0	0	593	0	0	0	0	0
411+50	412+00				0	0	0		554		0	-554	0	0	554	0	0	0	0	0
412+00	412+50				0	0	0		523		0	-523	0	0	523	0	0	0	0	0
Ramp C																				
501+00	501+50	0			0	0	0	337			-337	0	0	337	0	0	0	0	0	0
501+50	502+00	0			0	0	0	457			-457	0	0	457	0	0	0	0	0	0
502+00	502+50	0			0	0	0	579			-579	0	0	579	0	0	0	0	0	0
502+50	503+00	0			0	0	0	710			-710	0	0	710	0	0	0	0	0	0
503+00	503+50	0			0	0	0	946			-946	0	0	946	0	0	0	0	0	0
503+50	504+00	0			0	0	0	778			-778	0	0	778	0	0	0	0	0	0
504+00	504+50	0			0	0	0	421			-421	0	0	421	0	0	0	0	0	0
504+50	505+00	0			0	0	0	772			-772	0	0	772	0	0	0	0	0	0
505+00	505+50	0			0	0	0	1310			-1310	0	0	1310	0	0	0	0	0	0
505+50	506+00	0			0	0	0	1450			-1450	0	0	1450	0	0	0	0	0	0
506+00	506+50	4			3	0	0	903			-900	0	0	900	0	0	0	0	0	0
506+50	507+00	98			83	0	0	218			-135	0	0	135	0	0	0	0	0	0
Ramp D																				
603+50	604+00	135			115	0	0	156			-41	0	0	41	0	0	0	0	0	0
604+00	604+50	105			89	0	0	147			-58	0	0	58	0	0	0	0	0	0
604+50	605+00	179			152	0	0	100			52	0	0	0	0	0	52	0	0	0
605+00	605+50	227			193	0	0	100			93	0	0	0	0	0	93	0	0	0
605+50	606+00	174			148	0	0	251			-103	0	0	103	0	0	0	0	0	0
606+00	606+50	109			93	0	0	519			-426	0	0	426	0	0	0	0	0	0
606+50	607+00	56			48	0	0	641			-593	0	0	593	0	0	0	0	0	0

G:\Jobs\2010\201003003\CAD\Site\Drawn\00\016033-ent-Schedule-Earthwork.dgn  
 07/13/2012 3:26:11 PM



USER NAME - 1654	DESIGNED - JWB	REVISED - CRAEF 09/11/2012/1
PLOT SCALE - 100.0000' / IN.	DRAWN - JWB	REVISED -
PLOT DATE - 9/13/2012	CHECKED - RS	REVISED -
	DATE - 06/15/2012	REVISED -

**STATE OF ILLINOIS**  
**DEPARTMENT OF TRANSPORTATION**

**U.S. ROUTE 30 AT IL ROUTE 31**  
**EARTHWORK SCHEDULES**  
 SCALE: N.T.S. SHEET NO. 2 OF 5

F.A.P. RTE.	SECTION	COUNTY	TOTAL SHEETS	SHEET NO.
349	(10 & 11 VB) R-3		507	43
KANE AND KENDALL			CONTRACT NO. 60133	
ILLINOIS FED. AID PROJECT				

FROM	TO	20200100						EXCAVATION AVAILABLE TO BE USED IN EMBANKMENT	EMBANKMENT			EARTHWORK BALANCE: WASTE (+) OR SHORTAGE (-)			20400800			WASTE HAUL OFF		
		EARTH EXCAVATION			CU YD				CU YD			CU YD			FURNISHED EXCAVATION			CU YD		
		STAGE 1	STAGE 2	Prestage	STAGE 1	STAGE 2	Prestage		STAGE 1	STAGE 2	Prestage	STAGE 1	STAGE 2	Prestage	STAGE 1	STAGE 2	Prestage	STAGE 1	STAGE 2	Prestage
607+00	607+50	64			54	0	0	324			-270	0	0	270	0	0	0	0	0	
607+50	608+00				0	0	0	148			-148	0	0	148	0	0	0	0	0	
608+00	608+50	11			9	0	0	181			-172	0	0	172	0	0	0	0	0	
608+50	609+00	85			72	0	0	180			-108	0	0	108	0	0	0	0	0	
609+00	609+50	21			18	0	0	228			-210	0	0	210	0	0	0	0	0	
IL 31																				
116+50	119+50		144		0	122	0		0		0	122	0	0	0	0	0	122	0	
119+50	121+50		0																	
121+50	123+00		93		0	79	0		139		0	-60	0	0	60	0	0	0	0	
123+00	124+50		204		0	173	0		623		0	-450	0	0	450	0	0	0	0	
124+50	129+17		735																	
129+17	129+50		45		0	38	0		15		0	23	0	0	0	0	0	23	0	
129+50	130+00		49		0	42	0		34		0	8	0	0	0	0	0	8	0	
130+00	131+50		65		0	55	0		97		0	-42	0	0	42	0	0	0	0	
131+50	133+50		0		0	0	0		111		0	-111	0	0	111	0	0	0	0	
133+50	134+00		0		0	0	0		10		0	-10	0	0	10	0	0	0	0	
US 30																				
1238+00	1238+50	16	9		14	8	0	0	0		14	8	0	0	0	0	14	8	0	
1238+50	1239+00	25	2		21	2	0	2	2		19	0	0	0	0	0	19	0	0	
1239+00	1239+50	31	3		26	3	0	2	6		24	-3	0	0	3	0	24	0	0	
1239+50	1240+00	40	9		34	8	0	3	11		31	-3	0	0	3	0	31	0	0	
1240+00	1240+50	82	16		70	14	0	4	18		66	-4	0	0	4	0	66	0	0	
1240+50	1241+00	187	71		159	60	0	1	11		158	49	0	0	0	0	158	49	0	
1241+00	1241+50	188	75		160	64	0	4	17		156	47	0	0	0	0	156	47	0	
1241+50	1242+00	121	40		103	34	0	12	38		91	-4	0	0	4	0	91	0	0	
1242+00	1242+50	69	44		59	37	0	27	46		32	-9	0	0	9	0	32	0	0	
1242+50	1243+00	22	47		19	40	0	28	45		-9	-5	0	9	5	0	0	0	0	
1243+00	1243+50	23	55		20	47	0	15	37		5	10	0	0	0	0	5	10	0	
1243+50	1244+00	29	75		25	64	0	5	31		20	33	0	0	0	0	20	33	0	
1244+00	1244+50	219	107		186	91	0	1	25		185	66	0	0	0	0	185	66	0	
1244+50	1245+00	481	109		409	93	0	0	22		409	71	0	0	0	0	409	71	0	
1245+00	1245+50	524	88		445	75	0	0	21		445	54	0	0	0	0	445	54	0	
1245+50	1246+00	476	72		405	61	0	0	18		405	43	0	0	0	0	405	43	0	
1246+00	1246+50	500	71		425	60	0	1	16		424	44	0	0	0	0	424	44	0	
1246+50	1247+00	559	78		475	66	0	1	16		474	50	0	0	0	0	474	50	0	
1247+00	1247+50	537	87		456	74	0	0	9		456	65	0	0	0	0	456	65	0	



P:\Jobs\2010\20103003\CAD\Site\dcn\00\06033-ent-Schedule-Earthwork.dgn  
 3/13/2012 3:50:21 PM

USER NAME - 1654	DESIGNED - JWB	REVISED - GRAEF 09/11/2012/1
	DRAWN - JWB	REVISED -
PLOT SCALE - 100.0000' / IN.	CHECKED - AS	REVISED -
PLOT DATE - 9/13/2012	DATE - 06/15/2012	REVISED -

**STATE OF ILLINOIS**  
**DEPARTMENT OF TRANSPORTATION**

<b>U.S. ROUTE 30 AT IL ROUTE 31</b> <b>EARTHWORK SCHEDULES</b>	
SCALE: N.T.S.	SHEET NO. 3 OF 5

F.A.P. RTE.	SECTION	COUNTY	TOTAL SHEETS	SHEET NO.
349	(10 & 11 V8) R-3	-	607	44
KANE AND KENDALL			CONTRACT NO. 60133	
ILLINOIS FED. AID PROJECT				





FROM	TO	20200100						20400800											
		EARTH EXCAVATION			EXCAVATION AVAILABLE TO BE USED IN EMBANKMENT			EMBANKMENT			EARTHWORK BALANCE: WASTE (+) OR SHORTAGE (-)			FURNISHED EXCAVATION			WASTE HAUL OFF		
		CU YD			CU YD			CU YD			CU YD			CU YD					
STATION	STATION	STAGE 1	STAGE 2	Prestage	STAGE 1	STAGE 2	Prestage	STAGE 1	STAGE 2	Prestage	STAGE 1	STAGE 2	Prestage	STAGE 1	STAGE 2	Prestage	STAGE 1	STAGE 2	Prestage
1266+00	1266+50	123	66		105	56	0	98	520		7	-464	0	0	464	0	7	0	0
1266+50	1267+00	97	63		82	54	0	139	647		-57	-593	0	57	593	0	0	0	0
1267+00	1267+50	78	68		66	58	0	141	347		-75	-289	0	75	289	0	0	0	0
1267+50	1268+00	72	73		61	62	0	202	206		-141	-144	0	141	144	0	0	0	0
1268+00	1268+50	Bridge Location																	
1268+50	1269+00	Bridge Location																	
1269+00	1269+50	Bridge Location																	
1269+50	1270+00	Bridge Location																	
1270+00	1270+50	Bridge Location																	
1270+50	1271+00	Bridge Location																	
1271+00	1271+50	Bridge Location																	
1271+50	1272+00	Bridge Location																	
1272+00	1272+50	Bridge Location																	
1272+50	1273+00	Bridge Location																	
1273+00	1273+50	Bridge Location																	
1273+50	1274+00	Bridge Location																	
1274+00	1274+50	22	20		19	17	0	67	35		-48	-18	0	48	18	0	0	0	0
1274+50	1275+00	16	6		14	5	0	99	70		-85	-65	0	85	65	0	0	0	0
1275+00	1275+50	20	8		17	7	0	92	61		-75	-54	0	75	54	0	0	0	0
1275+50	1276+00	18	10		15	9	0	138	46		-123	-38	0	123	38	0	0	0	0
1276+00	1276+50	20	9		17	8	0	105	53		-88	-45	0	88	45	0	0	0	0
1276+50	1277+00	16	6		14	5	0	57	63		-43	-58	0	43	58	0	0	0	0
1277+00	1277+50	14	11		12	9	0	50	38		-38	-29	0	38	29	0	0	0	0
1277+50	1278+00	16	16		14	14	0	41	8		-27	6	0	27	0	0	0	6	0
1278+00	1278+50	17	22		14	19	0	37	4		-23	15	0	23	0	0	0	15	0
1278+50	1279+00	14	24		12	20	0	29	3		-17	17	0	17	0	0	0	17	0
1279+00	1279+50	10	22		9	19	0	11	0		-3	19	0	3	0	0	0	19	0
TOTALS		47,858	63,491	0	40,679	53,342	0	26,404	63,802	1,796	14,276	-10,460	-1,796	0	10,460	1,796	14,276	0	0

P:\Jobs\2010\20100303\31\Site\Site.dgn\00\06033-sht-1-Schedule-Emb-Work.dgn  
 9/13/2012 3:29:47 PM



USER NAME - 1654	DESIGNED - JWB	REVISED - GRAEF 09/11/2012/1
DRAWN - JWB	CHECKED - RS	REVISED -
PLLOT SCALE - 100,0000' / IN.	DATE - 06/15/2012	REVISED -
PLLOT DATE - 9/13/2012		

**STATE OF ILLINOIS**  
**DEPARTMENT OF TRANSPORTATION**

<b>U.S. ROUTE 30 AT IL ROUTE 31</b> <b>EARTHWORK SCHEDULES</b>	
SCALE: N.T.S.	SHEET NO. 5 OF 5

F.A.P. RTE.	SECTION	COUNTY	TOTAL SHEETS	SHEET NO.
349	(10 & 11 VB) R-3	*	507	48
* KANE AND KENDALL			CONTRACT NO. 60133	
ILLINOIS FED. AID PROJECT				

LOCATION		30300112	35501316	35501324	35501327	35600716	40600200	40600300	40600400	40600635	40603335	40603340
		AGGREGATE SUBGRADE IMPROVEMENT, 12"	HOT-MIX ASPHALT BASE COURSE, 8"	HOT-MIX ASPHALT BASE COURSE, 10"	HOT-MIX ASPHALT BASE COURSE, 10 3/4"	HOT-MIX ASPHALT BASE COURSE WIDENING, 10"	BITUMINOUS MATERIALS (PRIME COAT)	AGGREGATE (PRIME COAT)	MIXTURE FOR JOINTS, CRACKS, AND FLANGEWAYS	LEVELING BINDER (MACHINE METHOD), N70	HOT-MIX ASPHALT SURFACE COURSE, MIX "D", N50	HOT-MIX ASPHALT SURFACE COURSE, MIX "D", N70
		(SO YD)	(SO YD)	(SO YD)	(SO YD)	(SO YD)	(TON)	(TON)	(TON)	(TON)	(TON)	(TON)
STATION	STATION											
US 30												
KANE												
1234+00	1249+00	4713	0	1855		156	4	22	5	227	0	0
1249+00	1261+00	10367	0	0		0	7	33	0	0	0	0
1261+00	1275+00	5914	0	0		0	4	18	0	0	0	0
1275+00	1277+13 / 1278+21	679	0	0		0	0	0	0	0	0	0
KENDALL												
1277+13 / 1278+21	1281+00	378	0	0		0	0	0	0	0	0	0
IL 31												
KENDALL												
79+00	92+00	0	0	0		0	3	34	13	474	0	948
92+00	100+00	51	0	0		0	2	22	8	312	0	623
100+00	106+11 / 107+36	763	0	0		364	3	24	9	343	0	686
KANE												
106+11 / 107+36	111+00	628	0	366		67	2	19	6	263	0	526
111+00	124+00	6671	0	0	6218	0	7	46	8	301	0	1299
124+00	138+00	4092	221	545	4092	10	5	37	7	274	25	1006
138+00	140+70	0	0	0		0	0	0	0	0	0	0
RAMP A												
300+00	315+00	4520	0	0		0	3	11	0	0	0	0
315+00	317+80	720	0	0		0	0	2	0	0	0	0
RAMP B												
400+00	413+34	5395	0	0		0	4	16	0	0	0	0
RAMP C												
500+00	509+54	2130	0	0		0	1	5	0	0	0	0
RAMP D												
600+00	611+65	2852	0	0		0	2	8	0	0	0	0
KANE		48681	221	2766	10310	233	41	217	27	1065	25	2831
KENDALL		1192	0	0	0	364	9	81	30	1128	0	2256
TOTALS		49873	221	2766	10310	597	50	298	57	2193	25	5087

COLUMN MOVED TO NEXT SHEET

R:\Jobs\2010\20103003\CAD\Site\vdgn\00\060133-sht-Schedule-Roadway.dgn 9/13/2012 2:29:20 PM

USER NAME * 1654	DESIGNED - JWB	REVISED - GRAEF 09/11/2012
	DRAWN - JWB	REVISED -
PLOT SCALE * 100.0000 "/ IN.	CHECKED - RS	REVISED -
PLOT DATE * 9/13/2012	DATE - 06/15/2012	REVISED -

**STATE OF ILLINOIS  
DEPARTMENT OF TRANSPORTATION**

**U.S. ROUTE 30 AT IL ROUTE 31  
ROADWAY SCHEDULES**

F.A.P. RTE.	SECTION	COUNTY	TOTAL SHEETS	SHEET NO.
349	(10 & 11 VB) R-3	*	507	47
* KANE AND KENDALL			CONTRACT NO. 60133	
ILLINOIS FED. AID PROJECT				

SCALE: N.T.S. SHEET NO. 1 OF 3

COLUMN MOVED FROM PREVIOUS SHEET

COLUMN MOVED TO NEXT SHEET

LOCATION		40603595	40701931	40701936	42000501	42001420	42001430	44300200	48101600	48102100	48203047	48203048
		POLYMERIZED HOT-MIX ASPHALT SURFACE COURSE, MIX "F", N90	HOT-MIX ASPHALT PAVEMENT (FULL DEPTH), 12 1/2"	HOT-MIX ASPHALT PAVEMENT (FULL DEPTH), 12 3/4"	PORTLAND CEMENT CONCRETE PAVEMENT 10" (JOINTED)	BRIDGE APPROACH PAVEMENT CONNECTOR (PCC)	BRIDGE APPROACH PAVEMENT CONNECTOR (FLEXIBLE)	STRIP REFLECTIVE CRACK CONTROL TREATMENT	AGGREGATE SHOULDERS, TYPE B, 8"	AGGREGATE WEDGE SHOULDER, TYPE B	HOT-MIX ASPHALT SHOULDERS, 12 1/2"	HOT-MIX ASPHALT SHOULDERS, 12 3/4"
		(TON)	(SQ YD)	(SQ YD)	(SQ YD)	(SQ YD)	(SQ YD)	(FT)	(SQ YD)	(TON)	(SQ YD)	(SQ YD)
STATION	STATION											
US 30												
KANE												
1234+00	1249+00	605	0	2157	0	0	0	3337	116	450	0	2430
1249+00	1261+00	0	0	8338	0	0	0	0	265	154	0	1939
1261+00	1275+00	0	0	4492	98	197	52	0	79	248	0	1185
1275+00	1277+13 / 1278+21	0	0	0	293	0	0	0	0	0	0	0
KENDALL												
1277+13 / 1278+21	1281+00	0	0	0	103	0	0	0	0	0	0	0
IL 31												
KENDALL												
79+00	92+00	0	0	0	0	0	0	3992	0	513	0	0
92+00	100+00	0	0	0	0	0	0	3076	24	429	0	0
100+00	106+11 / 107+36	0	0	0	0	0	0	4250	765	28	0	357
KANE												
106+11 / 107+36	111+00	0	0	0	0	0	0	3370	292	0	0	179
111+00	124+00	0	0	0	0	0	0	3095	380	0	0	348
124+00	138+00	0	0	0	0	0	0	2803	0	0	0	0
138+00	140+70	0	0	0	0	0	0	0	0	0	0	0
RAMP A												
300+00	315+00	0	2800	0	0	0	0	0	485	0	1601	0
315+00	317+80	0	497	0	0	0	0	0	106	0	209	0
RAMP B												
400+00	413+34	0	3913	0	0	0	0	0	350	0	1379	0
RAMP C												
500+00	509+54	0	1351	0	0	0	0	0	324	0	707	0
RAMP D												
600+00	611+65	0	1890	0	0	0	0	0	372	0	875	0
KANE		605	10452	14988	391	197	52	12605	2768	852	4772	6081
KENDALL		0	0	0	103	0	0	11318	790	970	0	357
TOTALS		605	10452	14988	494	197	52	23923	3558	1822	4772	6438

P:\jobs\210-2003\203\CAD\Site.dgn\00\016\013-sht-Sched.dwg-Roadway.dgn  
 9/2/2012 11:35:19 AM

USER NAME	DESIGNED	REVISED
1654	- JW8	- GRAEF 09/11/2012
PLLOT SCALE	CHECKED	REVISED
100.0000' / IN.	- RS	-
PLLOT DATE	DATE	REVISED
9/12/2012	- 06/15/2012	-

STATE OF ILLINOIS  
DEPARTMENT OF TRANSPORTATION

U.S. ROUTE 30 AT IL ROUTE 31  
ROADWAY SCHEDULES

SHEET NO. 2 OF 3

F.A.P. RTE.	SECTION	COUNTY	TOTAL SHEETS	SHEET NO.
349	(10 & 11 VBI) R-3		507	48
KANE AND KENDALL			CONTRACT NO. 60133	
ILLINOIS FED. AID PROJECT				

COLUMN MOVED FROM PREVIOUS SHEET



LOCATION		48300500	60600605	60602800	60605000	63000001	63100085	63100167	64300240						
		PORTLAND CEMENT CONCRETE SHOULDERS 10"	CONCRETE CURB, TYPE B	CONCRETE GUTTER, TYPE B	COMBINATION CONCRETE CURB AND GUTTER, TYPE B-6.24	STEEL PLATE BEAM GUARDRAIL, TYPE A, 6 FT POSTS	TRAFFIC BARRIER TERMINAL, TYPE 6	TRAFFIC BARRIER TERMINAL, TYPE 1 (SPECIAL) TANGENT	IMPACT ATTENUATORS (FULLY REDIRECTIVE, NARROW), TEST LEVEL 2						
		(SO YD)	(FT)		(FT)		(FT)		(EACH)		(EACH)		(EACH)		
STATION	STATION		LT	RT	LT	RT	LT	RT	LT	RT	LT	RT	LT	RT	
US 30															
KANE															
1234+00	1249+00	0	0	0	0	0	0	0	450.5	0.0	0	0	1	0	0
1249+00	1261+00	0	0	0	460	0	0	0	262.0	0.0	2	0	1	0	0
1261+00	1275+00	61	0	0	0	0	0	0	0.0	0.0	0	1	0	1	0
1275+00	1277+13 / 1278+21	356	0	0	0	0	0	0	0.0	0.0	0	0	0	0	0
KENDALL															
1277+13 / 1278+21	1281+00	253	0	0	0	0	0	0	0.0	0.0	0	0	0	0	0
IL 31															
KENDALL															
79+00	92+00	0	0	0	0	0	0	0	0.0	0.0	0	0	0	0	0
92+00	100+00	0	0	0	0	0	0	0	0.0	0.0	0	0	0	0	0
100+00	106+11 / 107+36	0	0	0	0	0	0	0	0.0	0.0	0	0	0	0	0
KANE															
106+11 / 107+36	111+00	0	0	0	0	150	0	0	0.0	0.0	0	0	0	0	0
111+00	124+00	0	0	0	0	302	149	12.5	0.0	0.0	0	0	1	0	0
124+00	138+00	0	131	0	0	1293	529	0.0	0.0	0.0	0	0	0	0	0
138+00	140+70	0	0	0	0	0	0	0.0	0.0	0.0	0	0	0	0	0
RAMP A															
300+00	315+00	0	0	0	0	0	0	0	0.0	0.0	0	0	0	0	1
315+00	317+80	0	0	0	0	0	0	0	0.0	0.0	0	0	0	0	0
RAMP B															
400+00	413+34	0	0	0	0	0	0	0	0.0	0.0	0	0	0	0	0
RAMP C															
500+00	509+54	0	0	0	0	0	0	0	275.0	0.0	0	0	1	0	0
RAMP D															
600+00	611+65	0	0	0	0	0	0	0	0.0	162.5	0	0	0	1	0
KANE		417	131		460		2423		1163		3		6		1
KENDALL		253	0		0		0		0		0		0		0
TOTALS		670	131		460		2423		1163		3		6		1

P:\\_jobs\210-2003003\CAD\Site.dgn 9/12/2012 10:57:38 AM

USER NAME - 1654	DESIGNED - JWB	REVISED - GRAEF 09/11/2012/1
PLOT SCALE - 100.0000' / IN.	DRAWN - JWB	REVISED -
PLOT DATE - 9/12/2012	CHECKED - RS	REVISED -
	DATE - 06/15/2012	REVISED -

**STATE OF ILLINOIS  
DEPARTMENT OF TRANSPORTATION**

**U.S. ROUTE 30 AT IL ROUTE 31  
ROADWAY SCHEDULE**

SHEET NO. 3 OF 3

F.A.P. RTE.	SECTION	COUNTY	TOTAL SHEETS	SHEET NO.
349	(10 & 11 VB) R-3	*	507	48A
* KANE AND KENDALL			CONTRACT NO. 60133	
ILLINOIS FED. AID PROJECT				

CURVE NB31-1  
 PI STA. = 106+18.14  
 $\Delta = 24^\circ 53' 49''$  (RT)  
 $D = 2^\circ 02' 46''$   
 $R = 2,800.16'$   
 $T = 618.14'$   
 $L = 1,216.77'$   
 $E = 67.42'$   
 $e = 2.0\%$  (EX.)  
 T.R. = N/A  
 S.E. RUN = N/A  
 P.C. STA. = 100+00.00  
 P.T. STA. = 112+16.77  
 DS=50 MPH; PS=45 MPH

CURVE NB31-2  
 PI STA. = 118+12.62  
 $\Delta = 26^\circ 49' 55''$  (LT)  
 $D = 3^\circ 49' 10''$   
 $R = 1,500.08'$   
 $T = 357.81'$   
 $L = 702.50'$   
 $E = 42.08'$   
 $e = 2.0\%$   
 T.R. = N/A  
 S.E. RUN = N/A  
 P.C. STA. = 114+54.81  
 P.T. STA. = 121+57.31  
 DS=50 MPH; PS=45 MPH

CURVE SB31-1  
 PI STA. = 206+05.93  
 $\Delta = 26^\circ 14' 15''$  (RT)  
 $D = 2^\circ 12' 13''$   
 $R = 2,600.00'$   
 $T = 605.93'$   
 $L = 1,190.62'$   
 $E = 69.67'$   
 $e = 2.0\%$  (EX.)  
 T.R. = N/A  
 S.E. RUN = N/A  
 P.C. STA. = 200+00.00  
 P.T. STA. = 211+90.62  
 DS=50 MPH; PS=45 MPH

CURVE SB31-2  
 PI STA. = 215+20.99  
 $\Delta = 8^\circ 57' 52''$  (LT)  
 $D = 1^\circ 54' 24''$   
 $R = 3,005.00'$   
 $T = 235.56'$   
 $L = 470.16'$   
 $E = 9.22'$   
 $e = 2.0\%$  (EX.)  
 T.R. = N/A  
 S.E. RUN = N/A  
 P.C. STA. = 212+85.43  
 P.T. STA. = 217+55.59  
 DS=50 MPH; PS=45 MPH

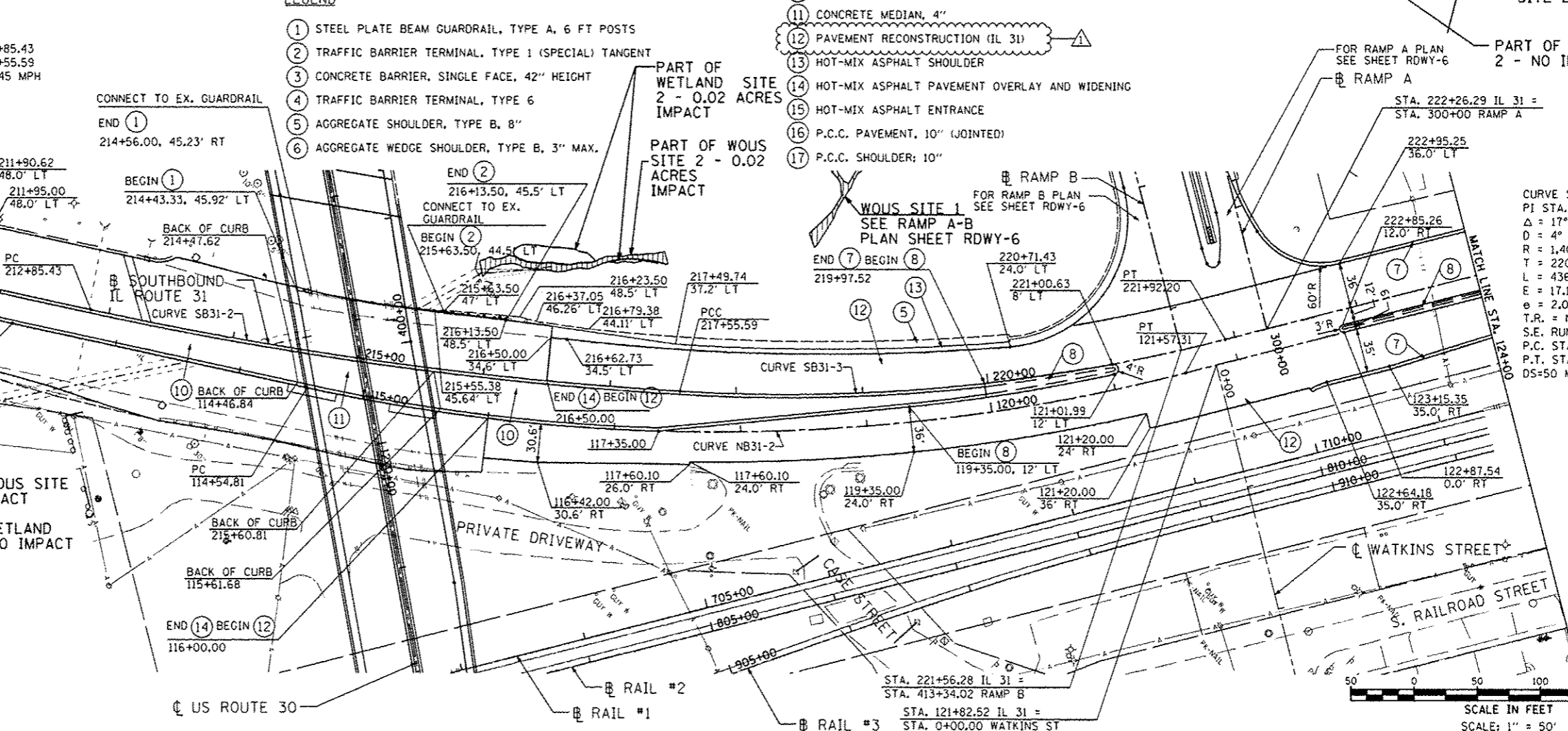
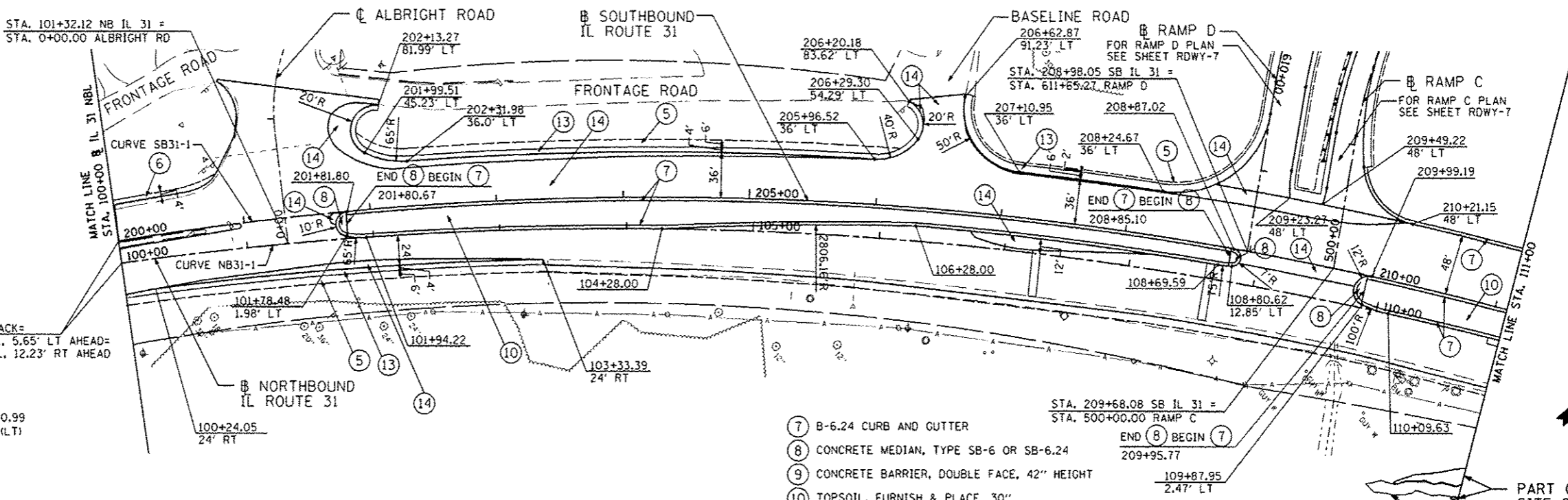
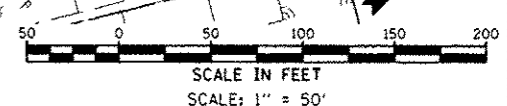
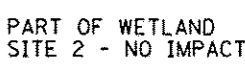

**LEGEND**

- ① STEEL PLATE BEAM GUARDRAIL, TYPE A, 6 FT POSTS
- ② TRAFFIC BARRIER TERMINAL, TYPE 1 (SPECIAL) TANGENT
- ③ CONCRETE BARRIER, SINGLE FACE, 42" HEIGHT
- ④ TRAFFIC BARRIER TERMINAL, TYPE 6
- ⑤ AGGREGATE SHOULDER, TYPE B, 8"
- ⑥ AGGREGATE WEDGE SHOULDER, TYPE B, 3" MAX.
- ⑦ B-6.24 CURB AND CUTTER
- ⑧ CONCRETE MEDIAN, TYPE SB-6 OR SB-6.24
- ⑨ CONCRETE BARRIER, DOUBLE FACE, 42" HEIGHT
- ⑩ TOPSOIL, FURNISH & PLACE, 30"
- ⑪ CONCRETE MEDIAN, 4"
- ⑫ PAVEMENT RECONSTRUCTION (IL 31)
- ⑬ HOT-MIX ASPHALT SHOULDER
- ⑭ HOT-MIX ASPHALT PAVEMENT OVERLAY AND WIDENING
- ⑮ HOT-MIX ASPHALT ENTRANCE
- ⑯ P.C.C. PAVEMENT, 10" (JOINTED)
- ⑰ P.C.C. SHOULDER; 10"

PART OF WETLAND SITE 2 - 0.02 ACRES IMPACT

PART OF WOUS SITE 2 - 0.02 ACRES IMPACT

-PART OF WOUS SITE 2 - NO IMPACT

PART OF WETLAND SITE 2 - NO IMPACT

USER NAME = JWS	DESIGNED - JWB	REVISED - GRAEF 9-11-12
PLOT SCALE = 1/8" = 100'	DRAWN - JWB	REVISED -
PLOT DATE = 9/12/2012	CHECKED - RS	REVISED -
	DATE - 06/15/2012	REVISED -

**STATE OF ILLINOIS**  
**DEPARTMENT OF TRANSPORTATION**

<b>U.S. ROUTE 30 AT IL ROUTE 31</b>		
<b>ROADWAY PLAN - IL ROUTE 31</b>		
SCALE: 1"=50'	SHEET NO. RDWY-4 OF 7	STA. 100+00 TO STA. 124+00

F.A.P. RTE. 349	SECTION (10 & 11 VB) R-3	COUNTY *	TOTAL SHEETS 507	SHEET NO. 78
* KANE AND KENDALL			CONTRACT NO. 60133	
ILLINOIS FED. AID PROJECT				

P:\Jobs\2010\20103033\CAD\_Site\dwg\001\033\_sht-plan-04.dwg  
 9/12/2012 8:46:09 AM

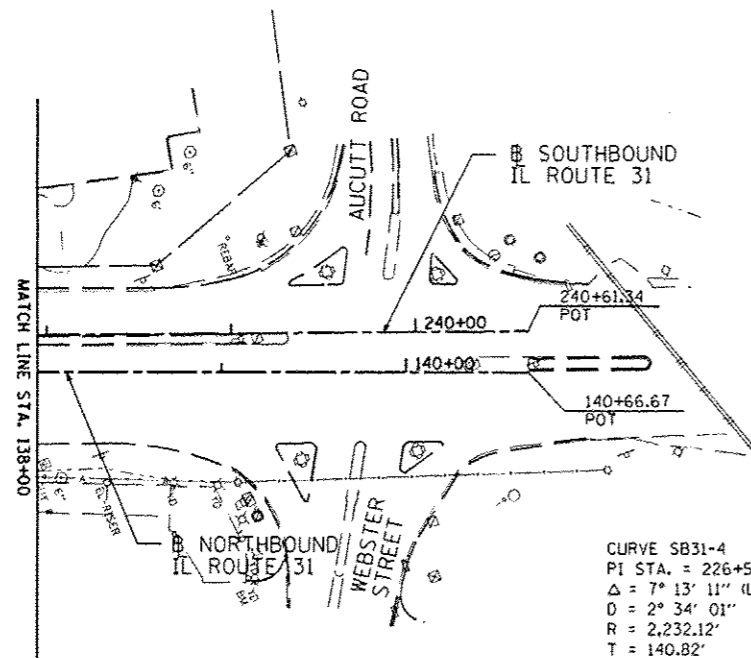
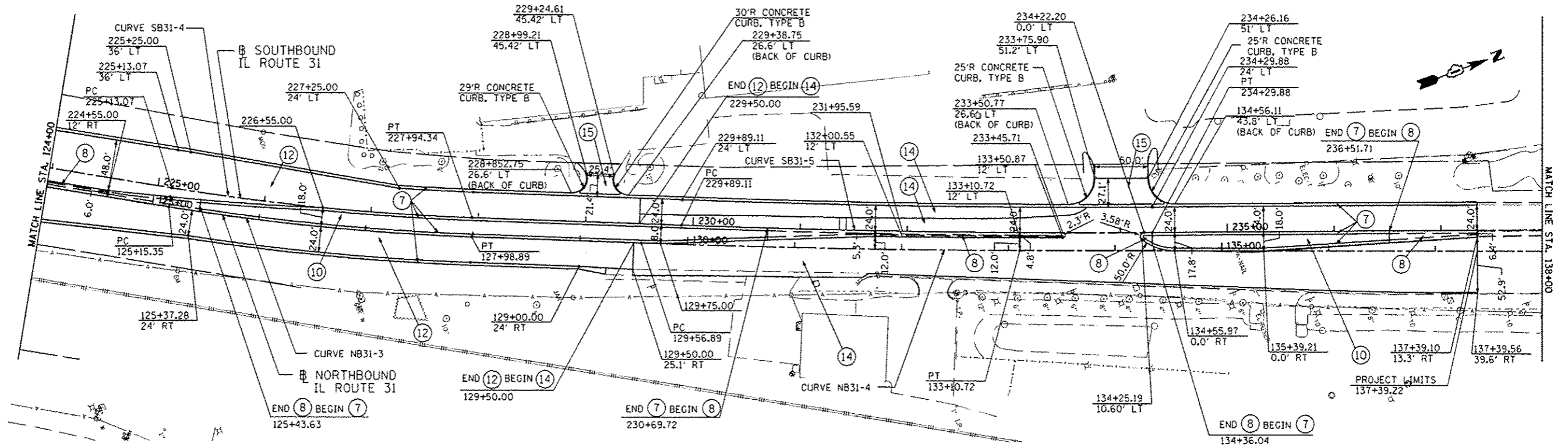

CURVE NB31-3  
 PI STA. = 126+57.31  
 $\Delta = 7^\circ 13' 11''$  (LT)  
 $D = 2^\circ 32' 47''$   
 $R = 2,250.12'$   
 $T = 141.95'$   
 $L = 283.53'$   
 $E = 4.47'$   
 $e = 2.0\%$   
 $T.R. = 51'$   
 $S.E. RUN = 69'$   
 $P.C. STA. = 125+15.35$   
 $P.T. STA. = 127+98.89$   
 $DS=50 MPH; PS=45 MPH$

CURVE NB31-4  
 PI STA. = 131+33.82  
 $\Delta = 2^\circ 01' 38''$  (LT)  
 $D = 0^\circ 34' 23''$   
 $R = 10,000.55'$   
 $T = 176.94'$   
 $L = 353.84'$   
 $E = 1.57'$   
 $e = 2.0\%$  (EX.)  
 $T.R. = N/A$   
 $S.E. RUN = N/A$   
 $P.C. STA. = 129+56.89$   
 $P.T. STA. = 133+10.72$   
 $DS=50 MPH; PS=45 MPH$

CURVE SB31-4  
 PI STA. = 226+53.89  
 $\Delta = 7^\circ 13' 11''$  (LT)  
 $D = 2^\circ 34' 01''$   
 $R = 2,232.12'$   
 $T = 140.82'$   
 $L = 281.26'$   
 $E = 4.44'$   
 $e = 2.0\%$   
 $T.R. = N/A$   
 $S.E. RUN = N/A$   
 $P.C. STA. = 225+13.07$   
 $P.T. STA. = 227+94.34$   
 $DS=50 MPH; PS=45 MPH$

CURVE SB31-5  
 PI STA. = 232+09.53  
 $\Delta = 2^\circ 31' 31''$  (LT)  
 $D = 0^\circ 34' 23''$   
 $R = 10,000.00'$   
 $T = 220.42'$   
 $L = 440.76'$   
 $E = 2.43'$   
 $e = 2.0\%$  (EX.)  
 $T.R. = N/A$   
 $S.E. RUN = N/A$   
 $P.C. STA. = 229+89.11$   
 $P.T. STA. = 234+29.88$   
 $DS=50 MPH; PS=45 MPH$

**LEGEND**

- ① STEEL PLATE BEAM GUARDRAIL, TYPE A, 6 FT POSTS
- ② TRAFFIC BARRIER TERMINAL, TYPE 1 (SPECIAL) TANGENT
- ③ CONCRETE BARRIER, SINGLE FACE, 42" HEIGHT
- ④ TRAFFIC BARRIER TERMINAL, TYPE 6
- ⑤ AGGREGATE SHOULDER, TYPE B, 8"
- ⑥ AGGREGATE WEDGE SHOULDER, TYPE B, 3" MAX.
- ⑦ B-6.24 CURB AND GUTTER
- ⑧ CONCRETE MEDIAN, TYPE SB-6 OR SB-6.24
- ⑨ CONCRETE BARRIER, DOUBLE FACE, 42" HEIGHT
- ⑩ TOPSOIL, FURNISH & PLACE, 30"
- ⑪ CONCRETE MEDIAN, 4"
- ⑫ PAVEMENT RECONSTRUCTION (IL 31)
- ⑬ HOT-MIX ASPHALT SHOULDER
- ⑭ HOT-MIX ASPHALT PAVEMENT OVERLAY AND WIDENING
- ⑮ HOT-MIX ASPHALT ENTRANCE
- ⑯ P.C.C. PAVEMENT, 10" (JOINTED)
- ⑰ P.C.C. SHOULDER, 10"

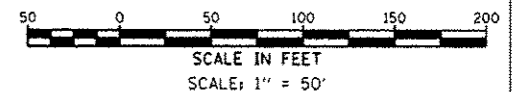

P:\Jobs\2012\20120303\CAD\Site\dwg\001860133-sht-plan-05.dgn  
 5/27/2012 11:46:27 AM

USER NAME = 1654	DESIGNED - JWB	REVISED - GRAEF 9-11-12
	DRAWN - JWB	REVISED -
PLOT SCALE = 100.0000' / IN.	CHECKED - RS	REVISED -
PLOT DATE = 9/12/2012	DATE - 06/15/2012	REVISED -

**STATE OF ILLINOIS**  
**DEPARTMENT OF TRANSPORTATION**

<b>U.S. ROUTE 30 AT IL ROUTE 31</b> <b>ROADWAY PLAN - IL ROUTE 31</b>		
SCALE: 1"=50'	SHEET NO. RDWY-5 OF 7	(IL 31) STA. 124+00 TO STA. 140+67

F.A.P. RTE.	SECTION	COUNTY	TOTAL SHEETS	SHEET NO.
349	(10 & 11) VBI R-3		507	77
KANE AND KENDALL			CONTRACT NO. 60133	
ILLINOIS FED. AID PROJECT				