

DATE	
BY	
SURVEYED	
PLOTTED	
TEMPLATE	
AREAS CHECKED	
FINAL SURVEY NOTE BOOK NO.	

DATE	
BY	
SURVEYED	
PLOTTED	
TEMPLATE	
AREAS CHECKED	
ORIGINAL SURVEY NOTE BOOK NO.	

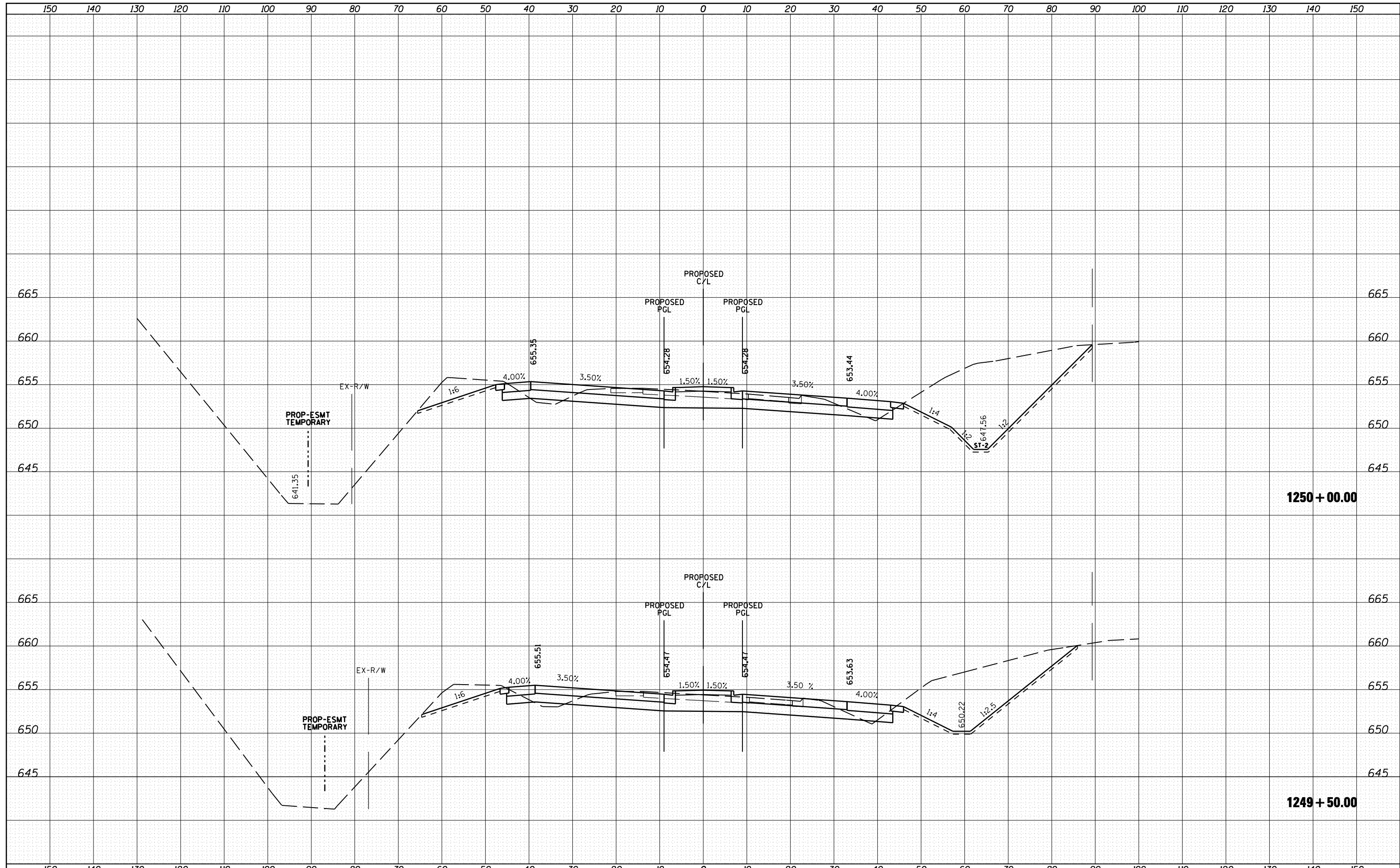

FILE NAME = h:\jobs\2010\20103003\cod\site\dgn\refs\US-30.D
 USER NAME = 1654
 60133-sht-US30-xsec.dgn
 PLOT SCALE = 20.0000' / IN.
 PLOT DATE = 5/16/2012

DESIGNED - NGS
 DRAWN - NGS
 CHECKED - RS
 DATE - 05/11/2012

REVISED -
 REVISED -
 REVISED -
 REVISED -

**STATE OF ILLINOIS
 DEPARTMENT OF TRANSPORTATION**

**U.S. ROUTE 30 AT IL ROUTE 31
 CROSS SECTIONS - U.S. ROUTE 30**
 SCALE: SHEET NO. 15 OF 41 SHEETS STA. 1249+50.00 TO STA. 1250+00.00

F.A. RTE.	SECTION	COUNTY	TOTAL SHEETS	SHEET NO.
349	(10 & 11 VB) R-3	*	507	400
* KANE AND KENDALL			CONTRACT NO. 60133	
ILLINOIS FED. AID PROJECT				