

DATE	
BY	
SURVEYED	
PLOTTED	
TEMPLATE	
AREAS	
CHECKED	
FINAL	
NO. SURVEY	
NOTE BOOK	
NO.	

DATE	
BY	
SURVEYED	
PLOTTED	
TEMPLATE	
AREAS	
CHECKED	
ORIGINAL	
NO. SURVEY	
NOTE BOOK	
NO.	

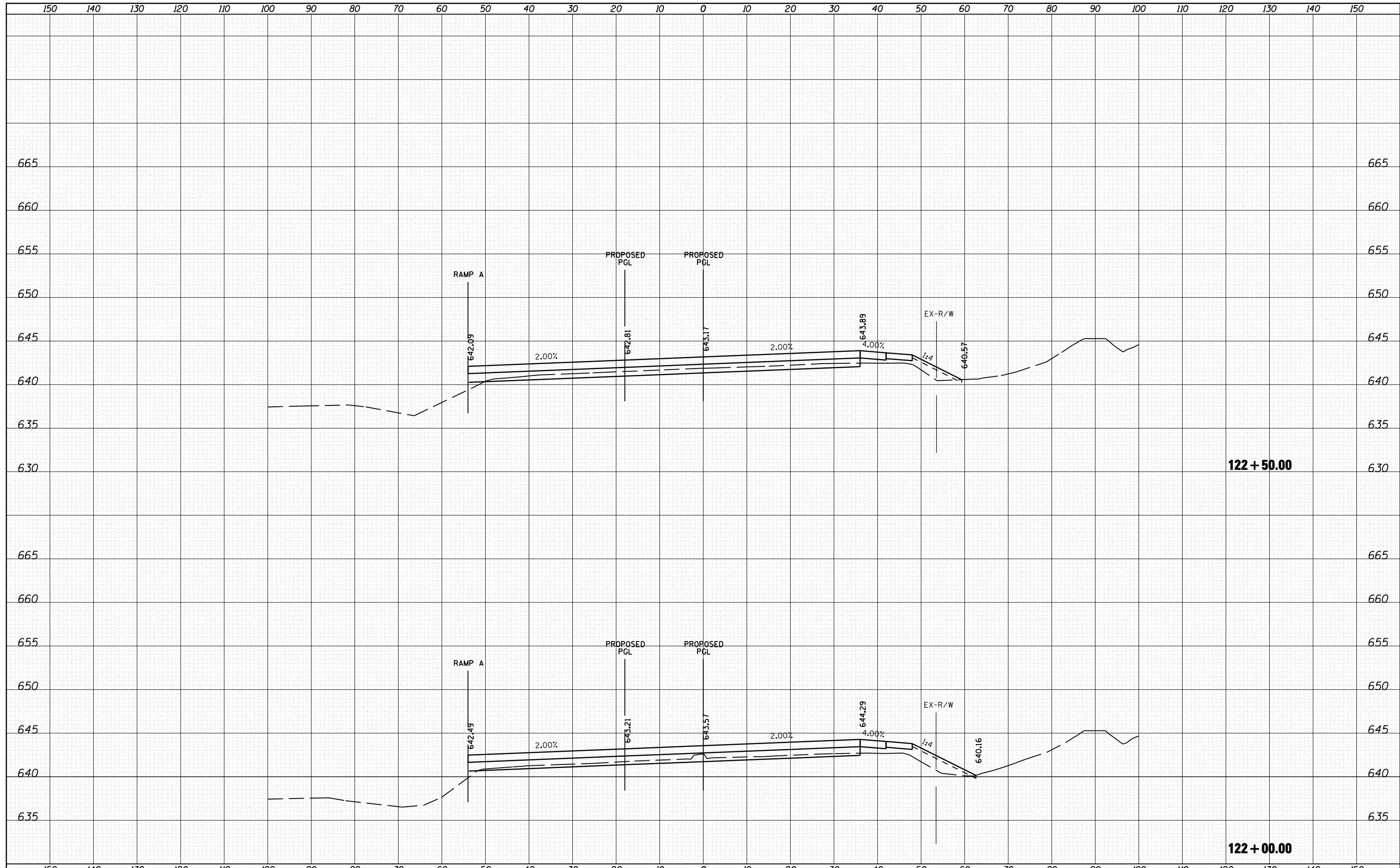

FILE NAME =	USER NAME = 1654	DESIGNED - NGS	REVISED -	STATE OF ILLINOIS DEPARTMENT OF TRANSPORTATION	U.S. ROUTE 30 AT IL ROUTE 31 CROSS SECTIONS - IL ROUTE 31			F.A. RTE.	SECTION	COUNTY	TOTAL SHEETS	SHEET NO.
ht:\jobs\2010\20103003\cod\site\dgn\refs\IL-31\160133-sh.t..il31-xsec-NB.dgn		DRAWN - NGS	REVISED -		349	(10 & 11 VB) R-3	*	507	450			
PLOT SCALE = 20.0000' / IN.		CHECKED - RS	REVISED -		* KANE AND KENDALL			CONTRACT NO. 60133				
PLOT DATE = 5/16/2012		DATE - 05/11/2012	REVISED -		SCALE:	SHEET NO. 24 OF 39 SHEETS	STA. 122+00.00 TO STA. 122+50.00	ILLINOIS FED. AID PROJECT				