

**INDEX OF SHEETS**

FOR INDEX OF SHEETS, SEE SHEET NO. 2

PROJECT LOCATED IN VILLAGE OF MIDLOTHIAN, THE CITY OF HARVEY, THE VILLAGE OF POSEN AND THE VILLAGE OF DDXMOOR

TRAFFIC DATA:	ADT (2030)	DESIGN SPEED	POSTED SPEED
147TH STREET	23,000	40 MPH	35 MPH
KEDZIE AVENUE	22,000	40 MPH	35 MPH
DIXIE HIGHWAY	11,000	40 MPH	35 MPH
WESTERN AVENUE	10,000	40 MPH	35 MPH

**PROJECT DESCRIPTION**

THE PROPOSED 147TH STREET IMPROVEMENT INCLUDES PAVEMENT RECONSTRUCTION AND WIDENING, TRAFFIC SIGNALS, ROADWAY LIGHTING, AND DRAINAGE. WORK WILL INCLUDE PORTIONS OF I-57 ENTRANCE AND EXIT RAMP AS WELL AS PORTIONS OF WESTERN AVENUE AND DIXIE HIGHWAY.

**DESIGN DESIGNATION**

1780(30) ARTERIAL

**STATE OF ILLINOIS  
DEPARTMENT OF TRANSPORTATION  
DIVISION OF HIGHWAYS**

**PROPOSED HIGHWAY PLANS**

FAP 397

**IL-83 (147TH STREET): KEDZIE AVENUE TO  
WESTERN AVENUE (DIXIE HIGHWAY)**

**ROADWAY RECONSTRUCTION, LIGHTING  
AND TRAFFIC SIGNAL INSTALLATION**

**COOK COUNTY**

C -91-130-11

PROJ. TIG - F-0397(004)

**SECTION (0405-1 & 0506-2) R-1  
PROJECT NO.**

These plans were prepared and initially advertised to allow bidders to choose between PCC or HMA pavement. Prior to the acceptance of bids the Department made the decision to only accept bids for the PCC option. Any reference in these plans and Special Provisions to the HMA pavement alternate (Alternate B) will not apply.

F.A.I. RTE.	SECTION	COUNTY	TOTAL SHEETS	SHEET NO.
57		COOK	577	1
FED. ROAD DIST. NO.	ILLINOIS	CONTRACT NO.	60M57	
D-91-130-11 (0405-1 & 0506-2) R-1				

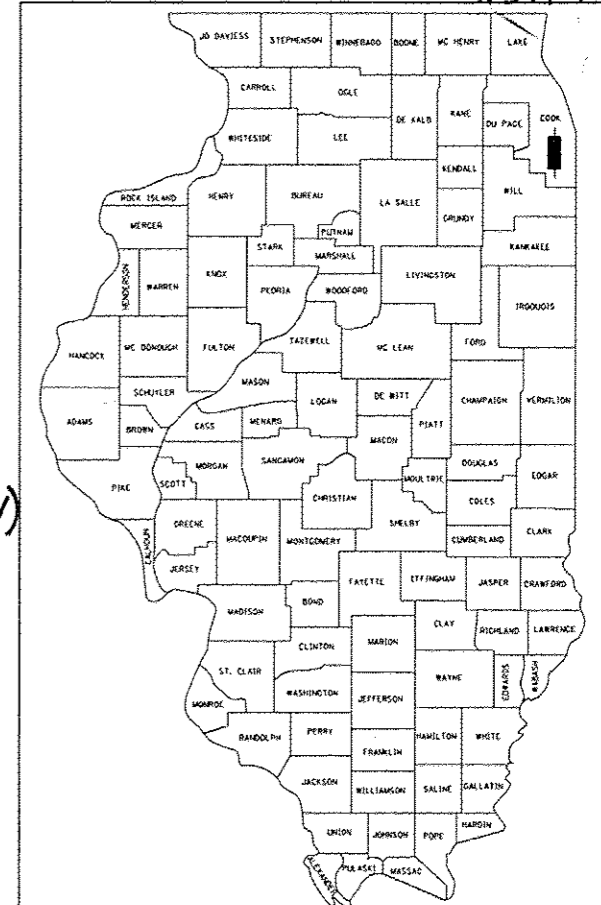

LOCATION OF SECTION INDICATED THUS: - [Red Box] -

STATE OF ILLINOIS  
DEPARTMENT OF TRANSPORTATION  
DIVISION OF HIGHWAYS

SUBMITTED MAY 2, 2012

*Diana M. O'Keefe*  
DEPUTY DIRECTOR OF HIGHWAYS, REGION ENGINEER

August 17, 2012  
*John D. Bauamelli P.E./B*  
ACTING ENGINEER OF DESIGN AND ENVIRONMENT

August 17, 2012  
*William Z. Freiler*  
ACTING DIRECTOR OF HIGHWAYS, CHIEF ENGINEER

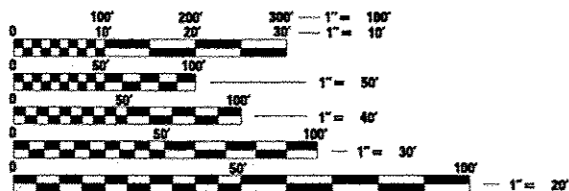

FULL SIZE PLANS HAVE BEEN PREPARED USING STANDARD ENGINEERING SCALES. REDUCED SIZED PLANS WILL NOT CONFORM TO STANDARD SCALES. IN MAKING MEASUREMENTS ON REDUCED PLANS, THE ABOVE SCALES MAY BE USED.

J.U.L.I.E.  
JOINT UTILITY LOCATION INFORMATION FOR EXCAVATION  
1-800-892-0123

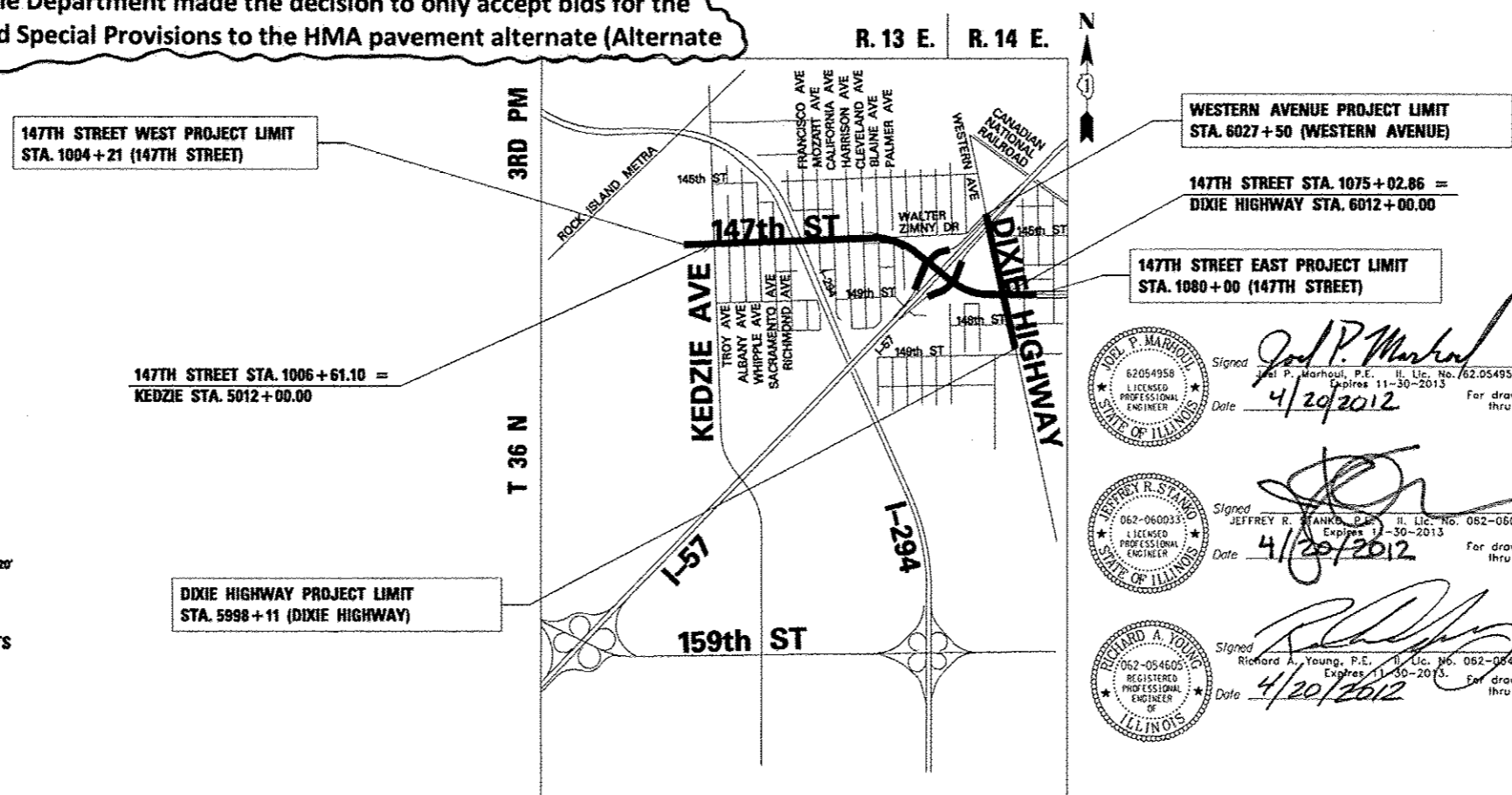

PROJECT MANAGER: HELEN PAZON (847) 705-4523

CONTRACT NO. 60M57

**VILLAGE OF POSEN**

**LOCATION MAP**

GROSS LENGTH OF PROJECT = 12,360 FT. = 2.34 MI.  
NET LENGTH OF PROJECT = 12,360 FT. = 2.34 MI.

**TYLIN INTERNATIONAL**  
200 SOUTH WACKER DRIVE, SUITE 1400  
CHICAGO, ILLINOIS 60606  
TEL: 312-777-2900 FAX: 312-705-0305

**PRINTED BY THE AUTHORITY  
OF THE STATE OF ILLINOIS**

Rev. 9-12-12 Rev.