

p:\602540(57-294)\road\p10_147th\PI0_AL_SHT05.dgn 2:55:16 PM 5/21/2012

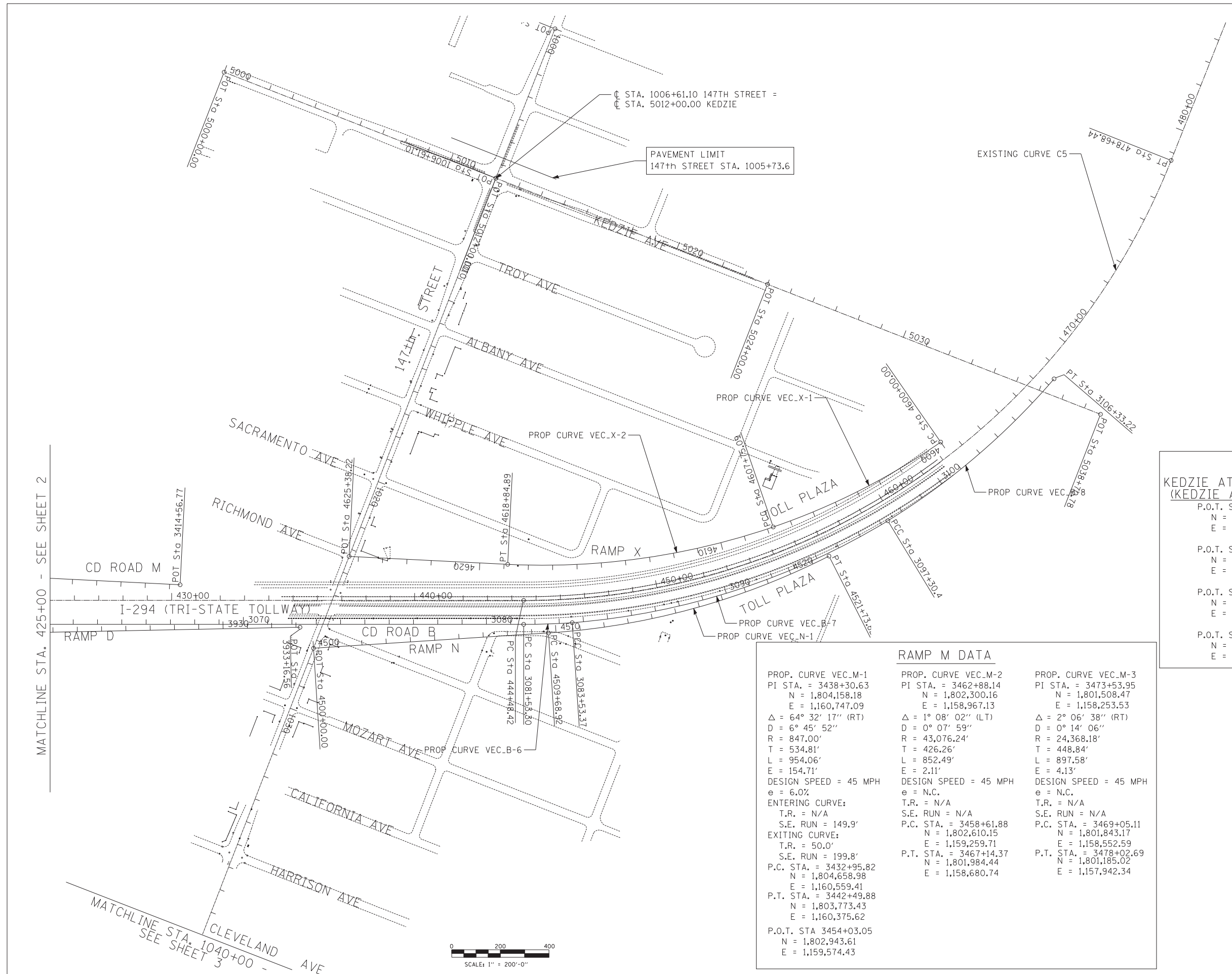

RAMP X DATA	
PROP. CURVE VEC.X-1 PI STA. = 4603+90.08 N = 1,808,814.76 E = 1,158,463.84 Δ = 15° 58' 58" (RT) D = 2° 03' 43" R = 2,778.58' T = 390.08' L = 775.09' E = 27.25'	PROP. CURVE VEC.X-2 PI STA. = 4613+36.74 N = 1,808,110.64 E = 1,159,104.16 Δ = 21° 44' 21" (RT) D = 1° 57' 32" R = 2,925.00' T = 561.65' L = 1,109.80' E = 53.44'
DESIGN SPEED = XX MPH e = -----%	DESIGN SPEED = XX MPH e = -----%
ENTERING CURVE: T.R. = ----- S.E. RUN = -----	ENTERING CURVE: T.R. = ----- S.E. RUN = -----
EXITING CURVE: T.R. = ----- S.E. RUN = -----	EXITING CURVE: T.R. = ----- S.E. RUN = -----
P.C. STA. = 4600+00.00 N = 1,809,019.93 E = 1,158,132.08	P.C.C. STA. = 4607+75.09 N = 1,807,526.17 E = 1,158,726.28
P.C.C. STA. = 4607+75.09 N = 1,807,526.17 E = 1,158,726.28	P.T. STA. = 4618+84.89 N = 1,807,584.71 E = 1,159,301.26

KEDZIE AT 147th STREET (KEDZIE AVENUE (NORTH))	
P.O.T. STA 5000+00.00 N = 1,805,709.68 E = 1,157,906.86	
P.O.T. STA 5012+00.00 N = 1,806,908.89 E = 1,157,863.09	
P.O.T. STA 5024+00.00 N = 1,808,108.09 E = 1,157,819.44	
P.O.T. STA 5038+70.78 N = 1,809,577.90 E = 1,157,765.93	

RAMP N DATA	
P.O.T. STA 4500+00.00 N = 1,806,988.48 E = 1,159,935.55	
PROP. CURVE VEC.N-1 PI STA. = 4515+79.73 N = 1,808,394.33 E = 1,159,215.06 Δ = 23° 11' 04" (LT) D = 1° 55' 27" R = 2,977.68' T = 610.80' L = 1,204.90' E = 62.00'	
DESIGN SPEED = 45 MPH e = 4.5%	
ENTERING CURVE: T.R. = 44.4' S.E. RUN = 133.2'	
EXITING CURVE: T.R. = N/A S.E. RUN = N/A	
P.C. STA. = 4509+68.92 N = 1,807,850.76	
P.T. STA. = 4521+73.82 N = 1,808,784.34 E = 1,158,744.98	

RAMP M DATA		
PROP. CURVE VEC.M-1 PI STA. = 3438+30.63 N = 1,804,158.18 E = 1,160,747.09 Δ = 64° 32' 17" (RT) D = 6° 45' 52" R = 847.00' T = 534.81' L = 954.06' E = 154.71'	PROP. CURVE VEC.M-2 PI STA. = 3462+88.14 N = 1,802,300.16 E = 1,158,967.13 Δ = 1° 08' 02" (LT) D = 0° 07' 59" R = 43,076.24' T = 426.26' L = 852.49' E = 2.11'	PROP. CURVE VEC.M-3 PI STA. = 3473+53.95 N = 1,801,508.47 E = 1,158,253.53 Δ = 2° 06' 38" (RT) D = 0° 14' 06" R = 24,368.18' T = 448.84' L = 897.58' E = 4.13'
DESIGN SPEED = 45 MPH e = 6.0%	DESIGN SPEED = 45 MPH e = N.C.	DESIGN SPEED = 45 MPH e = N.C.
ENTERING CURVE: T.R. = N/A S.E. RUN = 149.9'	T.R. = N/A S.E. RUN = N/A	T.R. = N/A S.E. RUN = N/A
EXITING CURVE: T.R. = 50.0' S.E. RUN = 199.8'	P.C. STA. = 3458+61.88 N = 1,802,610.15 E = 1,159,259.71	P.C. STA. = 3469+05.11 N = 1,801,843.17 E = 1,158,552.59
P.C. STA. = 3432+95.82 N = 1,804,658.98 E = 1,160,559.41	P.T. STA. = 3467+14.37 N = 1,801,984.44 E = 1,158,680.74	P.T. STA. = 3478+02.69 N = 1,801,185.02 E = 1,157,942.34
P.T. STA. = 3442+49.88 N = 1,803,773.43 E = 1,160,375.62		
P.O.T. STA 3454+03.05 N = 1,802,943.61 E = 1,159,574.43		

NOTE:
CONTRACT 60M57 USES THE FOLLOWING ALIGNMENTS:
I-57, I-294, 147TH STREET, WESTERN AVENUE, DIXIE HWY,
KEDZIE AVENUE (NORTH), RAMP EX.F, RAMP E, RAMP J,
AND RAMP K. ALL OTHER ALIGNMENTS ARE FOR FUTURE
CONTRACTS AND ARE SHOWN FOR INFORMATION ONLY.

TYLIN INTERNATIONAL

USER NAME =	DESIGNED - CAC	REVISED -
	DRAWN - CAC	REVISED -
PLOT SCALE =	CHECKED - JDF	REVISED -
PLOT DATE =	DATE - 5/23/2012	REVISED -

**STATE OF ILLINOIS
DEPARTMENT OF TRANSPORTATION**

**147TH STREET PROJECT
ALIGNMENT PLANS**

SCALE: 1"=200' SHEET NO. 5 OF 10 SHEETS STA. 425+00 TO STA. 3118+34.77

F.A.I. RTE.	SECTION	COUNTY	TOTAL SHEETS	SHEET NO.
XX	(0405-1 & 0506-2) R-1	COOK	577	20
CONTRACT NO. 60M57				
FED. ROAD DIST. NO.	ILLINOIS FED. AID PROJECT			