

RAMP J

STA. 4306+80.90 TO STA. 4311+60±

- REFER TO PROPOSED PLAN FOR PAVEMENT CROSS SLOPES
- 4% AND VARIES PER IDOT STD. 483001
- STA. 4306+81.19 TO STA. 4311+22.00 (SEE PLANS)

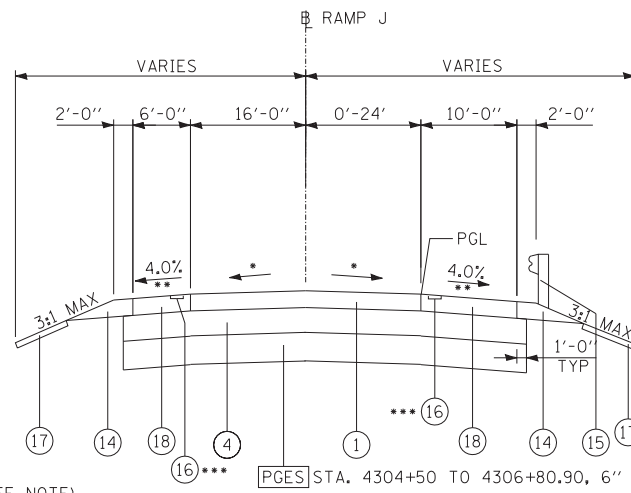

RAMP J

STA. 4304+35.49 TO STA. 4306+80.90

- REFER TO PROPOSED PLAN FOR PAVEMENT CROSS SLOPES
- 4% AND VARIES PER IDOT STD. 483001
- STA. 4304+31.00 TO STA. 4306+81.19 (SEE PLANS)

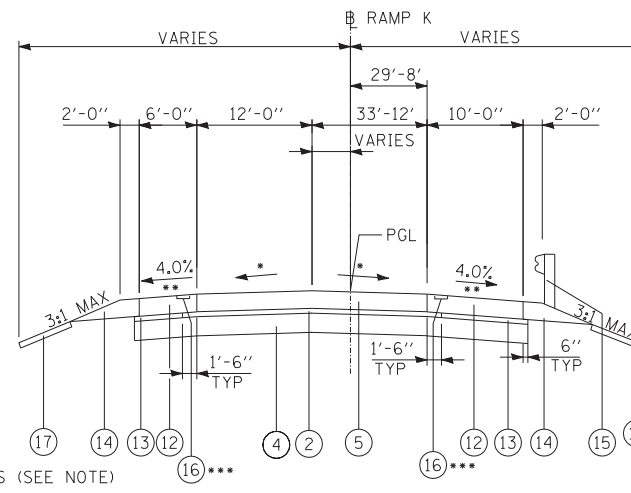

RAMP K

STA. 4401+18.60 TO STA. 4404+22.45

- REFER TO PROPOSED PLAN FOR PAVEMENT CROSS SLOPES
- 4% AND VARIES PER IDOT STD. 483001
- STA. 4401+22.00 TO STA. 4404+22.45 (SEE PLANS)

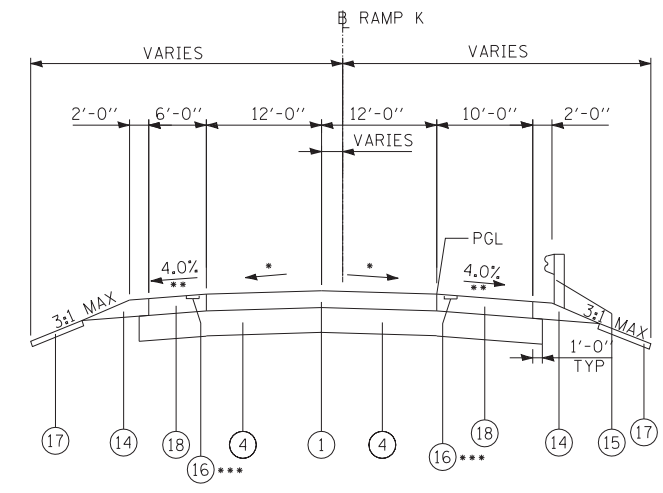

RAMP K

STA. 4404+22.45 TO STA. 4407+36.54

- REFER TO PROPOSED PLAN FOR PAVEMENT CROSS SLOPES
- 4% AND VARIES PER IDOT STD. 483001
- STA. 4404+22.45 TO STA. 4407+36.00

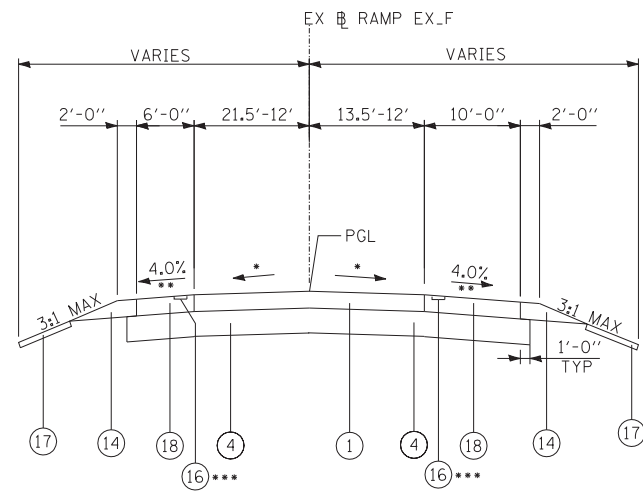

RAMP EX_F

STA. 5201+53.87 TO STA. 5202+98.21

- REFER TO PROPOSED PLAN FOR PAVEMENT CROSS SLOPES
- 4% AND VARIES PER IDOT STD. 483001
- STA. 5201+50.00 TO STA. 5202+98.00 (SEE PLANS)

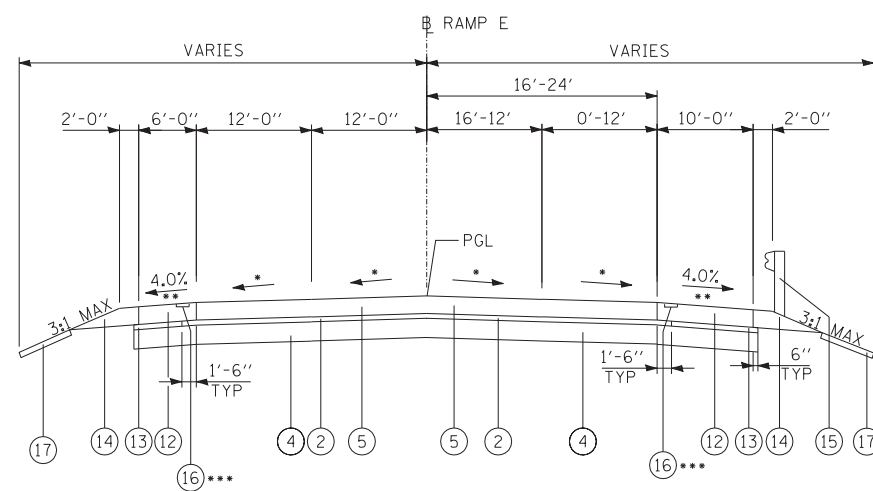

RAMP E

STA. 4110+38.73 TO STA. 4115+36±

- REFER TO PROPOSED PLAN FOR PAVEMENT CROSS SLOPES
- 4% AND VARIES PER IDOT STD. 483001
- STA. 4110+39.09 TO STA. 4114+75.83 (SEE PLANS)

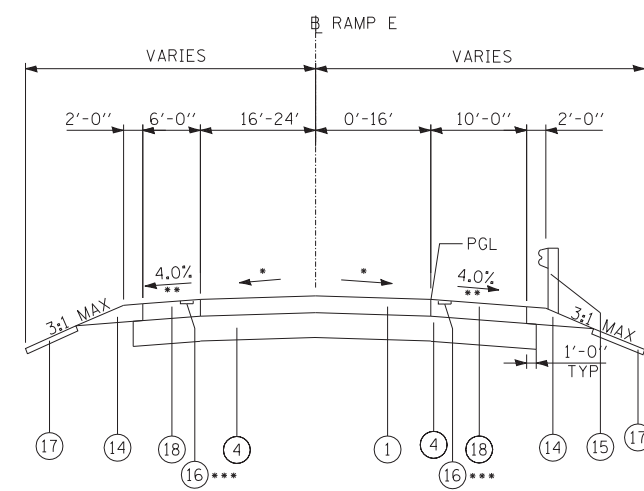

RAMP E

STA. 4107+88.03 TO STA. 4110+38.73

- REFER TO PROPOSED PLAN FOR PAVEMENT CROSS SLOPES
- 4% AND VARIES PER IDOT STD. 483001
- STA. 4108+68.00 TO STA. 4110+39.09 (SEE PLANS)

LEGEND

- PROPOSED PORTLAND CEMENT CONCRETE PAVEMENT 9" (JOINTED)
- PROPOSED STABILIZED SUBBASE- HOT-MIX ASPHALT, 4 1/2 "
- PROPOSED PORTLAND CEMENT CONCRETE PAVEMENT, 10" (JOINTED)
- AGGREGATE SUBGRADE IMPROVEMENT 12"
- PROPOSED PORTLAND CEMENT CONCRETE PAVEMENT 11" (JOINTED)
- PROPOSED POLYMERIZED HOT-MIX ASPHALT BINDER COURSE, IL-19.0, N90
- PROPOSED POLYMERIZED HOT-MIX ASPHALT SURFACE COURSE, MIX "F", N90
- PROPOSED COMBINATION CONCRETE CURB AND GUTTER, TYPE B-6.24
- PROPOSED COMBINATION CONCRETE CURB AND GUTTER, TYPE B-6.12
- PROPOSED CONCRETE CEMENT SIDEWALK, 5"
- PROPOSED MEDIAN (SEE PLANS)
- PROPOSED PORTLAND CEMENT CONCRETE SHOULDERS, 11"
- SUBBASE GRANULAR MATERIAL, TYPE C
- AGGREGATE SHOULDERS, TYPE B
- STEEL PLATE BEAM GUARDRAIL (SEE PROPOSED PLANS FOR LIMITS)
- PROPOSED SHOULDER RUMBLE STRIPS, 16"
- TOPSOIL (SEE LANDSCAPING PLANS)
- PROPOSED PORTLAND CEMENT CONCRETE SHOULDERS, 9"

PGES SEE NOTE 2 ON TYPICAL SECTIONS SHEET 4 OF 4

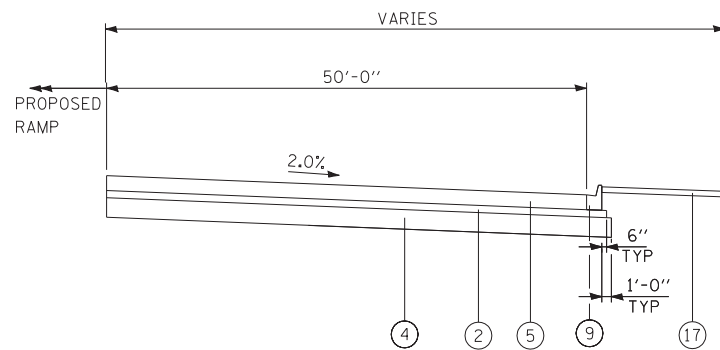

ACCIDENT INVESTIGATION SITE

RAMP E AND RAMP J

RAMP E: STA. 4110+58.39 TO STA. 4113+01.03
RAMP J: STA. 4306+96.70 TO STA. 4309+65.54

NOTES:

- RAMP J PGES PROVISION LIMITS: STA. 4304+50 TO 4307+00, 6" PGES.

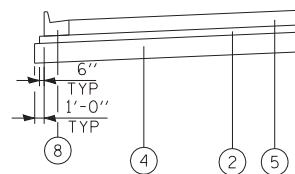

CCC&G RAMP SECTION
RAMP E, RAMP J, AND RAMP K
SEE PLANS FOR LOCATION

TYLIN INTERNATIONAL	USER NAME =	DESIGNED - DM	REVISED -	STATE OF ILLINOIS DEPARTMENT OF TRANSPORTATION	147TH STREET PROJECT			F.A.I. RT. =	SECTION	COUNTY	TOTAL SHEETS	SHEET NO.	
	DRAWN - DM	REVISED -			PROPOSED TYPICAL SECTIONS (RAMPS - PCC & HMA ALTERNATES)			XX	(0405-1 & 0506-2) R-1	COOK	577	33	
	PLOT SCALE =	CHECKED - JPM	REVISED -		SCALE: NTS			SHEET NO. 3 OF 4 SHEETS		STA.	TO STA.		CONTRACT NO. 60M57
	PLOT DATE =	DATE - 5/23/2012	REVISED -		FED. ROAD DIST. NO.			ILLINOIS		FED. AID PROJECT			