

STAGES 1, 1A, 1B, & 1C: 147TH ST: STA. 1036+30 TO STA. 1039+60
E - E

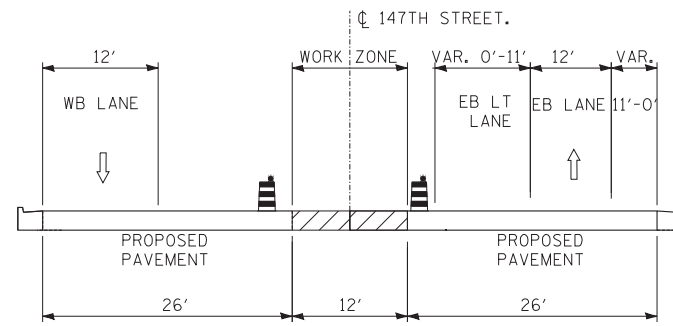

STAGES 3, 3A & 3B: 147TH ST: STA. 1030+04 TO STA. 1036+30
EE - EE

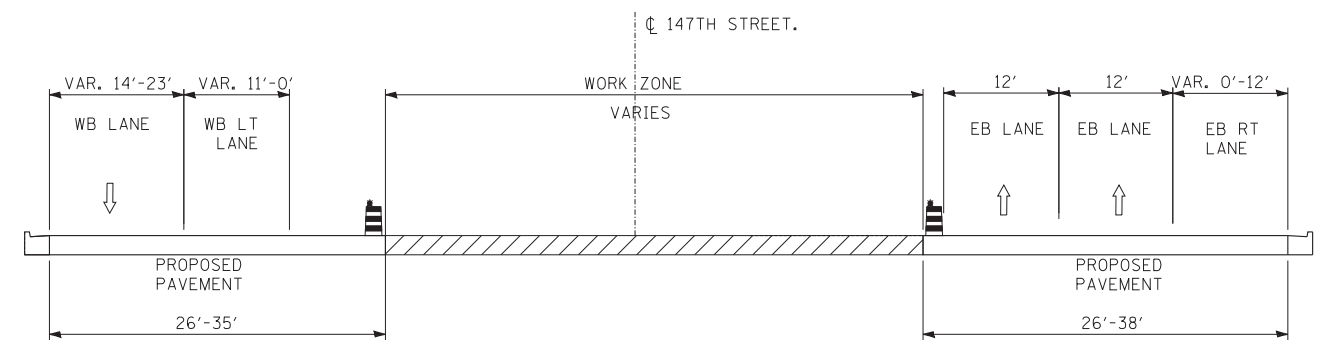

STAGE 3: 147TH ST: STA. 1040+14 TO STA. 1055+65
GG - GG

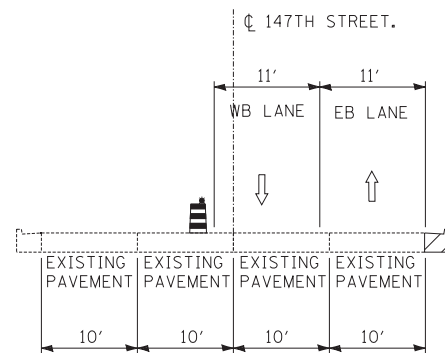

STAGES 2, 2A, 2B & 2C: 147TH ST: STA. 1020+06 TO STA. 1030+04
O - O

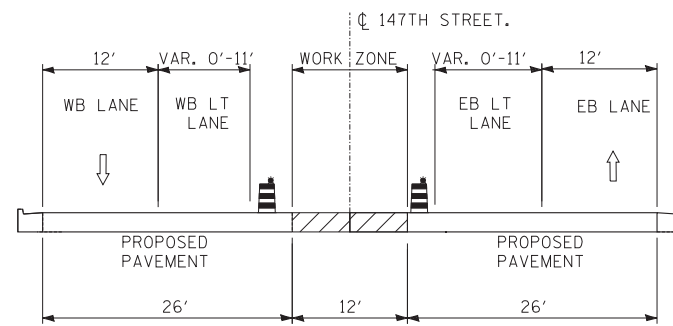

STAGES 3, 3A & 3B: 147TH ST: STA. 1030+04 TO STA. 1036+30
FF - FF

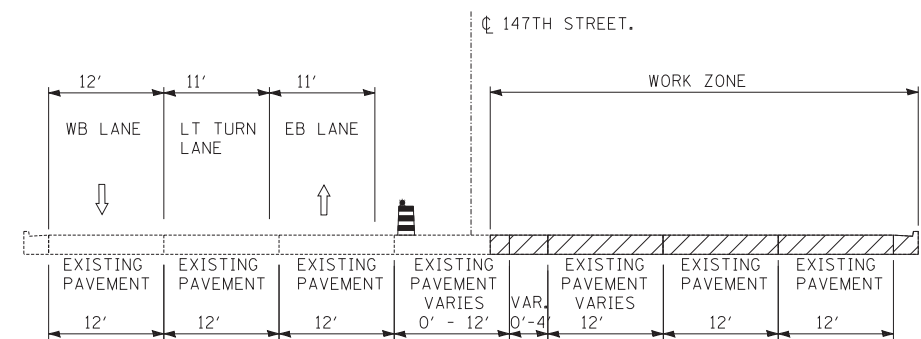

STAGES 1, 1A, 1B & 1C: 147TH ST: STA. 1056+50 TO STA. 1062+50
G - G

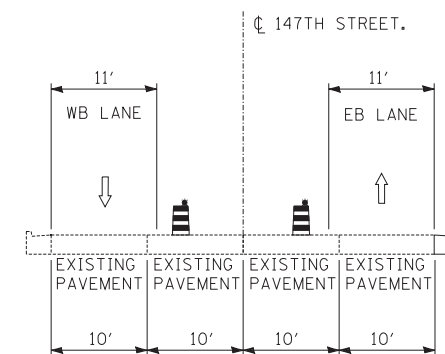

STAGE 3, 3A & 3B: 147TH ST: STA. 1020+06 TO STA. 1030+04
DD - DD

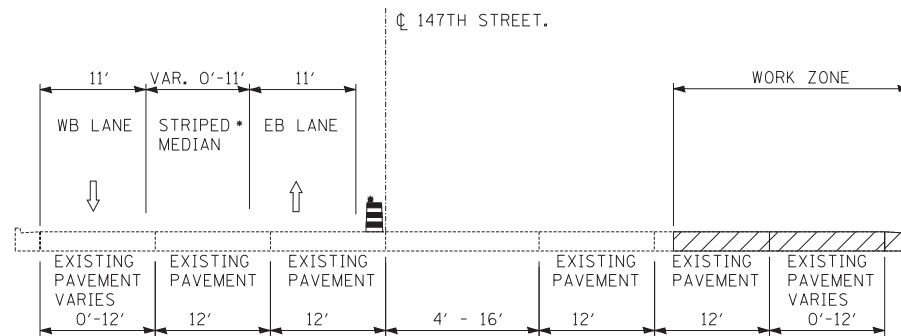

STAGES 1, 1A, 1B & 1C: 147TH ST: STA. 1040+14 TO STA. 1055+65
F - F
• 11' WIDE WB LEFT TURN LANE FROM STA. 1040+14 TO STA. 1043+56

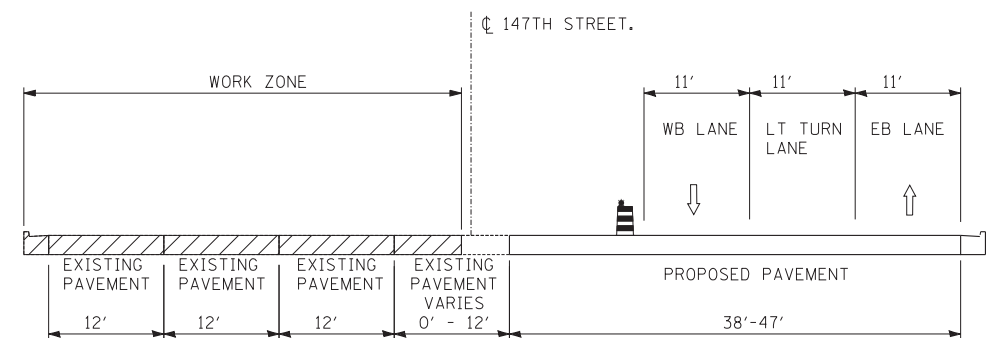

STAGE 2: 147TH ST: STA. 1056+50 TO STA. 1062+50
R - R

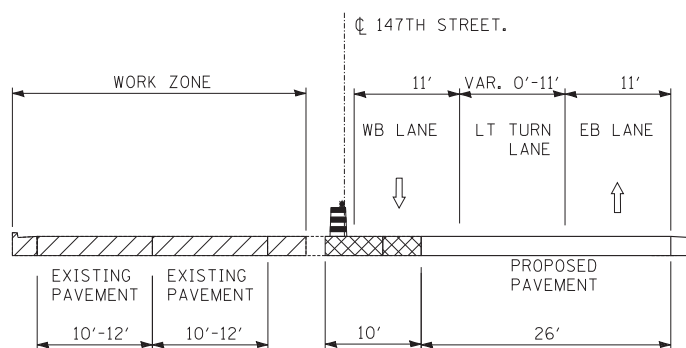

STAGES 2, 2A, 2B & 2C: 147TH ST: STA. 1030+04 TO STA. 1039+60
P - P

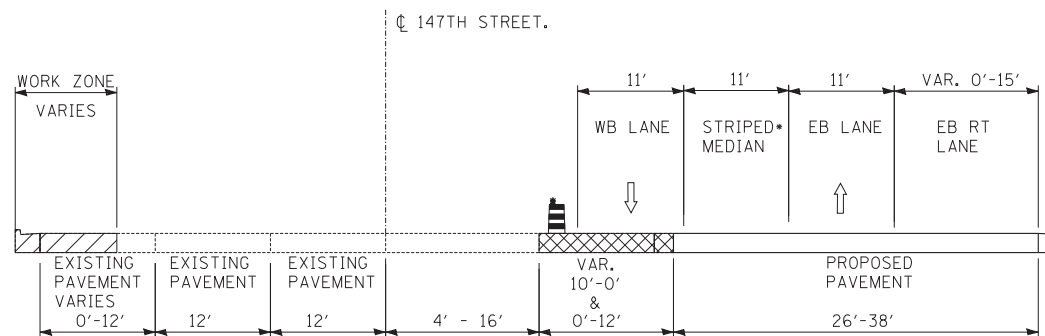

STAGES 2, 2A, 2B: 147TH ST: STA. 1040+14 TO STA. 1055+65
Q - Q
• 11' WIDE WB LEFT TURN LANE FROM STA. 1040+23 TO STA. 1044+67

- LEGEND**
- TRAFFIC MOVEMENT
 - TEMPORARY CONCRETE BARRIER (WITH MONO-DIRECTIONAL PRISMATIC REFLECTORS ON TOP AND SIDE FACING TRAFFIC)
 - WORK ZONE
 - TEMPORARY PAVEMENT
 - DRUM WITH MONO-DIRECTIONAL STEADY BURNING LIGHT

TYLIN INTERNATIONAL

USER NAME =	DESIGNED - JDU	REVISED -
PLOT SCALE =	DRAWN - JDU	REVISED -
PLOT DATE =	CHECKED - SES	REVISED -
	DATE - 5/23/2012	REVISED -

STATE OF ILLINOIS
DEPARTMENT OF TRANSPORTATION

147TH STREET PROJECT
MAINTENANCE OF TRAFFIC - TYPICAL SECTIONS

SCALE: N.T.S. SHEET NO. 5 OF 8 SHEETS STA. TO STA.

F.A.I. RTE.	SECTION	COUNTY	TOTAL SHEETS	SHEET NO.
XX	(0405-1 & 0506-2) R-1	COOK	577	97
FED. ROAD DIST. NO.			ILLINOIS FED. AID PROJECT	