

MATCHLINE STA. 5015+00

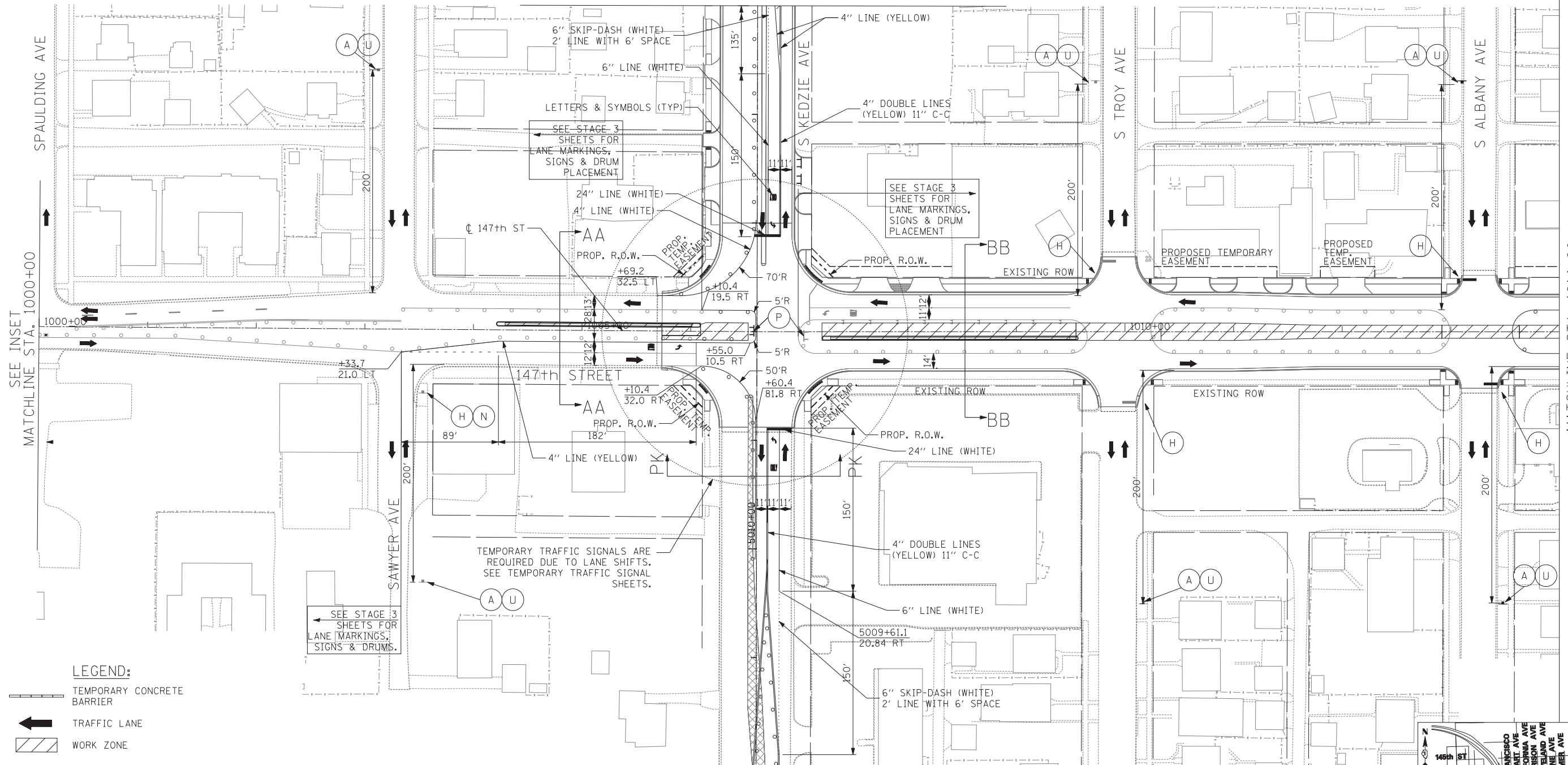

MATCHLINE STA. 5008+00

- LEGEND:**
- TEMPORARY CONCRETE BARRIER
  - TRAFFIC LANE
  - WORK ZONE
  - TEMPORARY PAVEMENT
  - BARRICADE, TYPE III
  - DRUM WITH MONO-DIRECTIONAL STEADY BURNING LIGHT
  - ARROW BOARD

SEE STAGE 3 SHEETS FOR LANE MARKINGS, SIGNS & DRUMS.

TEMPORARY TRAFFIC SIGNALS ARE REQUIRED DUE TO LANE SHIFTS. SEE TEMPORARY TRAFFIC SIGNAL SHEETS.

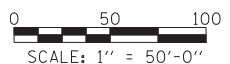
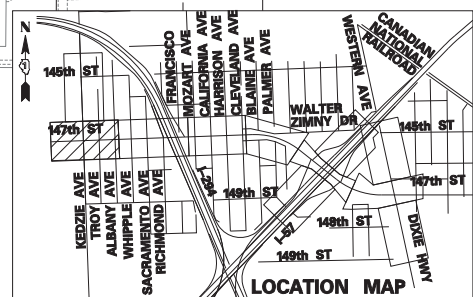

**TYLIN INTERNATIONAL**

USER NAME =	DESIGNED - DM	REVISED -
	DRAWN - DM	REVISED -
PLOT SCALE =	CHECKED - JPM	REVISED -
PLOT DATE =	DATE - 5/23/2012	REVISED -

**STATE OF ILLINOIS  
DEPARTMENT OF TRANSPORTATION**

<b>147TH STREET PROJECT</b>			
<b>MAINTENANCE OF TRAFFIC - 147TH ST. STAGE 3A</b>			
SCALE: 1" = 50'	SHEET NO. 1 OF 2 SHEETS	STA. 1000+00 TO STA. 1014+00	

F.A.I. RTE.	SECTION	COUNTY	TOTAL SHEETS	SHEET NO.
XX	(0405-1 & 0506-2) R-1	COOK	577	149
FED. ROAD DIST. NO.			ILLINOIS FED. AID PROJECT	
			CONTRACT NO. 60M57	