

PA:602540(57-294)\road\p10\_147th\P10\_MOT3\_SHT09.dgn

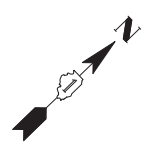

**LEGEND:**

	TEMPORARY CONCRETE BARRIER
	TRAFFIC LANE
	WORK ZONE
	TEMPORARY PAVEMENT
	BARRICADE, TYPE III
	DRUM WITH MONO-DIRECTIONAL STEADY BURNING LIGHT
	ARROW BOARD

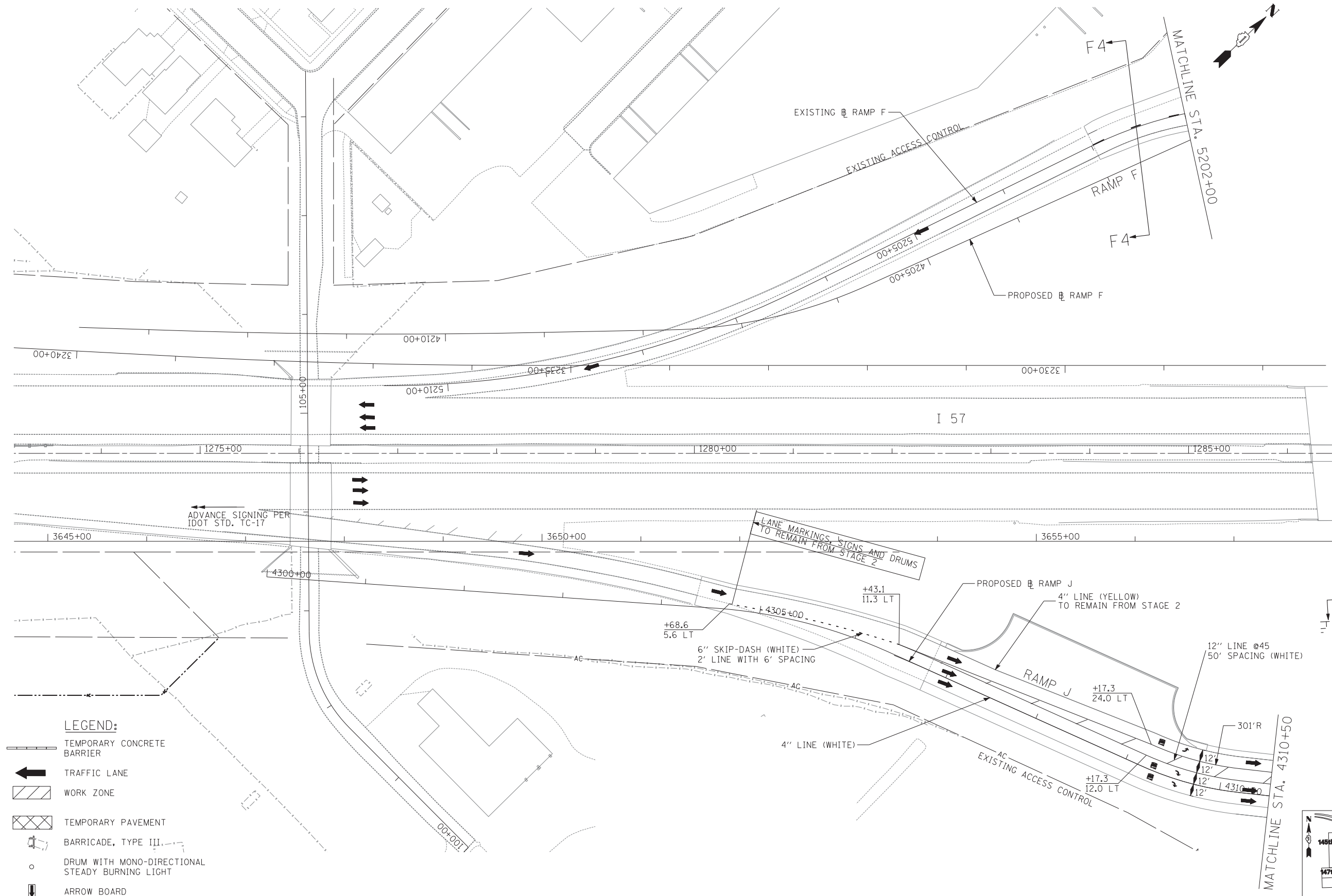
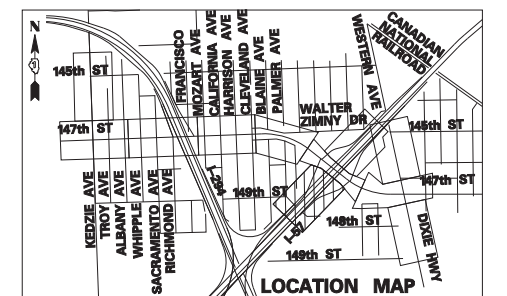

<b>TYLIN INTERNATIONAL</b>	USER NAME =	DESIGNED - DM	REVISED -
		DRAWN - DM	REVISED -
	PLOT SCALE =	CHECKED - JPM	REVISED -
	PLOT DATE =	DATE - 5/23/2012	REVISED -

**STATE OF ILLINOIS  
DEPARTMENT OF TRANSPORTATION**

<b>147TH STREET PROJECT MAINTENANCE OF TRAFFIC – I-57 RAMPS STAGE 3</b>		
SCALE: 1"=50'	SHEET NO. 10 OF 11 SHEETS	STA. TO STA.

F.A.I. RTE.	SECTION	COUNTY	TOTAL SHEETS	SHEET NO.
XX	(0405-1 & 0506-2) R-1	COOK	577	162
FED. ROAD DIST. NO.			ILLINOIS FED. AID PROJECT	

pt:\602540(57-294)\road\p10\_147th\P10\_MOT3\_SHT09.dgn

5/22/2012 1:48:34 PM