

P10_DRPP_SHT11_HRGREEN.dgn 4/26/2012 11:22:42 AM

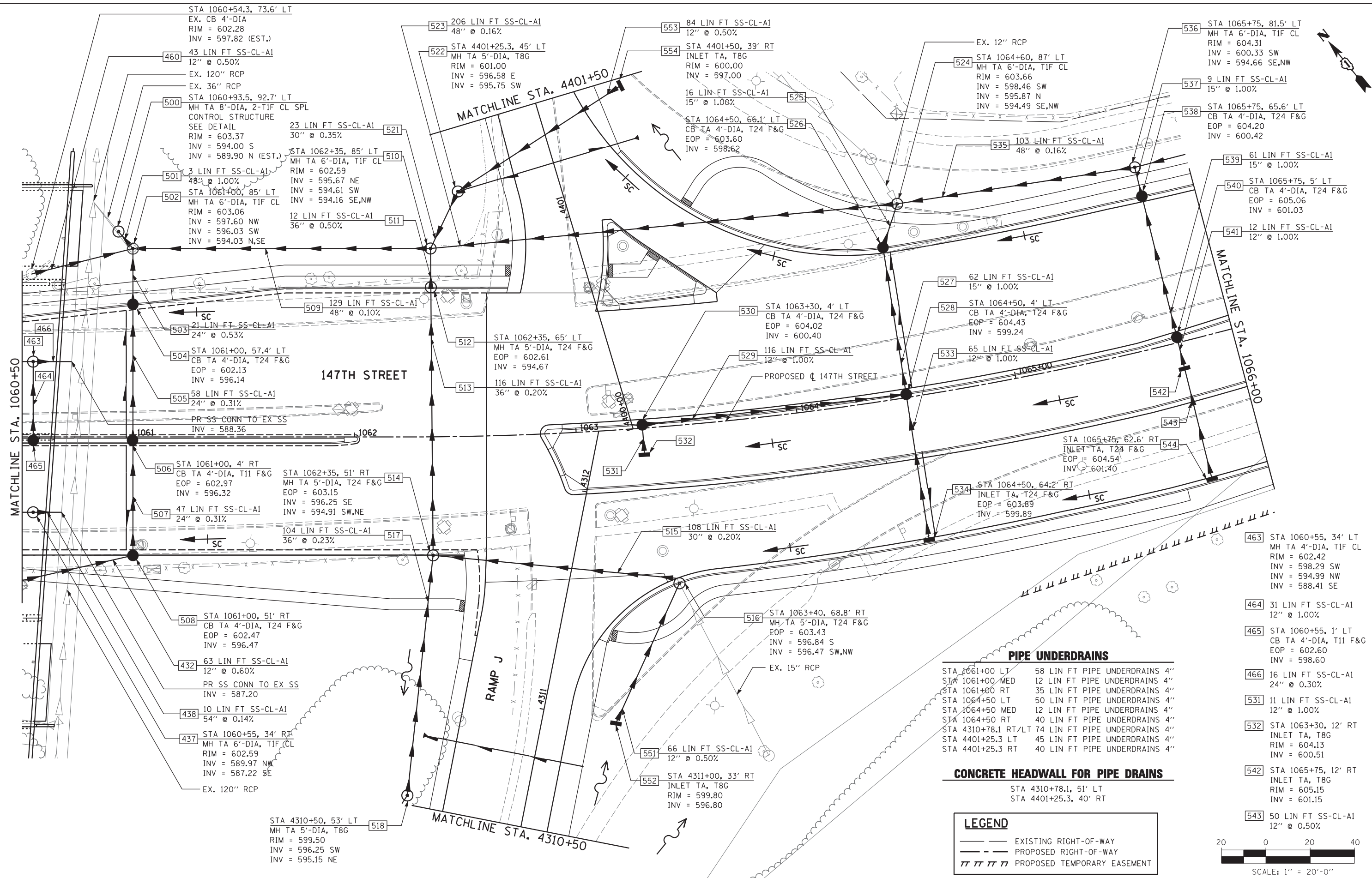

PIPE UNDERDRAINS	
STA 1061+00 LT	58 LIN FT PIPE UNDERDRAINS 4"
STA 1061+00 MED	12 LIN FT PIPE UNDERDRAINS 4"
STA 1061+00 RT	35 LIN FT PIPE UNDERDRAINS 4"
STA 1064+50 LT	50 LIN FT PIPE UNDERDRAINS 4"
STA 1064+50 MED	12 LIN FT PIPE UNDERDRAINS 4"
STA 1064+50 RT	40 LIN FT PIPE UNDERDRAINS 4"
STA 4310+78.1 RT/LT	74 LIN FT PIPE UNDERDRAINS 4"
STA 4401+25.3 LT	45 LIN FT PIPE UNDERDRAINS 4"
STA 4401+25.3 RT	40 LIN FT PIPE UNDERDRAINS 4"

CONCRETE HEADWALL FOR PIPE DRAINS	
STA 4310+78.1, 51' LT	
STA 4401+25.3, 40' RT	

LEGEND	
	EXISTING RIGHT-OF-WAY
	PROPOSED RIGHT-OF-WAY
	PROPOSED TEMPORARY EASEMENT

- 460 43 LIN FT SS-CL-A1
12" @ 0.50%
EX. 120" RCP
EX. 36" RCP
- 500 STA 1060+93.5, 92.7' LT
MH TA 8'-DIA, 2-TIF CL SPL
CONTROL STRUCTURE
SEE DETAIL
RIM = 603.37
INV = 594.00 S
INV = 589.90 N (EST.)
- 501 3 LIN FT SS-CL-A1
48" @ 1.00%
- 502 STA 1061+00, 85' LT
MH TA 6'-DIA, TIF CL
RIM = 603.06
INV = 597.60 NW
INV = 596.03 SW
INV = 594.03 N,SE
- 503 21 LIN FT SS-CL-A1
24" @ 0.53%
- 504 STA 1061+00, 57.4' LT
CB TA 4'-DIA, T24 F&G
EOP = 602.13
INV = 596.14
- 505 58 LIN FT SS-CL-A1
24" @ 0.31%
- PR SS CONN TO EX SS
INV = 588.36
- 506 STA 1061+00, 4' RT
CB TA 4'-DIA, T11 F&G
EOP = 602.97
INV = 596.32
- 507 47 LIN FT SS-CL-A1
24" @ 0.31%
- 508 STA 1061+00, 51' RT
CB TA 4'-DIA, T24 F&G
EOP = 602.47
INV = 596.47
- 432 63 LIN FT SS-CL-A1
12" @ 0.60%
- PR SS CONN TO EX SS
INV = 587.20
- 438 10 LIN FT SS-CL-A1
54" @ 0.14%
- 437 STA 1060+55, 34' RT
MH TA 6'-DIA, TIF CL
RIM = 602.59
INV = 589.97 NW
INV = 587.22 SE
- EX. 120" RCP

- 23 LIN FT SS-CL-A1
30" @ 0.35%
- 521 STA 1062+35, 85' LT
MH TA 6'-DIA, TIF CL
RIM = 602.59
INV = 595.67 NE
INV = 594.61 SW
INV = 594.16 SE,NW
- 510
- 511 12 LIN FT SS-CL-A1
36" @ 0.50%
- 512 STA 1062+35, 65' LT
MH TA 5'-DIA, T24 F&G
EOP = 602.61
INV = 594.67
- 513 116 LIN FT SS-CL-A1
36" @ 0.20%
- 514 STA 1062+35, 51' RT
MH TA 5'-DIA, T24 F&G
EOP = 603.15
INV = 596.25 SE
INV = 594.91 SW,NE
- 517 104 LIN FT SS-CL-A1
36" @ 0.23%
- 518 STA 4310+50, 53' LT
MH TA 5'-DIA, T8G
RIM = 599.50
INV = 596.25 SW
INV = 595.15 NE

- 206 LIN FT SS-CL-A1
48" @ 0.16%
- 522 STA 4401+25.3, 45' LT
MH TA 5'-DIA, T8G
RIM = 601.00
INV = 596.58 E
INV = 595.75 SW
- 523
- 524 STA 1064+60, 87' LT
MH TA 6'-DIA, TIF CL
RIM = 603.66
INV = 598.46 SW
INV = 595.87 N
INV = 594.49 SE,NW
- 525 16 LIN FT SS-CL-A1
15" @ 1.00%
- 526 STA 1064+50, 66.1' LT
CB TA 4'-DIA, T24 F&G
EOP = 603.60
INV = 598.62
- 527 62 LIN FT SS-CL-A1
15" @ 1.00%
- 528 STA 1064+50, 4' LT
CB TA 4'-DIA, T24 F&G
EOP = 604.43
INV = 599.24
- 529 116 LIN FT SS-CL-A1
12" @ 1.00%
- 530 STA 1063+30, 4' LT
CB TA 4'-DIA, T24 F&G
EOP = 604.02
INV = 600.40
- 531
- 532
- 533 65 LIN FT SS-CL-A1
12" @ 1.00%
- 534 STA 1064+50, 64.2' RT
INLET TA, T24 F&G
EOP = 603.89
INV = 599.89
- 535 103 LIN FT SS-CL-A1
48" @ 0.16%
- 536 STA 1065+75, 81.5' LT
MH TA 6'-DIA, TIF CL
RIM = 604.31
INV = 600.33 SW
INV = 594.66 SE,NW
- 537 9 LIN FT SS-CL-A1
15" @ 1.00%
- 538 STA 1065+75, 65.6' LT
CB TA 4'-DIA, T24 F&G
EOP = 604.20
INV = 600.42
- 539 61 LIN FT SS-CL-A1
15" @ 1.00%
- 540 STA 1065+75, 5' LT
CB TA 4'-DIA, T24 F&G
EOP = 605.06
INV = 601.03
- 541 12 LIN FT SS-CL-A1
12" @ 1.00%
- 542 STA 1065+75, 62.6' RT
INLET TA, T24 F&G
EOP = 604.54
INV = 601.40
- 543
- 544
- 545 STA 1060+55, 34' LT
MH TA 4'-DIA, TIF CL
RIM = 602.42
INV = 598.29 SW
INV = 594.99 NW
INV = 588.41 SE
- 546 31 LIN FT SS-CL-A1
12" @ 1.00%
- 547 STA 1060+55, 1' LT
CB TA 4'-DIA, T11 F&G
EOP = 602.60
INV = 598.60
- 548 16 LIN FT SS-CL-A1
24" @ 0.30%
- 549 11 LIN FT SS-CL-A1
12" @ 1.00%
- 550 STA 1063+30, 12' RT
INLET TA, T8G
RIM = 604.13
INV = 600.51
- 551 66 LIN FT SS-CL-A1
12" @ 0.50%
- 552 STA 4311+00, 33' RT
INLET TA, T8G
RIM = 599.80
INV = 596.80
- 553 84 LIN FT SS-CL-A1
12" @ 0.50%
- 554 STA 4401+50, 39' RT
INLET TA, T8G
RIM = 600.00
INV = 597.00
- 555 66 LIN FT SS-CL-A1
12" @ 0.50%



USER NAME =	DESIGNED - JRS	REVISED - JRS 12/01/2011
	DRAWN - MJF	REVISED - JRS 02/15/2012
PLOT SCALE =	CHECKED - APS	REVISED - JRS 05/04/2012
PLOT DATE	DATE - 7/22/2011	REVISED -

**STATE OF ILLINOIS
DEPARTMENT OF TRANSPORTATION**

**147TH STREET PROJECT
PROPOSED DRAINAGE AND UTILITY PLAN - 147TH STREET**

F.A.I. RTE.	SECTION	COUNTY	TOTAL SHEETS	SHEET NO.
57	(0405-1 & 0506-2) R-1	COOK	577	231
CONTRACT NO. 60M57			FED. ROAD DIST. NO. ILLINOIS FED. AID PROJECT	