

STATE OF ILLINOIS)
 COUNTY OF COOK) S.S.

UTILITY(IES) SHOWN HEREON HAVE BEEN INVESTIGATED BY ASE IN ACCORDANCE WITH SUE INDUSTRY STANDARDS QUALITY LEVEL B (QLB). ALL OTHER INFORMATION SHOWN HAS BEEN PROVIDED BY OTHERS.

FIELD WORK WAS PERFORMED BETWEEN THE 29TH OF JANUARY AND 6TH DAY OF APRIL, A.D., 2009.

IN WITNESS WHEREOF, I HAVE HEREUNTO SET MY HAND AND SEAL THIS 9TH DAY OF APRIL A.D., 2009. CHICAGO, IL.

STEVEN M. RIENKS - ILLINOIS PROFESSIONAL ENGINEER NUMBER 62-044619 MY LICENSE EXPIRES 11/30/2009

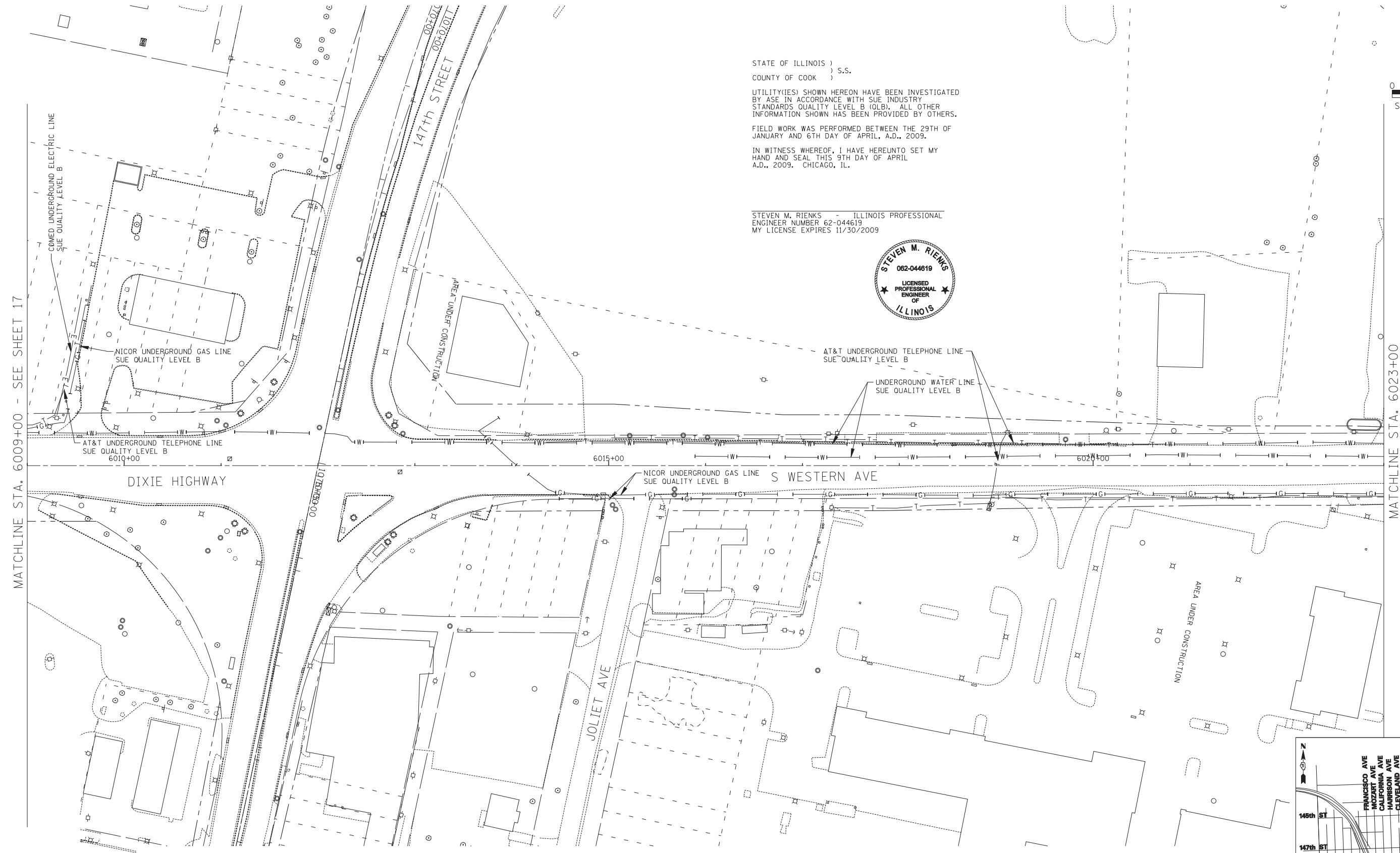

MATCHLINE STA. 6009+00 - SEE SHEET 17

MATCHLINE STA. 6023+00

DIXIE HIGHWAY

S WESTERN AVE

JOLIET AVE

AREA UNDER CONSTRUCTION

UTILITY LINE LEGEND

- | | | | |
|-----|--------------------------------|-------|----------------------------------|
| —T— | EXISTING UNDERGROUND TELEPHONE | —G+— | EXISTING UNDERGROUND GAS |
| —W— | EXISTING UNDERGROUND WATER | —CTV— | EXISTING UNDERGROUND CABLE TV |
| —E— | EXISTING UNDERGROUND ELECTRIC | —FO— | EXISTING UNDERGROUND FIBER OPTIC |

NOTES:

- HORIZONTAL CONTROL, VERTICAL CONTROL, CENTERLINE ALIGNMENT, AND TOPOGRAPHIC FEATURES WERE SUPPLIED BY ILLINOIS DEPARTMENT OF TRANSPORTATION.
- AS OF APRIL 6, 2009, ASE HAS NOT RECEIVED AT&T UTILITY MAPS. THEREFORE, AT&T UTILITY LINES SHOWN ARE BASED ON FIELD EVIDENCE.
- LEVEL D INFORMATION OBTAINED FROM VILLAGE OF POSEN'S WATER ATLAS.

