

INTERSECTION PAVEMENT ELEVATIONS

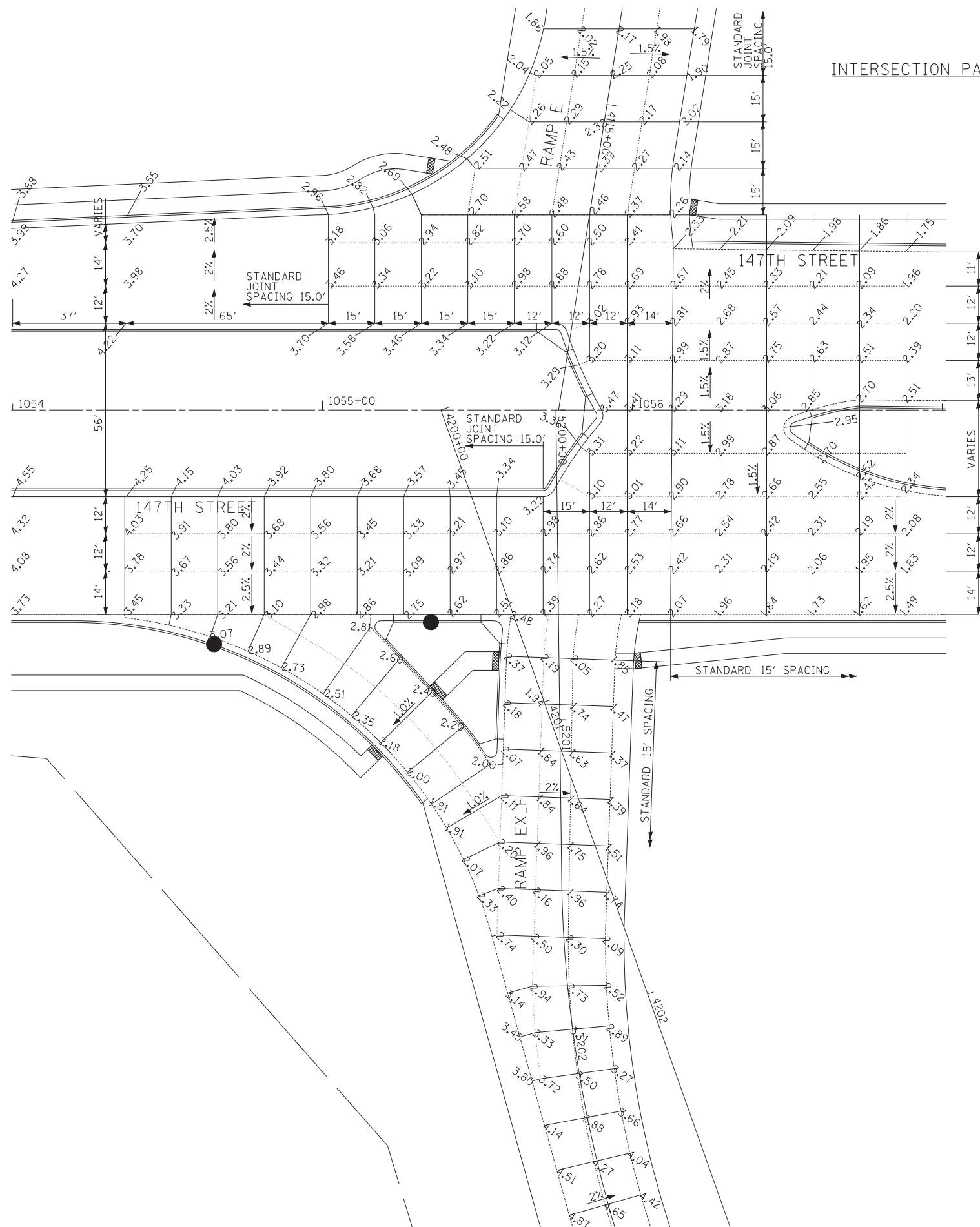

NOTES

1. ADA RAMPS PER IDOT STD 424001
PAID FOR AS PCC SIDEWALK 5".
2. ADA RAMPS PER IDOT STD 424031
PAID FOR AS CONCRETE MEDIAN SURFACE 4".

LEGEND

- C ROADWAY
- SAWED LONGITUDINAL JOINT (IDOT 420001)
- LONGITUDINAL CONSTRUCTION JOINT GROUTED-IN-PLACE TIE BAR (IDOT 420001)
- SAWED CONTRACTION JOINT (IDOT 420001)
- 1 INCH EXPANSION JOINT WITH SLEEPER SLAB (SEE DETAIL ON THIS SHEET)
- CONSTRUCTION LINE

JOINTING NOTE:
 - IDOT STANDARD 420001 APPLIES TO THE PCC ALTERNATE ONLY.
 - PAVEMENT ELEVATION LOCATIONS ARE IDENTICAL IN THE PCC AND HMA PAVEMENT ALTERNATES.

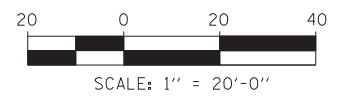

TYLIN INTERNATIONAL	USER NAME =	DESIGNED - JDU	REVISED -
		DRAWN - JDU	REVISED -
	PLOT SCALE =	CHECKED - JPM	REVISED -
	PLOT DATE =	DATE - 5/23/2012	REVISED -

**STATE OF ILLINOIS
DEPARTMENT OF TRANSPORTATION**

147TH STREET PROJECT			
INTERSECTION DETAIL - 147TH STREET AND SB RAMPS E AND F			
SCALE: 1"=20'	SHEET NO. 2 OF 2 SHEETS	STA. 1054+00 TO STA. 1057+00	

F.A.I. RE.	SECTION	COUNTY	TOTAL SHEETS	SHEET NO.
XX	(0405-1 & 0506-2) R-1	COOK	577	307
CONTRACT NO. 60M57				
FED. ROAD DIST. NO.		ILLINOIS FED. AID PROJECT		