

FINAL SURVEY	DATE
SURVEYED	BY
PLOTTED	
TEMPLATE	
AREAS CHECKED	
NO.	

ORIGINAL SURVEY	DATE
SURVEYED	BY
PLOTTED	
TEMPLATE	
AREAS CHECKED	
NO.	

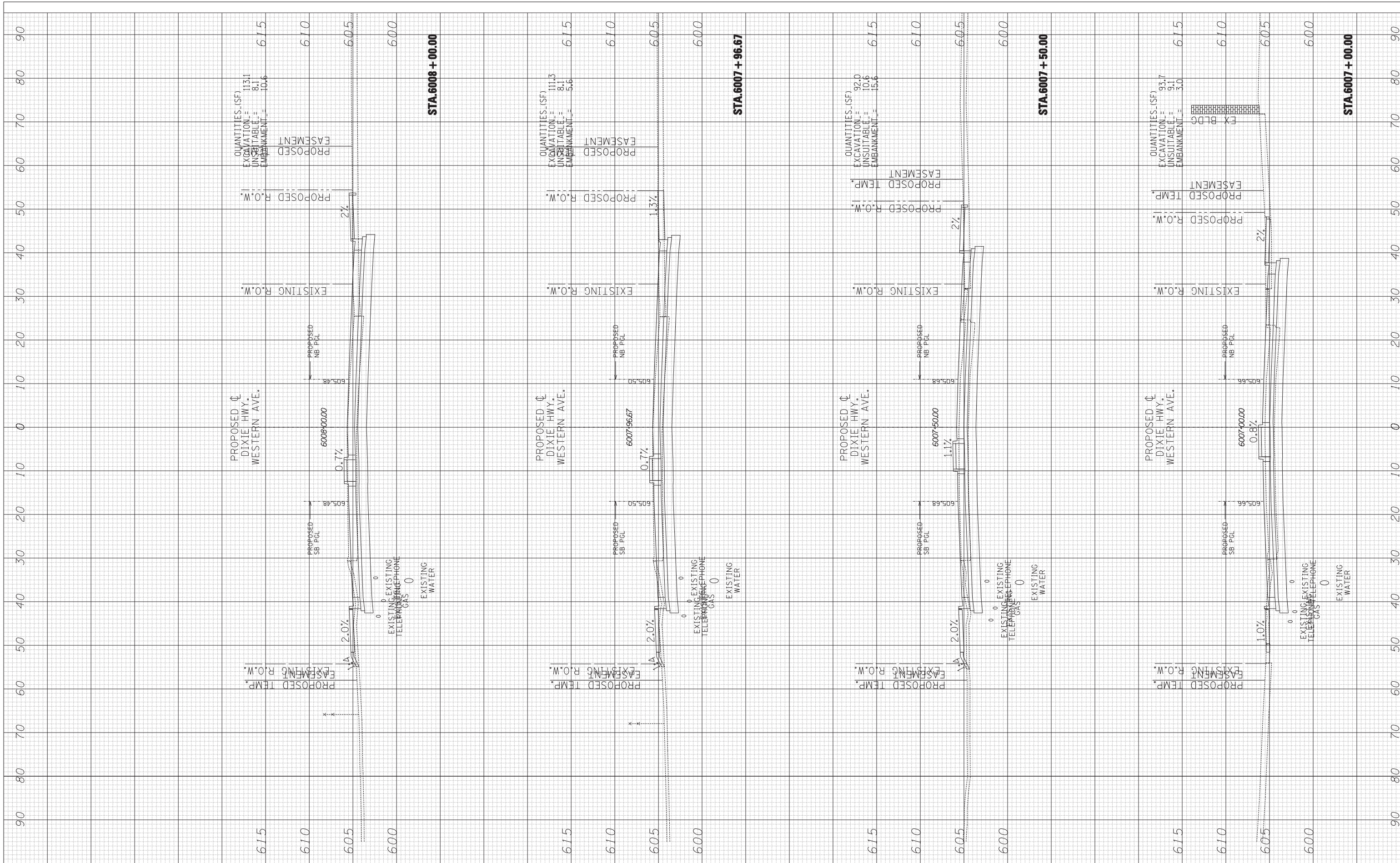

TYLIN INTERNATIONAL

USER NAME -	DESIGNED - JDF	REVISED -
	DRAWN - JDF	REVISED -
PLOT SCALE -	CHECKED - JPM	REVISED -
PLOT DATE	DATE - 6/19/2011	REVISED -

**STATE OF ILLINOIS
DEPARTMENT OF TRANSPORTATION**

**147TH STREET PROJECT
PROPOSED DIXIE WESTERN CROSS SECTIONS**

SCALE: 1" = 10' H
SHEET NO. OF SHEETS STA. 6007+00.00 TO STA. 6008+00.00

F.A. RTE.	SECTION	COUNTY	TOTAL SHEETS	SHEET NO.
XX	(0405-1 & 0506-2) R-1	COOK	577	488
FED. ROAD DIST. NO.			ILLINOIS FED. AID PROJECT	
			CONTRACT NO. 60M57	