

FINAL SURVEY NO.	SURVEYED PLOTTED TEMPLATE AREAS CHECKED	BY	DATE

ORIGINAL SURVEY NO.	SURVEYED PLOTTED TEMPLATE AREAS CHECKED	BY	DATE

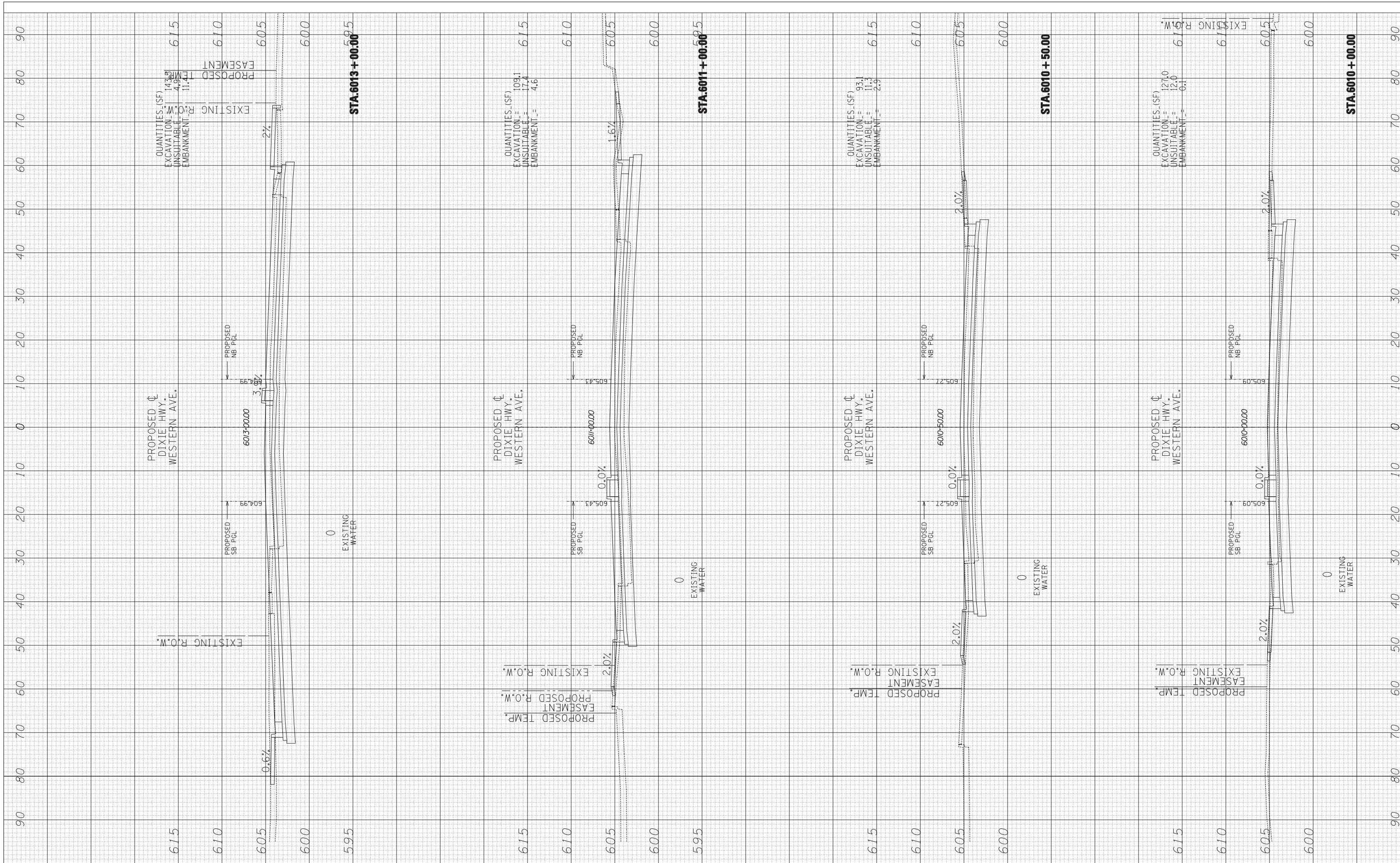

**TYLIN INTERNATIONAL**

USER NAME -	DESIGNED - JDF	REVISED -
PLOT SCALE -	DRAWN - JDF	REVISED -
PLOT DATE	CHECKED - JPM	REVISED -
	DATE - 6/19/2011	REVISED -

**STATE OF ILLINOIS  
DEPARTMENT OF TRANSPORTATION**

<b>147TH STREET PROJECT PROPOSED DIXIE WESTERN CROSS SECTIONS</b>			
SCALE: 1" = 10' H	SHEET NO.	OF SHEETS	STA. 6010+00.00 TO STA. 6013+00.00

F.A. RTE.	SECTION	COUNTY	TOTAL SHEETS	SHEET NO.
XX	(0405-1 & 0506-2) R-1	COOK	577	490
FED. ROAD DIST. NO.			ILLINOIS FED. AID PROJECT	
			CONTRACT NO. 60M57	