

| | |
|--------------|---------------|
| DATE | |
| BY | |
| FINAL SURVEY | SURVEYED |
| NOTE BOOK | PLOTTED |
| NO. | TEMPLATE |
| | AREAS CHECKED |

| | |
|-----------------|---------------|
| DATE | |
| BY | |
| ORIGINAL SURVEY | SURVEYED |
| NOTE BOOK | PLOTTED |
| NO. | TEMPLATE |
| | AREAS CHECKED |

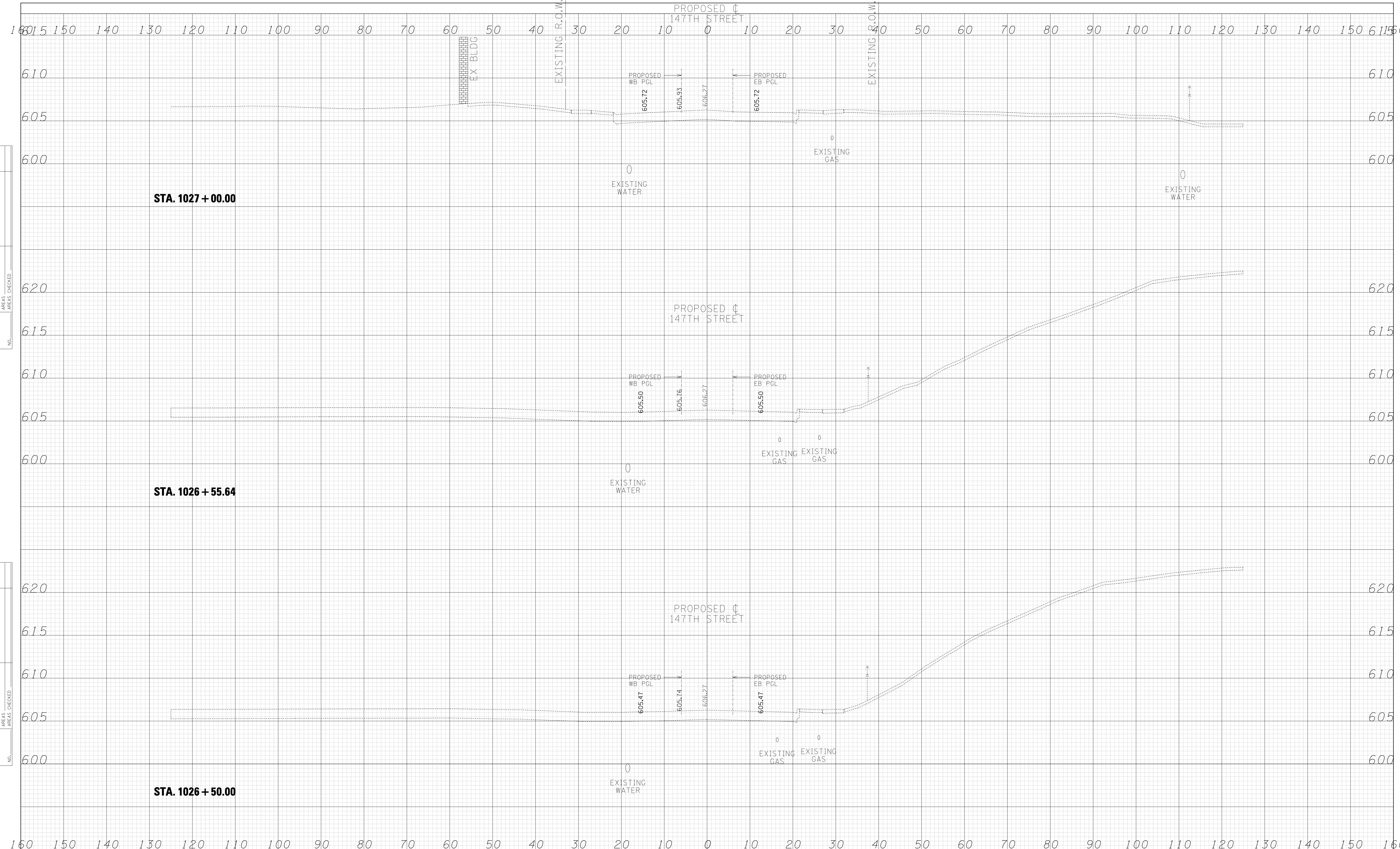

TYLIN INTERNATIONAL

| | | |
|--------------|------------------|-----------|
| USER NAME - | DESIGNED - JPM | REVISED - |
| | DRAWN - JDF | REVISED - |
| PLOT SCALE - | CHECKED - JPM | REVISED - |
| PLOT DATE | DATE - 2/24/2012 | REVISED - |

**STATE OF ILLINOIS
DEPARTMENT OF TRANSPORTATION**

**I-294 AT I-57 INTERCHANGE PROJECT
PROPOSED 147TH STREET CROSS SECTIONS**

SCALE: 1" = 10' V, 1" = 100' H

SHEET NO. OF SHEETS STA. 1026+50.00 TO STA. 1027+00.00

| F.A. RTE. | SECTION | COUNTY | TOTAL SHEETS | SHEET NO. |
|---|---------|--------|--------------|-----------|
| 57 | 1414.2B | COOK | 577 | 518 |
| CONTRACT NO. 60M57 | | | | |
| FED. ROAD DIST. NO. ILLINOIS FED. AID PROJECT | | | | |

p:\602540(57-294)\road\p10_147th\P10_XS_147TH.SHT.dgn