

DATE	
BY	
ORIGINAL SURVEY	
SURVEYED	
PLOTTED	
TEMPLATE	
NOTE BOOK	
AREAS CHECKED	
NO.	

DATE	
BY	
ORIGINAL SURVEY	
SURVEYED	
PLOTTED	
TEMPLATE	
NOTE BOOK	
AREAS CHECKED	
NO.	

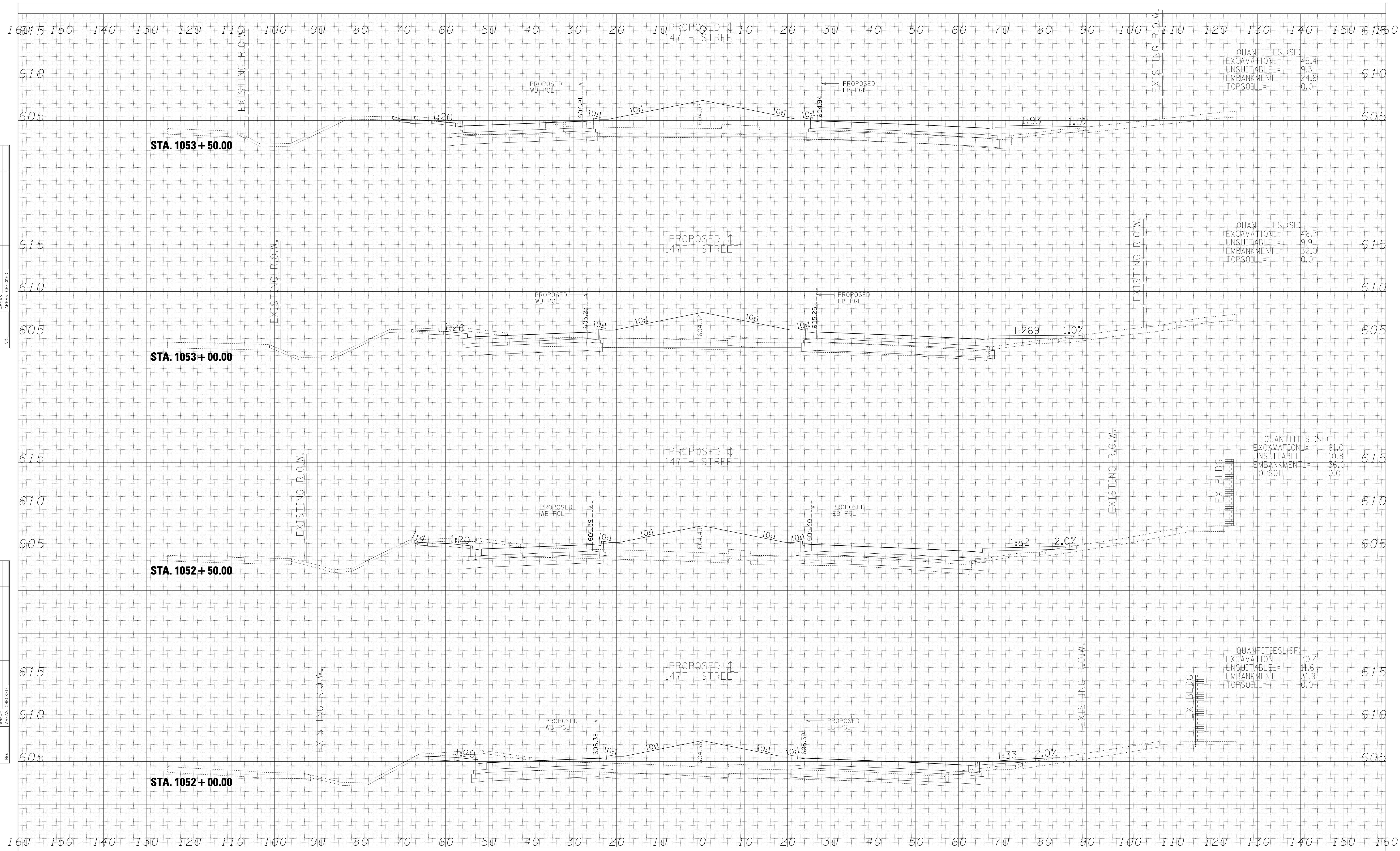

QUANTITIES (SF)	
EXCAVATION	45.4
UNSUITABLE	9.3
EMBANKMENT	24.8
TOPSOIL	0.0

QUANTITIES (SF)	
EXCAVATION	46.7
UNSUITABLE	9.9
EMBANKMENT	32.0
TOPSOIL	0.0

QUANTITIES (SF)	
EXCAVATION	61.0
UNSUITABLE	10.8
EMBANKMENT	36.0
TOPSOIL	0.0

QUANTITIES (SF)	
EXCAVATION	70.4
UNSUITABLE	11.6
EMBANKMENT	51.9
TOPSOIL	0.0

TYLIN INTERNATIONAL

USER NAME	=	DESIGNED	- JPM	REVISED	-
		DRAWN	- JDF	REVISED	-
PLOT SCALE	=	CHECKED	- JPM	REVISED	-
PLOT DATE	=	DATE	- 2/24/2012	REVISED	-

STATE OF ILLINOIS  
DEPARTMENT OF TRANSPORTATION

I-294 AT I-57 INTERCHANGE PROJECT  
PROPOSED 147TH STREET CROSS SECTIONS

SCALE: 1" = 10' H  
SHEET NO. OF SHEETS STA. 1052+00.00 TO STA. 1053+50.00

F.A. RTE.	SECTION	COUNTY	TOTAL SHEETS	SHEET NO.
57	1414.2B	COOK	577	538
CONTRACT NO. 60M57				
FED. ROAD DIST. NO. ILLINOIS FED. AID PROJECT				

p:\602540(57-294)\road\p10\_147th\P10\_XS\_147TH.SHT.dgn