

| | | | |
|------------------|--------------------------------|----|------|
| FINAL SURVEY NO. | SURVEYED PLOTTED AREAS CHECKED | BY | DATE |
| | | | |

| | | | |
|---------------------|--------------------------------|----|------|
| ORIGINAL SURVEY NO. | SURVEYED PLOTTED AREAS CHECKED | BY | DATE |
| | | | |

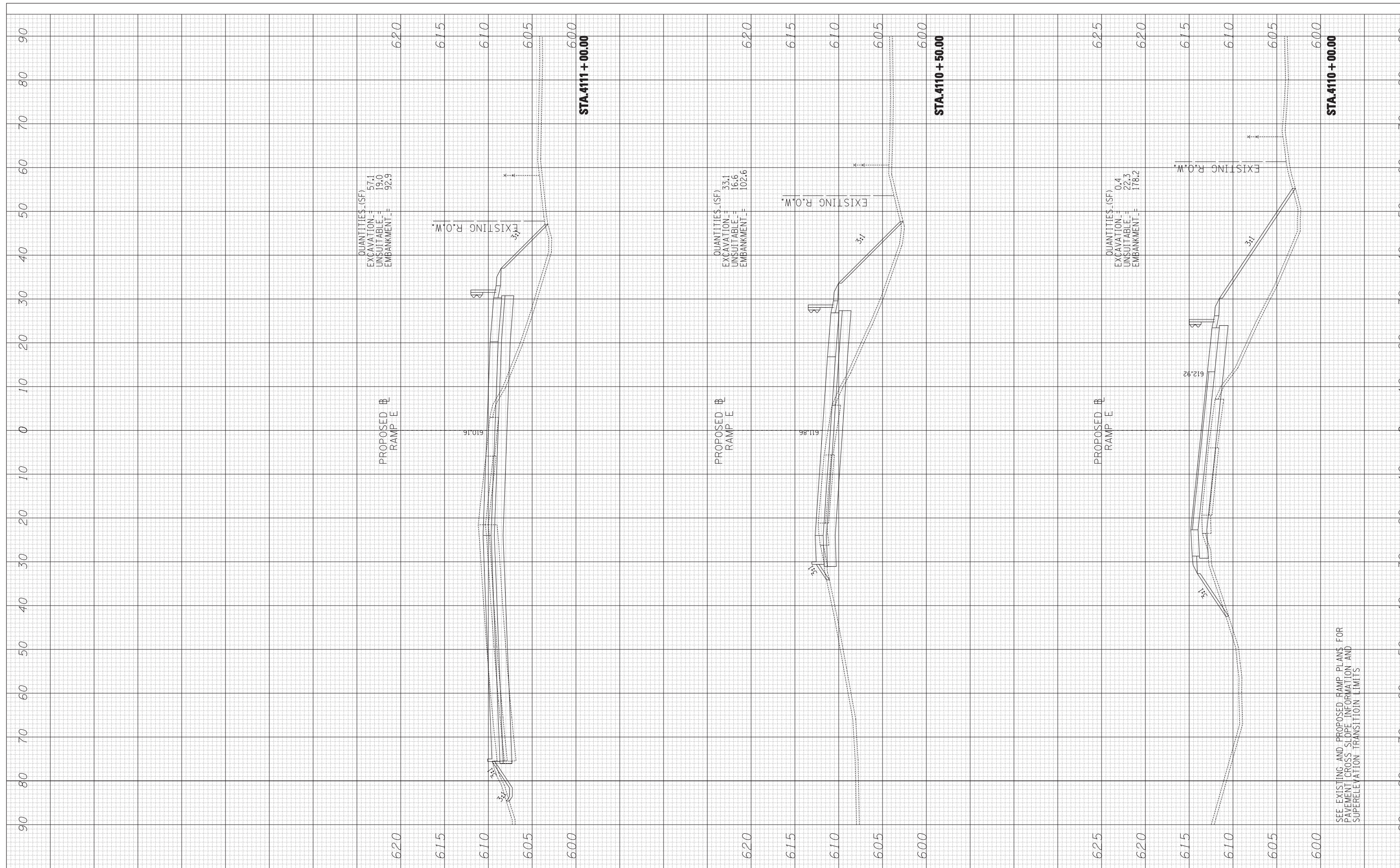

SEE EXISTING AND PROPOSED RAMP PLANS FOR PAVEMENT CROSS SLOPE INFORMATION AND SUPERELEVATION TRANSITION LIMITS

TYLIN INTERNATIONAL

| | | |
|--------------|------------------|-----------|
| USER NAME = | DESIGNED - JDF | REVISED - |
| PLOT SCALE = | DRAWN - JDF | REVISED - |
| PLOT DATE | CHECKED - JPM | REVISED - |
| | DATE - 6/19/2011 | REVISED - |

**STATE OF ILLINOIS
 DEPARTMENT OF TRANSPORTATION**

**147TH STREET PROJECT
 PROPOSED RAMP E CROSS SECTIONS**

SCALE: 1" = 10' V, 1" = 100' H SHEET NO. OF SHEETS STA. 4110+00.00 TO STA. 4111+00.00

| | | | | |
|---------------------------|-----------------------|--------|--------------------|-----------|
| F.A. RTE. | SECTION | COUNTY | TOTAL SHEETS | SHEET NO. |
| XX | (0405-1 & 0506-2) R-1 | COOK | 577 | 564 |
| FED. ROAD DIST. NO. | | | CONTRACT NO. 60M57 | |
| ILLINOIS FED. AID PROJECT | | | | |