

PLAN
 DATE: 03/28/11
 DRAWN BY: JMT
 CHECKED BY: JMT
 IN CHARGE: JMT
 PROJECT NO.: 00-00933-00-PV
 SHEET NO.: 73 OF 79
 CONTRACT NO.: 63579

PROFILE
 DATE: 03/28/11
 DRAWN BY: JMT
 CHECKED BY: JMT
 IN CHARGE: JMT
 PROJECT NO.: 00-00933-00-PV
 SHEET NO.: 73 OF 79
 CONTRACT NO.: 63579

- NOTES:
1. ALL PAVEMENT MARKINGS SHALL BE THERMOPLASTIC UNLESS OTHERWISE NOTED. PREFORMED PLASTIC PAVEMENT MARKINGS SHALL BE USED ON PROPOSED PCC PAVEMENT.
 2. SEE REMOVAL PLAN SHEET FOR LOCATIONS OF EXISTING SIGN PANELS TO BE REMOVED.
 3. REFER TO ROADWAY DETAIL SHEET FOR PROPOSED PAVEMENT MARKINGS ON OGDEN AVENUE WEST OF PASQUINELLI DRIVE.
 4. ALL SIGN PANELS TO BE RELOCATED SHALL BE TYPE 1 UNLESS OTHERWISE NOTED.

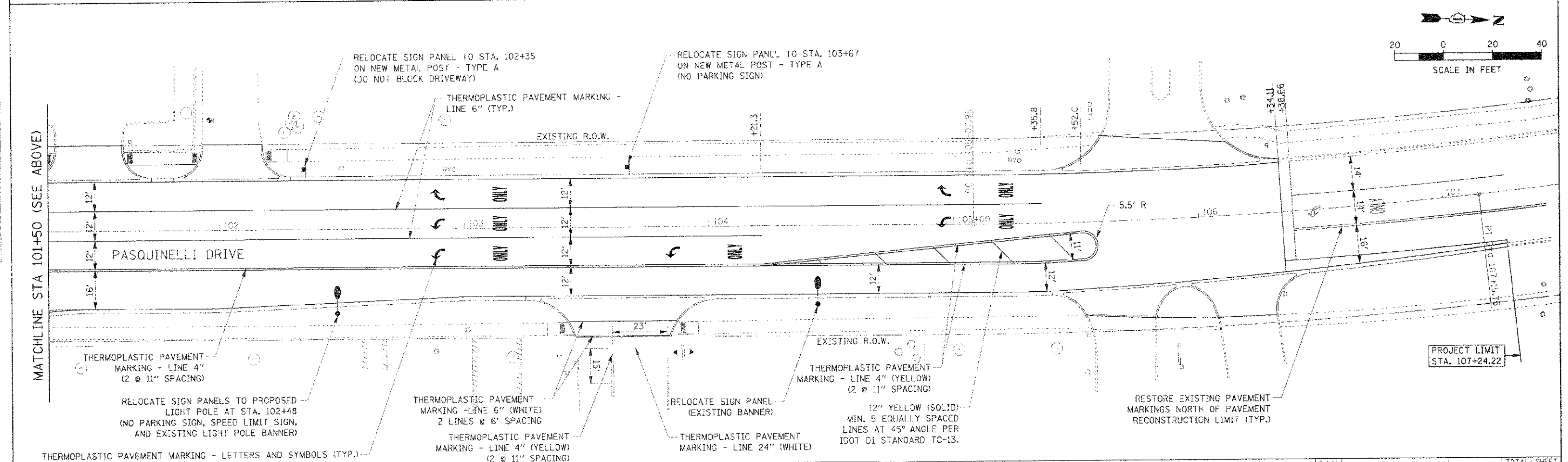
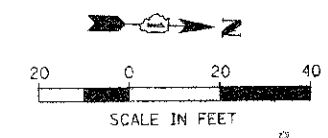
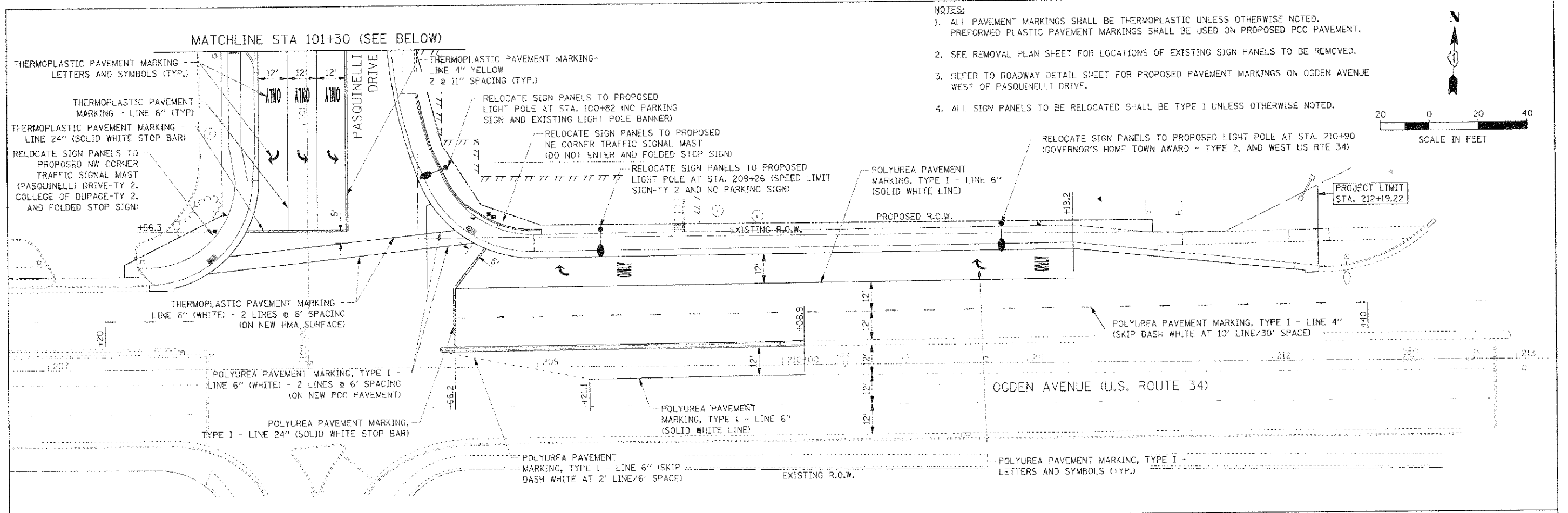
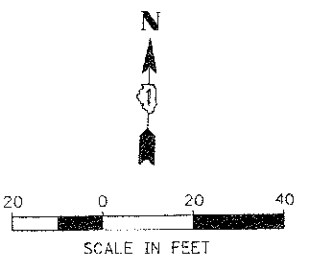

	1431 OPUS PLACE, STE 400 DOWNERS GROVE, IL 60515 PHONE: (630) 724-3200 FAX: (630) 724-3201 WEB: WWW.BURNSMCD.COM	USER NAME: JMT FILE NAME: 03/28/11 PLOT SCALE: 1"=20' PLOT DATE: 03/28/11	DESIGNED: JMT DRAWN: JMT CHECKED: JMT DATE: 03/28/11	REVISIONS: 1. REVISED: JMT 2. REVISED: JMT 3. REVISED: JMT	STATE OF ILLINOIS DEPARTMENT OF TRANSPORTATION	PASQUINELLI DRIVE RECONSTRUCTION PAVEMENT MARKING AND SIGNING	S.U. NO.: 3002 SECTION: 00-00933-00-PV COUNTY: DUPAGE CONTRACT NO.: 63579	TOTAL SHEETS: 79 SHEET NO.: 73
	SCALE: 1"=20' SHEET NO. 1 OF 1 SHEETS STA. 100+00.00 TO STA. 107+25.00						ILLINOIS FED. AID PROJECT	