

DATE	
BY	
FINAL SURVEY	
PLOTTED	
TEMPLATE	
NOTE BOOK	
AREAS CHECKED	
NO.	

DATE	
BY	
ORIGINAL SURVEY	
PLOTTED	
TEMPLATE	
NOTE BOOK	
AREAS CHECKED	
NO.	

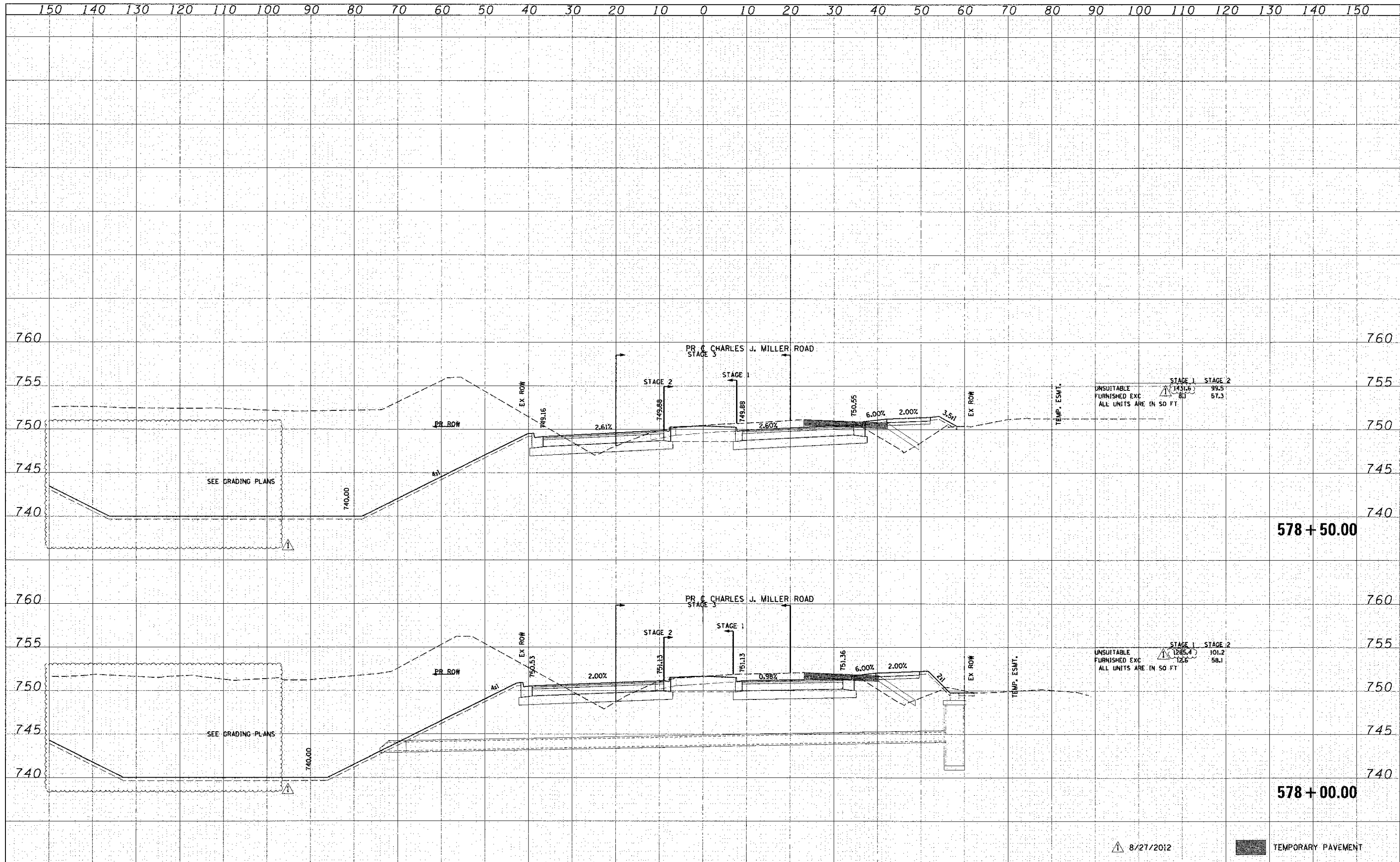

HRGreen.com 1800 Professional Design Firm 6184-001322 HRGreen	USER NAME = jettano PLOT SCALE = 1" = 10' PLOT DATE = 9/5/2012	DESIGNED - CMH DRAWN - SVJ CHECKED - JLP DATE - 8/24/12	REVISED - REVISED - REVISED - REVISED -	MCHENRY COUNTY DIVISION OF TRANSPORTATION	PROPOSED CROSS SECTIONS CHARLES J. MILLER ROAD SCALE: 1" = 10' SHEET NO. 14 OF 62 SHEETS STA. 578+00.00 TO STA. 578+50.00	F.A.L. RTE. 3860 SECTION 09-00372-00-PW COUNTY MCHENRY TOTAL SHEETS 252 SHEET NO. 204 CONTRACT NO. ILLINOIS FED. AID PROJECT 63633
--	--	--	--	--	---	---

8/27/2012 TEMPORARY PAVEMENT