

NOTES:

1. SETBACK IS MEASURED FROM THE BACK OF CURB (BOC) (OR FROM THE OUTSIDE EDGE OF TRAVELED ROADWAY) TO THE CENTER OF THE LIGHT POLE FOUNDATION.
2. SEE TRAFFIC SIGNAL PLANS FOR PLACEMENT OF THE COMBINATION POLE.
3. THE RELOCATED LIGHT POLES SHALL BE MOVED AS FOLLOWS: EXISTING LP CB2 SHALL BE MOVED BACK TO ACCOMMODATE THE ROADWAY WIDENING, EXISTING LP CB1 SHALL BE RELOCATED TO THE PROPOSED LOCATION OF LP CB5.
4. THE FOLLOWING LIGHT POLES ARE NEW: CB1, CB4, & CB6.
5. THE CONTRACTOR SHALL VERIFY CONTINUITY OF THE EXISTING LIGHTING CONDUCTORS, TO REMAIN. FAULTY SPLICES, FUSE HOLDERS, AND FUSES SHALL BE REPLACED AT NO ADDITIONAL COST TO THE CONTRACT.
6. THE EXISTING CABLE NOT SCHEDULED TO BE REPLACED, MAY BE REPLACED IF DURING TESTING IT IS DETERMINED BY THE ENGINEER TO BE NECESSARY. REPLACED CABLE SHALL BE PAID FOR AT THE CONTRACT UNIT PRICE.

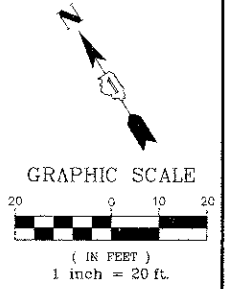

MATCHLINE - STA. 202+50 (SEE SHEET 39)

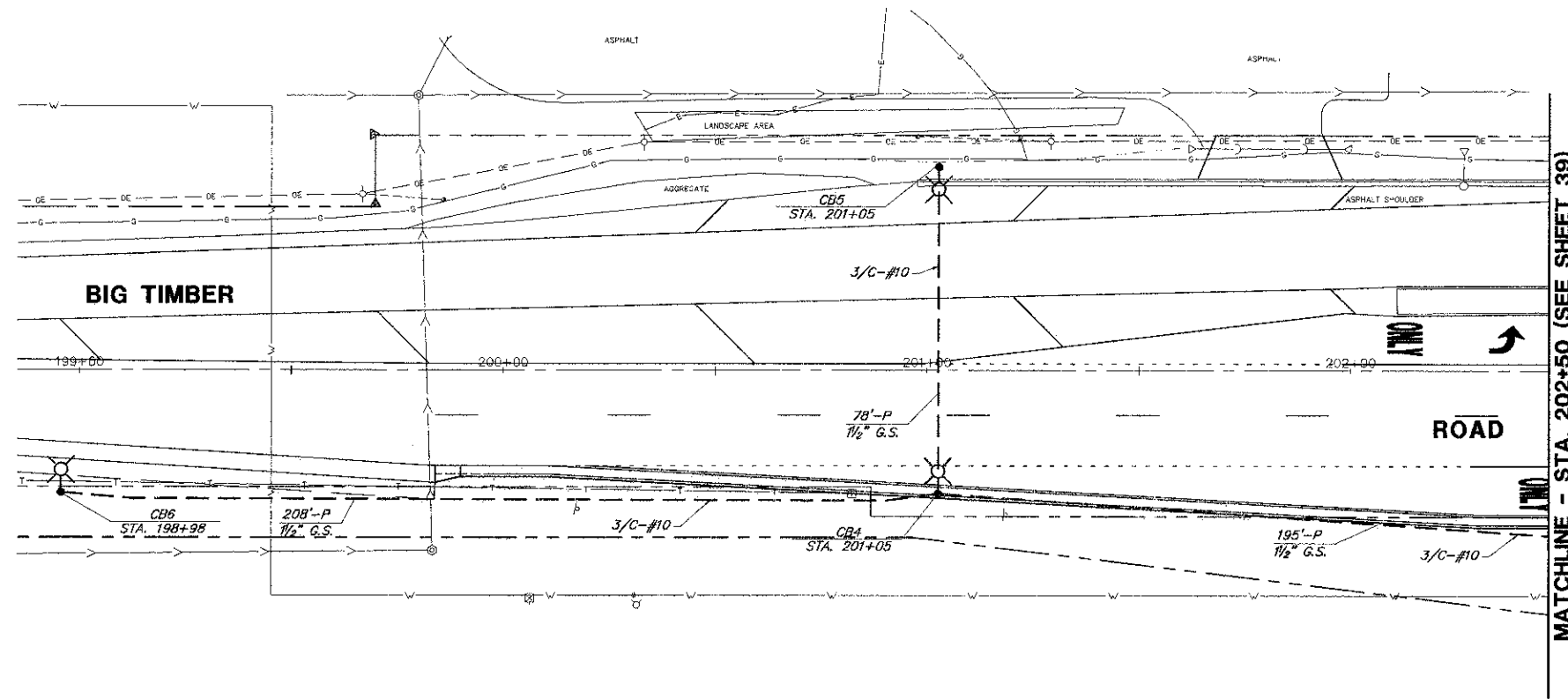
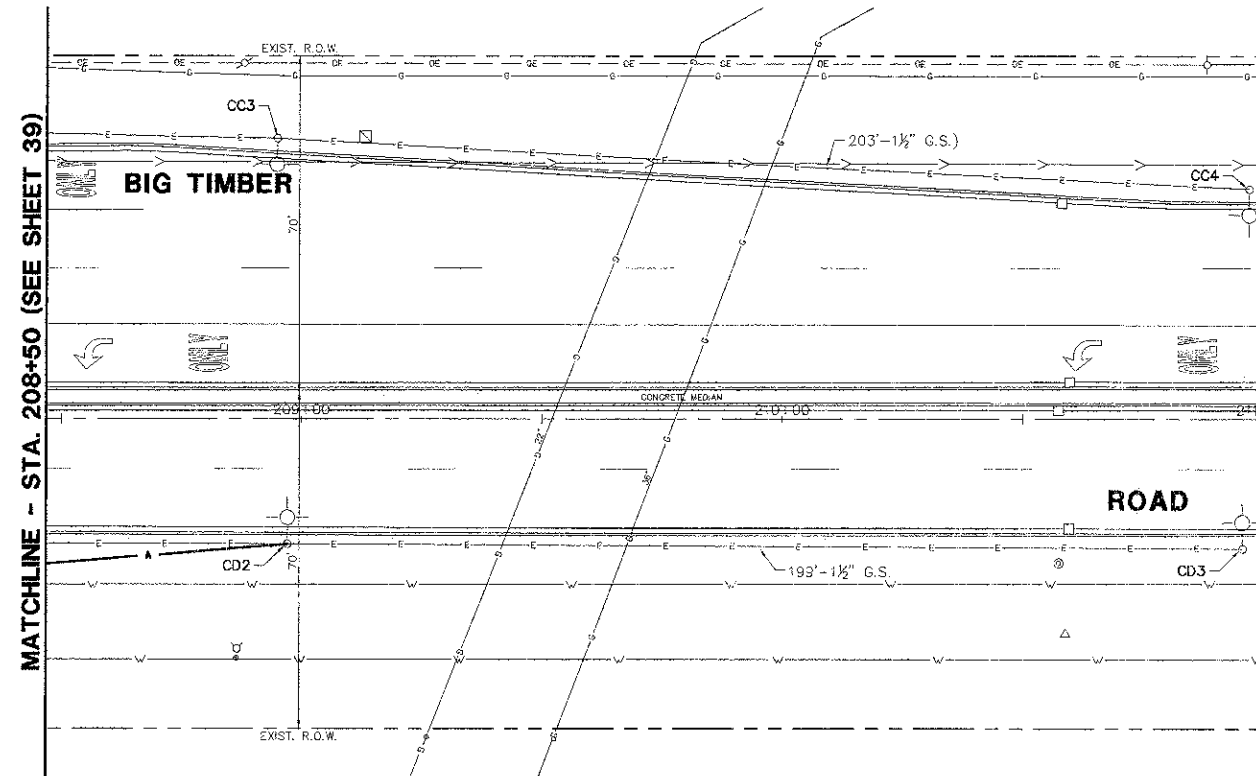

MATCHLINE - STA. 208+50 (SEE SHEET 39)

POLE PLACEMENT BIG TIMBER ROAD		
STATION	POLE LABEL	SETBACK
201+05	CB4	3.0'
201+05	CB5	3.0'
198+98	CB6	13.0'

LEGEND

- PROPOSED ALUMINUM STREET LIGHT
40 FT M.H., 10 FT MAST ARM
WITH TRANSFORMER BASE
- PROPOSED COMBINATION POLE STREET LIGHT
40 FT M.H., 12 FT MAST ARM
(SEE TRAFFIC SIGNAL PLANS)
- P - DENOTES LIGHTING CONTROLLER
A1 - DENOTES FIXTURE NUMBER ON GIVEN CIRCUIT
- STA # - DENOTES STATIONING LOCATION
- #10 AWG PHASE & GROUND, 600V, TYPE XLP
IN 2" GALVANIZED STEEL CONDUIT (OR AS SHOWN)
- PROPOSED CONTROLLER CABINET
- PROPOSED ELECTRIC SERVICE INSTALLATION
- PROPOSED HANDHOLE
- EXISTING STREET LIGHTING, TO REMAIN
- EXISTING ELECTRICAL CONDUIT, TO REMAIN