

LEGEND

- PROPOSED BOLLARD WITH LED LUMINAIRE
- UNIT DUCT, 3/4" DIA., WITH 2-1/2" No. 10 AND 1-1/2" No. 10 GROUND, UNLESS OTHERWISE NOTED
- ⊗ PROPOSED SERVICE INSTALLATION
- ⊠ PROPOSED CONTROLLER, 1 PHASE 100 AMP
- PROPOSED EMBEDDED CONCRETE POLE WITH LOYOLA LED LUMINAIRE

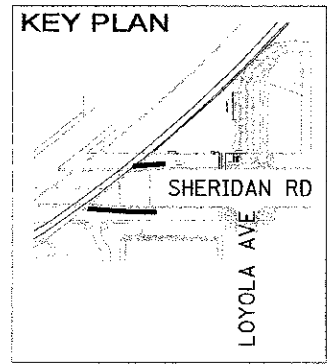

FILE NAME =	DESIGNED - GHT	REVISED -
...\\pp\in\abc-light\pln-02.dgn	DRAWN - TMB	REVISED -
USER NAME = tblank	CHECKED - JMM	REVISED -
PLOT DATE = 7/2/2012	DATE - 7/2/2012	REVISED -

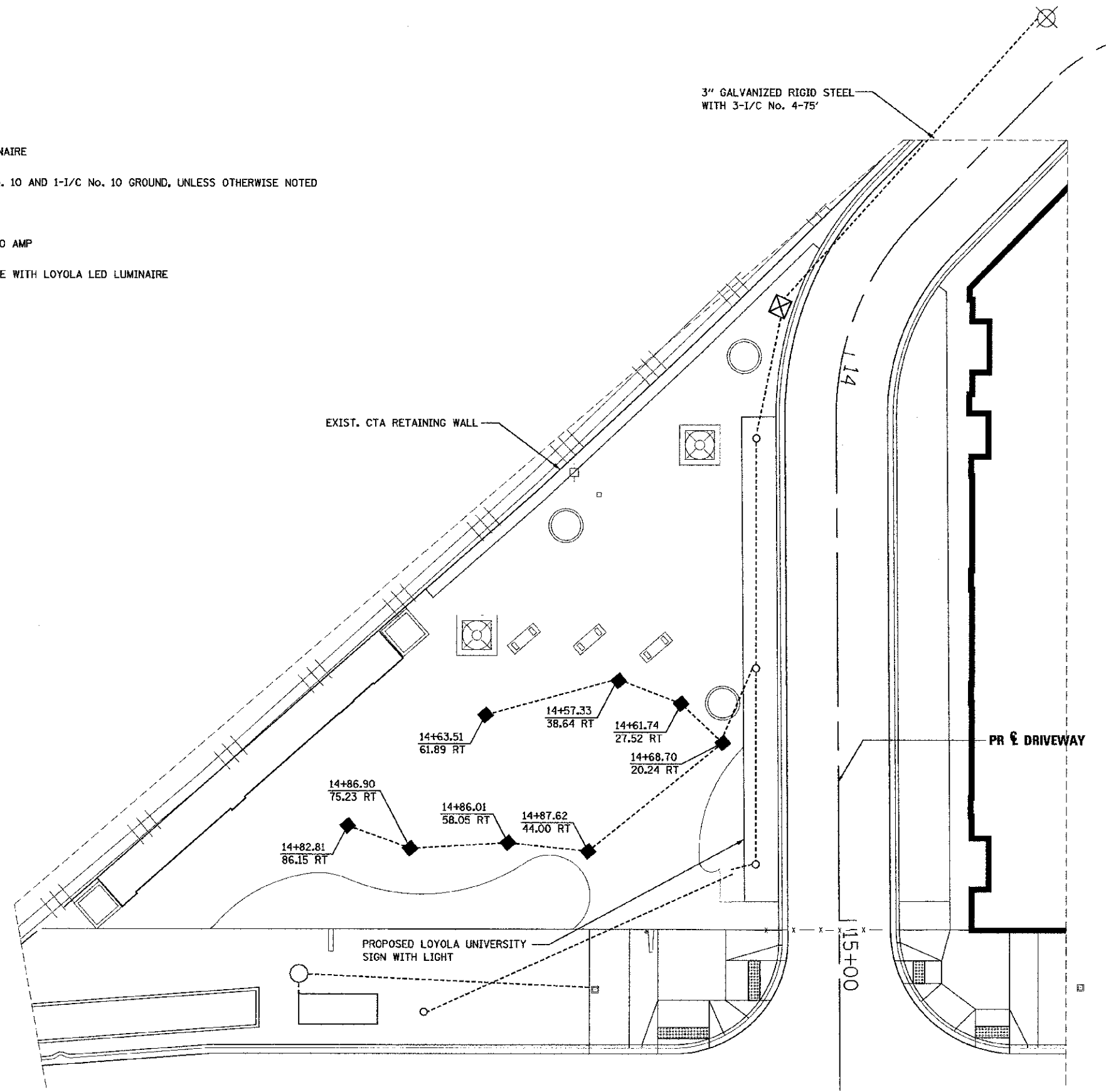

STATE OF ILLINOIS
DEPARTMENT OF TRANSPORTATION

LIGHTING PLAN

SCALE: 1"=20' SHEET NO. 2 OF 2 SHEETS STA. TO STA.

F.A.L. RTE.	SECTION	COUNTY	TOTAL SHEETS	SHEET NO.
2865	10-B5159-00-TL	COOK	62	38
CONTRACT NO. 63715			ILLINOIS FED. AID PROJECT	