

PAVEMENT MARKING LEGEND

- ① EXISTING PAVEMENT MARKING
 - ② TEMPORARY PAVEMENT MARKING FROM PREVIOUS STAGE
 - ③ PROPOSED PAVEMENT MARKING IN PLACE (SEE PROPOSED PAVEMENT MARKING PLAN)
 - T PAVEMENT MARKING TAPE, TYPE III
 - P POLYUREA PAVEMENT MARKING TYPE II
- | | | | |
|------|---|------|--------------------------------|
| 4SW | 4" SOLID WHITE | 8SW | 8" SOLID WHITE |
| 4SY | 4" SOLID YELLOW | 12SW | 12" SOLID WHITE @ 20" SPACING |
| 4SYY | 4" SOLID DOUBLE YELLOW (11" C-C) | 12SY | 12" SOLID YELLOW @ 20" SPACING |
| 4KW | 4" SKIP-DASH WHITE (30' SKIP, 10' DASH) | 24SW | 24" SOLID WHITE STOP BAR |
| 4DW | 4" DOTTED WHITE (9' SKIP, 3' DASH) | LSW | LETTERS & SYMBOLS, WHITE |

LEGEND

- ☼ DRUMS WITH STEADY BURNING WARNING LIGHTS
 - ➡ DIRECTION INDICATOR
 - ☼ BARRICADE WITH STEADY BURN MONODIRECTIONAL LIGHT
 - VERTICAL DELINEATOR PANELS
 - BARRICADE, TYPE III
 - ➡ FLASHING ARROW BOARD
 - ➡ DIRECTION OF TRAFFIC FLOW
 - ☼ IMPACT ATTENUATOR, TEMPORARY (NON-REDIRECTIVE)
 - ☼ IMPACT ATTENUATOR, TEMPORARY (NARROW, REDIRECTIVE)
 - TCP• SIGN INCLUDED IN TRAFFIC CONTROL & PROTECTION (SEE SIGN SCHEDULE)
- ▨ TEMPORARY PAVEMENT CONSTRUCTION
 - ▨ ON-GOING EARTHWORK FOR PROPOSED PAVEMENT
 - ▨ PROPOSED PAVEMENT CONSTRUCTION
 - ▨ TEMP PVMT REMOVAL (SEE REMOVAL PLAN FOR EX PVMT REMOVAL)
 - REM TEMP AGGREGATE SHOULDERS
 - AGGREGATE SHOULDERS, TYPE B 6"
 - TEMPORARY CONCRETE BARRIER
 - TEMPORARY CONCRETE BARRIER WITH 36" GLARE SCREEN
 - XX-X SIGN REFERENCE NUMBER (SEE SIGN SCHEDULE)

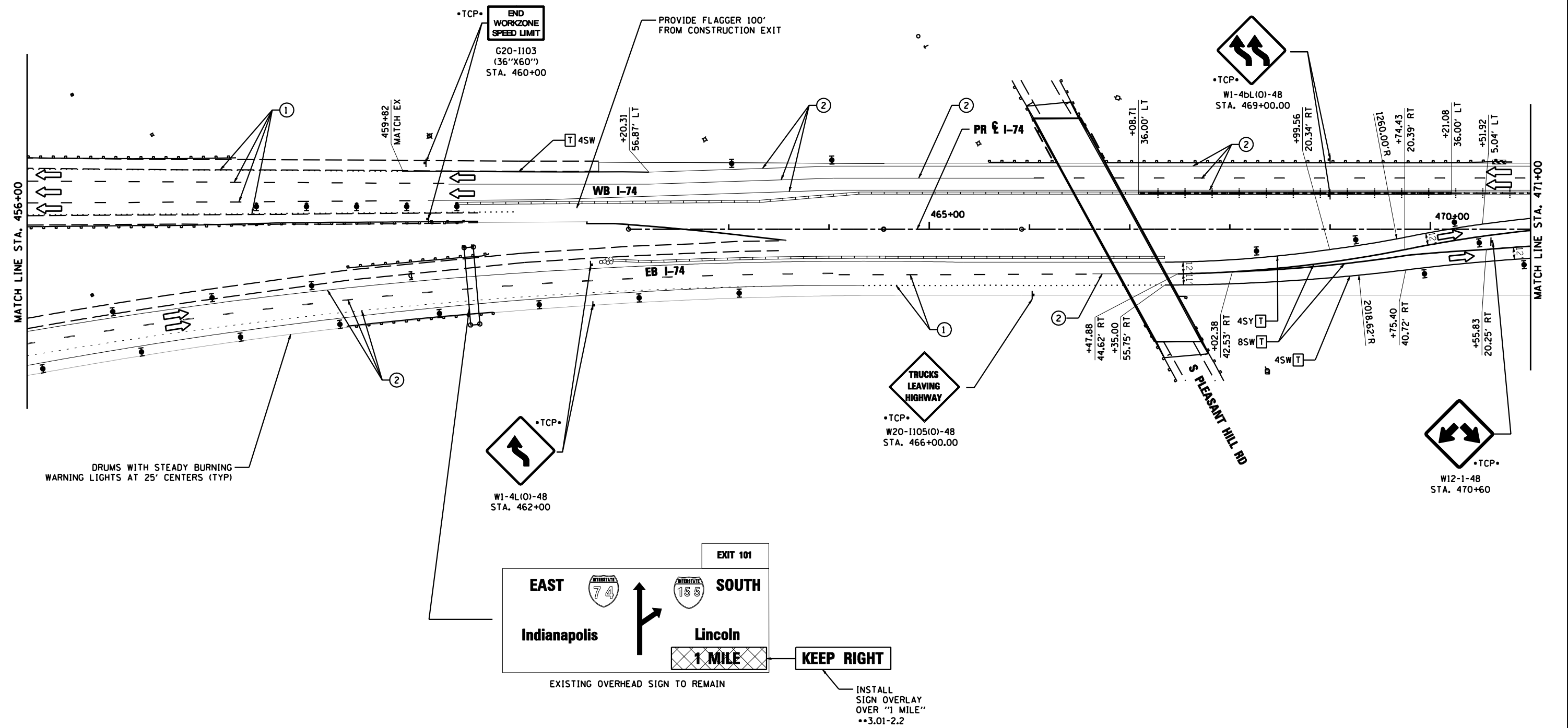
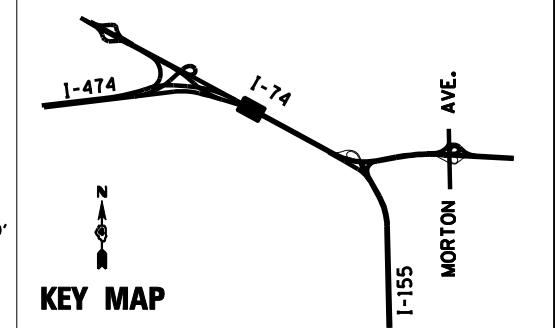
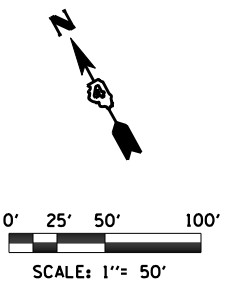

FILE NAME = D468620-sh1-staging03 174-02.dgn	DESIGNED - HTL	REVISED -		STATE OF ILLINOIS DEPARTMENT OF TRANSPORTATION	MAINTENANCE OF TRAFFIC STAGE 2A	F.A.I. RTE. = 90-[14R(14HB-4,14,14HVB)BR]	SECTION =	COUNTY = TAZEWELL	TOTAL SHEETS = 2433	SHEET NO. = 501			
USER NAME = TERRA	DRAWN - JPS	REVISED -				SCALE: 1" = 50'	SHEET NO. 11 OF 50 SHEETS	STA. 456+00 TO STA. 471+00	CONTRACT NO. 68620				
PLOT DATE = 7/16/2012	CHECKED - DA/LVA	REVISED -				ILLINOIS FED. AID PROJECT							
	DATE - 7/20/2012	REVISED -				• 74 & 155							